



**Have a Question?**  
 Chat with a Product Information Specialist

What can we help you find?

[Products](#) [Industries](#) [Resources](#) [About TE](#) [My Account](#) [Innovation](#) [Support Center](#)

## 1658539-4 Product Details

[Share](#) [Print](#) [Email](#)



**1658539-4**

TE Internal Number: 1658539-4

Active

### Standard Cable Connectors

Always EU RoHS/ELV Compliant (Statement of Compliance)

#### Product Highlights:

- Contact
- Product Series = HDP-20 (Crimp Snap)
- Contact Type = Pin
- Brass Contact Base Material
- Crimp Termination Method to Wire/Cable

[View all Features](#)

### Quick Links

- ▶ [Pricing & Availability](#)
- ▶ [Search for Tooling](#)
- ▶ [Product Feature Selector](#)
- ▶ [Contact Us About This Product](#)

[Add to My Part List](#) [Request Sample](#) [Find Similar Products](#) [Buy Product](#)

### Documentation & Additional Information

#### Product Drawings:

- [PIN CONTACT, 20 DF, \(PDF, English\)](#)

#### Catalog Pages/Data Sheets:

- [Signal Contacts \(PDF, English\)](#)
- [AMP Circular Connectors for Commercial Signal & Powe... \(PDF, English\)](#)
- [AMPLIMITE Subminiature D Connectors - Cable Connectors \(PDF, English\)](#)

#### Product Specifications:

- [AMPLIMITE HDP-20 Subminiature D Connector With F Cri... \(PDF, English\)](#)

#### Application Specifications:

- [HD-20 Precision Formed Contacts \(PDF, English\)](#)
- [AMPLIMITE HDP-20 and Economy Crimp Snap Subminiature... \(PDF, English\)](#)

#### Instruction Sheets:

- [AMPLIMITE High Density \(HDP-20\) Connectors with Crim... \(PDF, English\)](#)
- [PRO-CRIMPER III Hand Crimping Tool Assembly 58448-2 ... \(PDF, English\)](#)
- [Insertion/Extraction Tool 91285-1 and Replacement Ti... \(PDF, English\)](#)

#### CAD Files:

- None Available

[List all Documents](#)

#### Additional Information:

- [Product Line Information](#)

#### Related Products:

- [Tooling](#)

### Product Features (Please use the Product Drawing for all design activity)

#### Product Type Features:

- **Product Type** = Contact
- **Product Series** = HDP-20 (Crimp Snap)
- **Termination Method to Wire/Cable** = Crimp
- **Wire Insulation Diameter (mm [in])** = 1.27 - 1.52 [0.050 - 0.060]
- **Insulation Support** = Yes
- **Grade** = Standard

#### Mechanical Attachment:

- **Contact Retention in Housing** = Crimp Snap-In

#### Termination Features:

- **Solder Tail Contact Plating** = Tin over Nickel

#### Dimensions:

- **Pin Diameter (mm [in])** = 1.02 [0.040]

#### Body Features:

- **Wire Range (mm<sup>2</sup> [AWG])** = 0.2 - 0.6 [24-20]
- **Used With** = AMPLIMITE HDP-20, CPC Connectors

#### Contact Features:

- **Contact Type** = Pin
- **Contact Base Material** = Brass
- **Contact Plating, Mating Area, Material** = Gold Flash
- **Contact Size** = 20

#### Industry Standards:

- **RoHS/ELV Compliance** = RoHS compliant, ELV compliant
- **Lead Free Solder Processes** = Not relevant for lead free process
- **RoHS/ELV Compliance History** = Always was RoHS compliant

#### Packaging Features:

- **Packaging Method** = Loose Piece

#### Other:

- **Brand** = AMP

### Corporate Information

[About TE](#)

[Investors](#)

### Quick Links

[Distributor Inventory](#)

[Product Cross Reference](#)

### Customer Support

[Email or Chat With Us](#)

[Find a Phone Number](#)

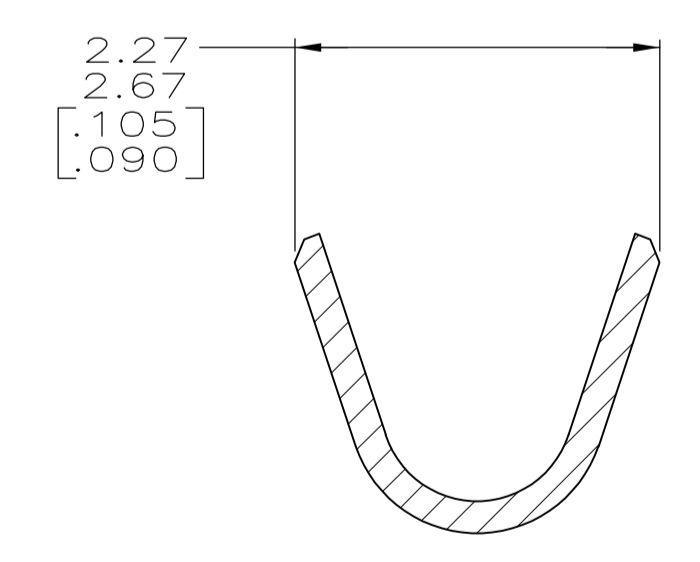
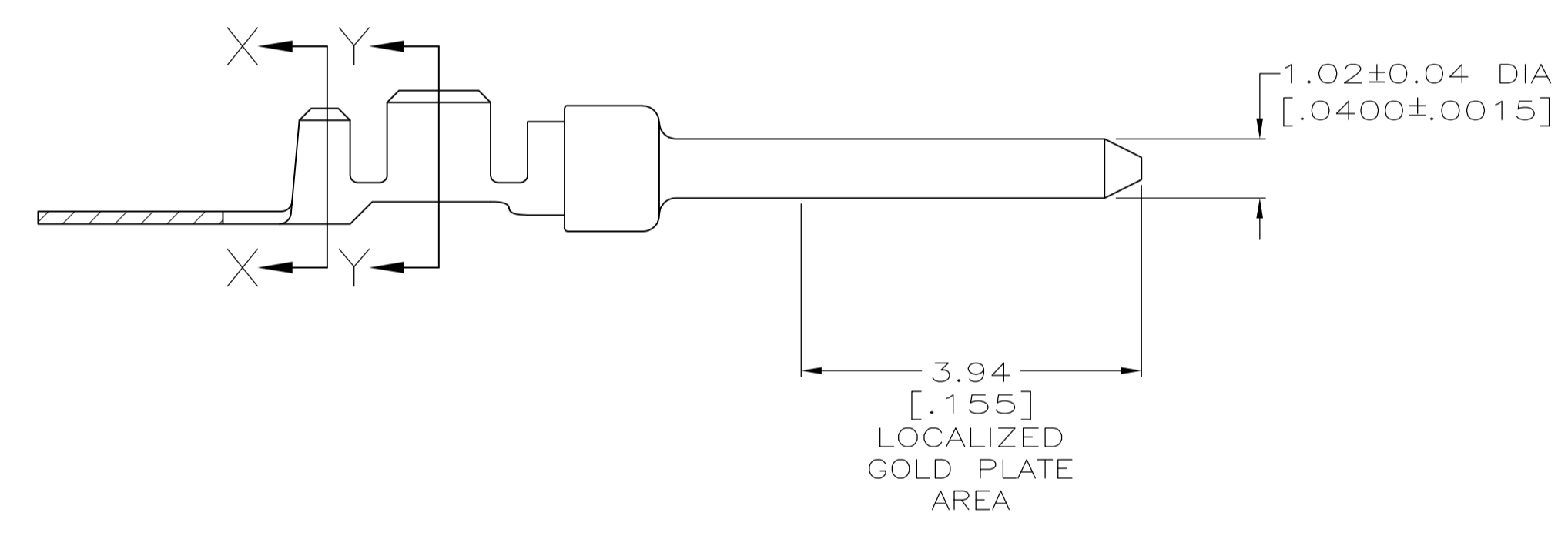
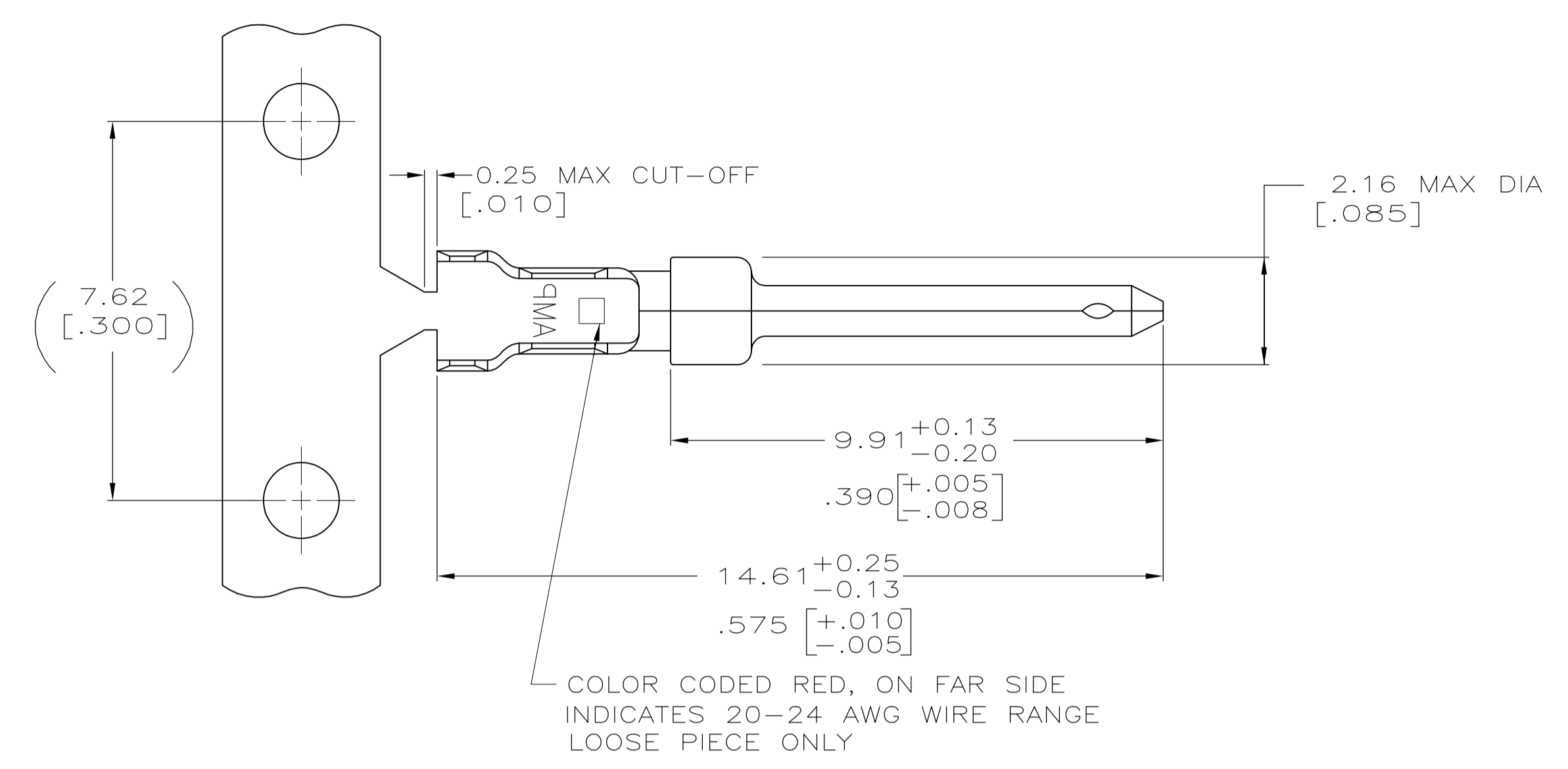

SECTION X-X  
INSULATION BARREL  
SCALE 20:1

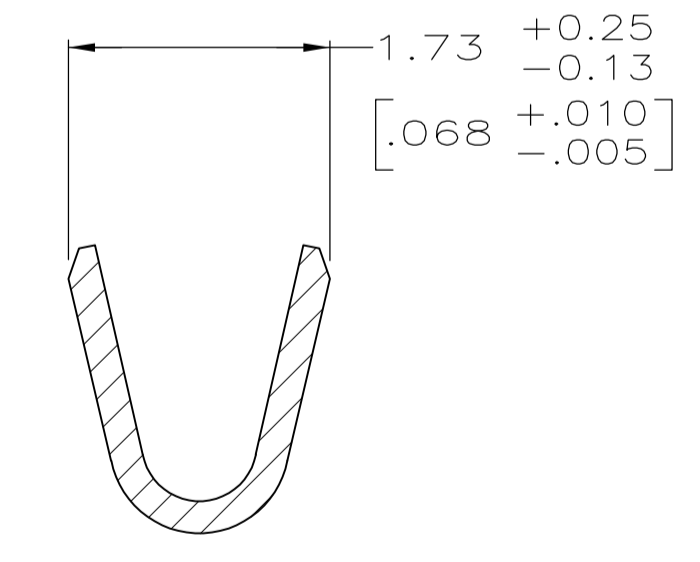

SECTION Y-Y  
WIRE BARREL  
SCALE 20:1

- 1. FOR MINI-APPLICATOR AND STRIPPER CRIMPER.
- 2. FOR HAND TOOL USE ONLY.
- 3. WIRE RANGE OF 20-24 AWG. INSULATION RANGE OF 1.27/1.52 [.050-.060].
- 4. GOLD PLATING MAY NOT APPEAR ON CARRIER STRIP.
- 5. GOLD PLATED IN LOCALIZED GOLD PLATE AREA AS FOLLOWS:  
0.76µm [.000030] MIN GOLD IN MATED AREA, 2.54µm [.000100] MIN TIN ON WIRE BARRELS, ALL OVER 1.27µm [.000050] MIN NICKEL UNDERPLATE.  
OR  
GOLD FLASH OVER PALLADIUM-NICKEL PLATE, 0.76µm [.000030] MIN TOTAL IN MATED AREA, 2.54µm [.000100] MIN TIN ON WIRE BARRELS, ALL OVER 1.27µm [.000050] MIN NICKEL UNDERPLATE.
- 6. GOLD FLASH IN LOCALIZED GOLD PLATE AREA, 2.54µm [.000100] MIN TIN PLATED WIRE BARRELS, ALL OVER 0.76µm [.000030] MIN NICKEL UNDERPLATE.
- 7. GOLD FLASH IN LOCALIZED GOLD PLATE AREA, 0.76µm [.000030] MIN TIN PLATED WIRE BARRELS, ALL OVER 0.76µm [.000030] MIN NICKEL UNDERPLATE.

1	1	STRIP	1658539-5
6	2	LOOSE PIECE	1658539-4
5	2	LOOSE PIECE	1658539-3
6	1	STRIP	1658539-2
5	1	STRIP	1658539-1
FINISH	USE	TYPE	PART NUMBER

THIS DRAWING IS A CONTROLLED DOCUMENT.

APPROVED BY: R. SAMICK	DATE: 11AUG03	<b>STE</b> TE Connectivity
CHK: S. BOLASH	DATE: 11AUG03	
APPROVED BY: M. WALMSLEY	DATE: 11AUG03	NAME: PIN CONTACT, 20 DF,
PRODUCT SPEC: 108-40005		APPLICATION SPEC: 20-24 AWG, AMPLIMITE
SIZE: 114-10000	SCALE: A1	DRAWING NO: 1658539
MATERIAL: BRASS	FINISH: SEE TABLE	WEIGHT: -
CUSTOMER DRAWING		SCALE: 10:1 SHEET 1 OF 1 REV C1