

THIS DRAWING IS UNPUBLISHED. RELEASED FOR PUBLICATION  
 © COPYRIGHT - BY - ALL RIGHTS RESERVED.

LOC		DIST		REVISIONS			
P	LTR	DESCRIPTION		DATE	DWN	APVD	
	A1	REVISED PER ECO-11-005301		07MAR11	RK	HMR	

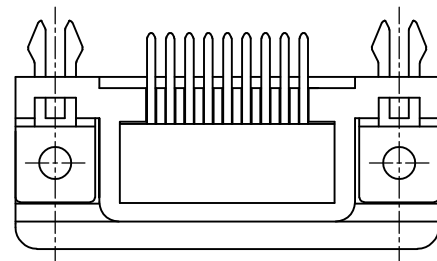
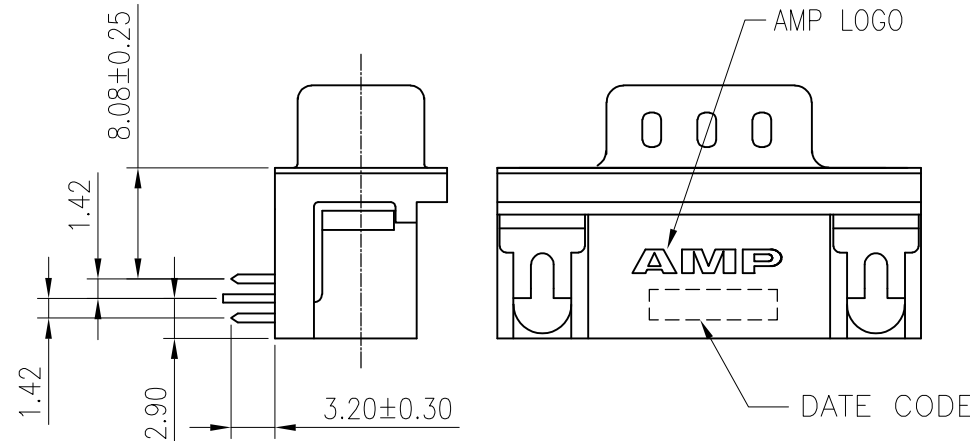
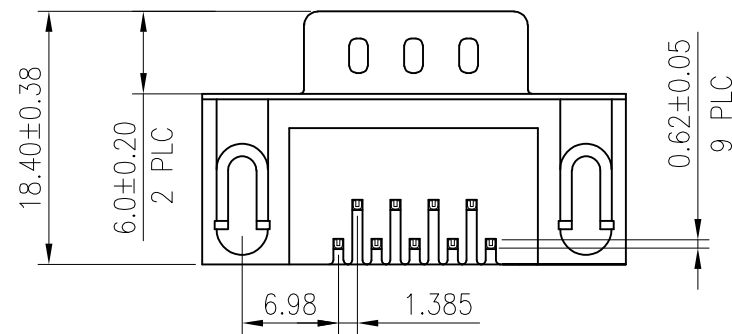
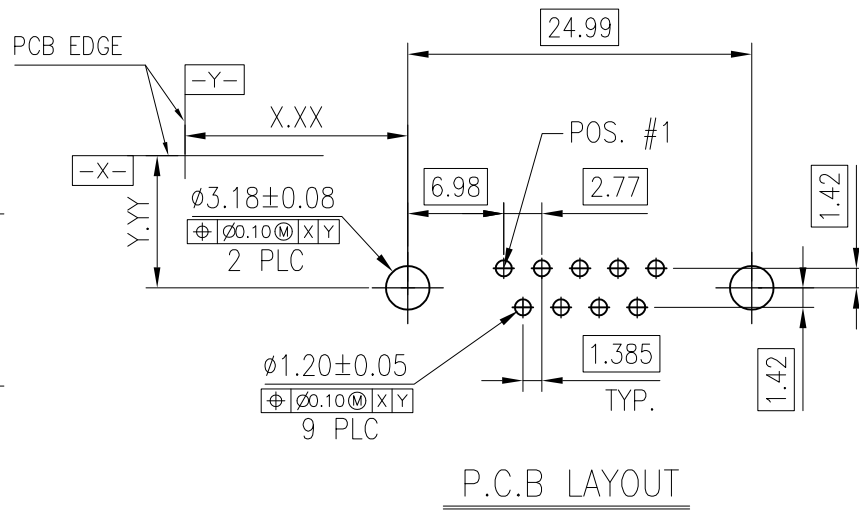
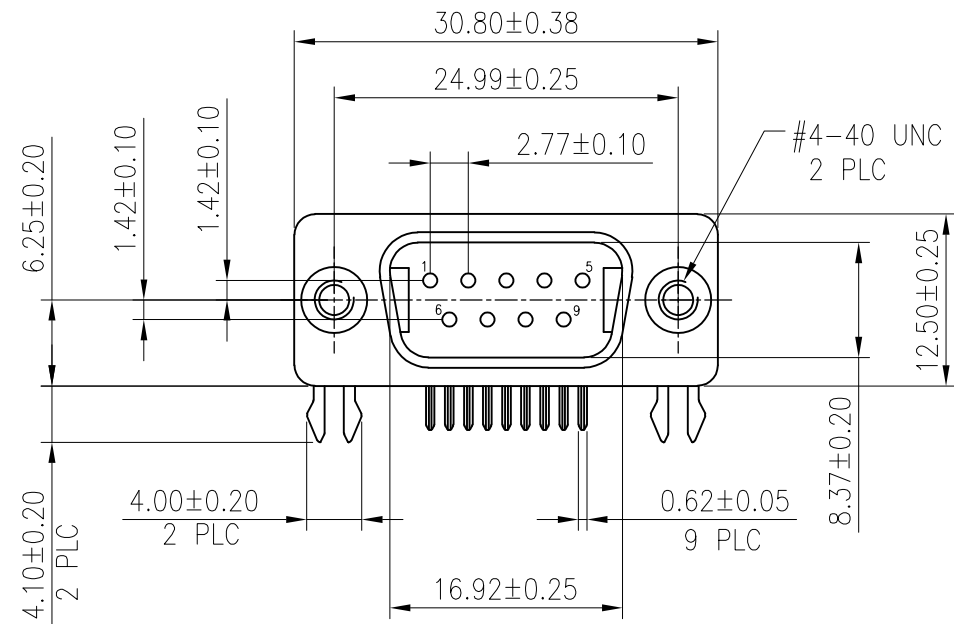

NOTES:

- MATERIAL :
  - HOUSING: THERMOPLASTIC, UL 94V-0 RATED, BLACK
  - CONTACTS: BRASS
  - SHELL: SPCC
  - BOARDLOCKS: BRASS.
  - RIVET: COPPER ALLOY
- FINISH:
  - CONTACT: GOLD PLATING ON CONTACT AREA. (SEE TABLE) 100µ" MIN. MATTE TIN PLATING ON SOLDER TAIL AREA, 50µ" MIN. NICKEL UNDERPLATING OVERALL,
  - BOARDLOCK: 100µ" MIN MATTE TIN PLATING 50µ" MIN NICKEL UNDERPLATING OVERALL,
  - SHELL: NICKEL PLATED
  - RIVET: NICKEL PLATING OVERALL
- RECOMMENDED PCB THICKNESS: 1.6 MM
- WAVE SOLDER CAPABLE TO 265°C PER TE CONNECTIVITY SPEC. 109-202, CONDITION B.
- NET WEIGHT: 7.03 gram/pc
- DATE CODE: YYWW
- THE SCREW TORQUE FORCE APPLIED: 7.0 kgf-cm MIN. (OR 6.0 lb-in MIN.)

OBSOLETE	TUBE	10u"	1734352-4
	TRAY	10u"	1734352-3
	TRAY	15u"	1734352-2
	TRAY	GOLD FLASH	1734352-1
PACKAGING	CONTACT FINISH MIN.		PART NO.

THIS DRAWING IS A CONTROLLED DOCUMENT.		DWN	J. LEE	24OCT2005	TE Connectivity		
DIMENSIONS: MM		CHK	S. HOU	24OCT2005			
TOLERANCES UNLESS OTHERWISE SPECIFIED:		APVD	W.J. KE	24OCT2005	PRODUCT SPEC 108-57541		
0 PLC ± 0.5 1 PLC ± 0.3 2 PLC ± 0.2 3 PLC ± 0.15 4 PLC ± - ANGLES ± 3°		QUALIFICATION TEST REPORT		SIZE CAGE CODE DRAWING NO RESTRICTED TO 501-57623 A3 00779 C=1734352 -			
MATERIAL SEE NOTE		FINISH SEE NOTE					WEIGHT SEE NOTE
CUSTOMER DRAWING					SCALE	SHEET	REV
					-	1 OF 3	A1

4

3

2

1

THIS DRAWING IS UNPUBLISHED.

RELEASED FOR PUBLICATION

- . - .

ALL RIGHTS RESERVED.

© COPYRIGHT - BY -

LOC  
DWDIST  
/

REVISIONS

P	LTR	DESCRIPTION	DATE	DWN	APVD
-	-	SEE SHEET 1.	-	-	-

NOTES:

- MATERIAL:
  - 1.1 TRAY: PVC
  - 1.2 SHIPPING CARTON: CORRUGATED FIBERBOARD
- DIMENSION:
  - 2.1 TRAY: L=340, W=228, H=17.4
  - 2.2 SHIPPING CARTON: L=440, W=321, H=150
- QUANTITY:
  - 3.1 PRIMARY PACKING: 90 PCS/TRAY
  - 3.2 SECONDARY PACKING: 11 TRAY/CARTON (990PCS)
- CARTON WEIGHT:
  - 4.1 NET WEIGHT: 6.96 KG
  - 4.2 GROSS WEIGHT: 7.96 KG

COVER

TRAY

CARTON

440

321

150

THIS DRAWING IS A CONTROLLED DOCUMENT.		DWN		TE Connectivity	
DIMENSIONS: MM		CHK			
		APVD		NAME	
TOLERANCES UNLESS OTHERWISE SPECIFIED: 0 PLC ± - 1 PLC ± - 2 PLC ± - 3 PLC ± - 4 PLC ± - ANGLES ± -		PRODUCT SPEC		PLUG ASSEMBLY, 9 POSN, RIGHT ANGLE, 8.08mm[0.318in]	
MATERIAL		FINISH		SIZE	
				CAGE CODE	
				DRAWING NO	
				RESTRICTED TO	
		WEIGHT		A3 00779	
		CUSTOMER DRAWING		C=1734352	
		SCALE		SHEET	
		-		2 OF 3	
				REV A1	

1470-19 (3/11)

4

3

2

1

THIS DRAWING IS UNPUBLISHED.

RELEASED FOR PUBLICATION

- . - .

ALL RIGHTS RESERVED.

© COPYRIGHT - BY -

LOC

DIST

REVISIONS

DW

P

LTR

DESCRIPTION

DATE

DWN

APVD

SEE SHEET 1.

NOTES:

1. MATERIAL:
  - 1.1 TUBE: PVC
  - 1.2 SHIPPING CARTON: CORRUGATED FIBERBOARD
2. DIMENSION:
  - 2.1 TUBE: L=650, W=18.8, H=18.6
  - 2.2 SHIPPING CARTON: L=680, W=320, H=200
3. QUANTITY:
  - 3.1 PRIMARY PACKING: 20 PCS/TUBE
  - 3.2 SECONDARY PACKING: 50 TUBE/BOX
  - 3.3 THIRD PACKING: 2 BOX/CARTON (2,000PCS)
4. CARTON WEIGHT:
  - 4.1 NET WEIGHT: 17.0 KG
  - 4.2 GROSS WEIGHT: 18.0 KG

THIS DRAWING IS A CONTROLLED DOCUMENT.

DWN

CHK

APVD

PRODUCT SPEC

APPLICATION SPEC

WEIGHT

CUSTOMER DRAWING

**STE**

TE Connectivity

NAME

PLUG ASSEMBLY, 9 POSN,  
RIGHT ANGLE, 8.08mm[0.318in]

SIZE

CAGE CODE

DRAWING NO

RESTRICTED TO

A3

00779

C=1734352

SCALE

SHEET

3 OF 3

REV

A1

DIMENSIONS:

MM

TOLERANCES UNLESS  
OTHERWISE SPECIFIED:

0 PLC	± -
1 PLC	± -
2 PLC	± -
3 PLC	± -
4 PLC	± -
ANGLES	± -
FINISH	-

MATERIAL

1470-19 (3/11)