

Distributed by:

JAMECO[®]
ELECTRONICS

www.Jameco.com ♦ 1-800-831-4242

The content and copyrights of the attached
material are the property of its owner.

Jameco Part Number 742776

LOG		DISTR		REV		ZONE		LTR		REVISIONS		DATE	APPR
CM	54									F	REV PER EC 0730-4050-93	1-21-89	RS

1. ACCEPTS CONTACT P/N 770601-1.
2. DIMENSIONS IN BRACKETS ARE IN INCHES.
3. ACCEPTS MTA-100 KEYING PLUG P/N 641994-1.

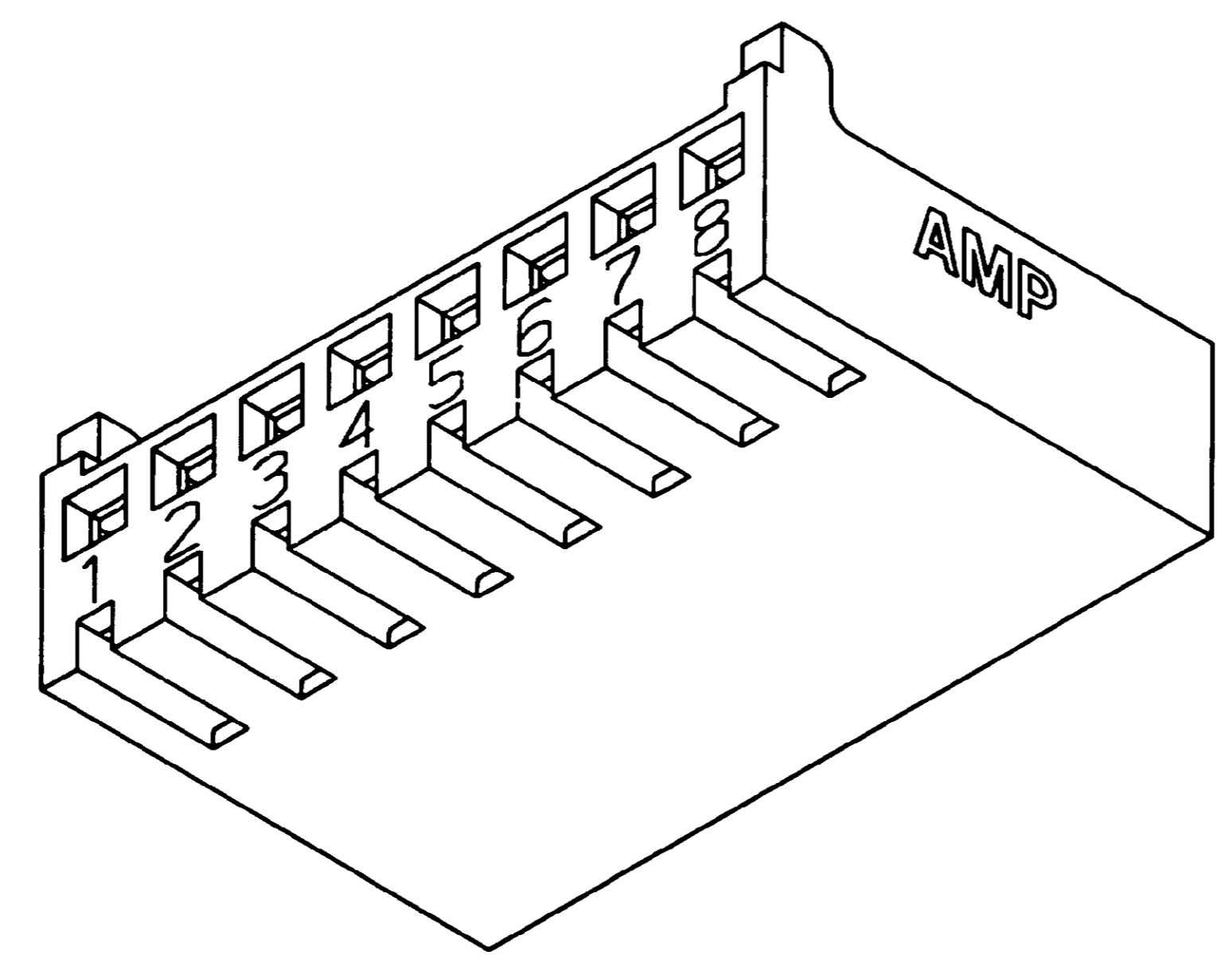
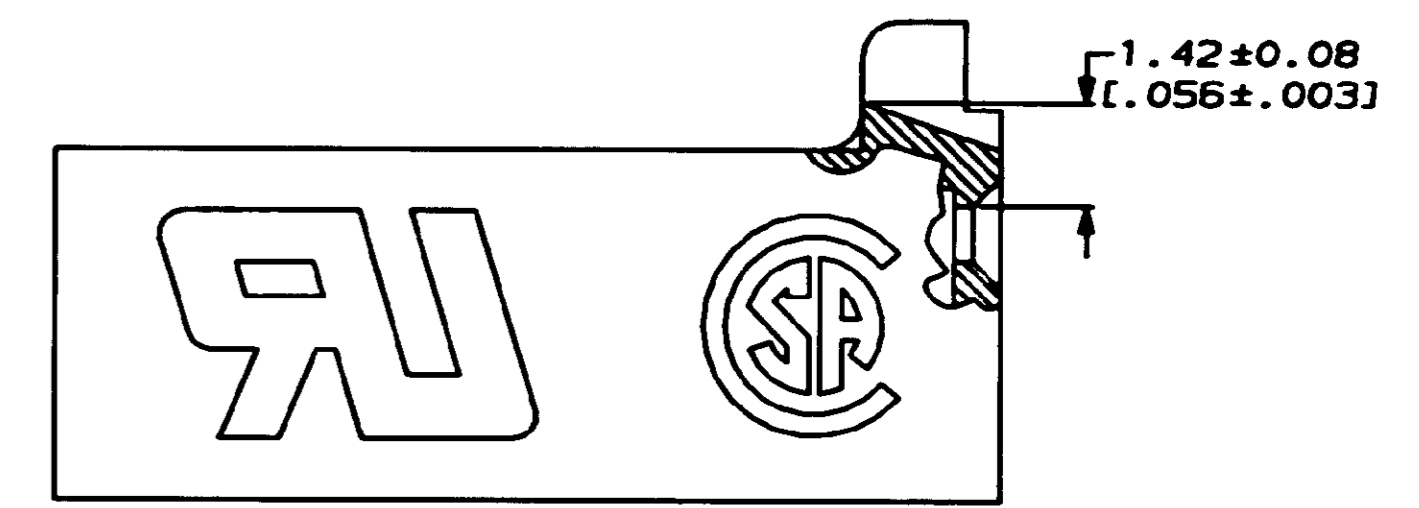
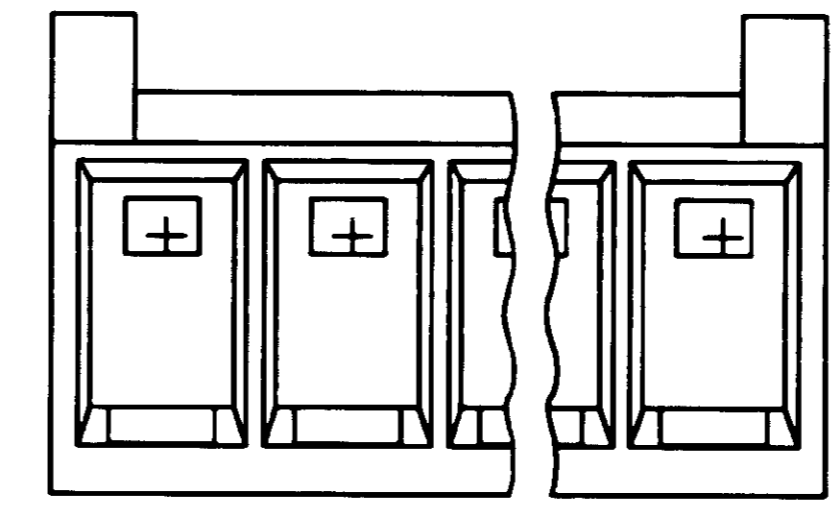
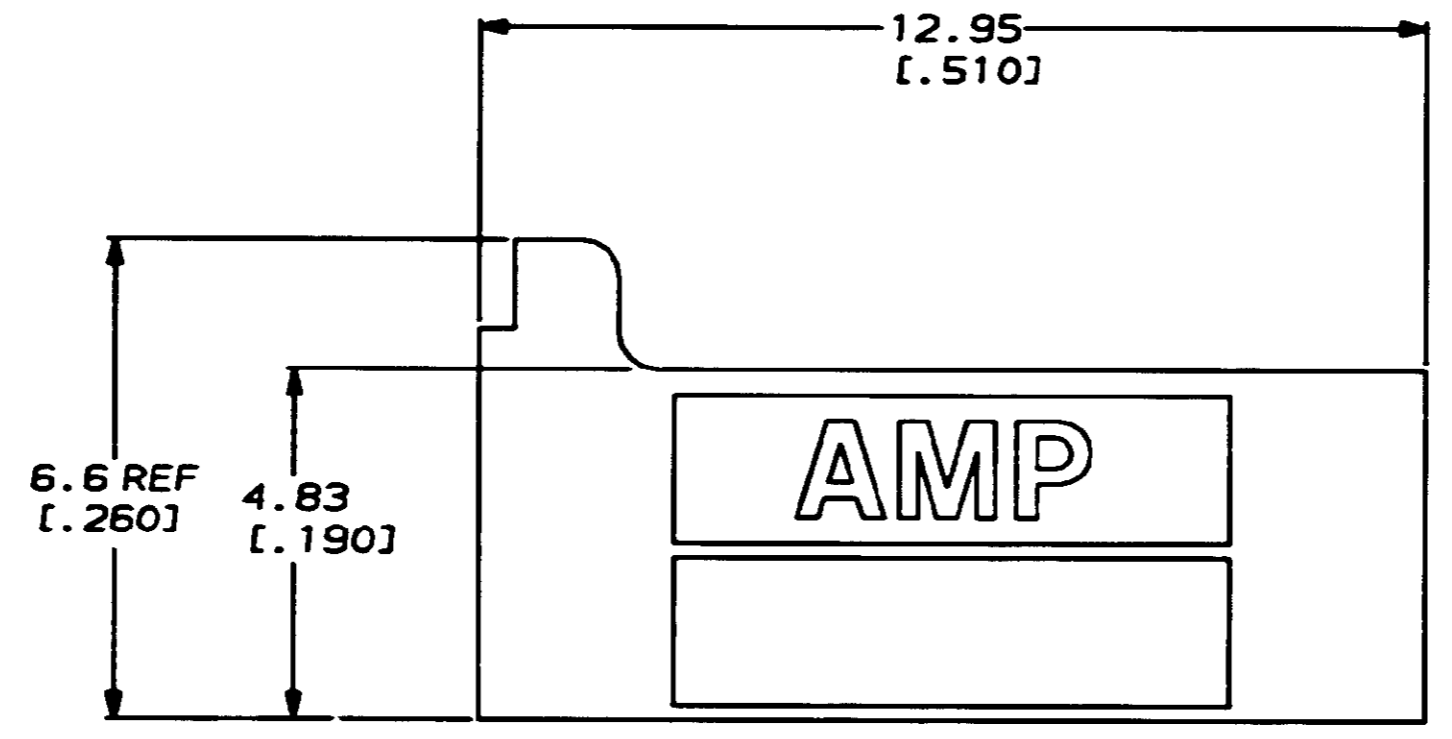
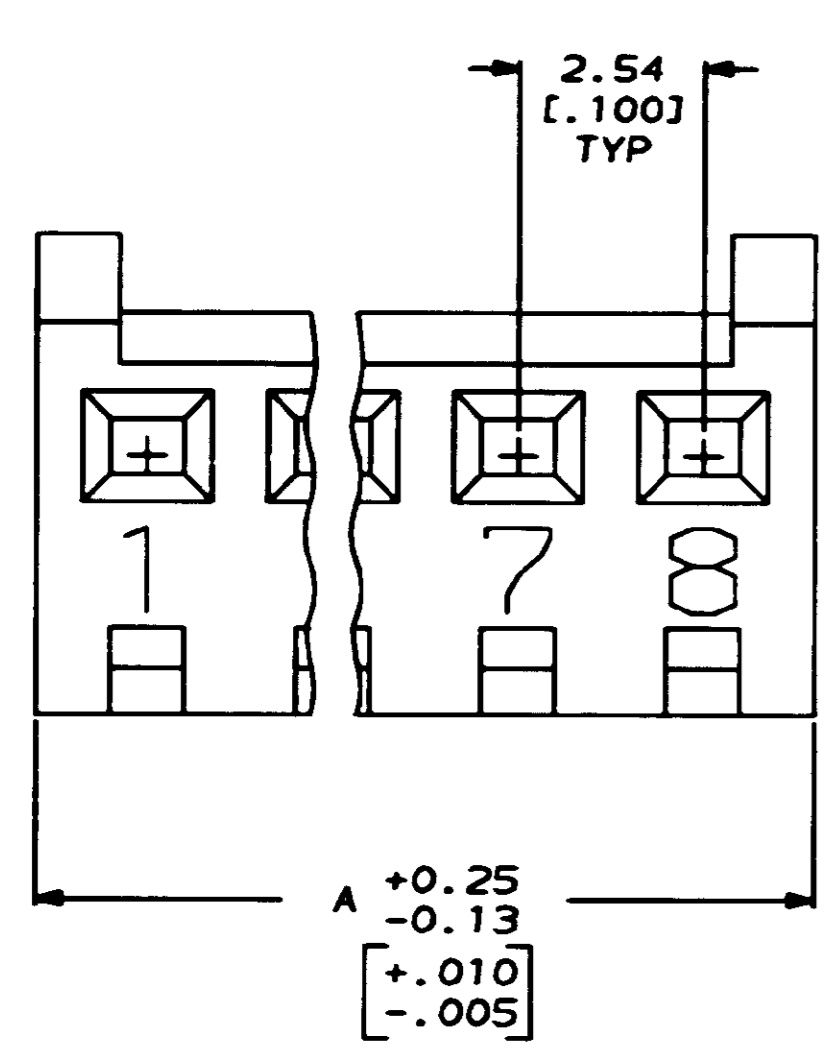

3-DIMENSIONAL MODEL
NTS

2.820	71.63	28	2-770602-8
2.720	69.09	27	2-770602-7
2.620	66.55	26	2-770602-6
2.520	64.01	25	2-770602-5
2.420	61.47	24	2-770602-4
2.320	58.93	23	2-770602-3
2.220	56.39	22	2-770602-2
2.120	53.85	21	2-770602-1
2.020	51.31	20	2-770602-0
1.920	48.77	19	1-770602-9
1.820	46.23	18	1-770602-8
1.720	43.69	17	1-770602-7
1.620	41.15	16	1-770602-6
1.520	38.61	15	1-770602-5
1.420	36.07	14	1-770602-4
1.320	33.53	13	1-770602-3
1.220	30.99	12	1-770602-2
1.120	28.45	11	1-770602-1
1.020	25.91	10	1-770602-0
.920	23.37	9	770602-9
.820	20.83	8	770602-8
.720	18.29	7	770602-7
.620	15.75	6	770602-6
.520	13.21	5	770602-5
.420	10.67	4	770602-4
.320	8.13	3	770602-3
.220	5.59	2	770602-2
IN	MM	NO. OF	PART NUMBER
A		CIRCUITS	

DO NOT SCALE PRINT. UNLESS SPECIFIED DIMENSIONS IN MM (INCHES)		DR	PART NO	
TOLERANCES ON:		C. MARTIN 10-4-89	AMP AMP INCORPORATED Harrisburg, Pa. 17105	
2 PLC DEC ±		CHK R. SWINE 10-4-89		
3 PLC DEC 0±13 (.005)		APPR M. SHORE 10-4-89		
ANGLES ±		APPR M. SHORE 10-4-89		
MATERIAL		PRODUCT SPEC	NAME	
NYLON, UL 94V-0 NATURAL			HOUSING, CST-100	
FINISH		APPLICATION SPEC	SIZE	CASE CODE
			D	00779
		WEIGHT	SCALE	DRAWING NO
			10:1	770602
				SHEET 1 OF 1

METRIC

JVC BUILDING GROUP 3525 177-54 7416 BALTIMORE