

2007198-1 Product Details

[Share](#) [Print](#) [Email](#)



2007198-1

TE Internal Number: 2007198-1

 Active

[View 3D PDF](#)

Pluggable Connectors, Cages & Accessories

 Always EU RoHS/ELV Compliant (Statement of Compliance)

Product Highlights:

- SFP+ Product Line
- Cage
- SFP+ Application
- Cage Type = Single
- For Use With SFP+ SMT Connector

[View all Features](#)

Quick Links

- ▶ [Pricing & Availability](#)
- ▶ [Search for Tooling](#)
- ▶ [View Connectors \(2\)](#)
- ▶ [View Dust Cap/Plugs \(3\)](#)
- ▶ [View Cable Assemblies \(4\)](#)
- ▶ [Product Feature Selector](#)
- ▶ [Contact Us About This Product](#)

[Add to My Part List](#)

[Request Sample](#)

[Find Similar Products](#)

[Buy Product](#)

Documentation & Additional Information

Product Drawings:

- [SFP+ 1X1 CAGE ASSEMBLY, PRESS-FIT PRESS-FIT, EMI SPRINGS \(PDF, English\)](#)

Catalog Pages/Data Sheets:

- [1-1773717-7_PLUGGABLE_IO_QRG_CN \(PDF, English\)](#)
- [1-1773717-8_PLUGGABLEIO_QRG_TCN \(PDF, English\)](#)
- [1-1773717-9_HIGH_SPEED_IO_QRG_JA \(PDF, English\)](#)
- [1773408-1 Pluggable Input/Output Solutions catalog -... \(PDF, English\)](#)
- [SFP+ Product Family: Cages, Connectors, Cable Assemb... \(PDF, English\)](#)
- [4-1773455-2 - Quick Reference Guide Pluggable I/O So... \(PDF, English\)](#)
- [4-1773455-3 - Quick Reference Guide SFP+ Solutions \(PDF, English\)](#)

Product Specifications:

- [Single Port SFP+ Cages, Ganged SFP+ Cages, and SFP+ ... \(PDF, English\)](#)

Application Specifications:

- [Small Form-Factor Pluggable \(SFP\), SFP+, and zSFP+ S... \(PDF, English\)](#)

Instruction Sheets:

- None Available

CAD Files: (CAD Format & Compression Information)

- [2D Drawing \(DXF, Version B\)](#)
- [3D Model \(IGES, Version B\)](#)
- [3D Model \(STEP, Version B\)](#)

[List all Documents](#)

Related Products:

- [Tooling](#)
- [Connectors \(2\)](#)
- [Dust Cap/Plugs \(3\)](#)
- [Cable Assemblies \(4\)](#)

Product Features (Please use the Product Drawing for all design activity)

Product Type Features:

- Product Line = SFP+
- Product Type = Cage
- Termination Method to PC Board = Press-Fit

Mechanical Attachment:

- PCB Mount = Double Sided (Belly-to-Belly)

Electrical Characteristics:

- Data Signal Rate (Gb/s) = Up to 16

Termination Features:

- Tail Length (mm [in]) = 2.05 [0.081]

Dimensions:

- PCB Thickness, Recommended (mm [in]) = 2.25 [0.089]
- Length (X-Axis) (mm [in]) = 48.70 [1.917]
- Width (Z-Axis) (mm [in]) = 14.50 [0.570]
- Profile Height (Y-Axis) (mm [in]) = 9.70 [0.3818]

Housing Features:

- Cage Type = Single
- Cage Material = Nickel Silver

Configuration Features:

- Port Configuration = Single Port
- Lightpipe = Without
- EMI Containment = External Springs

Industry Standards:

- [RoHS/ELV Compliance](#) = RoHS compliant, ELV compliant
- [Lead Free Solder Processes](#) = Not relevant for lead free process
- [RoHS/ELV Compliance History](#) = Always was RoHS compliant

Conditions for Usage:

- [For Use With](#) = SFP+ SMT Connector
- Applies To = Printed Circuit Board

Operation/Application:

- [Application](#) = SFP+
- Heat Sink Application = No

Packaging Features:

- Packaging Method = Tray

Other:

- Brand = TE Connectivity

LOC	DIST	REVISIONS					
GP	00	P	LTN	DESCRIPTION	DATE	DMN	APVD
		B1		REVISED PER ECO-11-004835	11MAR2011	RK	HMR
		C		REVISED PER ECO-11-024172	07DEC2011	TX	AC
		C1		REVISED PER ECO-13-014018	09SEP2013	PP	SH

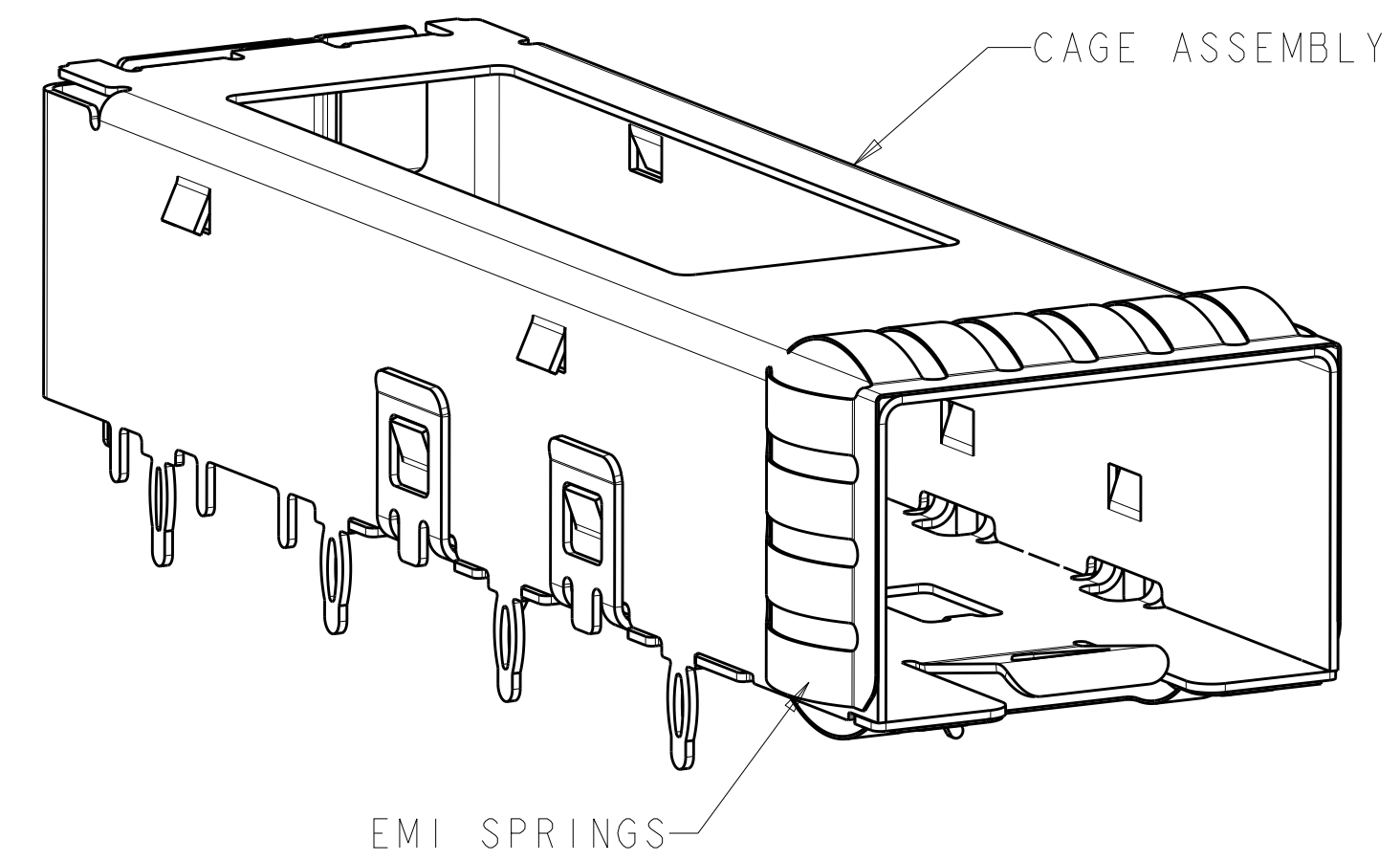

2007198-2
SCALE 5:1

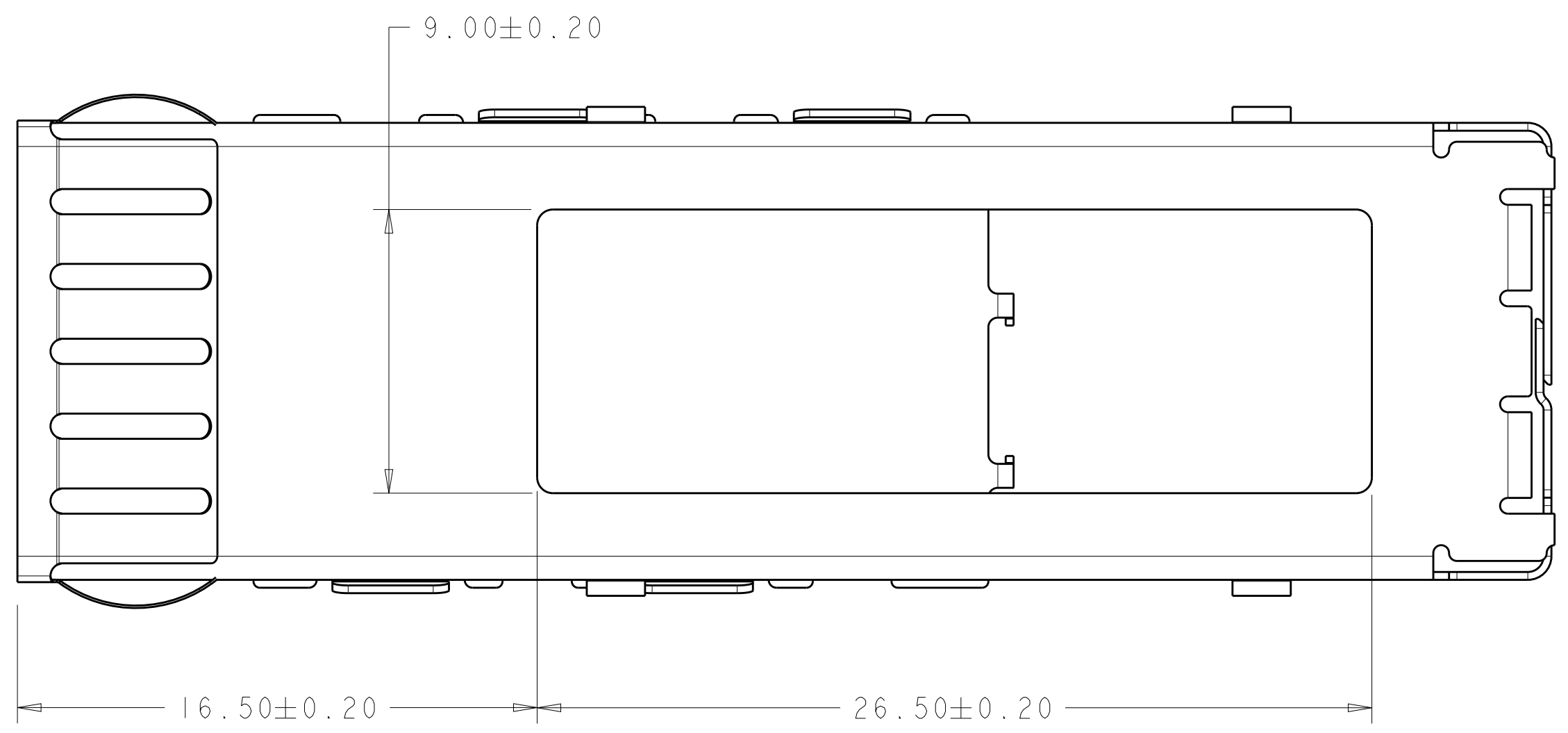

2007198-2
SAME AS 2007198-1 EXCEPT AS SHOWN
TOP VIEW

- 1 MATERIAL:
CAGE ASSEMBLY - 0.25mm THICK NICKEL SILVER ALLOY.
EMI SPRINGS - COPPER ALLOY.
- 2 FINISH
EMI SPRINGS - 0.8um MIN MATTE TIN OVER 0.8um MIN NICKEL,
NON-PLATED EDGES PERMISSIBLE.
- 3. MATES WITH SFP MSA COMPLIANT TRANSCEIVERS.
- 4 PADS AND VIAS CHASSIS GROUND.
- 5 DATUM AND BASIC DIMENSION ESTABLISHED BY CUSTOMER.
- 6. MINIMUM PC BOARD THICKNESS:
SINGLE SIDED = 1.50 mm
DOUBLE SIDED = 3.00 mm
- 7 REFERENCE APPLICATION SPEC. 114-13120, HOLE A, FOR
RECOMMENDED DRILL HOLE DIAMETER AND PLATING THICKNESS.
- 8 REFERENCE APPLICATION SPEC. 114-13120, HOLE C, FOR
RECOMMENDED DRILL HOLE DIAMETER AND PLATING THICKNESS.
- 9. NOTE DELETED

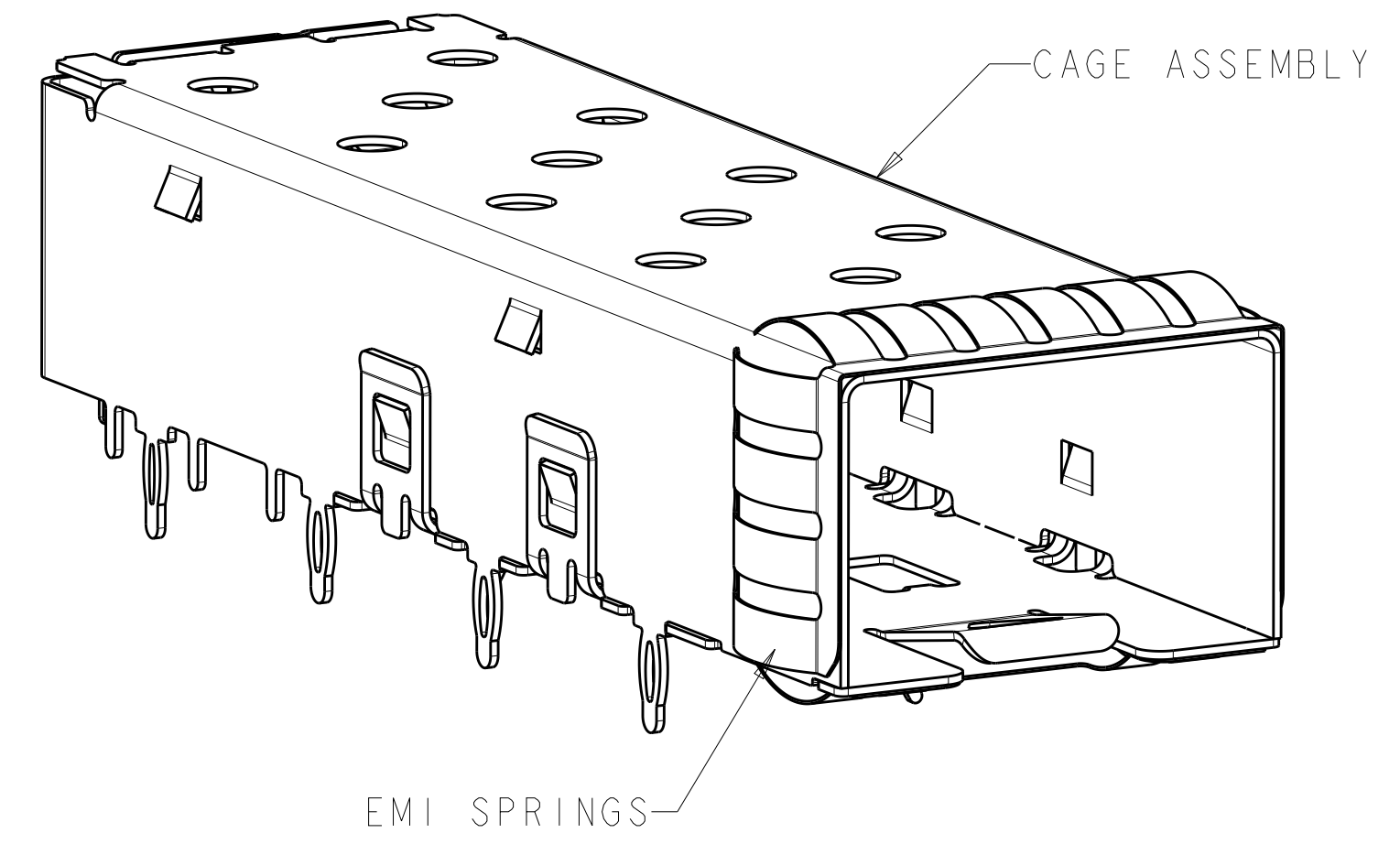

2007198-1
SCALE 5:1

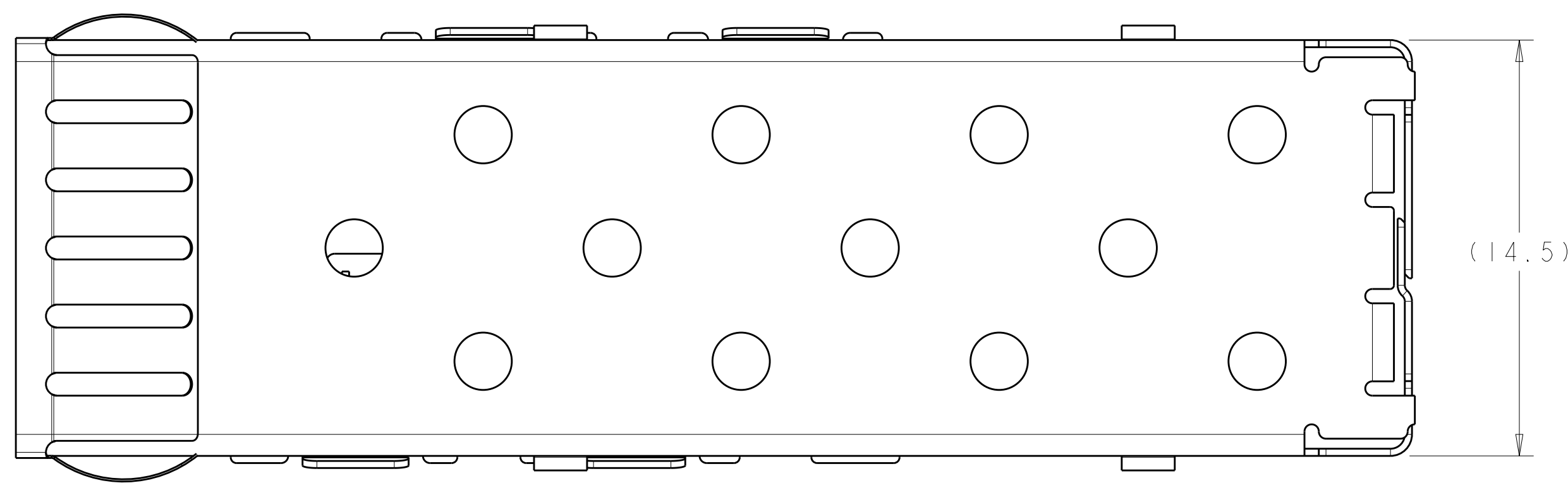

2007198-1
TOP VIEW

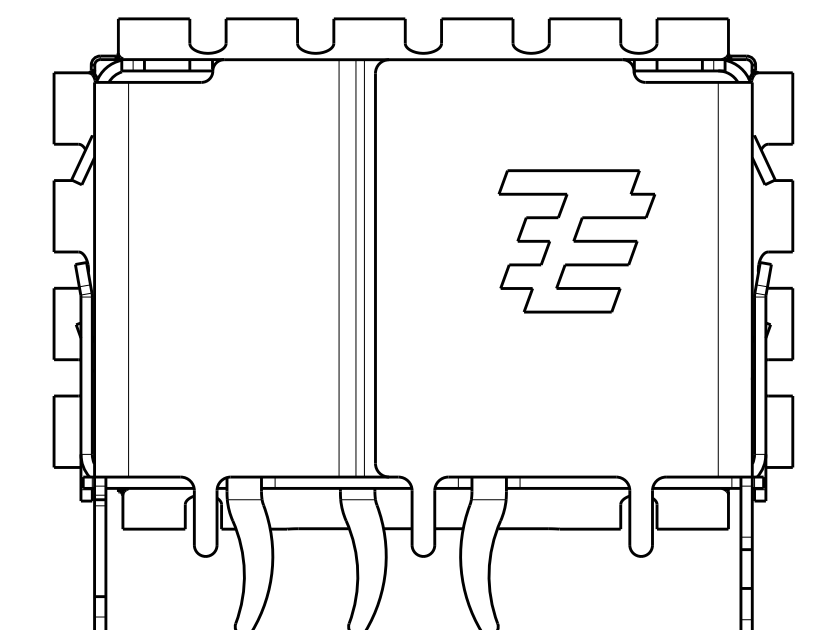
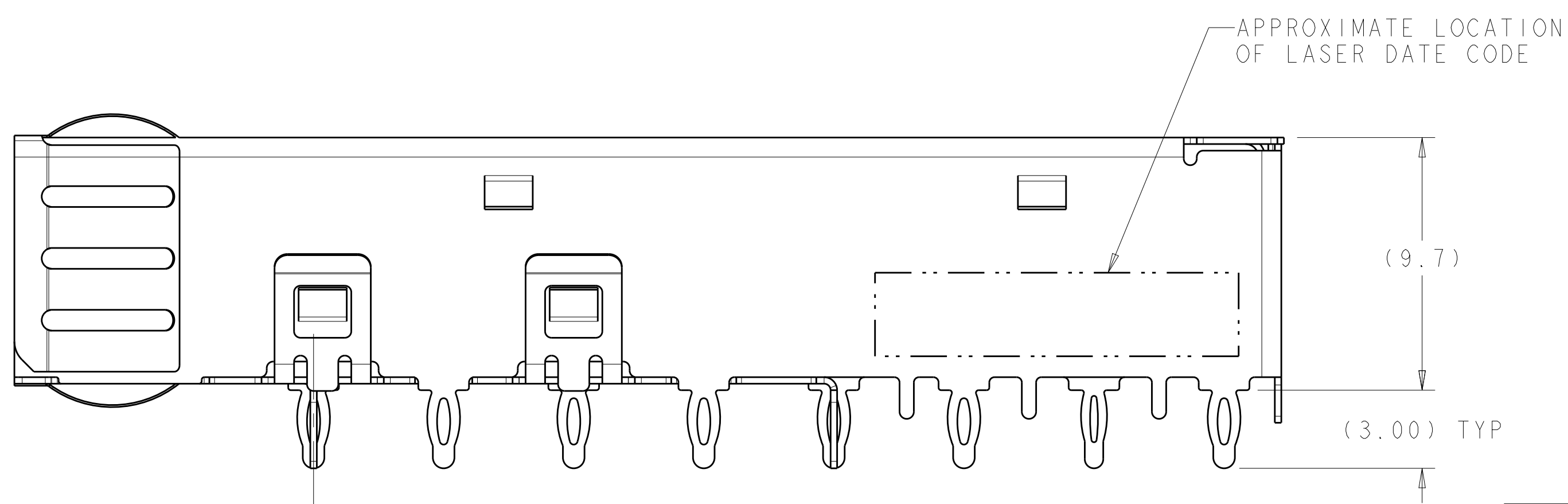
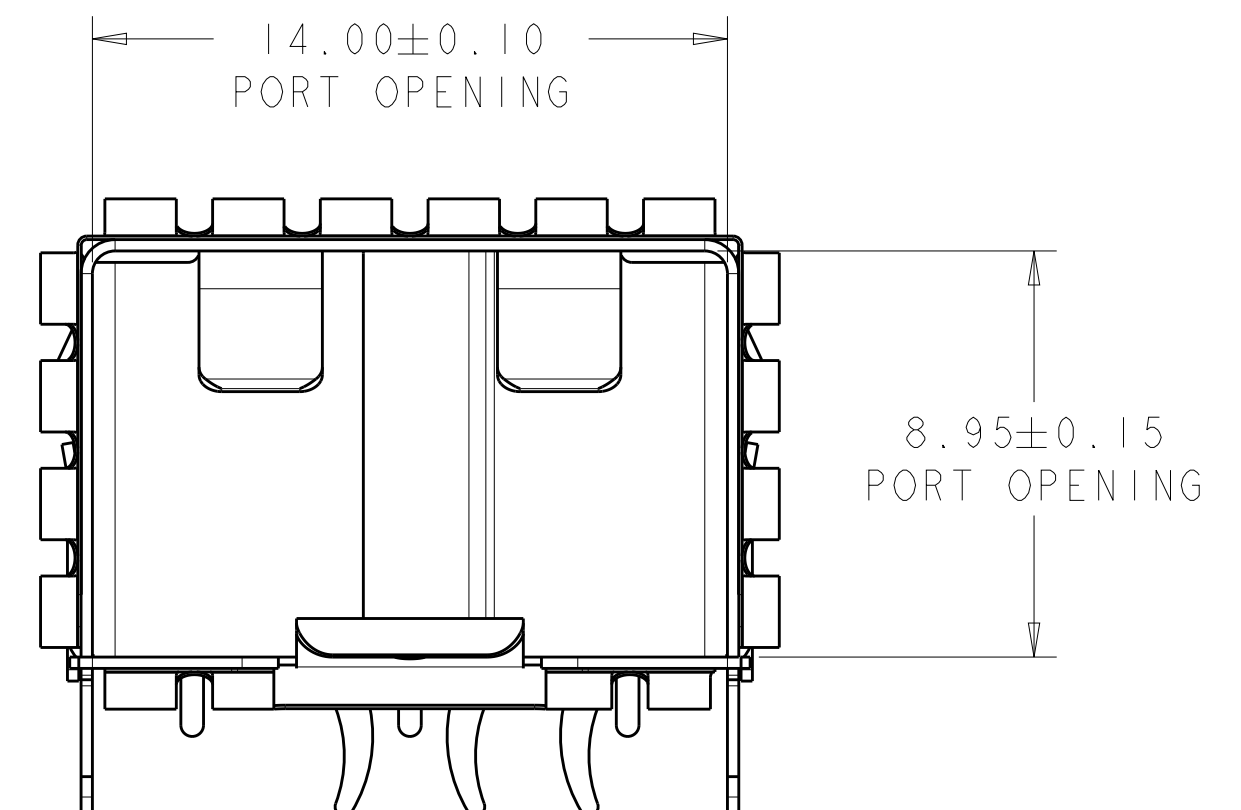

INSULATING TAPE	DESCRIPTION	PART NUMBER
W/ INSULATING TAPE	EMI HOLES	2007198-5
W/O INSULATING TAPE	HEATSINK OPENING	2007198-2
W/O INSULATING TAPE	EMI HOLES	2007198-1

THIS DRAWING IS A CONTROLLED DOCUMENT.

DIMENSIONS:	TOLERANCES UNLESS OTHERWISE SPECIFIED:	DMN M. SCHMITT 07JUN07	
mm	0 PLC ±0.1	CHK M. SCHMITT 07JUN07	
	1 PLC ±0.5	APVD B. WERTZ 07JUN07	
	2 PLC ±0.5		
	3 PLC ±0.5	NAME	SFP+ 1X1 CAGE ASSEMBLY, PRESS-FIT PRESS-FIT, EMI SPRINGS
	4 PLC ±0.13	PRODUCT SPEC	108-2364
	ANGLES ±0.13	APPLICATION SPEC	114-13120
MATERIAL	FINISH	SIZE CAGE CODE DRAWING NO	RESTRICTED TO
		A100779C=2007198	
		WEIGHT	
		Customer Drawing	SCALE 2:1 SHEET 1 OF 4 REV C1

LOC	DIST	REVISIONS			
P	LTN	DESCRIPTION	DATE	DMN	APVD
GP	00	SEE SHEET 1	-	-	-

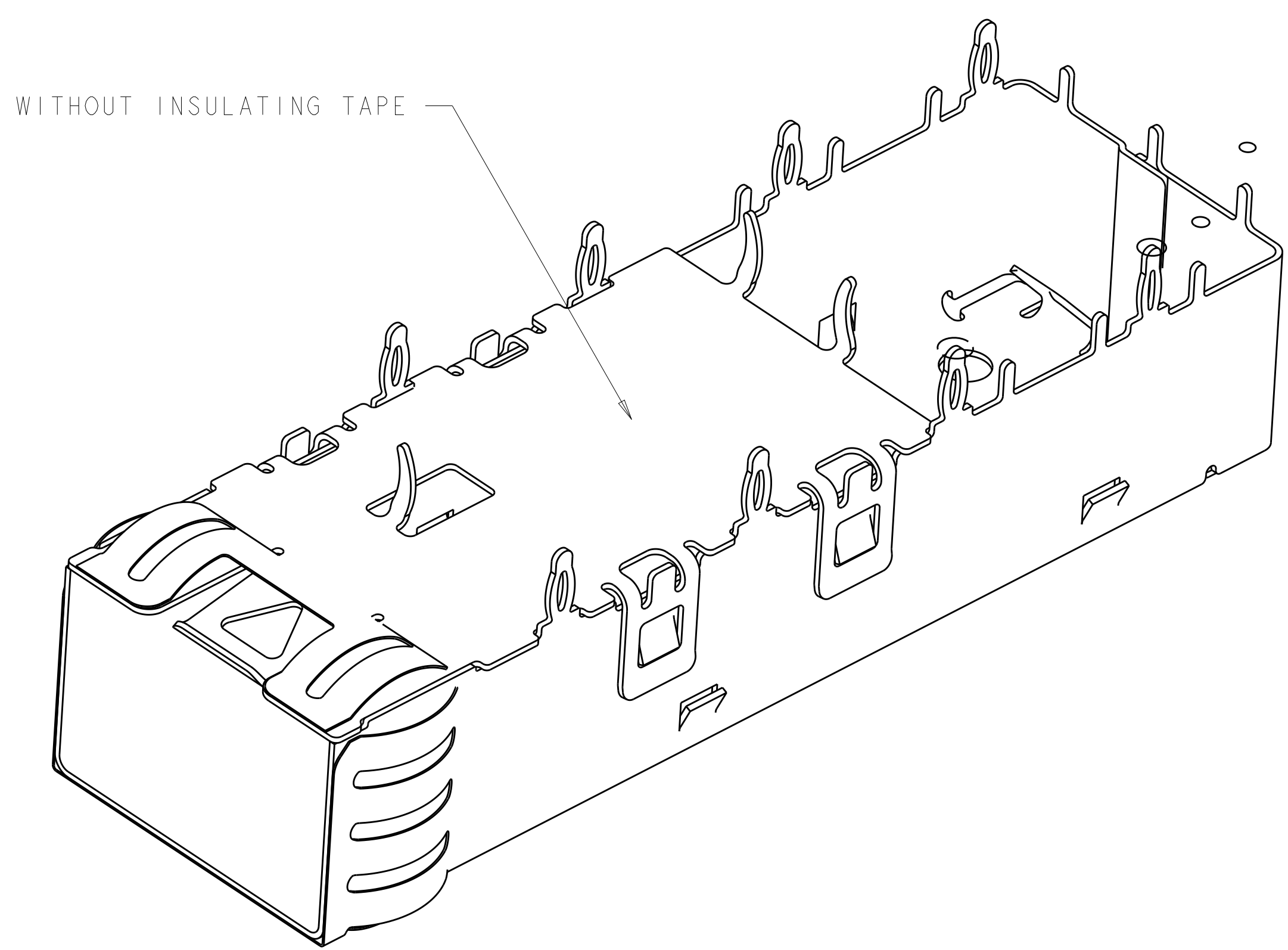

2007198-1,2 AS SHOWN WITHOUT INSULATING TAPE

WITH INSULATING TAPE

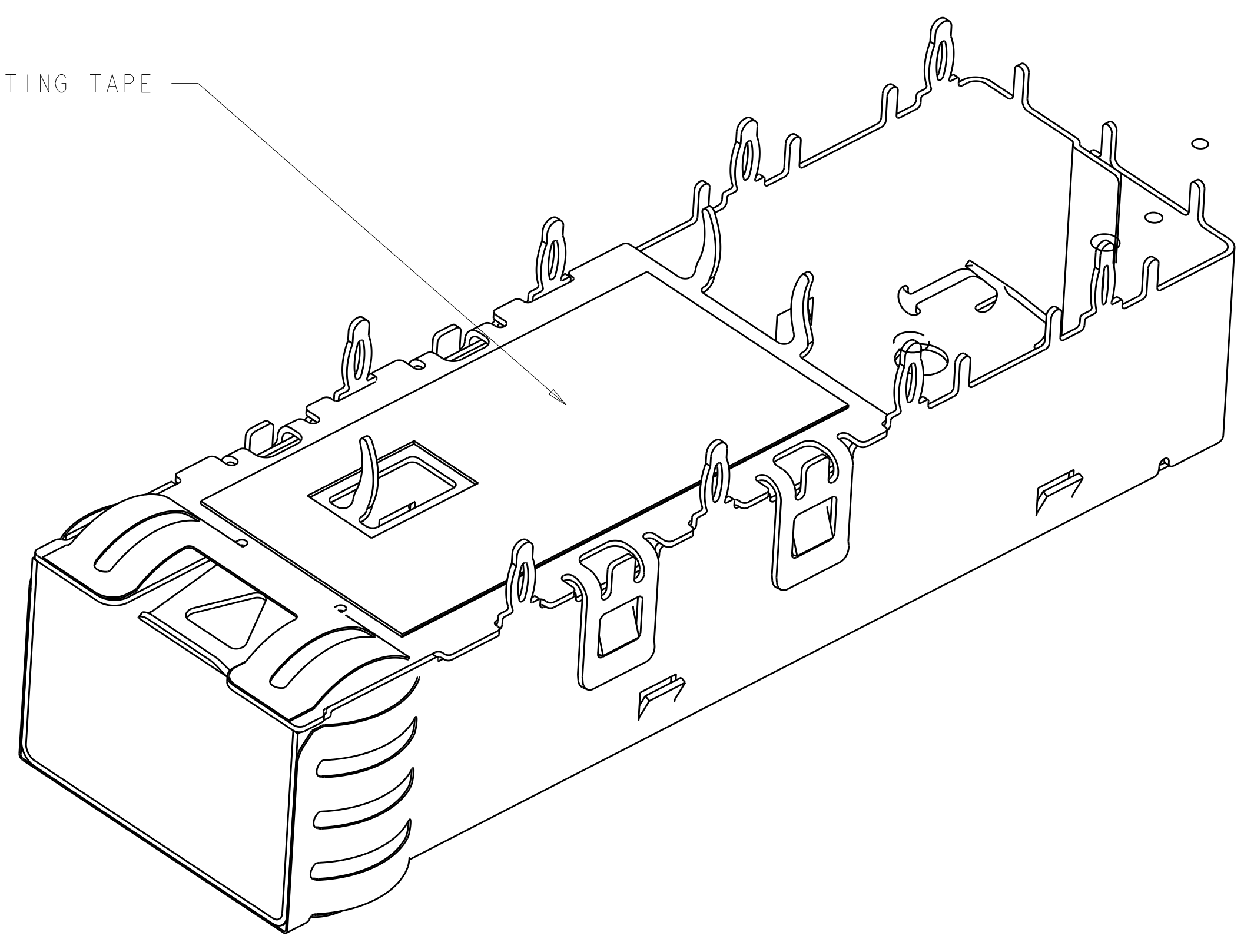

2007198-5 AS SHOWN WITH INSULATING TAPE

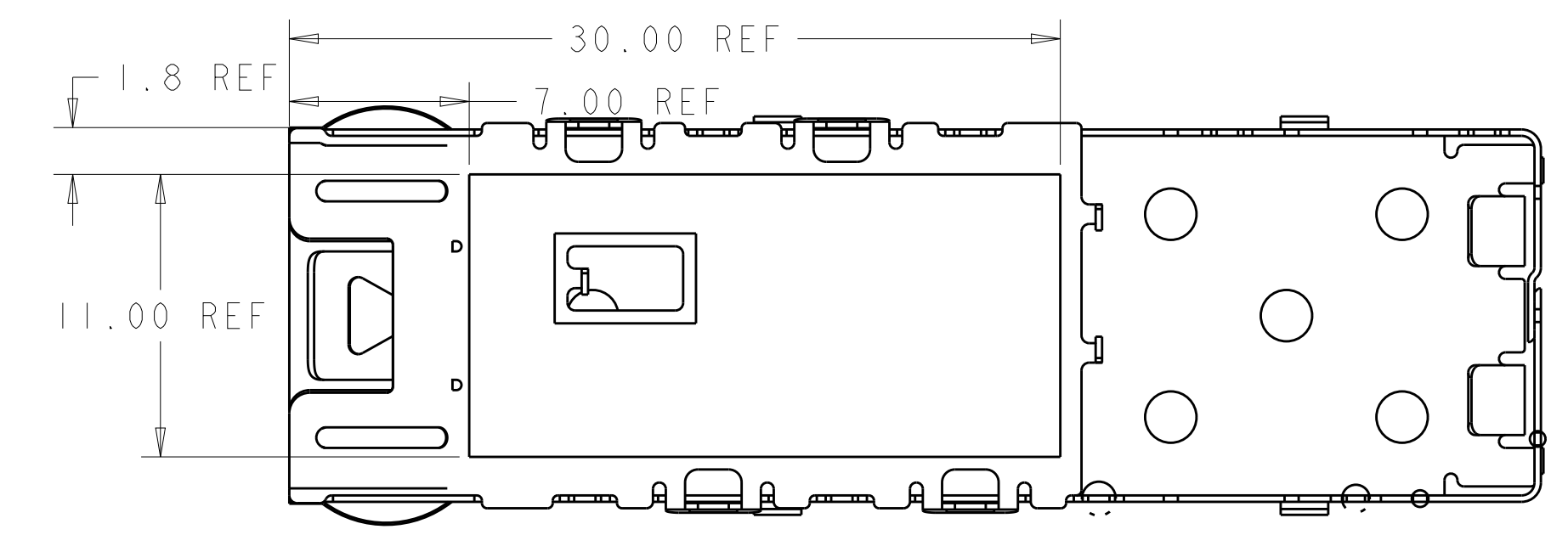

SCALE 4:1
 2007198-5 AS SHOWN THE LOCATION OF THE TAPE

THIS DRAWING IS A CONTROLLED DOCUMENT.		DMN M. SCHMITT 07JUN07	STE TE Connectivity
DIMENSIONS: mm		CHK M. SCHMITT 07JUN07	
TOLERANCES UNLESS OTHERWISE SPECIFIED:		APVD B. WERTZ 07JUN07	NAME SFP+ IXI CAGE ASSEMBLY, PRESS-FIT PRESS-FIT, EMI SPRINGS
0 PLC ±0.1	1 PLC ±0.5	PRODUCT SPEC 108-2364	SIZE CAGE CODE DRAWING NO RESTRICTED TO
2 PLC ±0.5	3 PLC ±0.5	APPLICATION SPEC 114-13120	A100779C=2007198
4 PLC ±0.13	ANGLES ±0.13	WEIGHT	SCALE 2:1 SHEET 2 OF 4 REV C1
MATERIAL FINISH	Customer Drawing		

LOC	DIST	REV	DATE	BY	APPV
GP	00				

REVISIONS		DATE	BY	APPV
	SEE SHEET 1			

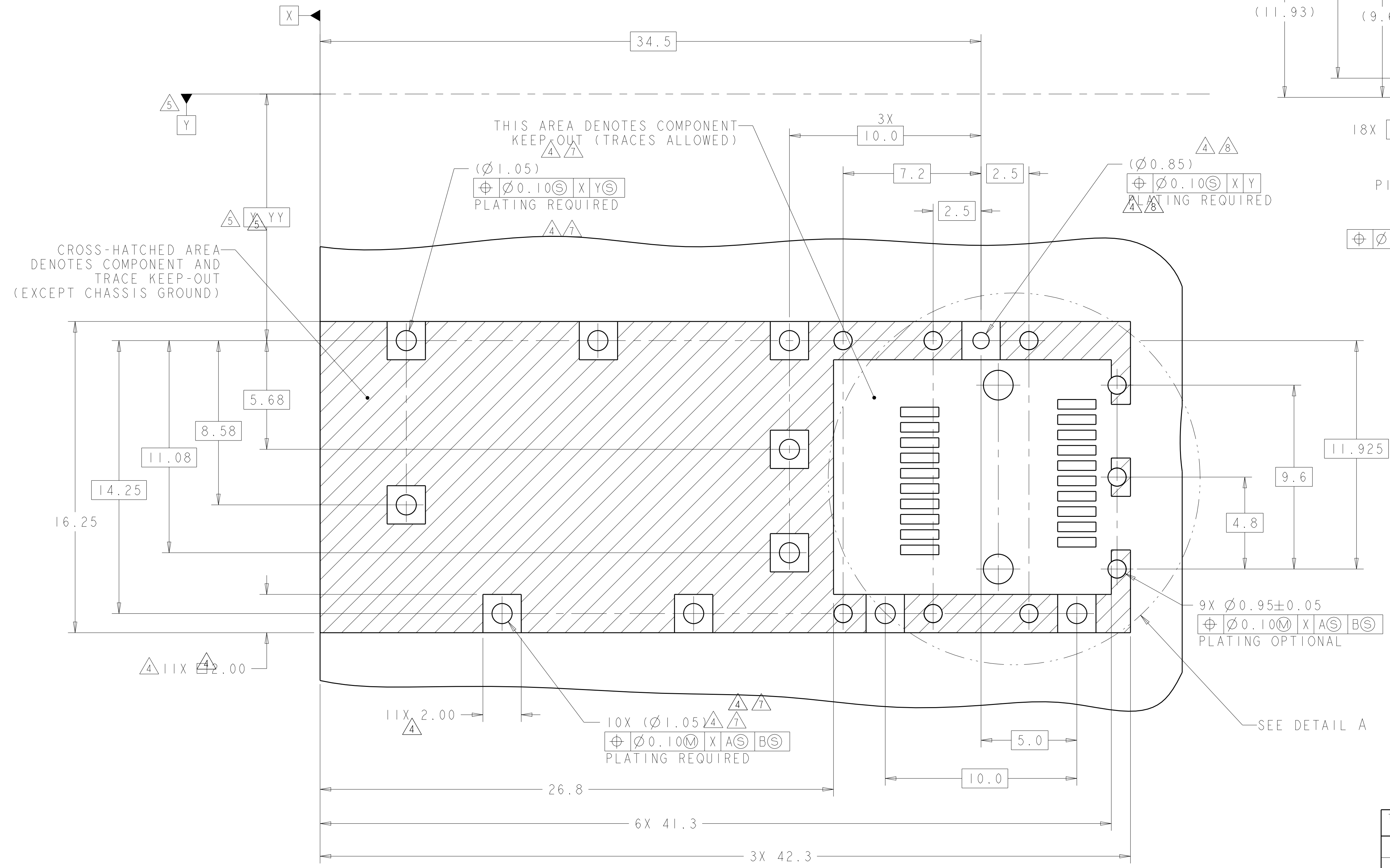
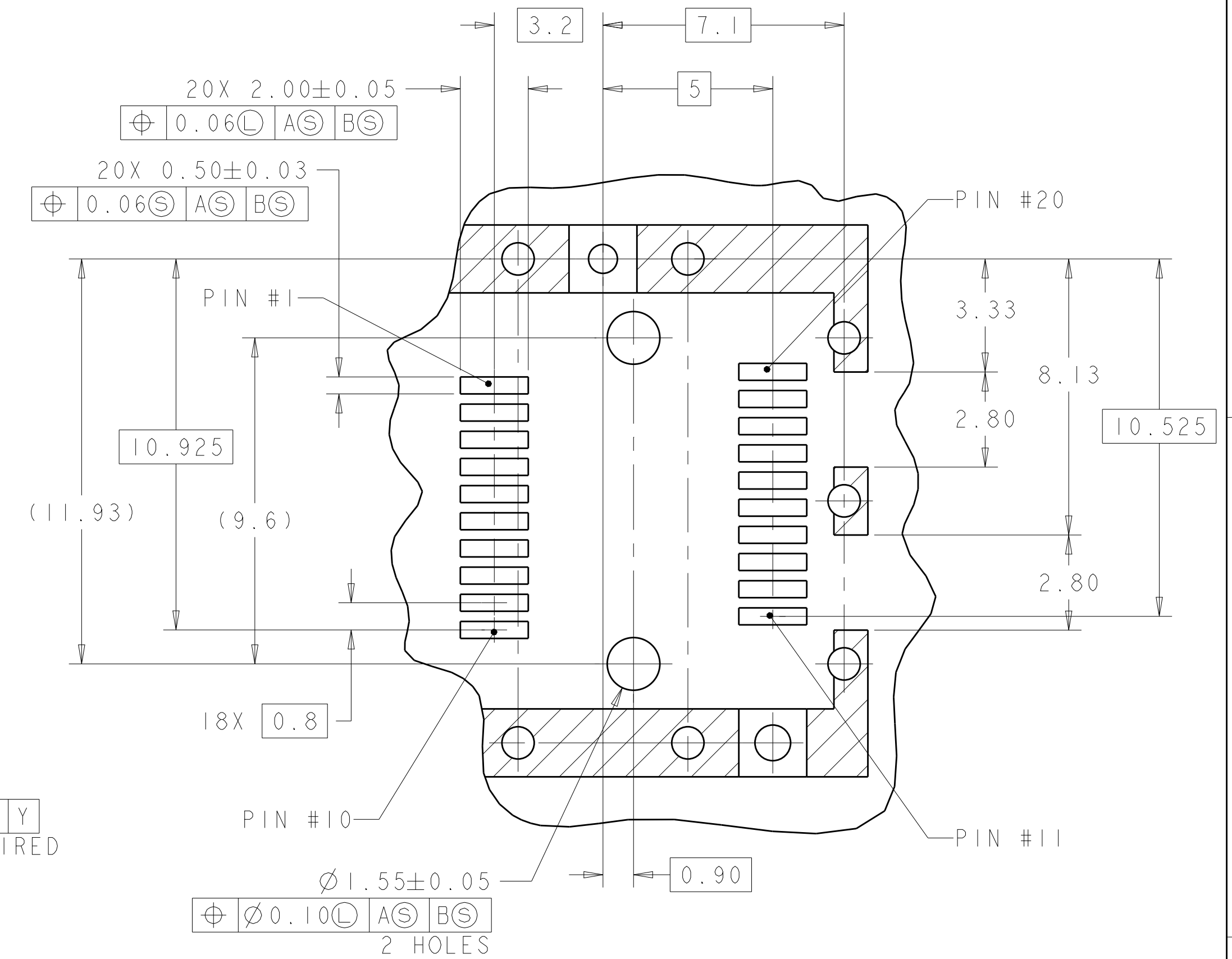
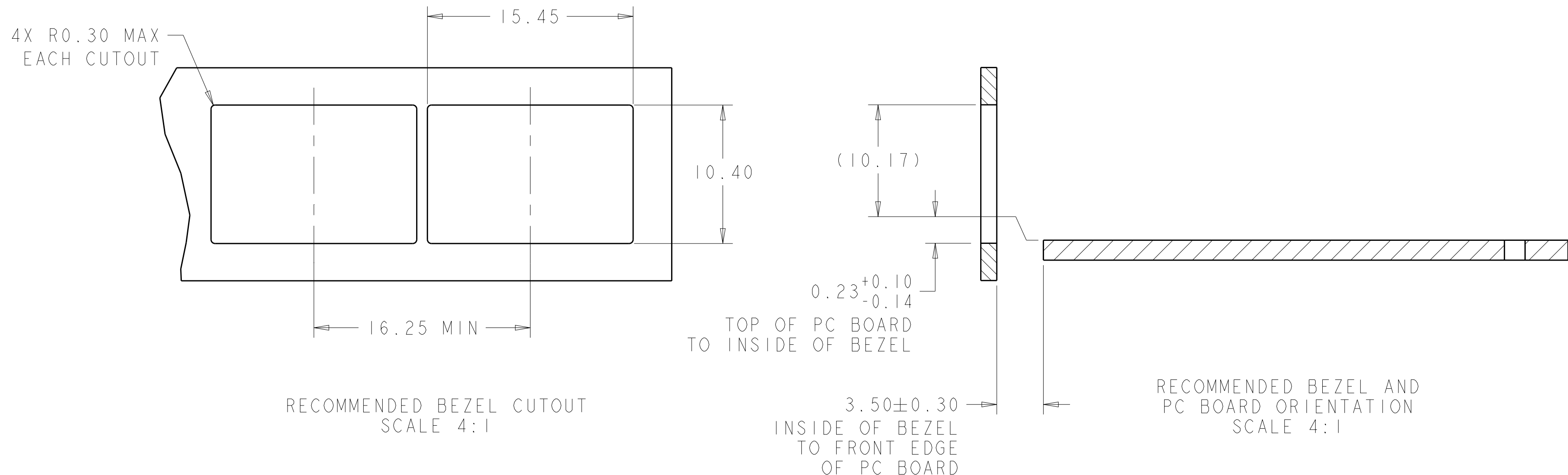

THIS DRAWING IS A CONTROLLED DOCUMENT.		OWN: M. SCHMITT 07JUN07	TE Connectivity
DIMENSIONS: mm		CHK: M. SCHMITT 07JUN07	
TOLERANCES UNLESS OTHERWISE SPECIFIED:		APV: B. WERTZ 07JUN07	NAME: SFP+ 1X1 CAGE ASSEMBLY, PRESS-FIT PRESS-FIT, EMI SPRINGS PRODUCT SPEC: 108-2364 APPLICATION SPEC: 114-13120
0 PLC ±0.1 1 PLC ±0.5 2 PLC ±0.5 3 PLC ±0.13 4 PLC ±0.13 ANGLES ±0.13		SIZE: A100779 CAGE CODE: C=2007198 WEIGHT: - Customer Drawing	
MATERIAL: FINISH:		SCALE: 2:1	RESTRICTED TO: -
		SHEET 3 OF 4	REV: C1

LOC	DIST	REV	DATE	APPD	APVD
GP	00				
P LTH		DESCRIPTION		DATE	OWN
		SEE SHEET 1			

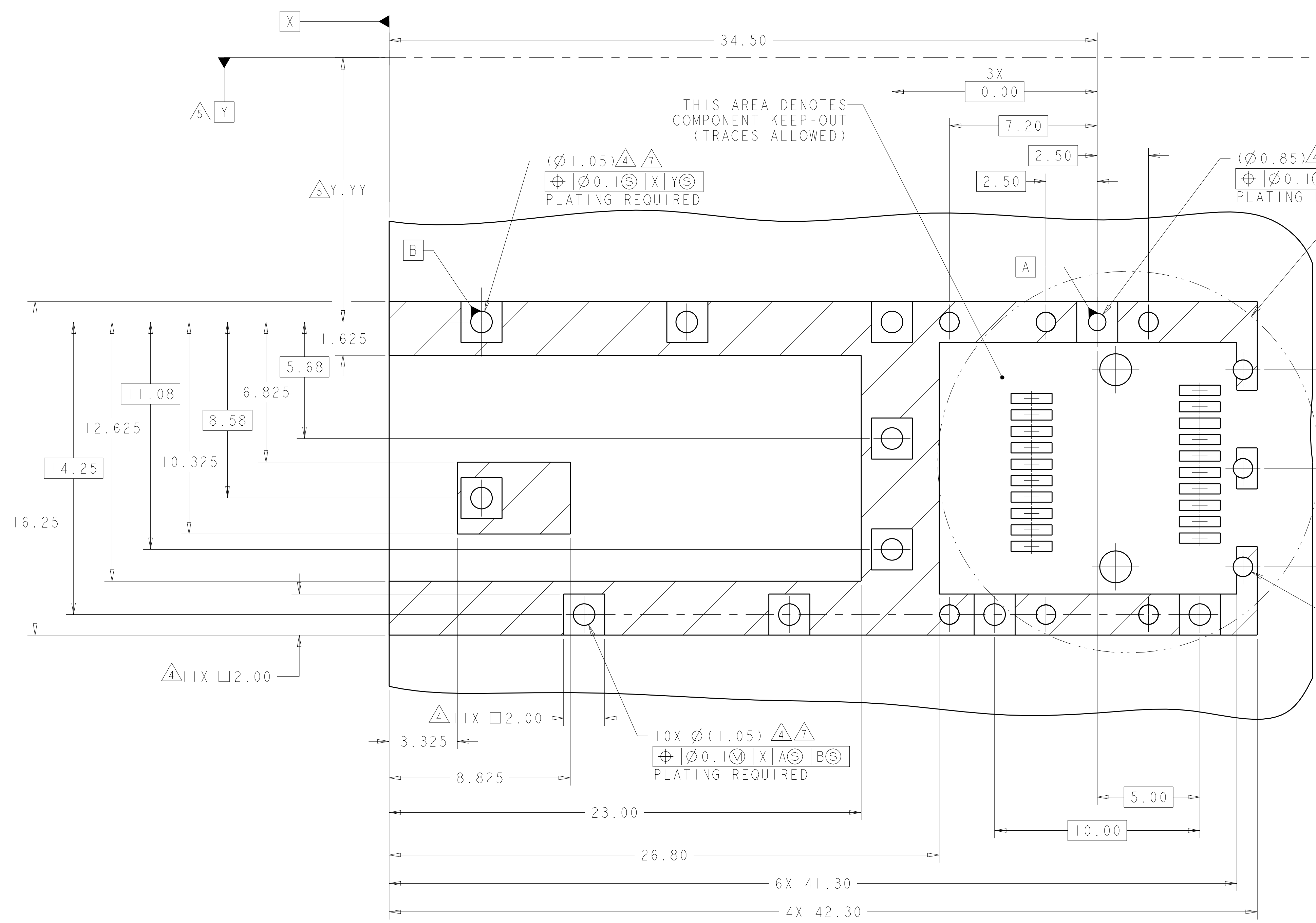
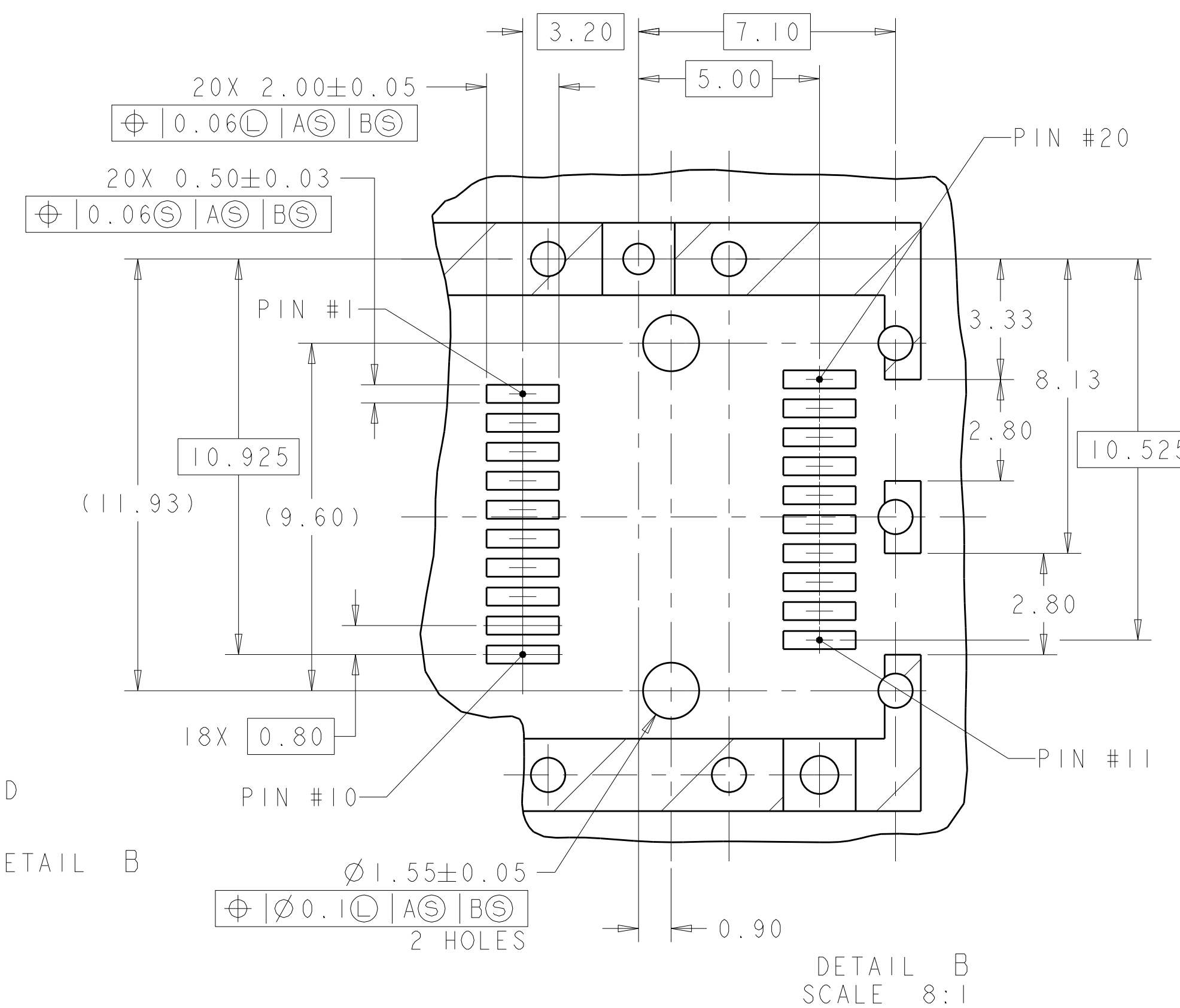
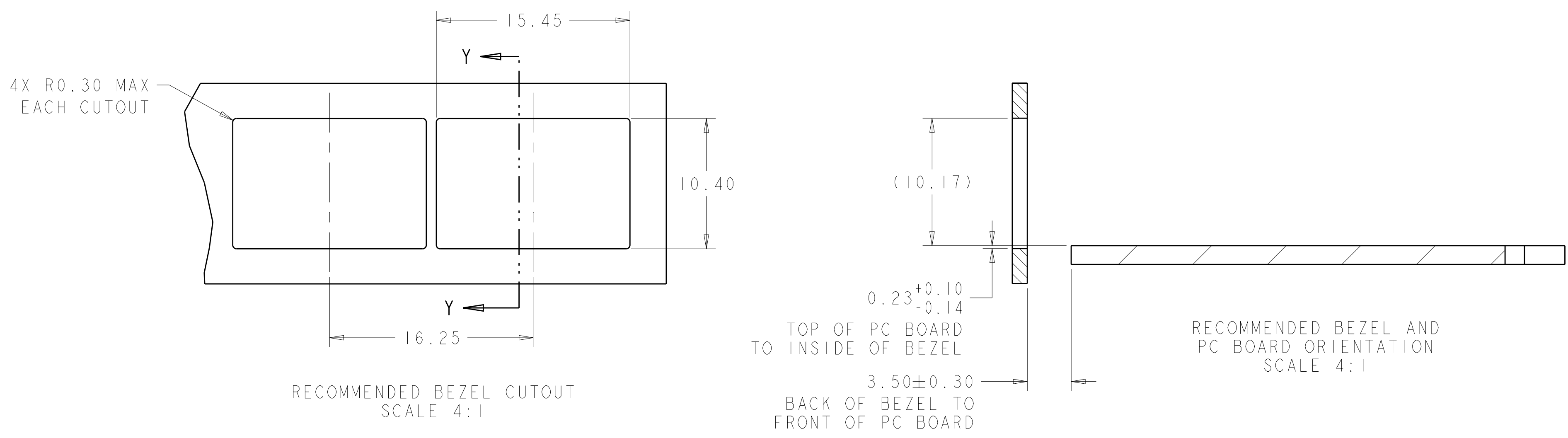

RECOMMENDED PCB LAYOUT FOR WITH INSULATING TAPE PART
 SCALE 8:1

THIS DRAWING IS A CONTROLLED DOCUMENT.		OWN M. SCHMITT 07JUN07	TE Connectivity
DIMENSIONS: mm		CHK M. SCHMITT 07JUN07	
TOLERANCES UNLESS OTHERWISE SPECIFIED:		APPD B. WERTZ 07JUN07	NAME SFP+ IXI CAGE ASSEMBLY, PRESS-FIT PRESS-FIT, EMI SPRINGS WITH HEATSINK
0 PLC ±0.1 1 PLC ±0.5 2 PLC ±0.5 3 PLC ±0.13 4 PLC ±0.13 ANGLES ±0.13		PRODUCT SPEC 108-2364	RESTRICTED TO
MATERIAL FINISH		APPLICATION SPEC 114-13120	SIZE CAGE CODE DRAWING NO. A100779C=2007198
		WEIGHT	SCALE 6:1 SHEET 4 OF 4 REV C1
		Customer Drawing	