



Have a Question?
 Chat with a Product
 Information Specialist

What can we help you find?

[Products](#) |
 [Industries](#) |
 [Resources](#) |
 [About TE](#) |
 [My Account](#) |
 [Innovation](#) |
 [Support Center](#)

201532-4 Product Details

[Share](#) |
 [Print](#) |
 [Email](#)



201532-4

TE Internal Number: 201532-4

Active

[View 3D PDF](#)

M Series Connectors

Always EU RoHS/ELV Compliant (Statement of Compliance)

Product Highlights:

- Product Series = M Series
- Connector
- Cable-to-Cable / Cable-to-Panel
- Applies To Panel, Applies To Wire/Cable
- Housing

[View all Features](#)

Quick Links

- ▶ [Pricing & Availability](#)
- ▶ [Search for Tooling](#)
- ▶ [Product Feature Selector](#)
- ▶ [Contact Us About This Product](#)

[Add to My Part List](#) |
 [Request Sample](#) |
 [Find Similar Products](#) |
 [Buy Product](#)

Documentation & Additional Information	
<p>Product Drawings:</p> <ul style="list-style-type: none"> • RECEPTACLE HOUSING, 104 POSITION, M SERIES (PDF, English) <p>Catalog Pages/Data Sheets:</p> <ul style="list-style-type: none"> • M_SERIES_PIN_AND_SOCKET_CONNECTORS (PDF, English) <p>Product Specifications:</p> <ul style="list-style-type: none"> • None Available <p>Application Specifications:</p> <ul style="list-style-type: none"> • None Available <p>Instruction Sheets:</p> <ul style="list-style-type: none"> • M Series 104-Position Plug & Receptacle Connectors w... (PDF, English) <p>CAD Files: (CAD Format & Compression Information)</p> <ul style="list-style-type: none"> • 2D Drawing (DXF, Version V) • 3D Model (IGES, Version V) • 3D Model (STEP, Version V) 	<p>Additional Information:</p> <ul style="list-style-type: none"> • Product Line Information <p>Related Products:</p> <ul style="list-style-type: none"> • Tooling

[List all Documents](#)

Product Features (Please use the Product Drawing for all design activity)	
<p>Product Type Features:</p> <ul style="list-style-type: none"> • Product Series = M Series • Product Type = Connector • Connector Type = Housing • Thread Size = 1/4-28-UNF-2B • Strain Relief = Without • Sealed = No <p>Mechanical Attachment:</p> <ul style="list-style-type: none"> • Mating Retention Type = Center Fastener • Panel Mount Retention = With • Mounting Hardware = Insert and Center Fastener • Panel Mount Retention Type = Screw Mount <p>Dimensions:</p> <ul style="list-style-type: none"> • Length (X-Axis) (mm [in]) = 30.39 [1.196] • Width (Z-Axis) (mm [in]) = 31.75 [1.250] • Profile Height (Y-Axis) (mm [in]) = 74.80 [2.945] <p>Body Features:</p> <ul style="list-style-type: none"> • Mating Retention = With • Fastener Type = Slotted Hex <p>Contact Features:</p> <ul style="list-style-type: none"> • Contact Type = Pin, Socket <p>Housing Features:</p> <ul style="list-style-type: none"> • Connector Style = Receptacle 	<p>Configuration Features:</p> <ul style="list-style-type: none"> • Number of Positions = 104 <p>Industry Standards:</p> <ul style="list-style-type: none"> • RoHS/ELV Compliance = RoHS compliant, ELV compliant • Lead Free Solder Processes = Wave solder capable to 240°C, Wave solder capable to 260°C, Wave solder capable to 265°C • RoHS/ELV Compliance History = Always was RoHS compliant <p>Environmental:</p> <ul style="list-style-type: none"> • Operating Temperature (°C [°F]) = -55 - +150 [-67 - +302] <p>Conditions for Usage:</p> <ul style="list-style-type: none"> • Applies To = Panel, Wire/Cable • For Use With = Plug Housing <p>Operation/Application:</p> <ul style="list-style-type: none"> • Application Use = Cable-to-Cable / Cable-to-Panel <p>Packaging Features:</p> <ul style="list-style-type: none"> • Packaging Method = Box/Carton • Packaging Quantity = 1 <p>Other:</p> <ul style="list-style-type: none"> • Brand = AMP • Comment = Pins and/or sockets may be used in any housing.; Housing cavity identification are mirror image.; Housing accepts type II, type III+ and Subminiature Coaxicon contacts.

- [Housing Material](#) = Phenolic - GF
- [Housing Color](#) = Black
- [Mating Alignment](#) = With
- [Mating Alignment Type](#) = Guide Hole
- [UL Flammability Rating](#) = UL 94V-0

Corporate Information

- [About TE](#)
- [Investors](#)
- [News Room](#)
- [Supplier Portal](#)
- [Careers](#)
- [Terms & Conditions](#)
- [Privacy Policy](#)

Quick Links

- [Distributor Inventory](#)
- [Product Cross Reference](#)
- [Documents & Drawings](#)
- [Product Compliance Support Center](#)
- [Site Map](#)

Customer Support

- [Email or Chat With Us](#)
- [Find a Phone Number](#)
- [Knowledge Base](#)
- [Manage Your Account](#)

Keep Me Informed



REVISIONS				
LTR	DESCRIPTION	DATE	DWN	APR
S1	REVISED PER ECO-11-005294	05APR11	RK	HMR

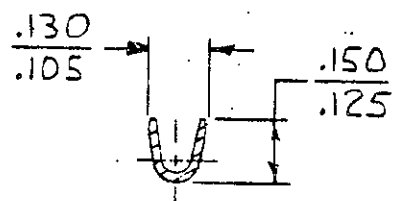
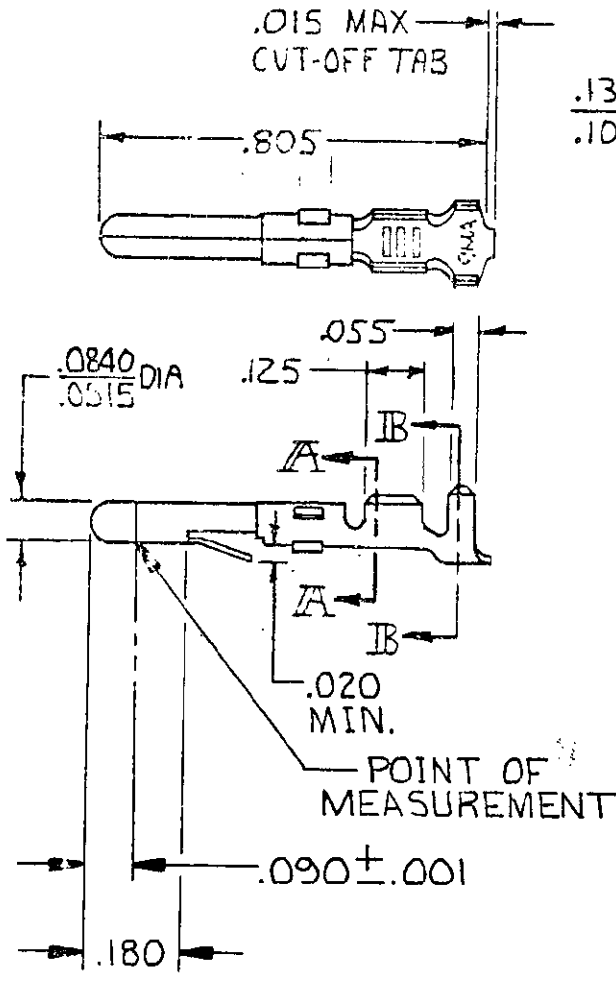

SECT A-A

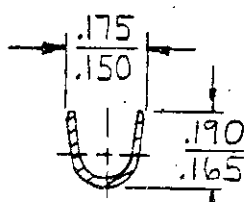

SECT B-B

⚠ .000030 GOLD INSIDE WIRE BARREL & ON TIP OF PIN & REMAINDER OF CONTACT IS NICKEL PLATE.

GOLD. ⚠	.012 BRASS	60620-5
PRE-TIN	PLI. BRZ	-4
PRE-TIN	.012 BRASS	60620-1
FINISH	MATERIAL	PART NO

UNLESS OTHERWISE SPECIFIED DIMENSIONS ARE IN INCHES. TOLERANCES ON: DECIMALS ±.015 ANGLES ±

CONTRACT NO
DR *M. FEHER 11-26-79*
CHK *W. Heide 11/80*

STE TE Connectivity

MATERIAL
SEE TABLE

APPD *W. Heide 1-7-81*
APPD

NAME
PIN, LOOSE PIECE,
COMMERCIAL MATE-N-LOK

FINISH
SEE TABLE

INSULATION DIA
.130 MAX
WIRE RANGE
20-14 AWG

SIZE **A** CODE IDENT NO **00779** DRAWING NO **60620**
SCALE — SHEET —