

207440-1 Product Details

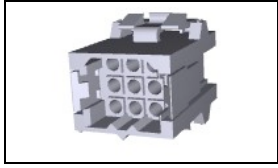

207440-1

TE Internal Number: 207440-1



5mm (.197") Centerline, 600 V, 14 A max. (Metrimate)

 Always EU RoHS/ELV Compliant (Statement of Compliance)

Product Highlights:

- Metrimate Product Line
- Wire-to-Board / Wire-to-Panel / Wire-to-Wire
- Applies To Panel, Applies To Printed Circuit Board, Applies To Wire/Cable
- Connector
- Housing

Documentation & Additional Information	
<p>Product Drawings:</p> <ul style="list-style-type: none"> • HOUSING, RECEPTACLE, 9 POSITION, METRIMATE (PDF, English) <p>Catalog Pages/Data Sheets:</p> <ul style="list-style-type: none"> • METRIMATE_PIN_SOCKET_CATALOG (PDF, English) <p>Product Specifications:</p> <ul style="list-style-type: none"> • None Available <p>Application Specifications:</p> <ul style="list-style-type: none"> • APPLICATION SPECIFICATION, METRIMATE DRAWER CONNECTORS (PDF, English) • Metrimate Self-Locking Connectors (PDF, English) • METRIMATE Self-Locking Connectors (PDF, Japanese) <p>Instruction Sheets:</p> <ul style="list-style-type: none"> • Self-Locking Metrimate Connectors (PDF, English) <p>CAD Files: (CAD Format & Compression Information)</p> <ul style="list-style-type: none"> • 2D Drawing (DXF, Version F) • 3D Model (IGES, Version F) • 3D Model (STEP, Version F) 	<p>Additional Information:</p> <ul style="list-style-type: none"> • Product Line Information <p>Related Products:</p> <ul style="list-style-type: none"> • Tooling

Product Features (Please use the Product Drawing for all design activity)	
<p>Product Type Features:</p> <ul style="list-style-type: none"> • Product Line = Metrimate • Product Type = Connector • Connector Type = Housing • Wire/Cable Type = Discrete Wire • Termination Method to Wire/Cable = Crimp, Solder • UL File Number = E28476 • CSA File Number = LR 16455 <p>Mechanical Attachment:</p> <ul style="list-style-type: none"> • Mating Retention Type = Locking Tab • Panel Mount Retention = With • Panel Mount Retention Type = Latch(es) <p>Electrical Characteristics:</p> <ul style="list-style-type: none"> • Operating Voltage Reference = AC/DC • Operating Voltage (VAC) = 600 • Operating Voltage (VDC) = 600 <p>Dimensions:</p> <ul style="list-style-type: none"> • Panel Thickness (mm [in]) = 0.76 - 2.29 [0.030 - 0.090] <p>Body Features:</p> <ul style="list-style-type: none"> • Wire Type = Stranded • Mating Retention = With • Row-to-Row Spacing (mm [in]) = 5.00 [0.197] <p>Contact Features:</p> <ul style="list-style-type: none"> • Contact Type = Pin • Contact Layout = Matrix <p>Housina Features:</p>	<p>Configuration Features:</p> <ul style="list-style-type: none"> • Connector Configuration = Square Grid • Number of Positions = 9 • Number of Rows = 3 <p>Industry Standards:</p> <ul style="list-style-type: none"> • RoHS/ELV Compliance = RoHS compliant, ELV compliant • Lead Free Solder Processes = Not relevant for lead free process • RoHS/ELV Compliance History = Always was RoHS compliant • VDE Tested = Yes • Agency/Standard = UL, CSA • UL Rating = Recognized, Certified <p>Environmental:</p> <ul style="list-style-type: none"> • Operating Temperature (°C [°F]) = -55 - +130 [-67 - +266] <p>Conditions for Usage:</p> <ul style="list-style-type: none"> • Applies To = Panel, Printed Circuit Board, Wire/Cable • For Use With = Plug Housing, Socket Header <p>Operation/Application:</p> <ul style="list-style-type: none"> • Application Use = Wire-to-Board / Wire-to-Panel / Wire-to-Wire <p>Packaging Features:</p> <ul style="list-style-type: none"> • Packaging Method = Package • Packaging Quantity = 1 <p>Other:</p> <ul style="list-style-type: none"> • Brand = AMP

- Connector Style = Receptacle
- Housing Material = Nylon
- Housing Color = Red
- Mating Alignment = With
- Mating Alignment Type = Polarization
- Centerline (mm [in]) = 5.00 [0.197]
- UL Flammability Rating = UL 94V-0

MOD	LOC	DIST	P	F	ZONE	LTR	DESCRIPTION	DATE	APPD
1	BD	37					REVISIONS		
						E	REDRAWN & REVISED PER ECN BD6668	08/26/92	-
						F	REV PER EC 0020-250-94	03/24/94	AT

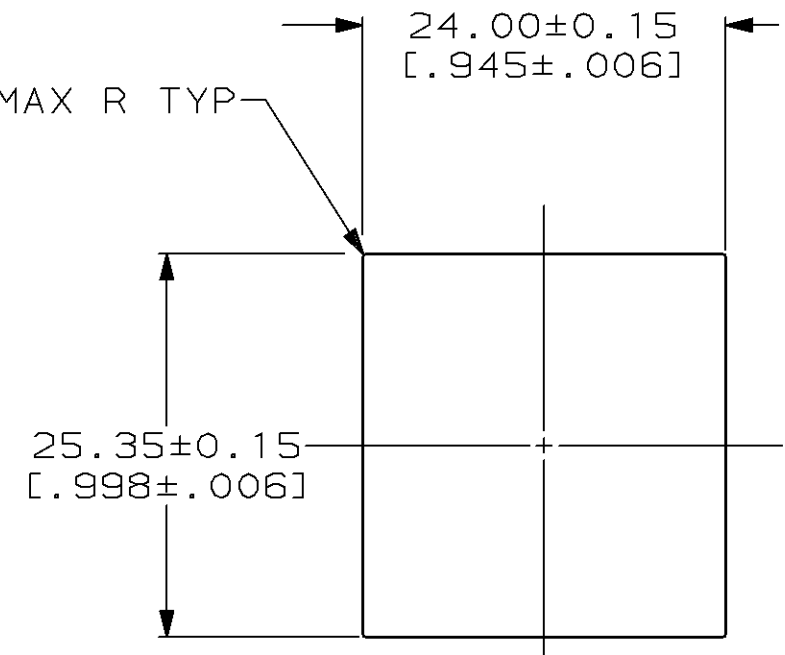
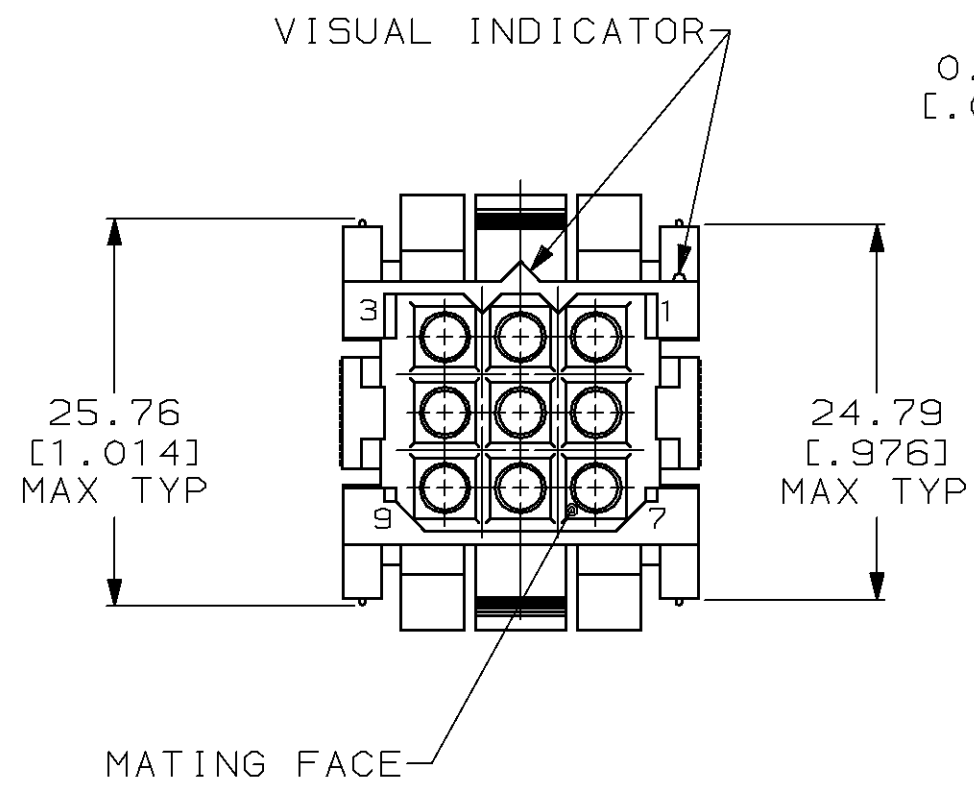
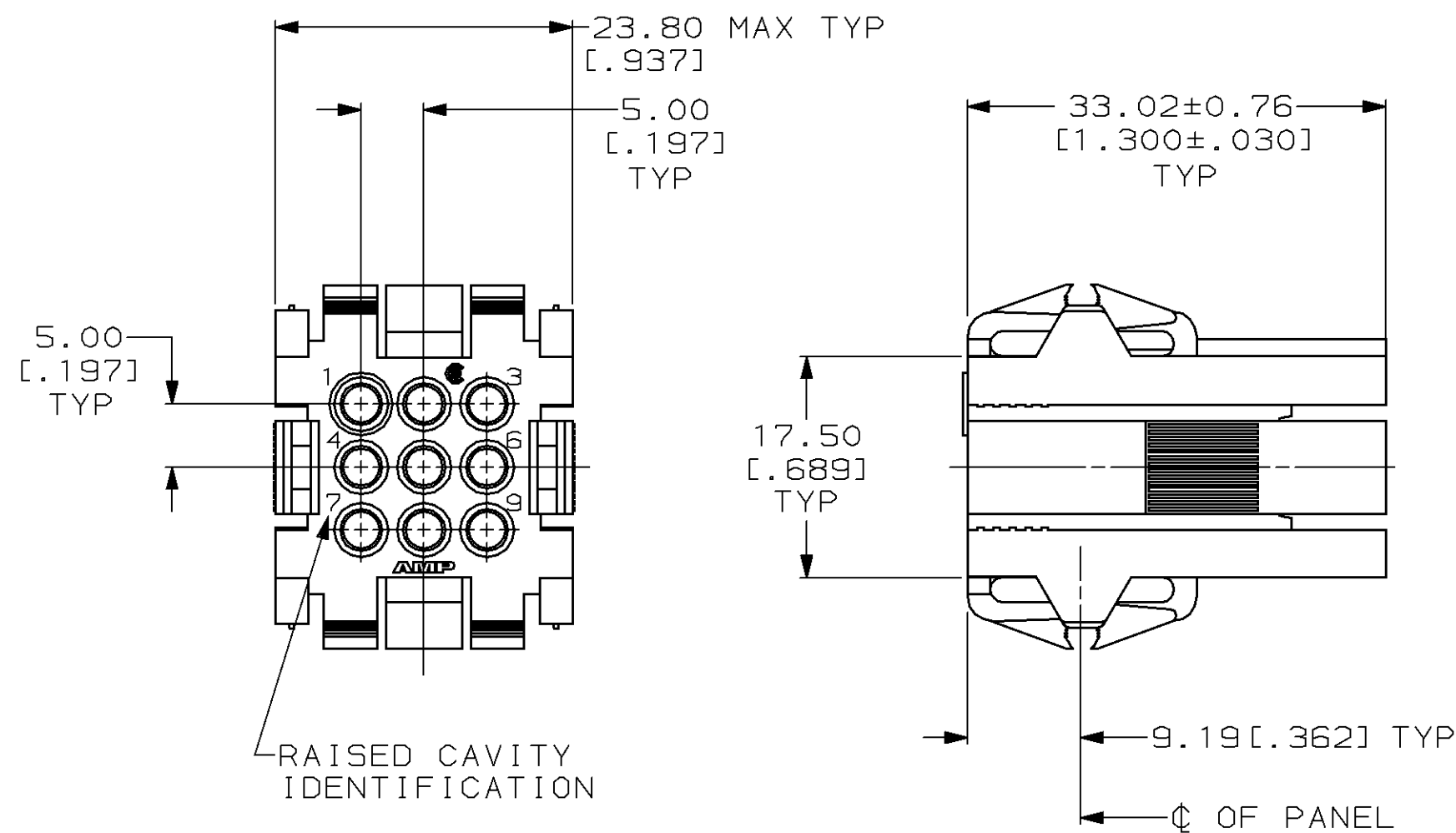

PANEL CUTOUT

1. PANEL RETENTION MECHANISM ACCOMMODATES PANEL THICKNESSES FROM 0.76 [0.030] TO 2.29 [0.090].

THIS DRAWING IS A CONTROLLED DOCUMENT FOR AMP INCORPORATED. IT IS SUBJECT TO CHANGE AND THE CONTROLLING ENGINEERING ORGANIZATION SHOULD BE CONTACTED FOR THE LATEST REVISION.

DO NOT SCALE PRINT. UNLESS SPECIFIED DIMENSIONS IN mm [INCHES] TOLERANCES ON : 2 PLC DEC ± 0.25 [0.010] 3 PLC DEC ± - ANGLES ± -		DR 08/26/92 W.LENKER		AMP Incorporated Harrisburg, PA 17105-3608	
MATERIAL NYLON, COLOR: RED		CHK 8-31-92 R.STONE			
FINISH -		APPD 9-2-92 A.TRAVIS		NAME HOUSING, RECEPTACLE, 9 POSITION, METRIMATE	
-		APPD 9-3-92 C.ROHDE		SIZE C 00779	
-		PRODUCT SPEC 108-10033		DRAWING NO C=207440	
-		APPLICATION SPEC -		SCALE 2:1	
-		WEIGHT -		SHEET 1 OF 1	

CUSTOMER DRAWING