

208210-2 Product Details

[Share](#) [Print](#) [Email](#)

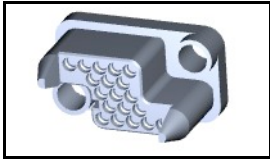

208210-2

TE Internal Number: 208210-2

Active

[View 3D PDF](#)

5mm (.197") Centerline, 600 V, 14 A max. (Metrimate)

Always EU RoHS/ELV Compliant
(Statement of Compliance)

Product Highlights:

- Metrimate Product Line
- Wire-to-Board, Wire-to-Panel, Wire-to-Wire
- Applies To Panel, Applies To Printed Circuit Board, Applies To Wire/Cable
- Connector
- Housing

[View all Features](#)

Quick Links

- ▶ [Pricing & Availability](#)
- ▶ [Search for Tooling](#)
- ▶ [Product Feature Selector](#)
- ▶ [Contact Us About This Product](#)

[Add to My Part List](#)

[Request Sample](#)

[Find Similar Products](#)

[Buy Product](#)

Documentation & Additional Information

Product Drawings:

- [SOCKET HOUSING, 19 POSN, METRIMATE](#) (PDF, English)

Catalog Pages/Data Sheets:

- [METRIMATE_PIN_SOCKET_CATALOG](#) (PDF, English)

Product Specifications:

- None Available

Application Specifications:

- [APPLICATION SPECIFICATION, METRIMATE DRAWER CONNECTORS](#) (PDF, English)

Instruction Sheets:

- None Available

CAD Files: ([CAD Format & Compression Information](#))

- [2D Drawing](#) (DXF, Version AM)
- [3D Model](#) (IGES, Version AM)
- [3D Model](#) (STEP, Version AM)

[List all Documents](#)

Additional Information:

- [Product Line Information](#)

Related Products:

- [Tooling](#)

Product Features (Please use the Product Drawing for all design activity)

Product Type Features:

- Product Line = Metrimate
- Product Type = Connector
- Connector Type = Housing
- Wire/Cable Type = Discrete Wire

Mechanical Attachment:

- Panel Mount Retention = With
- Panel Mount Retention Type = Screw Mount

Electrical Characteristics:

- Operating Voltage Reference = AC/DC
- Operating Voltage (VAC) = 600
- Operating Voltage (VDC) = 600

Configuration Features:

- [Connector Configuration](#) = Drawer
- [Number of Positions](#) = 19
- [Number of Rows](#) = 5

Industry Standards:

- [RoHS/ELV Compliance](#) = RoHS compliant, ELV compliant
- [Lead Free Solder Processes](#) = Wave solder capable to 260°C, Wave solder capable to 240°C, Wave solder capable to 265°C
- [RoHS/ELV Compliance History](#) = Always was RoHS compliant
- [VDE Tested](#) = Yes
- [Agency/Standard](#) = CSA, UL

Termination Features:

- Termination Method to Wire/Cable = Crimp, Solder

Dimensions:

- Panel Thickness (mm [in]) = 0.80 - 2.30 [0.031 - 0.091]

Body Features:

- Wire Type = Stranded
- Drawer Style = Standard
- Row-to-Row Spacing (mm [in]) = 4.39 [0.173]

Contact Features:

- Contact Type = Socket

Housing Features:

- Connector Style = Plug
- Housing Material = Polyester - GF
- Housing Color = Black
- Mating Alignment = With
- Mating Alignment Type = Blindmate
- Centerline (mm [in]) = 5.08 [0.200]

- UL Rating = Certified, Recognized
- UL File Number = E28476
- UL Flammability Rating = UL 94V-0

Environmental:

- Operating Temperature (°C [°F]) = -55 - +130 [-67 - +266]

Conditions for Usage:

- Applies To = Panel, Printed Circuit Board, Wire/Cable
- For Use With = Receptacle Housing, Hardware 208211-1 or -4

Operation/Application:

- Application Use = Wire-to-Board, Wire-to-Panel, Wire-to-Wire

Packaging Features:

- Packaging Method = Package
- Packaging Quantity = 1

Other:

- Brand = AMP
- Comment = Hardware not supplied.

Corporate Information

[About TE](#)
[Investors](#)
[News Room](#)
[Supplier Portal](#)
[Careers](#)
[Terms & Conditions](#)
[Privacy Policy](#)
[AODA Accessibility Policy](#)
[AODA Multi-Year Accessibility Plan](#)

Quick Links

[Distributor Inventory](#)
[Product Cross Reference](#)
[Documents & Drawings](#)
[Product Compliance Support Center](#)
[Site Map](#)

Customer Support

[Email or Chat With Us](#)
[Find a Phone Number](#)
[Knowledge Base](#)
[Manage Your Account](#)

Keep Me Informed

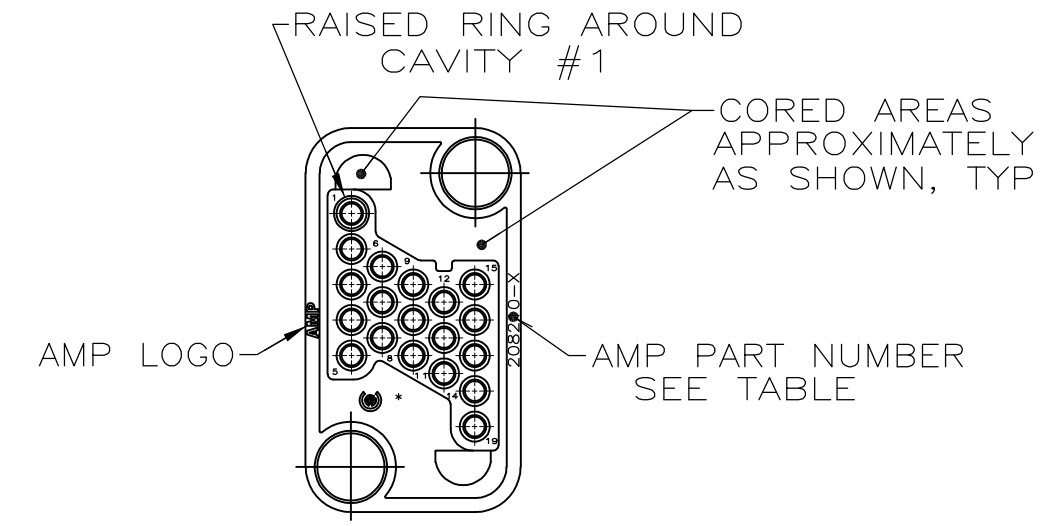
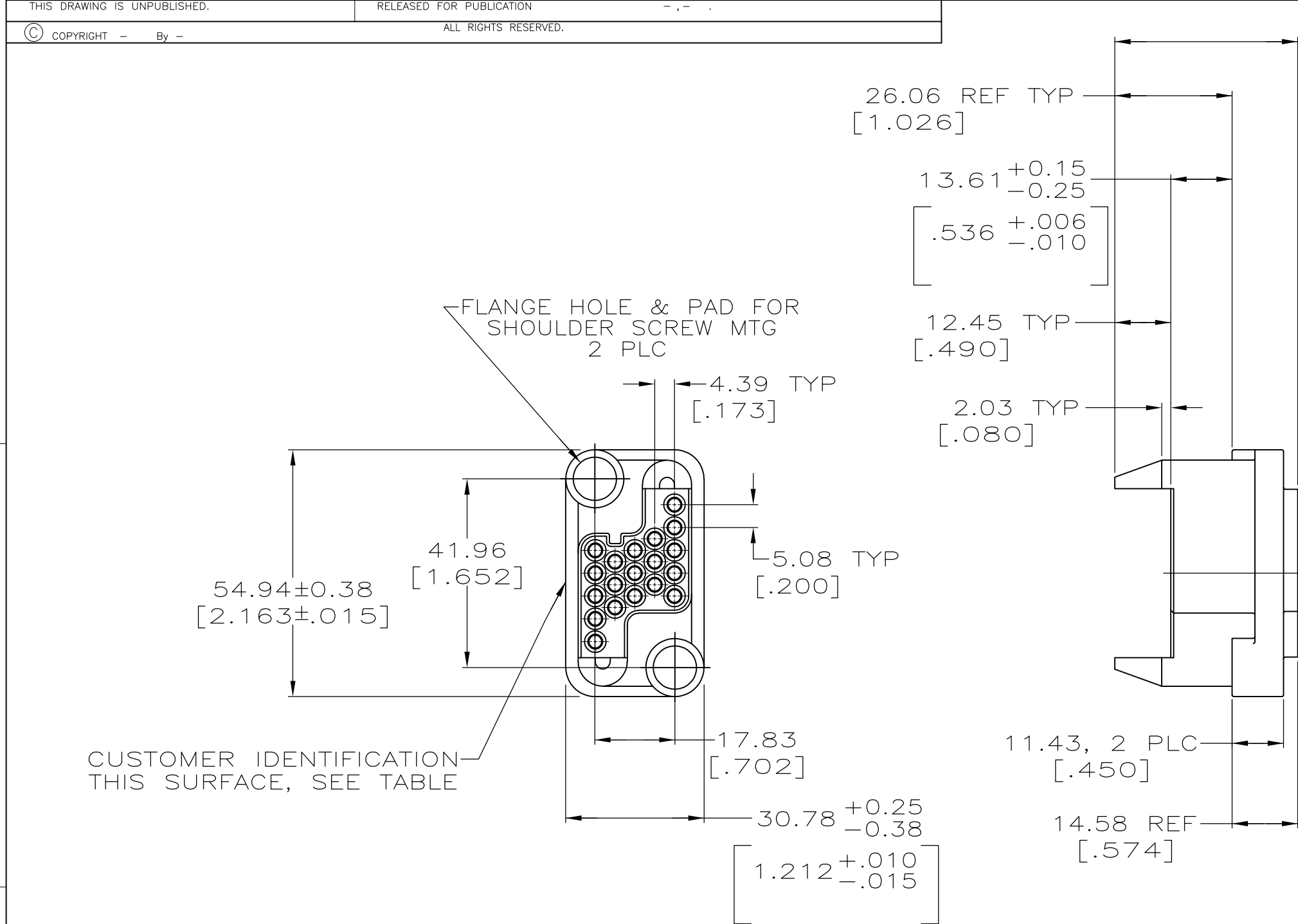

1. 208210 MATES WITH 208209.
2. MOUNTING SCREW INFORMATION SEE 208211.
3. 208210-1 WILL BE MOLDED WITH AMP PART NUMBER 208210-2 SINCE IT IS AN INK STAMPED VERSION OF 208210-2.

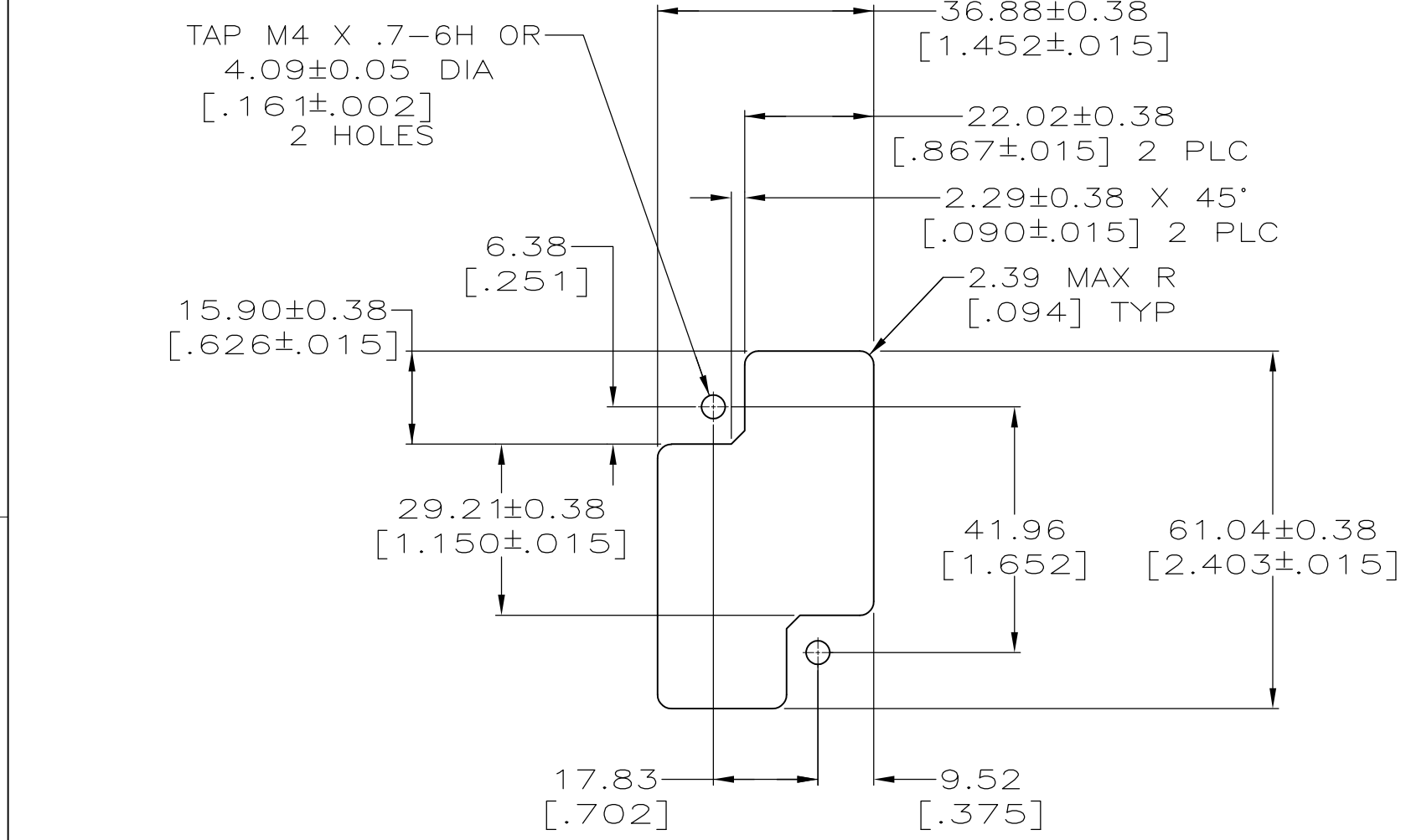

SUGGESTED
PANEL CUTOUT

208210-5	-	POLYESTER, BLUE	208210-5
208210-2	-	POLYESTER, BLACK	208210-2
208210-2	3	113P10188	208210-1
MOLDED PART NO	CUST IDENT	MATERIAL	PART NO

THIS DRAWING IS A CONTROLLED DOCUMENT.		DWN R. SHIREY 09/05/91	STE TE Connectivity	
DIMENSIONS: MM[INCHES]		CHK R. STONE 09/23/91		
TOLERANCES UNLESS OTHERWISE SPECIFIED:		APVD A. TRAVIS 09/23/91	NAME	
0 PLC ± -	1 PLC ± -	PRODUCT SPEC	SOCKET HOUSING, 19 POSN, METRIMATE	
2 PLC ± 0.13 [.005]	3 PLC ± -	APPLICATION SPEC	SIZE	CAGE CODE
4 PLC ± -	ANGLES ± 1°	114-10039	A2	00779
MATERIAL SEE TABLE	FINISH -	WEIGHT -	DRAWING NO	RESTRICTED TO
CUSTOMER DRAWING			SCALE 1:1	SHEET 1 of 1