

Circular Plastic Connector Sealing Accessories

Wire Entry Seal Kits for Plug and Receptacle Housings

Material and Finish:

Seal—Elastomer, red iron oxide
Pressure Plate—Nylon, black

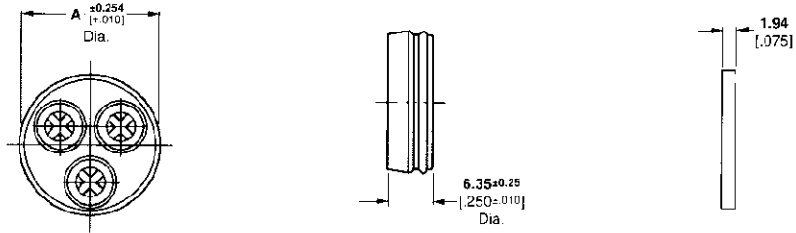

Arrangement No.	Insulation Dia. Range	Dimension A	Kit for Pins	Kit for Sockets
13-9	1.91-3.18 .075-.125	17.30 .681	213926-1	213925-1
17-3	4.52-6.73 .178-.265	20.07 .790	213899-1	213899-1
17-10	4.52-6.73 .178-.265	20.07 .790	213900-1	213900-1
	1.91-3.18 .075-.125			
17-14	1.91-3.18 .075-.125	20.07 .790	213919-2	213919-1
17-16	1.91-3.18 .075-.125	20.07 .790	213920-2	213920-1

- Notes:** 1. Kits include one Gang Seal and one pressure plate marked for cavity identification.
2. Arrangement No. 17--10 Insulation Range 4.52-6.73 [.176-.265] for two-holes, 1.95-3.18 [.075-.125] for eight holes.

Flange Seal

Material: Neoprene, black

Shell Size	Part No.
11	81665-3
13	81665-4
17	81665-2
23	81665-5

