

Distributed by:

**JAMECO**<sup>®</sup>  
ELECTRONICS

**www.Jameco.com ♦ 1-800-831-4242**

The content and copyrights of the attached  
material are the property of its owner.

Jameco Part Number 839893

DO NOT SCALE  
DIMENSIONS IN mm

METRIC

THIRD ANGLE  
PROJECTION

P.C.B. HOLE DIM. ACTION PIN	
DRILLED HOLE	1,15 ± 0,025 mm
FIN. HOLE	0,94 to 1,09 mm
AFTER REFLOW	0,91 to 1,09 mm
Cu-thkks	0,025 to 0,075 mm
SnPb-thkks	0,004 to 0,010 mm

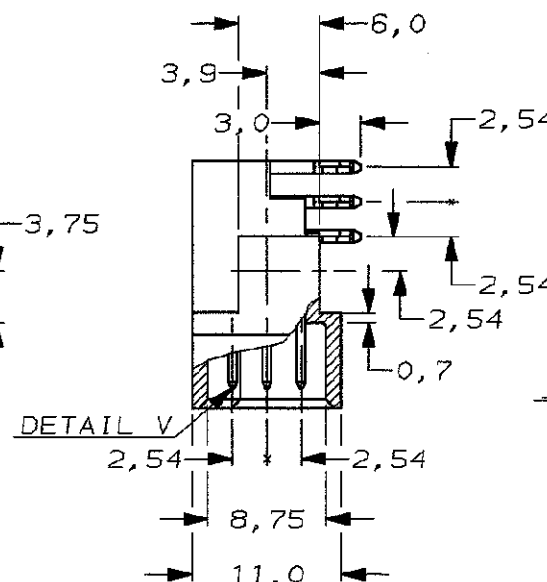
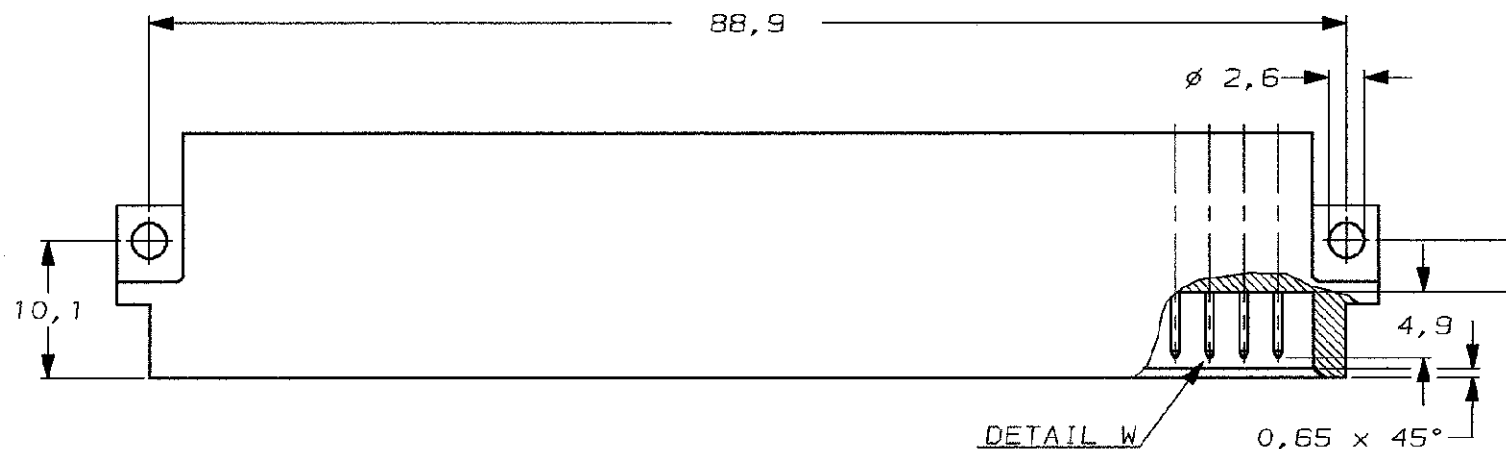

DETAIL W

DETAIL V

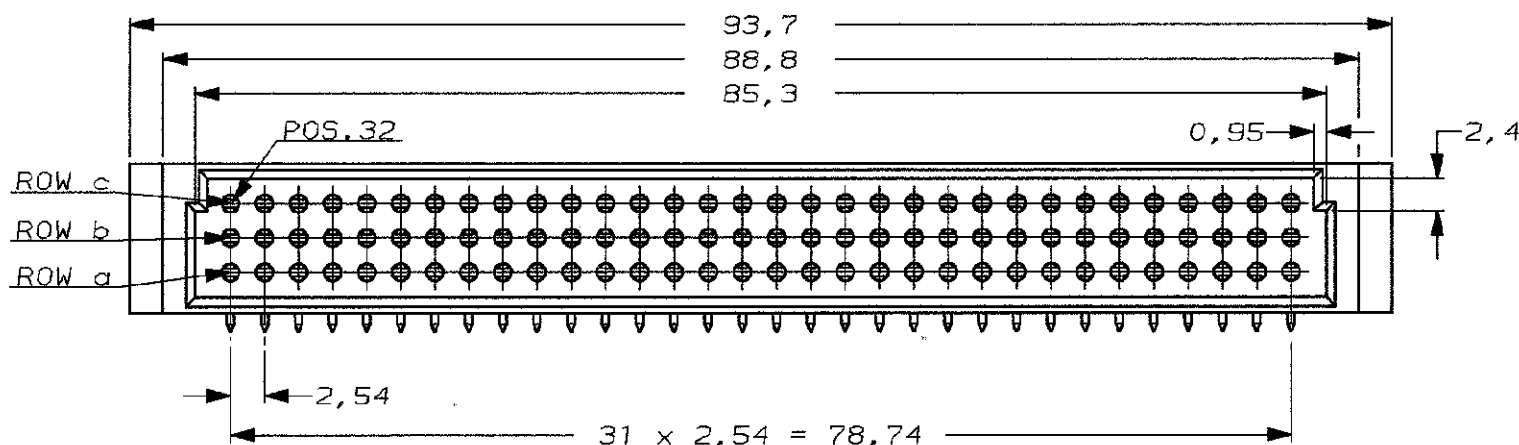
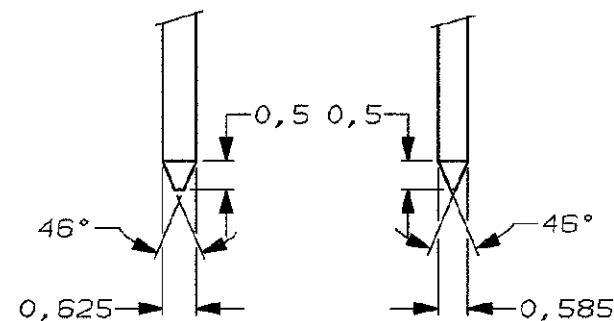

ROW	XX
abc	XX
POS	32 31 30 29 28 27 26 25 24 23 22 21 20 19 18 17 16 15 14 13 12 11 10 9 8 7 6 5 4 3 2 1

AN ASTERISK ,,X'' DENOTES A CONTACT.

NOTES:



MATERIAL:

- HOUSING: THERMOPL. POLYESTER  
COLOUR: GREY
- CONTACTS: PHOSPHORBRONZE



PLATING CONTACT:

- 1 : 1,25 µm Au OVER 1,25 µm Ni AT CONNECTOR MATING SIDE.  
2,54 µm Sn/Pb OVER 1,25 µm Ni AT ACTION-PIN AREA.
- 4 : 0,8 µm Au OVER 1,25 µm Ni AT CONNECTOR MATING SIDE.  
2,54 µm Sn/Pb OVER 1,25 µm Ni AT ACTION-PIN AREA.
- 7 : 2,0 µm Au OVER 1,25 µm Ni AT CONNECTOR MATING SIDE.  
2,54 µm Sn/Pb OVER 1,25 µm Ni AT ACTION-PIN AREA.
- 8 : 0,4 µm Au OVER 1,25 µm Ni AT CONNECTOR MATING SIDE.  
2,54 µm Sn/Pb OVER 1,25 µm Ni AT ACTION-PIN AREA.
- 9 : SAME AS -4 EXCEPT WITHOUT Sn/Pb.

OBSOLETE	SEE NOTE 2	SEE NOTE 1	215605-9
OBSOLETE	SEE NOTE 2	SEE NOTE 1	215605-8
OBSOLETE	SEE NOTE 2	SEE NOTE 1	215605-7
	SEE NOTE 2	SEE NOTE 1	215605-4
	SEE NOTE 2	SEE NOTE 1	215605-1
	SEE NOTE	MATERIAL	PARTNUMBER

CUSTOMER DRAWING				FOR REFERENCE ONLY WILL NOT BE UPDATED	
© COPYRIGHT 19- BY AMP-HOLLAND B.V. ALL INTERNATIONAL RIGHTS RESERVED. AMP PRODUCTS MAY BE COVERED BY U.S. AND FOREIGN AND/OR PATENTS PENDING.					
THIS DRAWING IS UNPUBLISHED RELEASED FOR PUBLICATION					
D	EH-1254-96	J.G.	J.G.	13-06-97	AMP-HOLLAND B.V. 's-Hertogenbosch, The Netherlands.
C	EH-0927-95	JG	RVL	03-08-95	
B	H-8830	DK	RVL	04-07-91	
LTR.	REVISION RECORD	DR.	CHK.	DATE	NAME 96 POS. DIN 41612 TYPE C-MALE CONN. WITH ACTION PIN FOR 1,6 P.C.B. THK'S.
DR.:	R.V. LOKVEN	CHK.:	J. Gibbels	APP.:	DWG. No. C-215605
DATE:	16-12-86	DATE:	6-6-97	DATE:	REV. LTR. D
					SHEET 1 OF 1