

THIS DRAWING IS UNPUBLISHED. RELEASED FOR PUBLICATION  
 © COPYRIGHT - By - ALL RIGHTS RESERVED.

LOC	DIST	REVISIONS					
		P	LTR	DESCRIPTION	DATE	DWN	APVD
H	-	J4		ECR-14-008810	12JUN14	CW	SH
		J5		ECO-15-014053	24SEP2015	AD	SH

NOTES:

1. TOLERANCES UNLESS OTHERWISE SPECIFIED: ±0.15
2. FOR APPLICATION INFORMATION SEE AMP SPEC. 114-19019.
3. FOR PERFORMANCE REQUIREMENTS SEE AMP SPEC. 108-19064

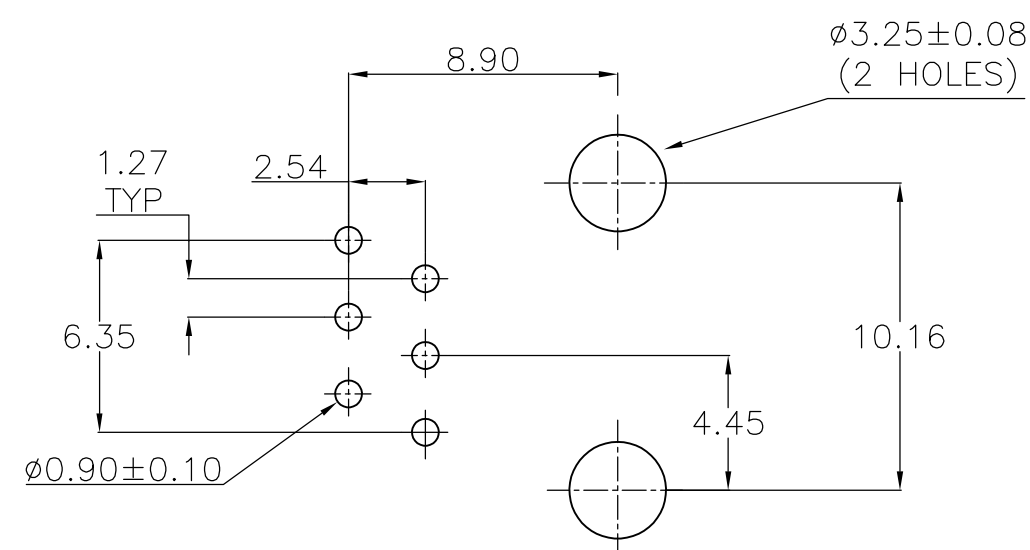
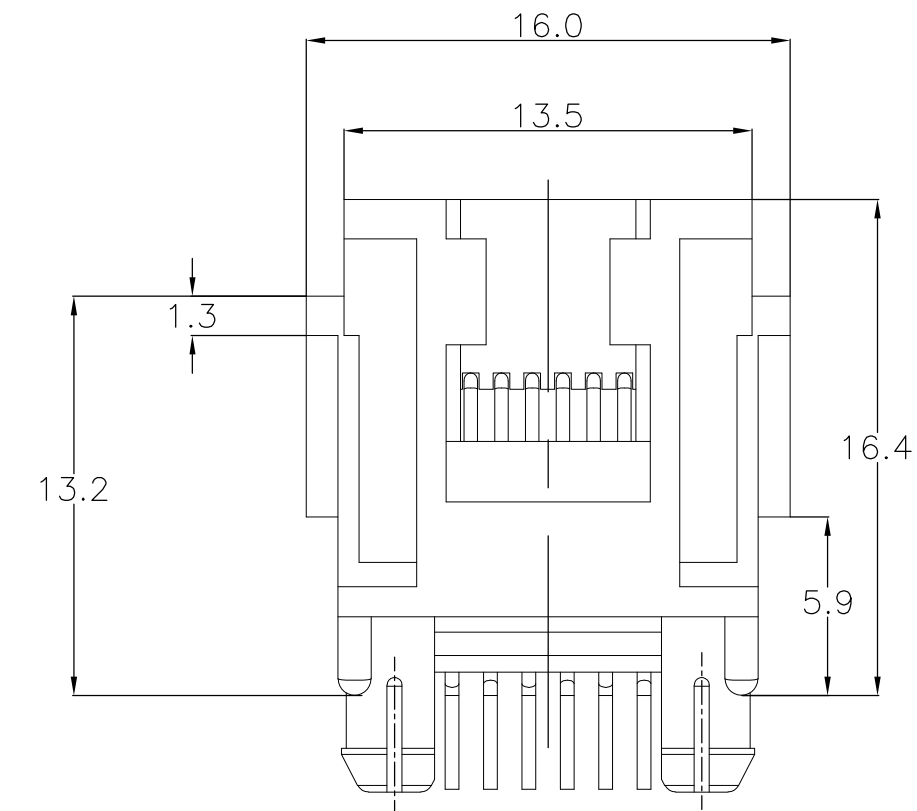
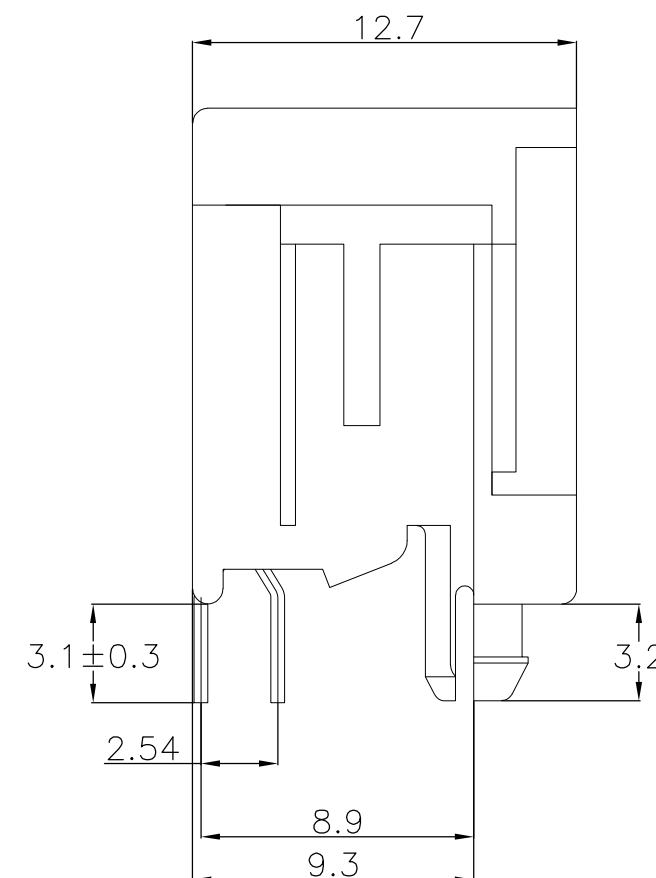
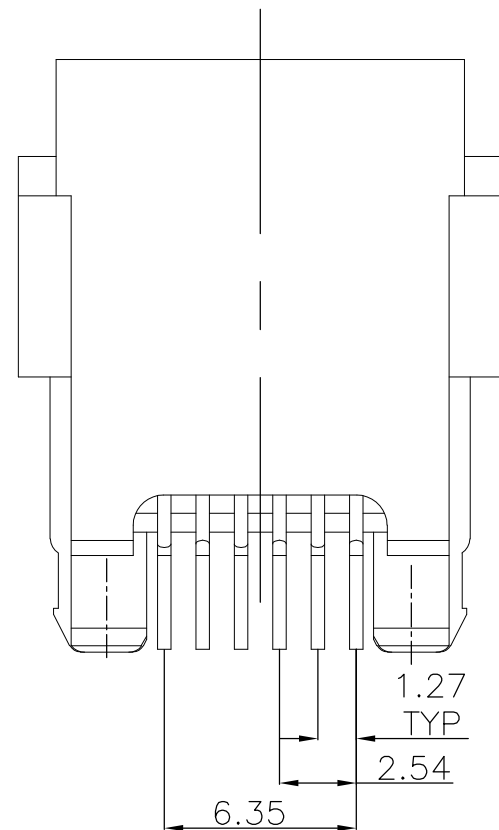
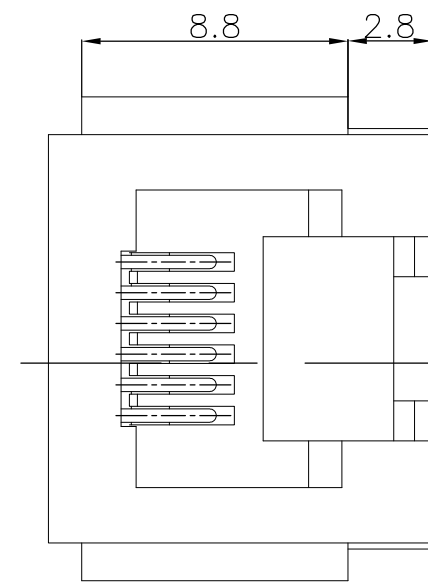

PRINTED CIRCUIT BOARD LAYOUT

[VIEW SHOWN IS CIRCUIT (NONCOMPONENT) SIDE OF BOARD.]  
 TOLERANCES UNLESS OTHERWISE SPECIFIED: ±0.05  
 PRINTED CIRCUIT BOARD THICKNESS: 1.6 mm NOMINAL.

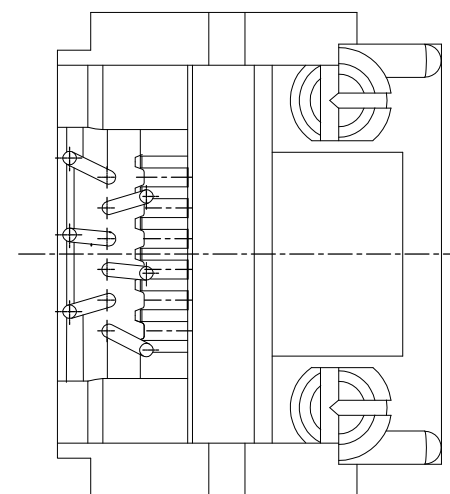

800 PCS. ON A 60cm. DIA. REEL	6 POSITIONS/ 6 CONTACTS.	IN CONTACT AREA: 1.2µm MIN. SEL. GOLD OVER 1.2µm MIN. NICKEL	HOUSING: PBT,UL 94V-HB COLOR: BLACK	216548-1
PACKAGING	REMARKS	FINISH	MATERIAL	PART NUMBER
SOLDER TINES: 2.0µm MIN. TIN OVER 1.2µm MIN. NICKEL		CONTACTS: PHOSPHOR BRONZE		

THIS DRAWING IS A CONTROLLED DOCUMENT.		DWN J.V.LIEMPT	22JAN92	<b>STE</b> TE Connectivity	
DIMENSIONS: mm		CHK C.STERKEN	APVD L.V.SOEST		
TOLERANCES UNLESS OTHERWISE SPECIFIED:		PRODUCT SPEC		MODULAR JACK, 6 POS. TOP ENTRY, SMALL SIZE WITH PANEL STOPS, FOR PRINTED CIRCUIT BOARDS	
0 PLC ± - 1 PLC ± - 2 PLC ± - 3 PLC ± - 4 PLC ± - ANGLES ± -		APPLICATION SPEC		SIZE A2	CAGE CODE 00779
MATERIAL SEE TABLE		FINISH SEE TABLE		DRAWING NO C=216548	RESTRICTED TO
CUSTOMER DRAWING				SCALE -	SHEET 1 of 3
				REV J5	

THIS DRAWING IS UNPUBLISHED. RELEASED FOR PUBLICATION  
 © COPYRIGHT - By - ALL RIGHTS RESERVED.

LOC	DIST	REVISIONS					
H	-	P	LTR	DESCRIPTION	DATE	DWN	APVD
				SEE SHEET 1/3			

NOTES:

1. TOLERANCES UNLESS OTHERWISE SPECIFIED: ±0.15
2. FOR APPLICATION INFORMATION SEE AMP SPEC. 114-19019.
3. FOR PERFORMANCE REQUIREMENTS SEE AMP SPEC. 108-19064

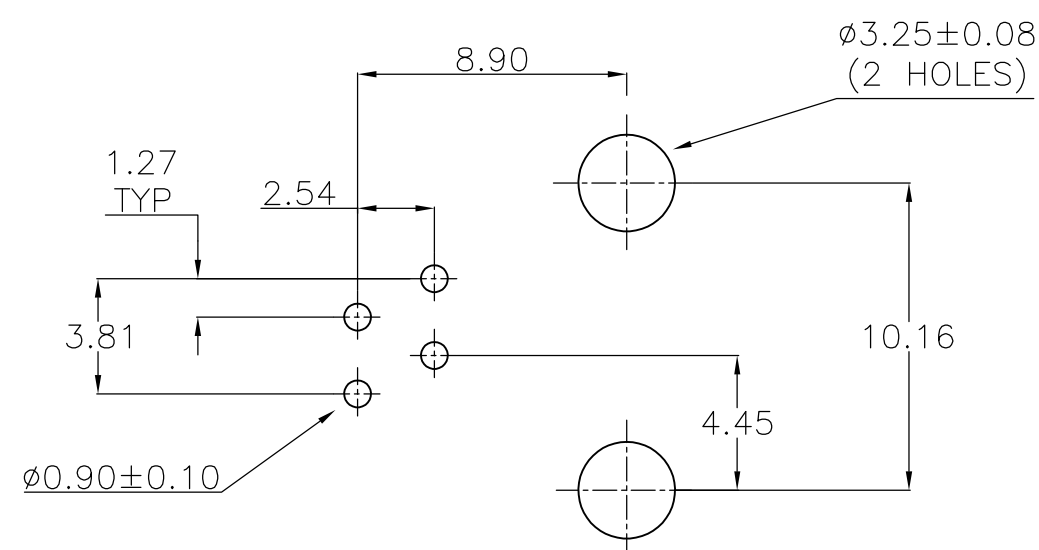
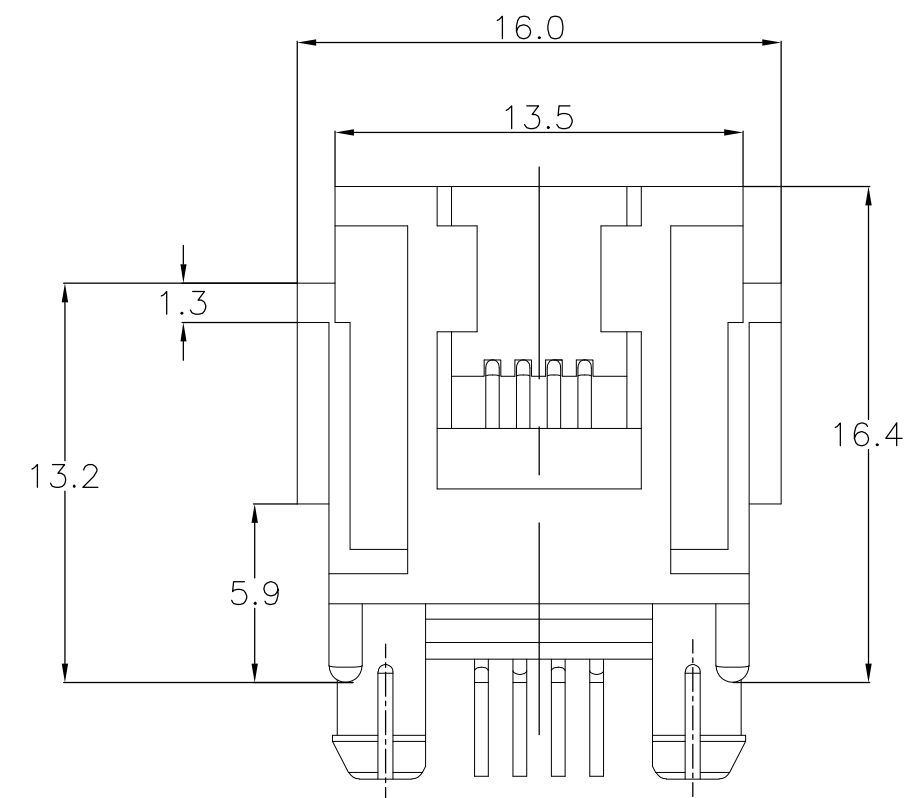
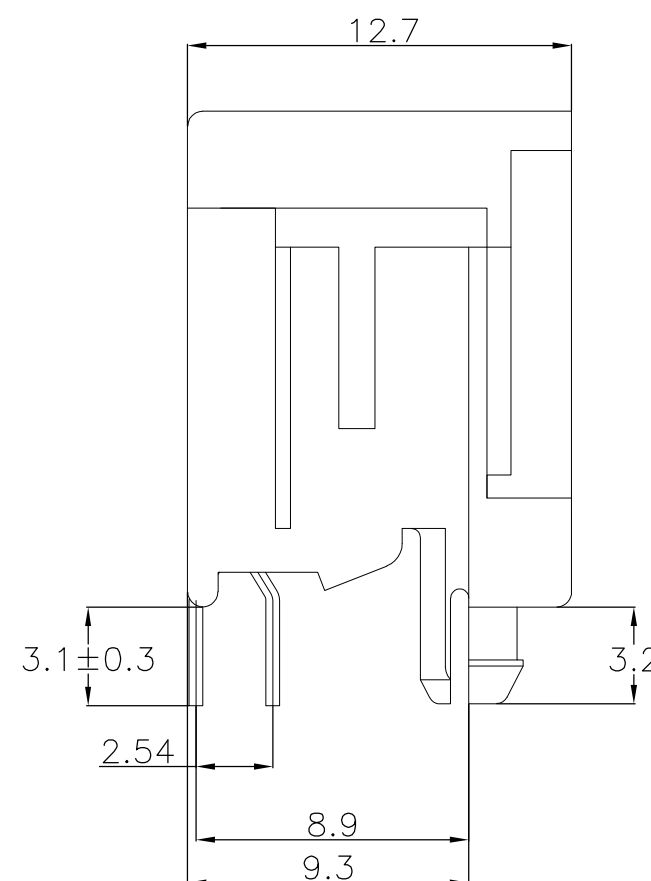
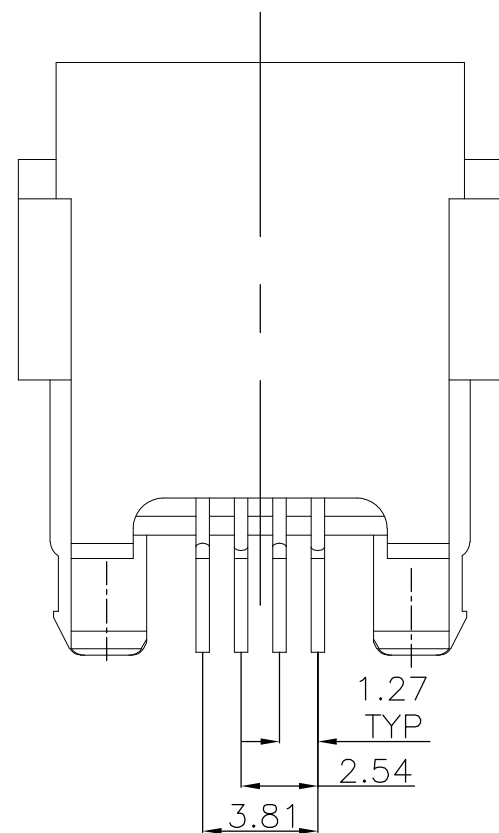
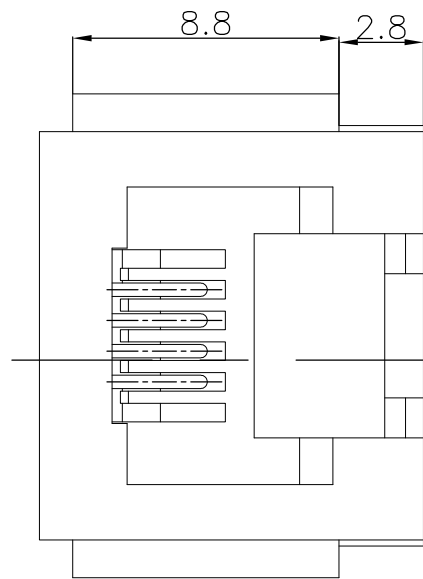

PRINTED CIRCUIT BOARD LAYOUT

[VIEW SHOWN IS CIRCUIT (NONCOMPONENT) SIDE OF BOARD.]  
 TOLERANCES UNLESS OTHERWISE SPECIFIED: ±0.05  
 PRINTED CIRCUIT BOARD THICKNESS: 1.6 mm NOMINAL.

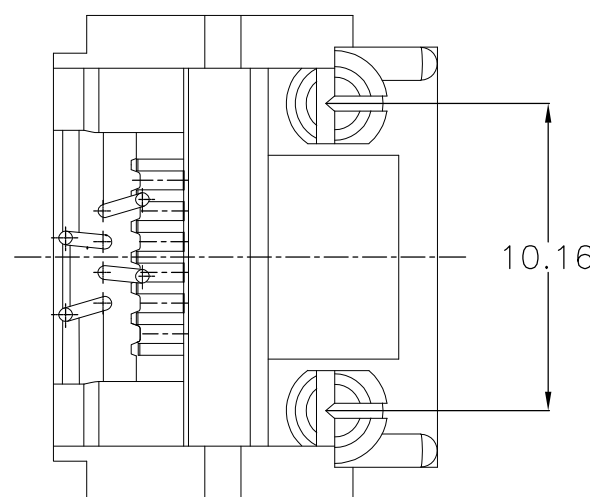

800 PCS. ON A 60cm. DIA. REEL	6 POSITIONS/ 4 CONTACTS.	IN CONTACT AREA: 1.2µm MIN. SEL. GOLD OVER 1.2µm MIN. NICKEL	HOUSING: PBT,UL 94V-HB COLOR: BLACK	216548-2
PACKAGING	REMARKS	FINISH	MATERIAL	PART NUMBER
		SOLDER TINES: 2.0µm MIN. TIN OVER 1.2µm MIN. NICKEL	CONTACTS: PHOSPHOR BRONZE	

THIS DRAWING IS A CONTROLLED DOCUMENT.		DWN J.v.LIEMPT 22JAN92	<b>STE</b> TE Connectivity	
DIMENSIONS: mm		CHK C.STERKEN		
TOLERANCES UNLESS OTHERWISE SPECIFIED:		APVD L.V.SOEST	NAME	
0 PLC ± -		PRODUCT SPEC	MODULAR JACK, 6 POS. TOP ENTRY, SMALL SIZE WITH PANEL STOPS, FOR PRINTED CIRCUIT BOARDS	
1 PLC ± -		APPLICATION SPEC	SIZE A2	CAGE CODE 00779
2 PLC ± -			DRAWING NO C=216548	RESTRICTED TO
3 PLC ± -				
4 PLC ± -				
ANGLES ± -				
MATERIAL SEE TABLE	FINISH SEE TABLE	WEIGHT -	SCALE -	SHEET 2 OF 3
		CUSTOMER DRAWING		REV J5

THIS DRAWING IS UNPUBLISHED. RELEASED FOR PUBLICATION  
 © COPYRIGHT - By - ALL RIGHTS RESERVED.

LOC	DIST	REVISIONS					
H	-	P	LTR	DESCRIPTION	DATE	DWN	APVD
				SEE SHEET 1/3			

NOTES:

1. TOLERANCES UNLESS OTHERWISE SPECIFIED: ±0.15
2. FOR APPLICATION INFORMATION SEE AMP SPEC. 114-19019.
3. FOR PERFORMANCE REQUIREMENTS SEE AMP SPEC. 108-19064

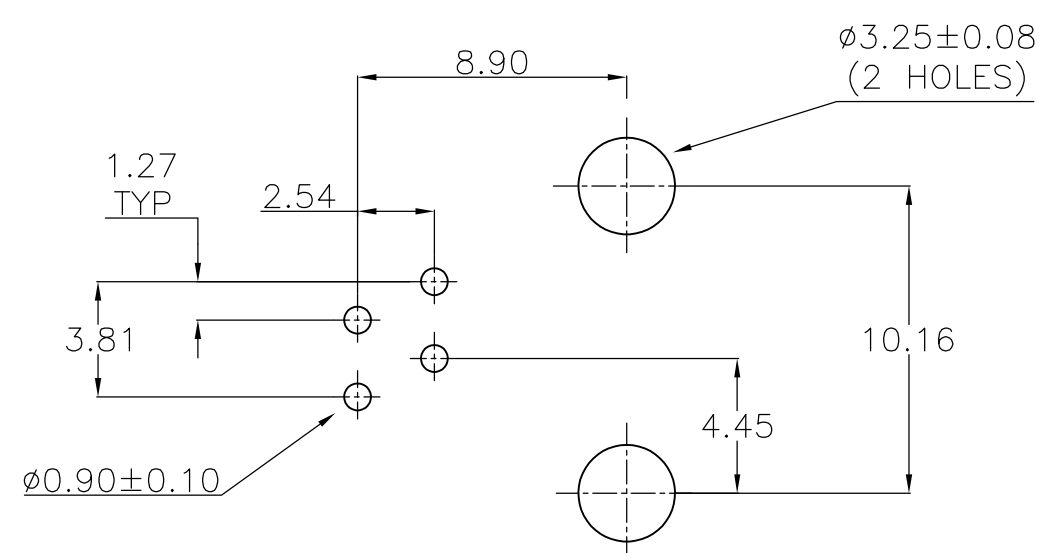
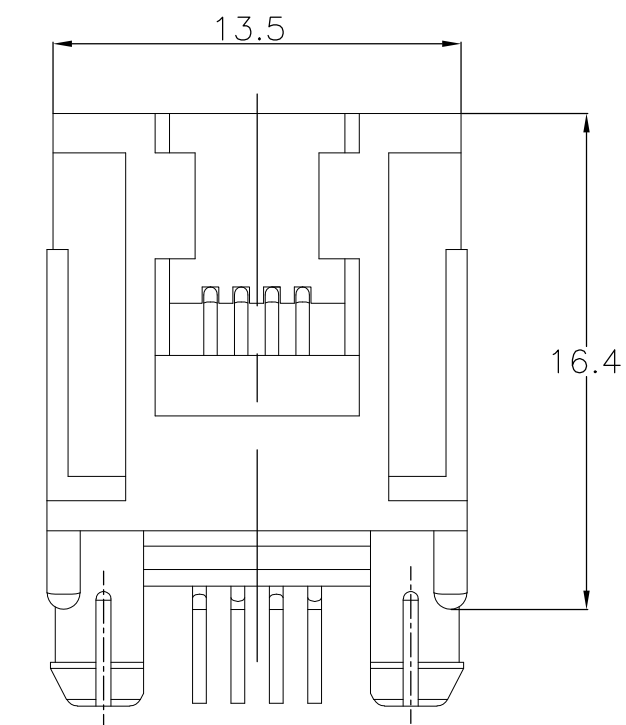
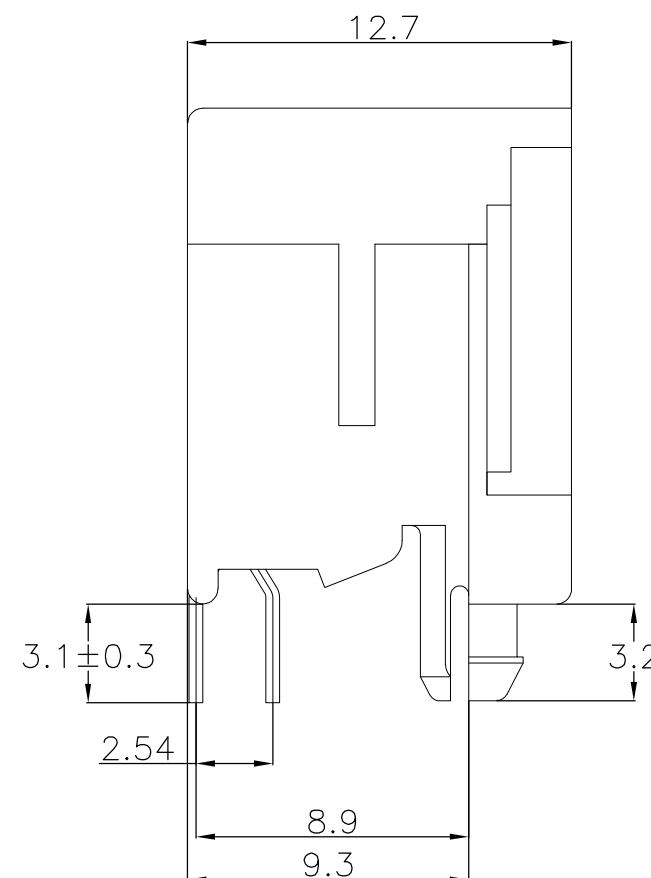
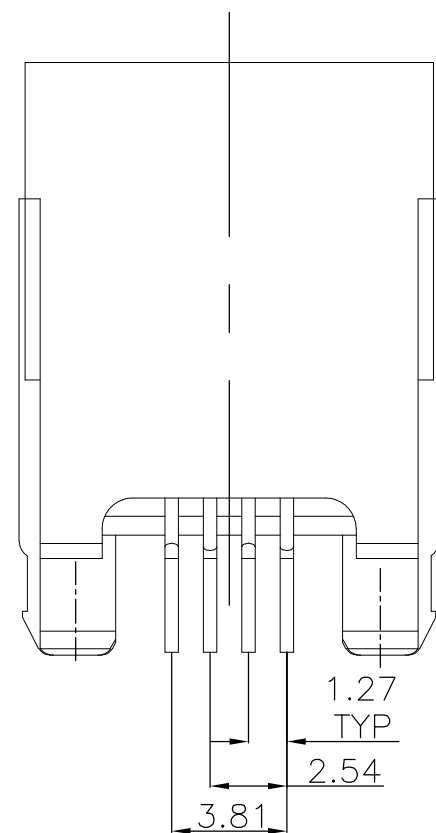
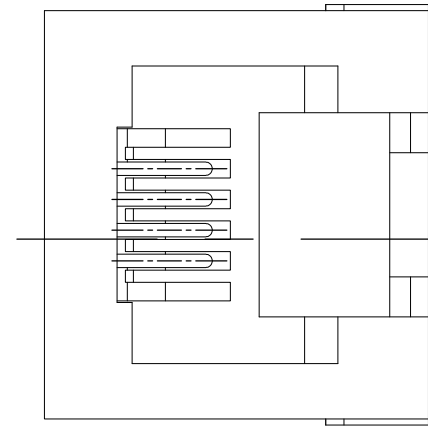

PRINTED CIRCUIT BOARD LAYOUT

[VIEW SHOWN IS CIRCUIT (NONCOMPONENT) SIDE OF BOARD.]  
 TOLERANCES UNLESS OTHERWISE SPECIFIED: ±0.05  
 PRINTED CIRCUIT BOARD THICKNESS: 1.6 mm NOMINAL.

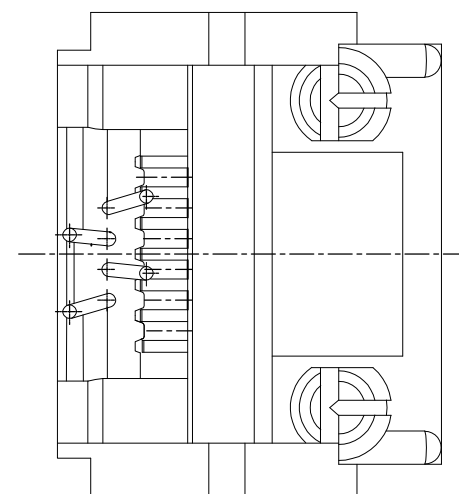

PACKAGING	REMARKS	FINISH	MATERIAL	PART NUMBER
800 PCS. ON A 60cm. DIA. REEL	6 POSITIONS/ 4 CONTACTS.	IN CONTACT AREA: 1.2µm MIN. SEL. GOLD OVER 1.2µm MIN. NICKEL SOLDER TINES: 2.0µm MIN. TIN OVER 1.2µm MIN. NICKEL	HOUSING: PBT,UL 94V-V0 COLOR: GRAY CONTACTS: PHOSPHOR BRONZE	216548-6
800 PCS. ON A 60cm. DIA. REEL	6 POSITIONS/ 4 CONTACTS.	IN CONTACT AREA: 1.2µm MIN. SEL. GOLD OVER 1.2µm MIN. NICKEL SOLDER TINES: 2.0µm MIN. TIN OVER 1.2µm MIN. NICKEL	HOUSING: PBT,UL 94V-HB COLOR: BLACK CONTACTS: PHOSPHOR BRONZE	216548-5

THIS DRAWING IS A CONTROLLED DOCUMENT.		DWN J.v.LIEMPT 22JAN92	<b>STE</b> TE Connectivity	
DIMENSIONS: mm		CHK C.STERKEN		
TOLERANCES UNLESS OTHERWISE SPECIFIED:		APVD L.V.SOEST	NAME	
0 PLC ± -		PRODUCT SPEC	MODULAR JACK, 6 POS. TOP ENTRY, SMALL SIZE WITHOUT PANEL STOPS, FOR PRINTED CIRCUIT BOARDS	
1 PLC ± -		APPLICATION SPEC	SIZE A2	CAGE CODE 00779
2 PLC ± -			DRAWING NO C=216548	RESTRICTED TO
3 PLC ± -			SCALE -	SHEET 3 OF 3
4 PLC ± -			REV J5	
ANGLES ± -				
MATERIAL SEE TABLE	FINISH SEE TABLE	WEIGHT -	CUSTOMER DRAWING	