

## 2-5174341-5 Product Details

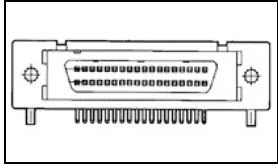

**2-5174341-5**

TE Internal Number: 2-5174341-5



### .050 Series Board Mount Connectors

 Always EU RoHS/ELV Compliant (Statement of Compliance)

#### Product Highlights:

- Connector
- Connector Style = Plug
- 68 Positions
- PCB Mounting Orientation = Right Angle
- Termination Method to PC Board = Through Hole - Solder

### Documentation & Additional Information

#### Product Drawings:

- [POST HEADER \(HORIZONTAL, WITH R/L\) AMPLIMITE .050 SE...](#) (PDF, English)

#### Catalog Pages/Data Sheets:

- None Available

#### Product Specifications:

- None Available

#### Application Specifications:

- None Available

#### Instruction Sheets:

- None Available

#### CAD Files: (CAD Format & Compression Information)

- [2D Drawing](#) (DXF, Version A)
- [3D Model](#) (IGES, Version A)
- [3D Model](#) (STEP, Version A)

#### Additional Information:

- [Product Line Information](#)

#### Related Products:

- [Tooling](#)

### Product Features (Please use the Product Drawing for all design activity)

#### Product Type Features:

- [Product Type](#) = Connector
- PCB Mounting Orientation = Right Angle
- Termination Method to PC Board = Through Hole - Solder
- PCB Mount Retention = With
- PCB Mount Retention Type = Boardlock(s)
- [PCB Mount Alignment](#) = Without
- [Shell Type](#) = Full Metal
- [Product Series](#) = Series II
- Shell Material = Zinc Die Cast
- Post Plate Material = Thermoplastic

#### Mechanical Attachment:

- Mating Retention Type = Latching

#### Electrical Characteristics:

- [Shielded](#) = Yes

#### Termination Features:

- [Termination Post Length](#) (mm [in]) = 2.90 [0.114]

#### Body Features:

- Mating Retention = With
- Post Plating = Tin over Nickel
- Shell Plating = Nickel over Copper
- Retention Leg Material = Nickel
- Retention Leg Plating = Brass

#### Contact Features:

- [Contact Plating, Mating Area, Material](#) = Gold (30)
- Contact Base Material = Phosphor Bronze

#### Housing Features:

- Connector Style = Plug
- Mating Alignment = Without
- Centerline (mm [in]) = 1.27 [0.050]
- Housing Material = Thermoplastic - GF
- UL Flammability Rating = UL 94V-0

#### Configuration Features:

- [Number of Positions](#) = 68

#### Industry Standards:

- [RoHS/ELV Compliance](#) = RoHS compliant, ELV compliant
- [Lead Free Solder Processes](#) = Wave solder capable to 260°C, Wave solder capable to 240°C, Wave solder capable to 265°C
- RoHS/ELV Compliance History = Always was RoHS compliant
- Post Plate Flammability Rating = UL 94V-0

#### Other:

- Brand = AMP

THIS DRAWING IS UNPUBLISHED. RELEASED FOR PUBLICATION APR , 1988.  
 © COPYRIGHT 1988 BY TYCO ELECTRONICS CORPORATION. ALL RIGHTS RESERVED.

LOC	DIST	REVISIONS			
P	LTR	DESCRIPTION	DATE	DWN	APVD
J		A	REVISED ECR-05-006022	1JUL05	L.Z S.Y
		A1	REVISED PER ECO-09-024927	09NOV09	KK AEG

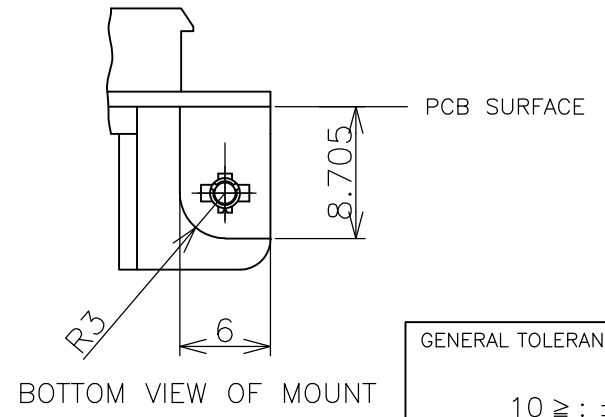
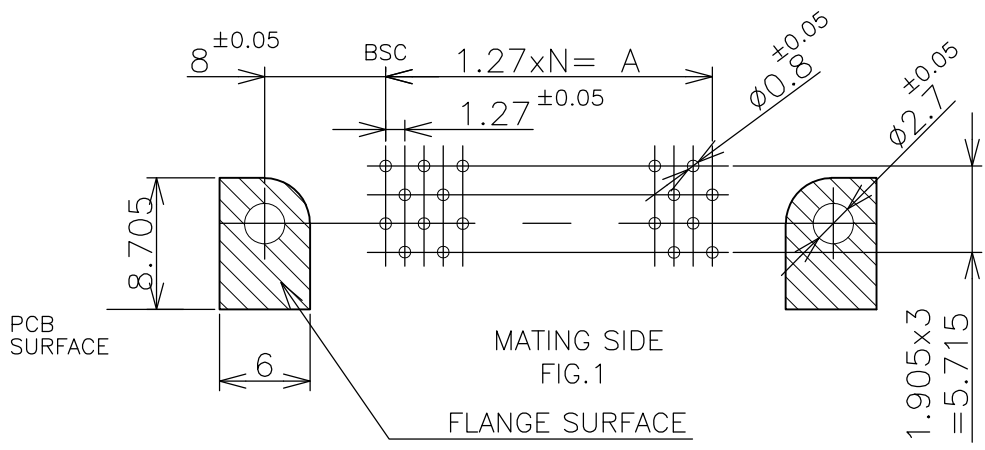
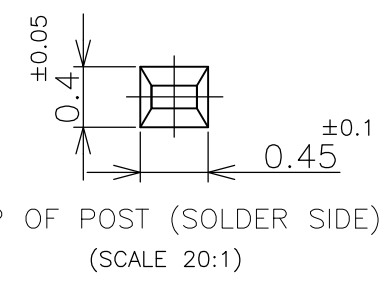
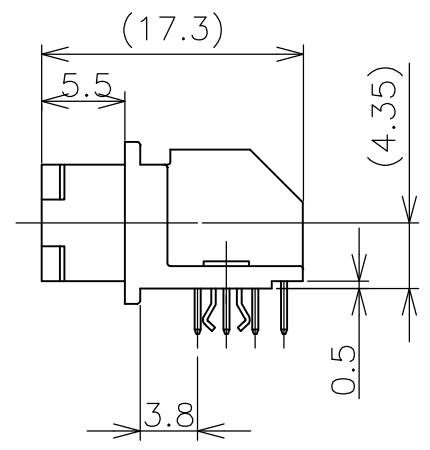
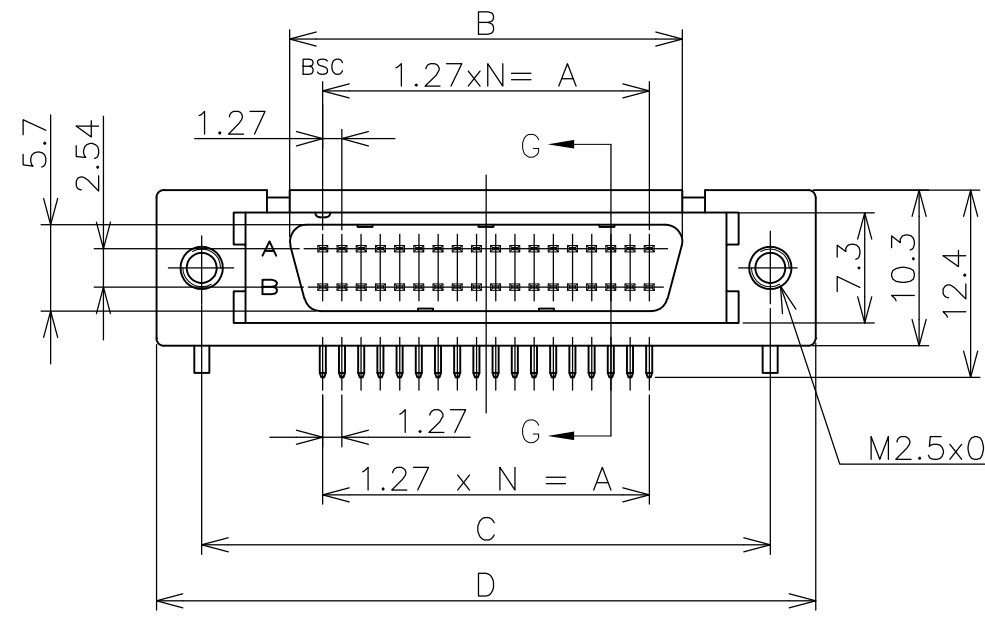
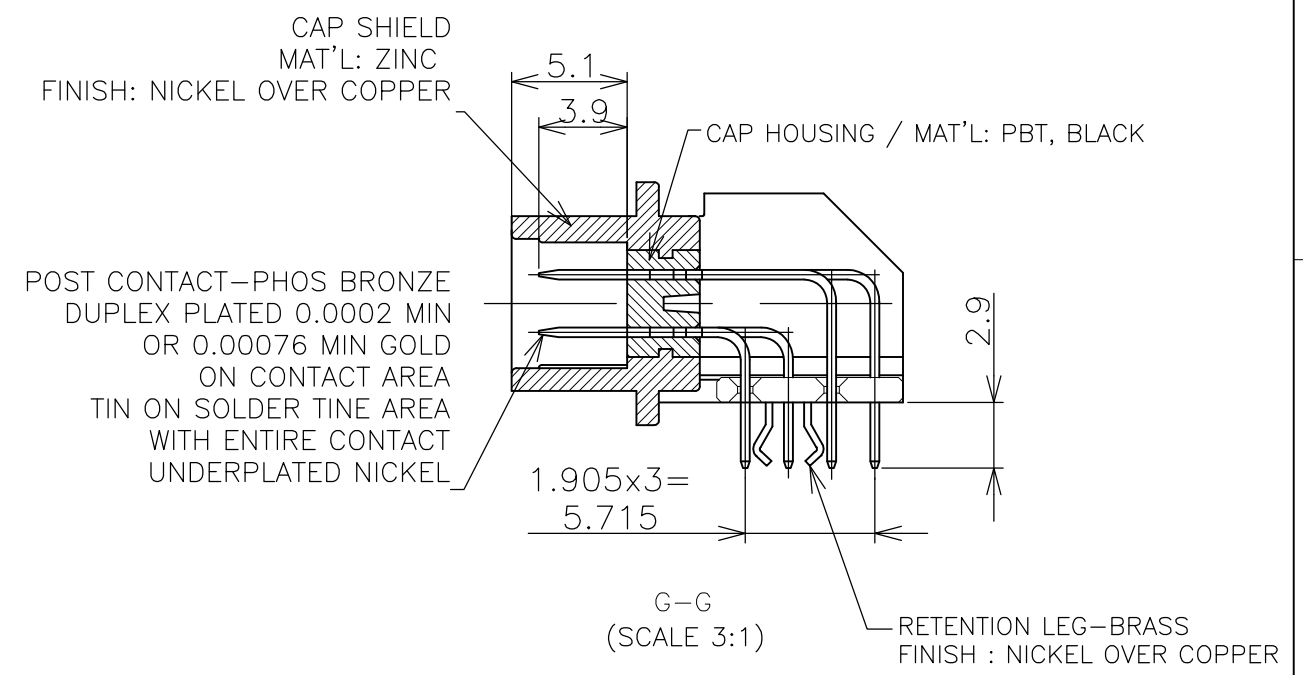
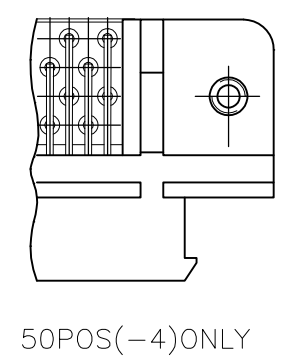
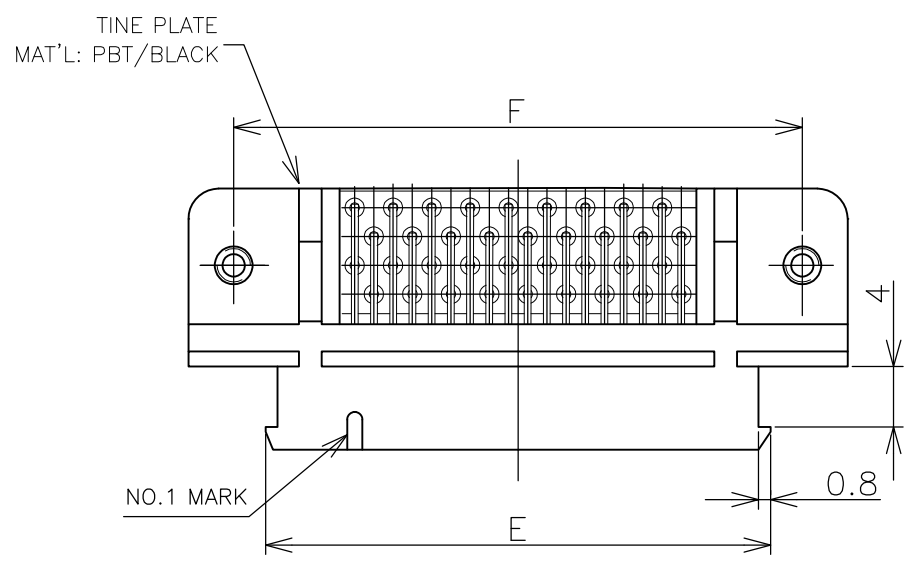

GENERAL TOLERANCE

10 ≥ : ±0.2  
 30 ≥ > 10: ±0.25  
 100 ≥ > 30: ±0.3  
 ANGLES: ±3°

POS	N	A	B	C	D	E	F	GOLD THK	PART NO.
96	47	59.69	64.06	75.7	81.7	71.49	75.7	0.00076 MIN	4-2-6
68	33	41.91	46.28	57.9	63.9	53.71	57.9		2--5
50	24	30.48	34.85	46.5	52.5	42.28	46.5		4-2-4
28	13	16.51	20.88	32.5	38.5	28.31	32.5		4-2-2
20	9	11.43	15.8	27.4	33.4	23.23	27.4	0.0002 MIN	4-2-1
96	47	59.69	64.06	75.7	81.7	71.49	75.7		4--6
68	33	41.91	46.28	57.9	63.9	53.71	57.9		4--5
50	24	30.48	34.85	46.5	52.5	42.28	46.5		4--4
36	17	21.59	25.96	37.6	43.6	33.39	37.6	0.0002 MIN	4--3
28	13	16.51	20.88	32.5	38.5	28.31	32.5		4--2
20	9	11.43	15.8	27.4	33.4	23.23	27.4		4--1

- 1 P.C BOARD HOLE LAY-OUT AS SHOWN FIG.1
- 2 USED SCREW SIZE; M2.5 PANHEAD SCREW
- 3 CONNECTOR TO BE MATED;  
X-5174340-X
- 4 OBSOLETE PARTS: OBSOLETE CIS STREAMLINING PER D.RENAUD/D.SINISI

THIS DRAWING IS A CONTROLLED DOCUMENT.

DWN Roy Hao 17Aug04	Tyco Electronics AMP K.K. Kawasaki, Japan
CHK Steven Yao 17Aug04	
APVD I.Enomoto 17Aug04	
PRODUCT SPEC 108-60037-1	NAME POST HEADER (HORIZONTAL, WITH R/L) AMPLIMITE .050 SERIES II CONN. TYPE B
APPLICATION SPEC	SIZE A3 CAGE CODE 00779 DRAWING NO C-5174341 RESTRICTED TO
MATERIAL SEE ABOVE	WEIGHT
FINISH SEE ABOVE	CUSTOMER DRAWING

SCALE 2:1 SHEET 1 OF 1 REV A1