

THIS DRAWING IS UNPUBLISHED. RELEASED FOR PUBLICATION, 19 .  
 © COPYRIGHT 19 BY AMP INCORPORATED. ALL INTERNATIONAL RIGHTS RESERVED.

LOC	DIST	P	F	REVISIONS				
G	14			ZONE	LTR	DESCRIPTION	DATE	APPD
					N	REV / 0720-0953-96	18JUN96	ME BB

<b>AMP</b> WIRE RANGE	Listed	LR7189 Certified
16-14 AWG SOLID OR STRANDED	16-14 AWG SOLID OR STRANDED	16-14 AWG SOLID OR STRANDED

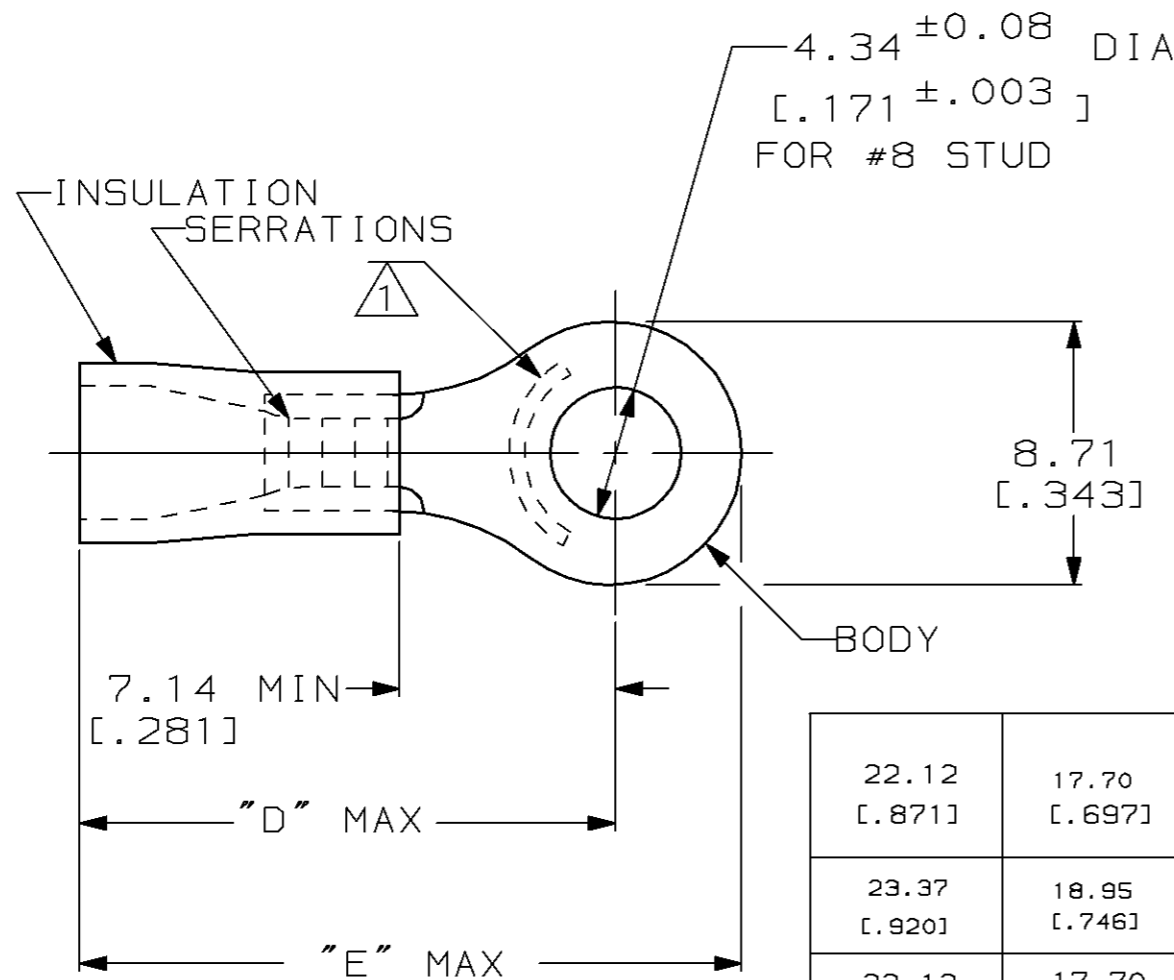

- 1 STAMP AMP 16-14\* APPROX AS SHOWN
- 2 TONGUE MATERIAL THK: 0.79<sup>±0.05</sup> [0.031<sup>±.002</sup>]
- 3 SUPERSEDED BY 8-34160-1

"E"	"D"	WIRE INSULATION DIA	QTY	PACKAGE TYPE	PART NUMBER
22.12 [0.871]	17.70 [0.697]	2.92-4.32 [0.115-.170]	50	LOOSE PC, BAG	8-34160-5 <sup>3</sup>
			5	LOOSE PC, BLS	8-34160-4
			100	LOOSE PC, BOX	8-34160-1
23.37 [0.920]	18.95 [0.746]	3.81-.635 [0.150-.250]	5000	ON TAPE, REEL	2-34160-3
			-	LOOSE PIECE	2-34160-2
22.12 [0.871]	17.70 [0.697]	2.92-4.32 [0.115-.170]	5000	ON TAPE, REEL	2-34160-1
			-	LOOSE PIECE	34160

**AMP INCORPORATED  
CUSTOMER SERVICE SYSTEMS**

FOR ADDITIONAL PRODUCT INFORMATION OR COPIES OF DRAWINGS AND TECHNICAL DOCUMENTS	PRODUCT INFORMATION CENTER 1-800-522-6752
FOR APPLICATION TOOLING INFORMATION	TOOLING ASSISTANCE CENTER 1-800-722-1111
FOR ORDER ENTRY	1-800-526-5142

MAX RECOMMENDED OPERATING TEMPERATURE:

90°C MAX

VOLTAGE RATING:  
NOT APPLICABLE

CIRCULAR MIL AREA:  
1.04-2.62mm<sup>2</sup> [2,050-5,180]  
SOLID OR STRANDED

THIS DRAWING IS A CONTROLLED DOCUMENT FOR AMP INCORPORATED. IT IS SUBJECT TO CHANGE AND THE CONTROLLING ENGINEERING ORGANIZATION SHOULD BE CONTACTED FOR THE LATEST REVISION.

DO NOT SCALE PRINT, UNLESS SPECIFIED  
DIMENSIONS IN mm [INCHES]  
TOLERANCES ON:  
2 PLC DEC ± 0.20 [0.008]  
3 PLC DEC ± -  
ANGLES ± -

MATERIAL  
COPPER PER ASTM B-152  
PVC, COLOR, BLUE

FINISH  
TIN PLATE  
PER ASTM B 545

DR 02/08/93  
OK SCHRUM

CHK 8/15/93  
RE HERSEY

APPD 8/15/93  
ML ELLIS

APPD 8/15/93  
M BARNABA

PRODUCT SPEC  
UL 486A

APPLICATION SPEC  
NOT AVAILABLE

WEIGHT -

**AMP** AMP Incorporated  
Harrisburg, PA 17105-3608

NAME  
TERMINAL, RING TONGUE, PLASTI-GRIP™  
WIRE SIZE, 16-14 AWG

SIZE	CAGE CODE	DRAWING NO
B	00779	C-34160
SCALE	SHEET	
4:1	1 OF 1	