

THIS DRAWING IS A CONTROLLED DOCUMENT
DWG NO C.345208

USED ON -

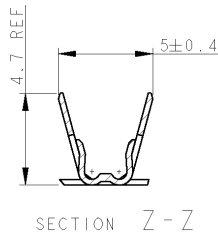

WIRE RANGE ID MARK
("M" SIZE MARK)
(STAMPED ON BOTTOM)

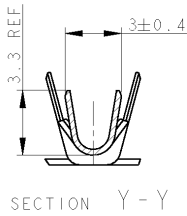
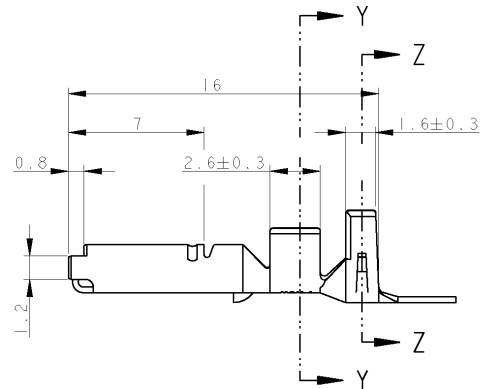
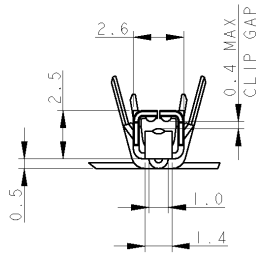
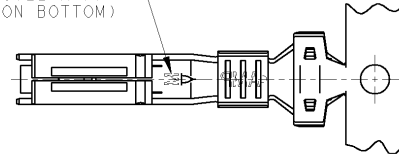

NOTES:

1. WIRE DETAILS: 0.75-1.5mm², 1.7-2.4 INSULATION DIA.
2. SIMILAR TO PART NUMBER 173631

LOC	B	EB00-0283-02	27/08/02	MJG	BB		
	A	EB00-0191-02	1-7-02	-	-	APPL FEED	TRIMMING BURR
	O	RELEASE FOR PRODUCTION, ECN C6261	27-8-92	-	-	VDW	IDW
DIST	I		16-10-91	MM	-	REELING	107-
E	P	LTR	REVISION RECORD	DATE	DWN	APVD	SPLICE
							115-1018

PRE-TIN FINISH	BRASS MATERIAL	345208-1 PART NO
WIRE RANGE 0.75-1.5	DIMENSIONS: mm DIMENSIONS APPLY BEFORE PLATING TOLERANCES UNLESS OTHERWISE SPECIFIED:	Tyco Electronics UK Ltd, Barton Tors, Bideford, Devon, EX39 4HE.
INSUL RANGE 1.7-2.4	2 PLC ± 0.5 3 PLC ± 0.5 ANGLES ± 0.5	
SURF AREA	CHK 2AUG2002 M. GREENER DWN 31 JUL 2002 D. ROUSE	NAME .070 SERIES RECEPTACLE CONTACT
	APVD 2AUG2002 B. BAKER	SCALE 5:1 SIZE A3 DRAWING NO C345208 SHEET OF 1
		REV B

AMP 3692-2 REV 8 31MAR2000

THIS INFORMATION IS CONFIDENTIAL AND PROPRIETARY TO TYCO ELECTRONICS. IT IS NOT TO BE DISCLOSED TO ANYONE OTHER THAN TYCO ELECTRONICS PERSONNEL, WITHOUT WRITTEN PERMISSION FROM TYCO ELECTRONICS CORPORATION, HARRISBURG, PENNSYLVANIA, USA.

PL2/ENGINEER DRAWING