



Have a Question?
 Chat with a Product
 Information Specialist

What can we help you find?

[Products](#) |
 [Industries](#) |
 [Resources](#) |
 [About TE](#) |
 [My Account](#) |
 [Innovation](#) |
 [Support Center](#)

35109 Product Details

[Share](#) |
 [Print](#) |
 [Email](#)

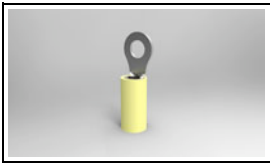

35109

TE Internal Number: 35109

Active

[View 3D PDF](#)

Ring and Spade Tongue Terminals

Always EU RoHS/ELV Compliant (Statement of Compliance)

Product Highlights:

- Terminal Shape = Ring Tongue
- Receptacle Style = Straight
- Body Style = PIDG
- Barrel Type = Closed Barrel
- Wire/Cable Type = Regular Wire

[View all Features](#)

Quick Links

- ▶ [Pricing & Availability](#)
- ▶ [Search for Tooling](#)
- ▶ [Product Feature Selector](#)
- ▶ [Contact Us About This Product](#)

[Add to My Part List](#) |
 [Request Sample](#) |
 [Find Similar Products](#) |
 [Buy Product](#)

Documentation & Additional Information

Product Drawings:

- [TERMINAL, RING TONGUE, PIDG WIRE SIZE: 12-10 AWG \(PDF, English\)](#)

Catalog Pages/Data Sheets:

- None Available

Product Specifications:

- None Available

Application Specifications:

- [Pre-Insulated Diamond Grip \(PIDG\) Terminals, Splices... \(PDF, English\)](#)

Instruction Sheets:

- None Available

CAD Files: [\(CAD Format & Compression Information\)](#)

- [2D Drawing \(DXF, Version V\)](#)
- [3D Model \(IGES, Version V\)](#)
- [3D Model \(STEP, Version V\)](#)

[List all Documents](#)

Related Products:

- [Tooling](#)

Product Features (Please use the Product Drawing for all design activity)

Product Type Features:

- Terminal Shape = Ring Tongue
- Receptacle Style = Straight
- Barrel Type = Closed Barrel
- Wire/Cable Type = Regular Wire
- Insulation = Yes
- Insulation Support = Insulation Support
- Stud Diameter (mm [in]) = 5.00 [0.197]
- Stud Size = 10
- Shape = RING-041
- Heavy Duty = No
- Finish = Tin
- Color = Yellow

Electrical Characteristics:

- Voltage (VAC) = 300

Termination Features:

- Wire/Cable Size (CMA) = 5,180 - 13,100

Dimensions:

- Insulation Diameter (mm [in]) = 6.35 [.250] Max.

Body Features:

- Body Style = PIDG
- Wire Range (mm [AWG]) = 3.00-6.00² [12-10]
- Material = Copper
- Tongue Material Thickness (mm [in]) = 0.99 [0.039]
- Insulation Material = Nylon

Contact Features:

- Class = 1 & 2

Industry Standards:

- Government/Industry Qualification = Yes
- Government/Industry Part Number = MS25036-112
- RoHS/ELV Compliance = RoHS compliant, ELV compliant

- Lead Free Solder Processes = Not relevant for lead free process
- RoHS/ELV Compliance History = Always was RoHS compliant

Packaging Features:

- Packaging Method = Loose Piece

Other:

- Brand = AMP

Corporate Information

[About TE](#)

[Investors](#)

Quick Links

[Distributor Inventory](#)

[Product Cross Reference](#)

Customer Support

[Email or Chat With Us](#)

[Find a Phone Number](#)

THIS DRAWING IS UNPUBLISHED. RELEASED FOR PUBLICATION
 © COPYRIGHT - By - ALL RIGHTS RESERVED.

| LOC | DIST | REVISIONS | | | | | |
|-----|------|-----------|-----|---------------------------|---------|-----|------|
| | | P | LTR | DESCRIPTION | DATE | DWN | APVD |
| G | 14 | | S2 | REVISED PER ECO-11-004587 | 11MAR11 | RK | HMR |

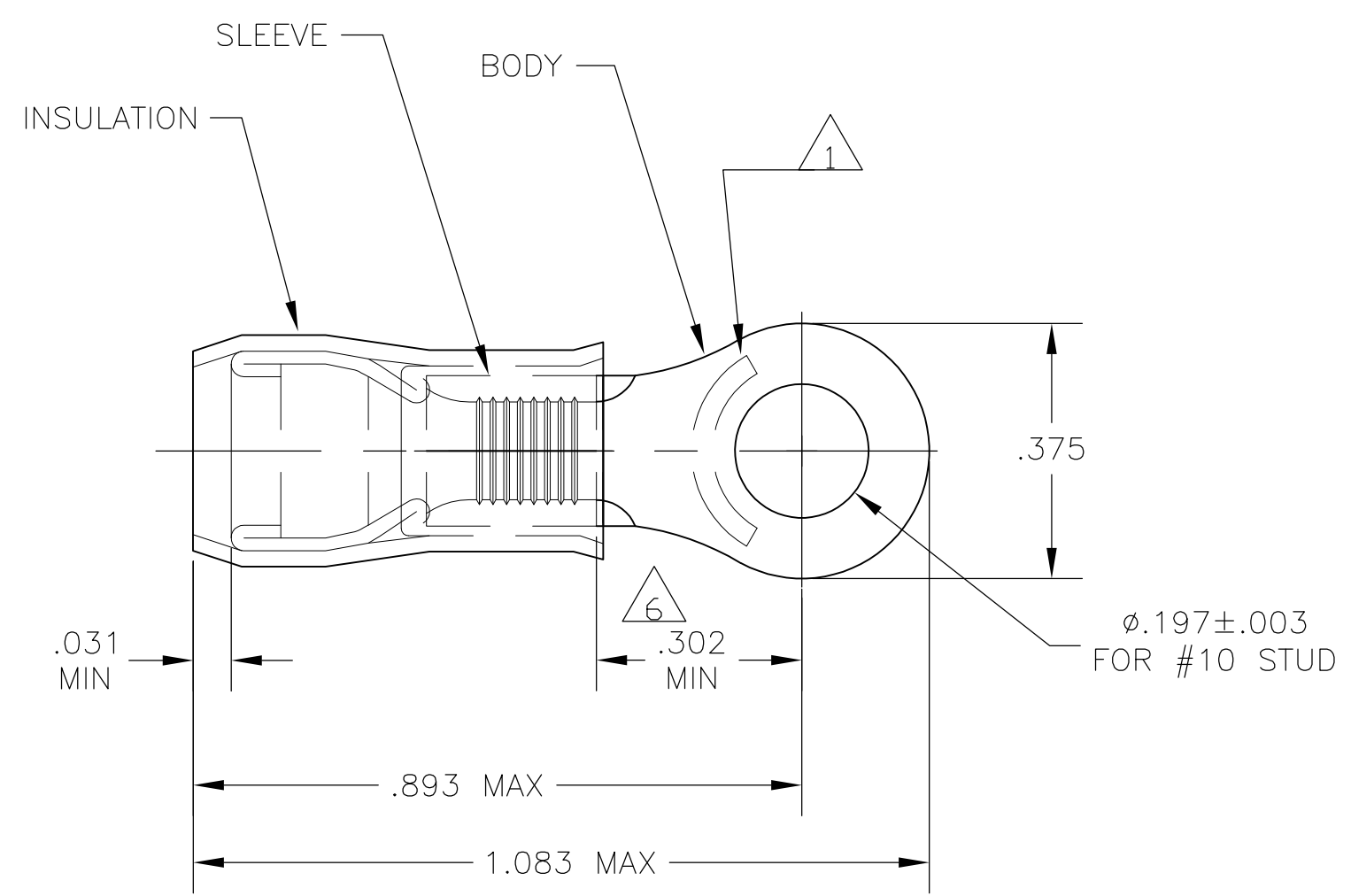

- 1 STAMP "AMP 12-10*" APPROX AS SHOWN
- 2 WIRE INSULATION DIA: .150-.250
- 3 TONGUE MATERIAL THK: .039±.002
- 4 BODY & SLEEVE: TIN PLATE .000100 MIN EXT THK PER ASTM B545
- 5 BODY & SLEEVE- CU PER ASTM B152 INSULATION - NYLON PER ASTM D4066 COLOR - YELLOW
- 6 APPLIES FROM EDGE OF METAL WIRE BARREL TO CENTER OF STUD HOLE.
- 7 MEETS MS25036-112, CLASS 1 & 2
- 8 MEETS MS25036-112, CLASS 2

| | | | |
|-------------------------|------|------------------|-----------|
| SUPERSEDED BY 8-35109-5 | 25 | LOOSE PIECE, BOX | 9-35109-4 |
| SUPERSEDED BY 8-35109-5 | 5 | LOOSE PIECE, BOX | 8-35109-4 |
| | 25 | LOOSE PIECE, BAG | 8-35109-5 |
| | 100 | LOOSE PIECE, BOX | 8-35109-1 |
| | 2500 | ON TAPE & REEL | 8-35109-1 |
| | --- | LOOSE PIECE | 35109 |
| QTY | | PACKAGE TYPE | PART NO |

| | | | | | | | | | |
|--|--|---|--|--|---------------------------------|--|--------------------|-----------------------|--------------------|
| CUSTOMER SERVICE SYSTEMS | | MAX RECOMMENDED OPERATING TEMPERATURE: 105°C MAX | THIS DRAWING IS A CONTROLLED DOCUMENT. | | DWN JR RUTH 16DEC09 | TE Connectivity TERMINAL, RING TONGUE, PIDG WIRE SIZE: 12-10 AWG | | | |
| FOR ADDITIONAL PRODUCT INFORMATION OR COPIES OF DRAWINGS AND TECHNICAL DOCUMENTS | PRODUCT INFORMATION CENTER 1-800-522-6752 | VOLTAGE RATING: 300 VOLT MAX | DIMENSIONS: INCHES | TOLERANCES UNLESS OTHERWISE SPECIFIED: | CHK T MICHELUTTI 16DEC09 | | | | |
| FOR APPLICATION TOOLING INFORMATION | TOOLING ASSISTANCE CENTER 1-800-722-1111 | CIRCULAR MIL AREA: 2.62-6.64mm² [5,180-13,100] STRANDED OR SOLID | | 0 PLC ± - 1 PLC ± - 2 PLC ± - 3 PLC ± .008 4 PLC ± - ANGLES ± - | APVD T MICHELUTTI 16DEC09 | APPLICATION SPEC | | | |
| FOR ORDER ENTRY | 1-800-526-5142 | | MATERIAL - 5 | FINISH - 4 | PRODUCT SPEC - | SIZE A3 | CAGE CODE 00779 | DRAWING NO C-35109 | RESTRICTED TO - |
| CUSTOMER DRAWING | | | | | WEIGHT - | SCALE 4:1 | SHEET 1 OF 1 | REV S2 | |