

## 36203 Product Details

[Share](#) [Print](#) [Email](#)



**36203**

TE Internal Number: 36203

 Active

 [View 3D PDF](#)

### Ring and Spade Tongue Terminals

 Always EU RoHS/ELV Compliant  
(Statement of Compliance)

#### Product Highlights:

- Terminal Shape = Ring Tongue
- Receptacle Style = Straight
- Body Style = PIDG
- Barrel Type = Closed Barrel
- Wire/Cable Type = Regular Wire

[View all Features](#)

### Quick Links

- ▶ [Pricing & Availability](#)
- ▶ [Search for Tooling](#)
- ▶ [Product Feature Selector](#)
- ▶ [Contact Us About This Product](#)

[Add to My Part List](#)

[Request Sample](#)

[Find Similar Products](#)

[Buy Product](#)

### Documentation & Additional Information

#### Product Drawings:

- [WIRE TERMINAL PIDG - RING TONGUE WIRE SIZE: 16-14 HD \(PDF, English\)](#)

#### Catalog Pages/Data Sheets:

- None Available

#### Product Specifications:

- None Available

#### Application Specifications:

- [Pre-Insulated Diamond Grip \(PIDG\) Terminals, Splices... \(PDF, English\)](#)

#### Instruction Sheets:

- None Available

#### CAD Files: (CAD Format & Compression Information)

- [2D Drawing \(DXF, Version C\)](#)
- [3D Model \(IGES, Version C\)](#)
- [3D Model \(STEP, Version C\)](#)

[List all Documents](#)

#### Related Products:

- [Tooling](#)

### Product Features (Please use the Product Drawing for all design activity)

#### Product Type Features:

- [Receptacle Style](#) = Straight
- [Barrel Type](#) = Closed Barrel
- [Wire/Cable Type](#) = Regular Wire
- [Insulation](#) = Yes
- [Insulation Support](#) = Insulation Support
- Stud Size = 1/2 [M12]
- [Shape](#) = RING-041
- [Heavy Duty](#) = Yes
- [Finish](#) = Tin
- Color = Yellow/Black

#### Electrical Characteristics:

- Voltage (VAC) = 300

#### Termination Features:

- Wire/Cable Size (CMA) = 2,050 – 5,180

#### Body Features:

- [Body Style](#) = PIDG
- [Wire Range \(mm \[AWG\]\)](#) = 1.25-2.00<sup>2</sup> [16-14]
- [Material](#) = Copper
- [Insulation Material](#) = Nylon

#### Contact Features:

- [Terminal Shape](#) = Ring Tongue

#### Industry Standards:

- [Government/Industry Qualification](#) = No
- [RoHS/ELV Compliance](#) = RoHS compliant, ELV compliant
- [Lead Free Solder Processes](#) = Not relevant for lead free process
- [RoHS/ELV Compliance History](#) = Always was RoHS compliant

**Dimensions:**

- [Insulation Diameter \(mm \[in\]\)](#) = 6.35 [.250] Max.
- [Stud Diameter \(mm \[in\]\)](#) = 12.70 [0.500]
- [Tongue Material Thickness \(mm \[in\]\)](#) = 1.27 [0.050]

**Packaging Features:**

- [Packaging Method](#) = Loose Piece/Bulk

**Other:**

- [Brand](#) = AMP
- [Comment](#) = Heavy Duty for extra mechanical strength

**Corporate Information**

[About TE](#)  
[Investors](#)  
[News Room](#)  
[Supplier Portal](#)  
[Careers](#)  
[Terms & Conditions](#)  
[Privacy Policy](#)

**Quick Links**

[Distributor Inventory](#)  
[Product Cross Reference](#)  
[Documents & Drawings](#)  
[Product Compliance Support Center](#)  
[Site Map](#)

**Customer Support**

[Email or Chat With Us](#)  
[Find a Phone Number](#)  
[Knowledge Base](#)  
[Manage Your Account](#)

**Keep Me Informed**

THIS DRAWING IS UNPUBLISHED. RELEASED FOR PUBLICATION  
 © COPYRIGHT BY TYCO ELECTRONICS CORPORATION. ALL INTERNATIONAL RIGHTS RESERVED.

| LOC | DIST | REVISIONS |     |                           |         |     |      |
|-----|------|-----------|-----|---------------------------|---------|-----|------|
|     |      | P         | LTR | DESCRIPTION               | DATE    | DWN | APVD |
| G   | 14   |           | C1  | REVISED PER ECR-09-009459 | 12JUN09 | HMR | JR   |

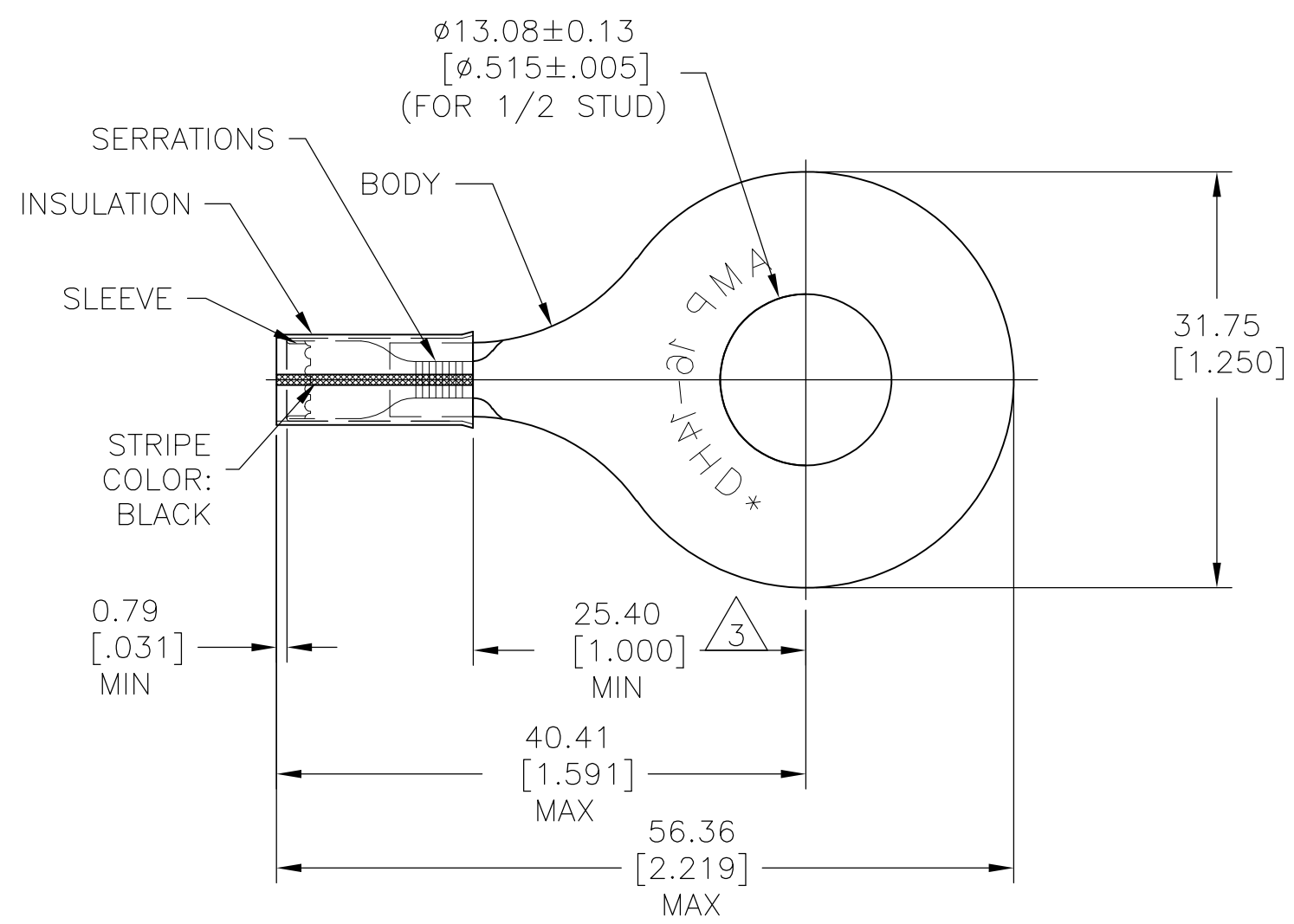

- 1 FOR 3.81[.150] TO 6.35[.250] WIRE INSULATION DIA
- 2 TONGUE MATERIAL THK 1.22±0.05[.048±.002]
- △ 3 APPLIES FROM EDGE OF METAL BARREL TO CENTERLINE OF STUD HOLE.

| QTY | DESCRIPTION   | MATERIAL & FINISH  | PART NO |
|-----|---------------|--|---------|
| 1   | WIRE TERMINAL | BODY: COPPER ASTM-B152<br>TIN PL ASTM-B545<br>SLEEVE: COPPER ASTM-B152<br>INSULATION: YELLOW NYLON | 36203   |

|  |  |  |  |  |
|--|--|--|--|--|
| THIS DRAWING IS A CONTROLLED DOCUMENT. |  | DWN RAGHAVEDRA 12JUN09                                     | Tyco Electronics Corporation<br>Harrisburg, PA 17105-3608    |  |
| DIMENSIONS: mm [INCHES]                |  | CHK JEFF RUTH 12JUN09                                      | NAME WIRE TERMINAL PIDG - RING TONGUE<br>WIRE SIZE: 16-14 HD |  |
| TOLERANCES UNLESS OTHERWISE SPECIFIED: |  | APVD TOM MICHIELUTTI 12JUN09                               | PRODUCT SPEC -   |  |
| 0 PLC ± -                              |  | APPLICATION SPEC -   |  |  |
| 1 PLC ± -                              |  | SIZE A3 CAGE CODE 00779 DRAWING NO C-36203 RESTRICTED TO - |  |  |
| 2 PLC ± -                              |  | WEIGHT -   |  |  |
| 3 PLC ± 0.20[.008]                     |  | CUSTOMER DRAWING SCALE 2:1 SHEET 1 OF 1 REV C1             |  |  |
| 4 PLC ± -                              |  |  |  |  |
| ANGLES ± .5°                           |  |  |  |  |
| MATERIAL -                             |  |  |  |  |
| FINISH -                               |  |  |  |  |