

Distributed by:

**JAMECO**<sup>®</sup>  
ELECTRONICS

**www.Jameco.com ♦ 1-800-831-4242**

The content and copyrights of the attached  
material are the property of its owner.

Jameco Part Number 751200

THIS DRAWING IS UNPUBLISHED. RELEASED FOR PUBLICATION  
 © COPYRIGHT BY TYCO ELECTRONICS CORPORATION. ALL RIGHTS RESERVED.

| LOC | DIST | REVISIONS |     |                          |         |     |      |
|-----|------|-----------|-----|--------------------------|---------|-----|------|
| CM  | 00   | P         | LTR | DESCRIPTION              | DATE    | DWN | APVD |
|     |      | H         |     | REV PER ECN 0G3B-0324-03 | 11JUN03 | SC  | DB   |

|          |       |                 |          |            |
|----------|-------|-----------------|----------|------------|
| YES      | 71.12 | [2.800]         | 28       | 5-643814-8 |
| YES      | 68.58 | [2.700]         | 27       | 5-643814-7 |
| YES      | 66.04 | [2.600]         | 26       | 5-643814-6 |
| YES      | 63.50 | [2.500]         | 25       | 5-643814-5 |
| YES      | 60.96 | [2.400]         | 24       | 5-643814-4 |
| YES      | 58.42 | [2.300]         | 23       | 5-643814-3 |
| YES      | 55.88 | [2.200]         | 22       | 5-643814-2 |
| YES      | 53.34 | [2.100]         | 21       | 5-643814-1 |
| YES      | 50.80 | [2.000]         | 20       | 5-643814-0 |
| YES      | 48.26 | [1.900]         | 19       | 4-643814-9 |
| YES      | 45.72 | [1.800]         | 18       | 4-643814-8 |
| YES      | 43.18 | [1.700]         | 17       | 4-643814-7 |
| YES      | 40.64 | [1.600]         | 16       | 4-643814-6 |
| YES      | 38.10 | [1.500]         | 15       | 4-643814-5 |
| YES      | 35.56 | [1.400]         | 14       | 4-643814-4 |
| YES      | 33.02 | [1.300]         | 13       | 4-643814-3 |
| YES      | 30.48 | [1.200]         | 12       | 4-643814-2 |
| YES      | 27.94 | [1.100]         | 11       | 4-643814-1 |
| YES      | 25.40 | [1.000]         | 10       | 4-643814-0 |
| YES      | 22.86 | [.900]          | 9        | 3-643814-9 |
| YES      | 20.32 | [.800]          | 8        | 3-643814-8 |
| YES      | 17.78 | [.700]          | 7        | 3-643814-7 |
| YES      | 15.24 | [.600]          | 6        | 3-643814-6 |
| YES      | 12.70 | [.500]          | 5        | 3-643814-5 |
| YES      | 10.16 | [.400]          | 4        | 3-643814-4 |
| YES      | 7.62  | [.300]          | 3        | 3-643814-3 |
| YES      | 5.08  | [.200]          | 2        | 3-643814-2 |
| NO       | 71.12 | [2.800]         | 28       | 2-643814-8 |
| NO       | 68.58 | [2.700]         | 27       | 2-643814-7 |
| NO       | 66.04 | [2.600]         | 26       | 2-643814-6 |
| NO       | 63.50 | [2.500]         | 25       | 2-643814-5 |
| NO       | 60.96 | [2.400]         | 24       | 2-643814-4 |
| NO       | 58.42 | [2.300]         | 23       | 2-643814-3 |
| NO       | 55.88 | [2.200]         | 22       | 2-643814-2 |
| NO       | 53.34 | [2.100]         | 21       | 2-643814-1 |
| NO       | 50.80 | [2.000]         | 20       | 2-643814-0 |
| NO       | 48.26 | [1.900]         | 19       | 1-643814-9 |
| NO       | 45.72 | [1.800]         | 18       | 1-643814-8 |
| NO       | 43.18 | [1.700]         | 17       | 1-643814-7 |
| NO       | 40.64 | [1.600]         | 16       | 1-643814-6 |
| NO       | 38.10 | [1.500]         | 15       | 1-643814-5 |
| NO       | 35.56 | [1.400]         | 14       | 1-643814-4 |
| NO       | 33.02 | [1.300]         | 13       | 1-643814-3 |
| NO       | 30.48 | [1.200]         | 12       | 1-643814-2 |
| NO       | 27.94 | [1.100]         | 11       | 1-643814-1 |
| NO       | 25.40 | [1.000]         | 10       | 1-643814-0 |
| NO       | 22.86 | [.900]          | 9        | 643814-9   |
| NO       | 20.32 | [.800]          | 8        | 643814-8   |
| NO       | 17.78 | [.700]          | 7        | 643814-7   |
| NO       | 15.24 | [.600]          | 6        | 643814-6   |
| NO       | 12.70 | [.500]          | 5        | 643814-5   |
| NO       | 10.16 | [.400]          | 4        | 643814-4   |
| NO       | 7.62  | [.300]          | 3        | 643814-3   |
| NO       | 5.08  | [.200]          | 2        | 643814-2   |
| LEADFREE | DIM A | NO. OF CIRCUITS | PART NO. |            |

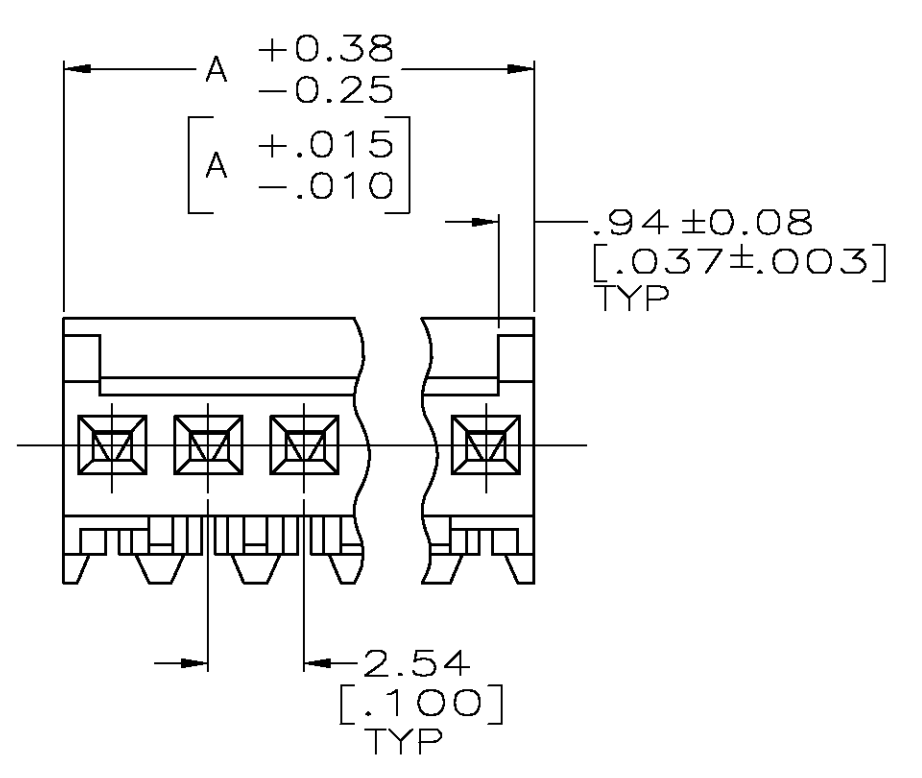
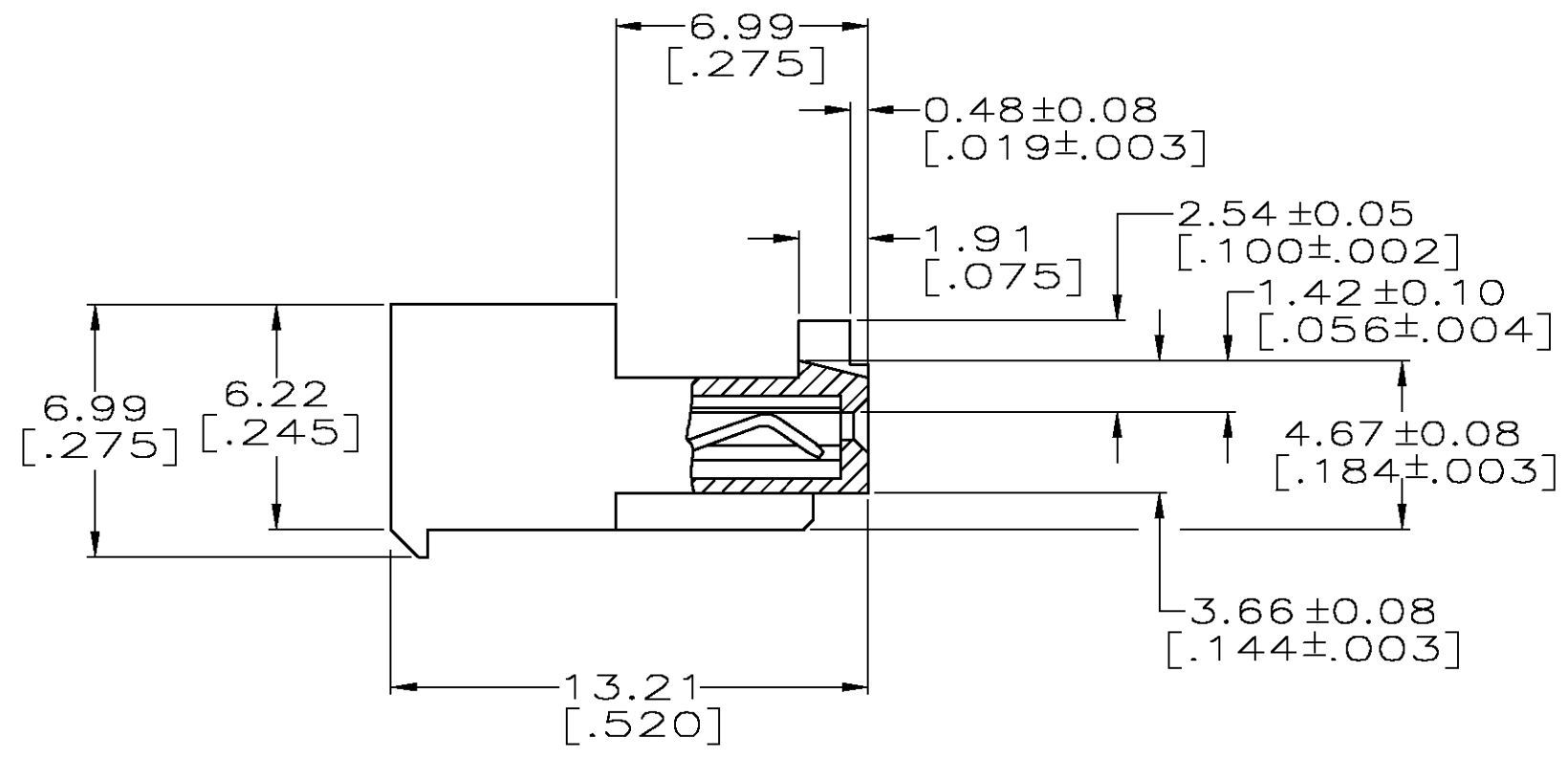
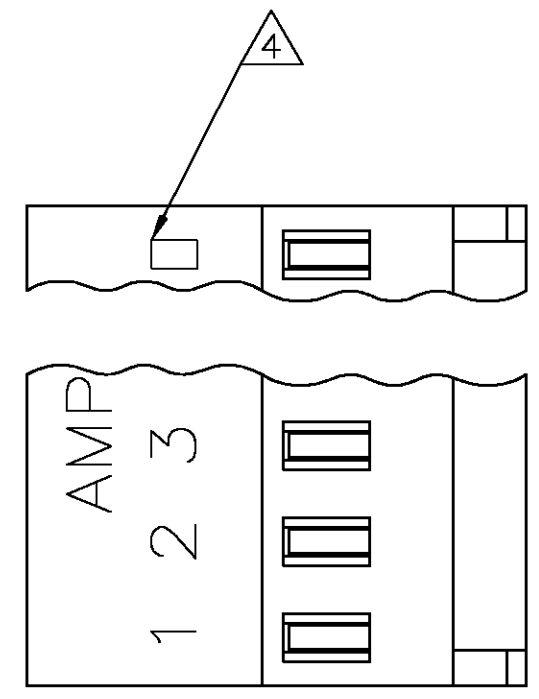

1 MATERIAL: CONNECTOR - NYLON UL94V-2 (WHITE).  
 CONTACTS - 0.30[.012] THICK COPPER ALLOY  
 BRIGHT TIN-LEAD .00203[.000080] MIN THICKNESS  
 FOR 643814-2 THRU 2-643814-8.  
 BRIGHT TIN .00305[.000120] MIN THICKNESS  
 FOR 3-643814-2 THRU 5-643814-8.

- CONTACTS ACCEPT 24 AWG WIRE WITH 1.52[.060] MAX INSULATION DIAMETER.
- CONTACTS MUST ACCEPT 0.64±0.03[.025] POST AND REMAIN LOCKED IN POSITION.
- IDENTIFICATION NUMBER FOR LAST CIRCUIT MAY NOT APPEAR ON ALL ASSEMBLIES.
- DIMENSIONS IN BRACKETS ARE IN INCHES.
- HOUSING FEATURES ARE: CLOSED END WITH LOCKING RAMP AND WITH POLARIZING TAB.

**METRIC**

|   |  |                                  |   |                              |
|---|--|----------------------------------|---|------------------------------|
| THIS DRAWING IS A CONTROLLED DOCUMENT.  |  | DWN<br>S. CARPENTER<br>11JUN2003 | Tyco Electronics Corporation<br>Harrisburg, PA 17105    |                              |
| DIMENSIONS:<br>INCHES   |  | CHK<br>D. BOSSI<br>11JUN2003     | NAME<br>MTA-100 CONNECTOR ASSEMBLY,<br>24 AWG, STANDARD |                              |
| TOLERANCES UNLESS OTHERWISE SPECIFIED:<br>0 PLC ±<br>1 PLC ±<br>2 PLC ±<br>3 PLC ± 0.13 [.005]<br>4 PLC ±<br>ANGLES ±<br>FINISH 1 |  | APVD<br>D. BOSSI<br>11JUN2003    | PRODUCT SPEC<br>108-1050                                |                              |
| MATERIAL 1  |  | APPLICATION SPEC<br>114-1019     | SIZE<br>A2  | CAGE CODE<br>00779           |
|   |  | WEIGHT                           | DRAWING NO<br>C=643814                                  | RESTRICTED TO<br>-           |
|   |  | CUSTOMER DRAWING                 |   | SCALE 5:1 SHEET 1 OF 1 REV H |

A/C BUSINESS GRP. 3323 177-34 'BARRY LEWIS'

643814

A