

## 5088450-3 Product Details

[Share](#) [Print](#) [Email](#)

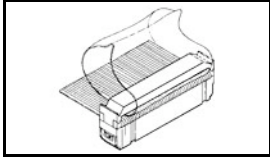

**5088450-3**

TE Internal Number: 5088450-3

 **Active**

 [View 3D PDF](#)

### AMP-LATCH Ribbon Cable Connectors

 **Always EU RoHS/ELV Compliant**  
(Statement of Compliance)

#### Product Highlights:

- AMP-LATCH Product Line
- Accessory Type = Pull Loop
- Accessory Color = Natural
- Phosphor Bronze Contact Base Material
- Gold or Palladium Nickel or Performance Based Contact Plating, Mating Area, Material

[View all Features](#)

### Quick Links

- ▶ [Pricing & Availability](#)
- ▶ [Search for Tooling](#)
- ▶ [Product Feature Selector](#)
- ▶ [Contact Us About This Product](#)

[Add to My Part List](#)

[Request Sample](#)

[Find Similar Products](#)

[Buy Product](#)

### Documentation & Additional Information

#### Product Drawings:

- [PULL LOOP, AMP-LATCH](#) (PDF, English)

#### Catalog Pages/Data Sheets:

- None Available

#### Product Specifications:

- None Available

#### Application Specifications:

- [AMP-LATCH 2 mm Receptacle Connectors](#) (PDF, English)

#### Instruction Sheets:

- None Available

#### CAD Files: (CAD Format & Compression Information)

- [2D Drawing](#) (DXF, Version 0)
- [3D Model](#) (IGES, Version 0)
- [3D Model](#) (STEP, Version 0)

[List all Documents](#)

#### Additional Information:

- [Product Line Information](#)

#### Related Products:

- [Tooling](#)

### Product Features (Please use the Product Drawing for all design activity)

#### Product Type Features:

- Product Line = AMP-LATCH
- Accessory Type = Pull Loop
- Accessory Color = Natural
- UL File Number = E28476
- CSA File Number = LR 7189

#### Contact Features:

- Contact Base Material = Phosphor Bronze
- [Contact Plating, Mating Area, Material](#) = Gold or Palladium Nickel or Performance Based

#### Industry Standards:

- [RoHS/ELV Compliance](#) = RoHS compliant, ELV compliant
- [Lead Free Solder Processes](#) = Not relevant for lead free process

#### Operation/Application:

- Contact Transmits (Typical Application) = Signal (Data)

#### Packaging Features:

- Packaging Method = Box/Carton

#### Other:

- Series = 2.0 [.079] AMP-LATCH, NOVO
- Brand = AMP

- RoHS/ELV Compliance History = Always was RoHS compliant
- Agency/Standard = CSA, UL
- UL Rating = Recognized

---

### Corporate Information

[About TE](#)  
[Investors](#)  
[News Room](#)  
[Supplier Portal](#)  
[Careers](#)  
[Terms & Conditions](#)  
[Privacy Policy](#)

### Quick Links

[Distributor Inventory](#)  
[Product Cross Reference](#)  
[Documents & Drawings](#)  
[Product Compliance Support Center](#)  
[Site Map](#)

### Customer Support

[Email or Chat With Us](#)  
[Find a Phone Number](#)  
[Knowledge Base](#)  
[Manage Your Account](#)

### Keep Me Informed



4

3

2

1

THIS DRAWING IS UNPUBLISHED. RELEASED FOR PUBLICATION  
 © COPYRIGHT - By - ALL RIGHTS RESERVED.

LOC	DIST	REVISIONS			
P	LTR	DESCRIPTION	DATE	DWN	APVD
GP	00	P			
		P	REVISED PER ECO-11-004835	11MAR11	RK HMR

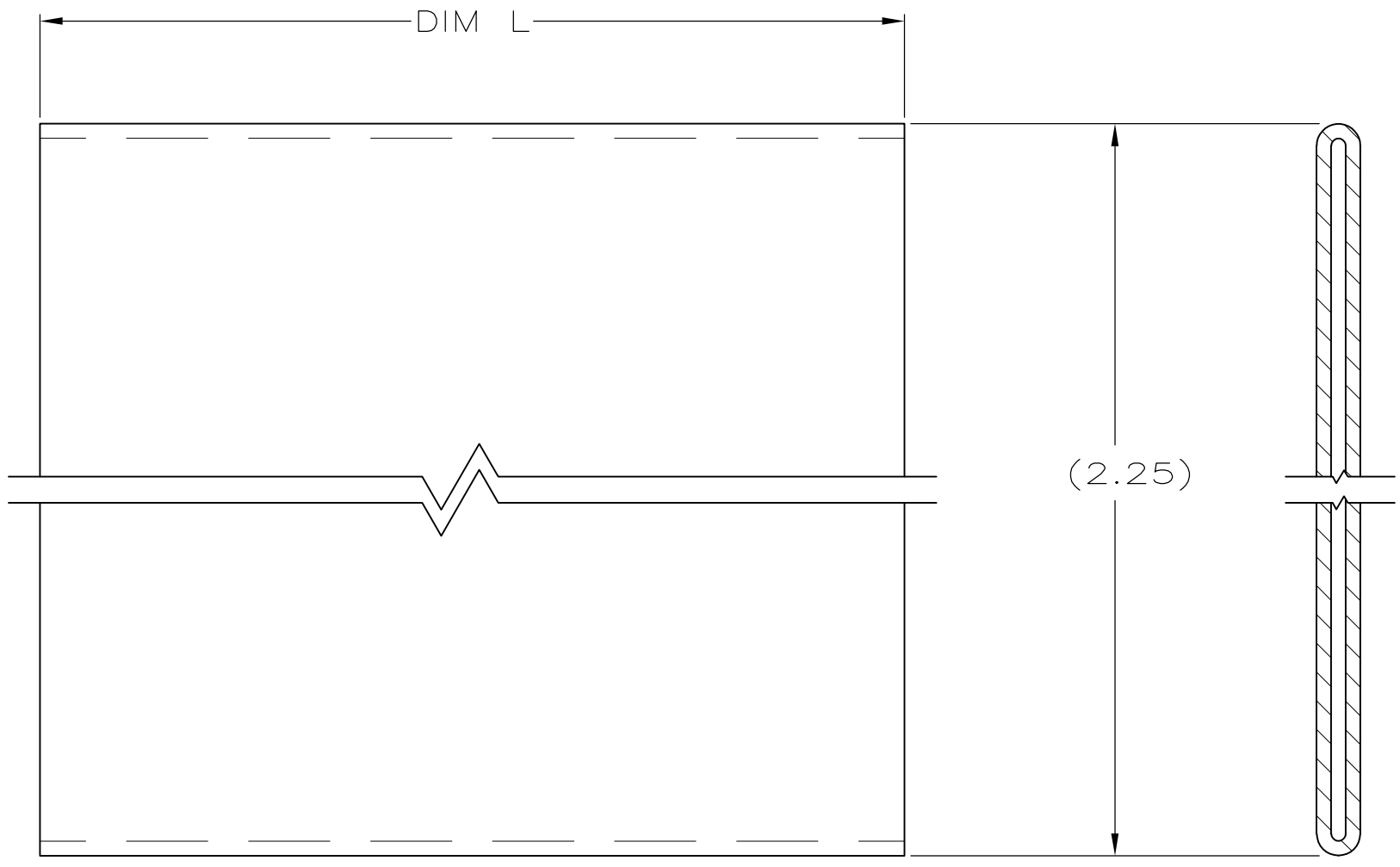

2.80±.20	60 POSN CONN	1-5088450-1
2.32±.18	50 POSN CONN	1-5088450-0
1.82±.18	40 POSN CONN	5088450-9
1.58±.12	34 POSN CONN	5088450-8
1.18±.12	26 POSN CONN	5088450-7
.88±.12	20 POSN CONN	5088450-5
.74±.06	16 POSN CONN	5088450-4
.64±.06	14 POSN CONN	5088450-3
.44±.06	10 POSN CONN	5088450-2
120.00±2.00	-	5088450-1

L	USED WITH	PART NUMBER
---	-----------	-------------

1 PVC LAY FLAT TUBING 94V-1 RATED, COLOR NATURAL.

THIS DRAWING IS A CONTROLLED DOCUMENT.		DWN R.RICHARDSON 1JUNE05	<b>STE</b> TE Connectivity													
DIMENSIONS: INCHES		CHK C.ROHDE 1JUNE05														
TOLERANCES UNLESS OTHERWISE SPECIFIED:		APVD M.WALMSLEY 1JUNE05	NAME PULL LOOP, AMP-LATCH													
<table border="0"> <tr> <td>0 PLC</td> <td>± -</td> </tr> <tr> <td>1 PLC</td> <td>± -</td> </tr> <tr> <td>2 PLC</td> <td>± -</td> </tr> <tr> <td>3 PLC</td> <td>± -</td> </tr> <tr> <td>4 PLC</td> <td>± -</td> </tr> <tr> <td>ANGLES</td> <td>± -</td> </tr> </table>		0 PLC	± -	1 PLC	± -	2 PLC	± -	3 PLC	± -	4 PLC	± -	ANGLES	± -	PRODUCT SPEC -	RESTRICTED TO -	
0 PLC	± -															
1 PLC	± -															
2 PLC	± -															
3 PLC	± -															
4 PLC	± -															
ANGLES	± -															
MATERIAL 1		FINISH -	APPLICATION SPEC -	SIZE A3												
		WEIGHT -	CAGE CODE 00779	DRAWING NO C-5088450												
CUSTOMER DRAWING			SCALE 10:1	SHEET 1 OF 1												
			REV P													