

5088450-5 Product Details

[Share](#) [Print](#) [Email](#)

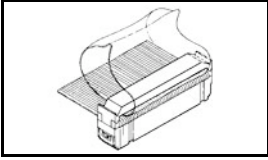

5088450-5

TE Internal Number: 5088450-5

 Active

[View 3D PDF](#)

AMP-LATCH Ribbon Cable Connectors

 Always EU RoHS/ELV Compliant
(Statement of Compliance)

Product Highlights:

- AMP-LATCH Product Line
- Accessory Type = Pull Loop
- Accessory Color = Natural
- Phosphor Bronze Contact Base Material
- Gold or Palladium Nickel or Performance Based Contact Plating, Mating Area, Material

[View all Features](#)

Quick Links

- ▶ [Pricing & Availability](#)
- ▶ [Search for Tooling](#)
- ▶ [Product Feature Selector](#)
- ▶ [Contact Us About This Product](#)

[Add to My Part List](#)

[Request Sample](#)

[Find Similar Products](#)

[Buy Product](#)

Documentation & Additional Information

Product Drawings:

- [PULL LOOP, AMP-LATCH](#) (PDF, English)

Catalog Pages/Data Sheets:

- [Ribbon Cable Interconnect Solutions](#) (PDF, English)

Product Specifications:

- None Available

Application Specifications:

- [AMP-LATCH 2 mm Receptacle Connectors](#) (PDF, English)

Instruction Sheets:

- None Available

CAD Files: (CAD Format & Compression Information)

- [2D Drawing](#) (DXF, Version 0)
- [3D Model](#) (IGES, Version 0)
- [3D Model](#) (STEP, Version 0)

[List all Documents](#)

Additional Information:

- [Product Line Information](#)

Related Products:

- [Tooling](#)

Product Features (Please use the Product Drawing for all design activity)

Product Type Features:

- Product Line = AMP-LATCH
- Accessory Type = Pull Loop
- Accessory Color = Natural
- UL File Number = E28476
- CSA File Number = LR 7189

Contact Features:

- Contact Base Material = Phosphor Bronze
- [Contact Plating, Mating Area, Material](#) = Gold or Palladium Nickel or Performance Based

Industry Standards:

- [RoHS/ELV Compliance](#) = RoHS compliant, ELV compliant
- [Lead Free Solder Processes](#) = Not relevant for lead free process

Operation/Application:

- Contact Transmits (Typical Application) = Signal (Data)

Packaging Features:

- Packaging Method = Box/Carton

Other:

- Series = 2.0 [.079] AMP-LATCH, NOVO
- Brand = AMP

- RoHS/ELV Compliance History = Always was RoHS compliant
- Agency/Standard = CSA, UL
- UL Rating = Recognized

Corporate Information

[About TE](#)
[Investors](#)
[News Room](#)
[Supplier Portal](#)
[Careers](#)
[Terms & Conditions](#)
[Privacy Policy](#)

Quick Links

[Distributor Inventory](#)
[Product Cross Reference](#)
[Documents & Drawings](#)
[Product Compliance Support Center](#)
[Site Map](#)

Customer Support

[Email or Chat With Us](#)
[Find a Phone Number](#)
[Knowledge Base](#)
[Manage Your Account](#)

Keep Me Informed



4

3

2

1

THIS DRAWING IS UNPUBLISHED. RELEASED FOR PUBLICATION
 © COPYRIGHT - By - ALL RIGHTS RESERVED.

| LOC | DIST | REVISIONS | | | |
|-----|------|---------------------------|---------|-----|------|
| P | LTR | DESCRIPTION | DATE | DWN | APVD |
| GP | 00 | | | | |
| | P | REVISED PER ECO-11-004835 | 11MAR11 | RK | HMR |

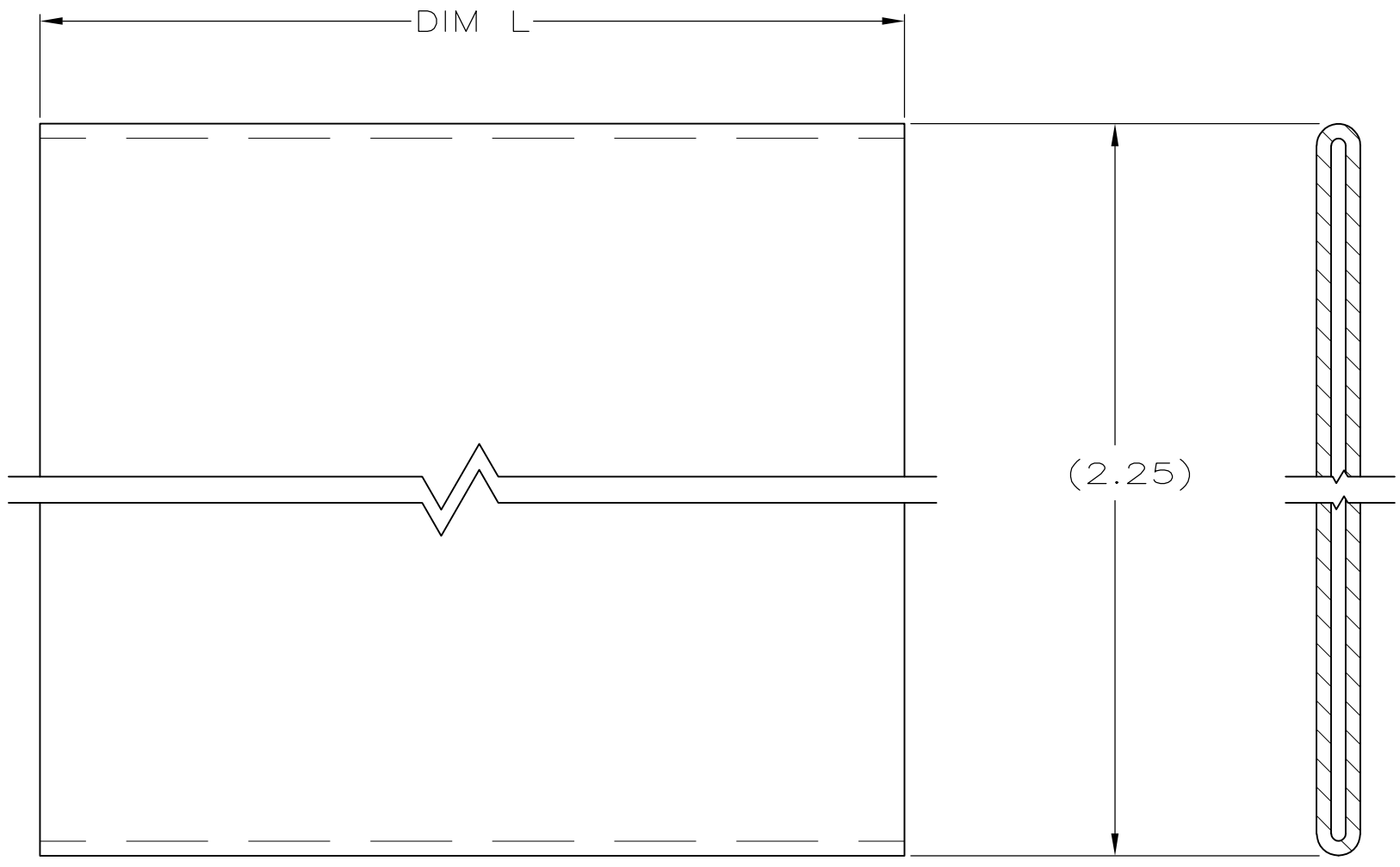

| | | |
|-------------|--------------|-------------|
| 2.80±.20 | 60 POSN CONN | 1-5088450-1 |
| 2.32±.18 | 50 POSN CONN | 1-5088450-0 |
| 1.82±.18 | 40 POSN CONN | 5088450-9 |
| 1.58±.12 | 34 POSN CONN | 5088450-8 |
| 1.18±.12 | 26 POSN CONN | 5088450-7 |
| .88±.12 | 20 POSN CONN | 5088450-5 |
| .74±.06 | 16 POSN CONN | 5088450-4 |
| .64±.06 | 14 POSN CONN | 5088450-3 |
| .44±.06 | 10 POSN CONN | 5088450-2 |
| 120.00±2.00 | - | 5088450-1 |

| | | |
|---|-----------|-------------|
| L | USED WITH | PART NUMBER |
|---|-----------|-------------|

1 PVC LAY FLAT TUBING 94V-1 RATED, COLOR NATURAL.

| | | | | | | | | | | | | | | | | | |
|--|-----|--------------------------------|------------------------------|---------------|--------------------|-------------------------|--------------------|-------|-----|-------|-----|--------|-----|-------------------|---|--|--|
| THIS DRAWING IS A CONTROLLED DOCUMENT. | | DWN R.RICHARDSON 1JUNE05 | TE Connectivity | | | | | | | | | | | | | | |
| DIMENSIONS: INCHES | | CHK C.ROHDE 1JUNE05 | | | | | | | | | | | | | | | |
| TOLERANCES UNLESS OTHERWISE SPECIFIED: | | APVD M.WALMSLEY 1JUNE05 | NAME PULL LOOP, AMP-LATCH | | | | | | | | | | | | | | |
| <table border="0"> <tr> <td>0 PLC</td> <td>± -</td> </tr> <tr> <td>1 PLC</td> <td>± -</td> </tr> <tr> <td>2 PLC</td> <td>± -</td> </tr> <tr> <td>3 PLC</td> <td>± -</td> </tr> <tr> <td>4 PLC</td> <td>± -</td> </tr> <tr> <td>ANGLES</td> <td>± -</td> </tr> </table> | | 0 PLC | ± - | 1 PLC | ± - | 2 PLC | ± - | 3 PLC | ± - | 4 PLC | ± - | ANGLES | ± - | PRODUCT SPEC - | - | | |
| 0 PLC | ± - | | | | | | | | | | | | | | | | |
| 1 PLC | ± - | | | | | | | | | | | | | | | | |
| 2 PLC | ± - | | | | | | | | | | | | | | | | |
| 3 PLC | ± - | | | | | | | | | | | | | | | | |
| 4 PLC | ± - | | | | | | | | | | | | | | | | |
| ANGLES | ± - | | | | | | | | | | | | | | | | |
| MATERIAL 1 | | FINISH - | APPLICATION SPEC - | SIZE A3 | CAGE CODE 00779 | DRAWING NO C-5088450 | RESTRICTED TO - | | | | | | | | | | |
| CUSTOMER DRAWING | | | WEIGHT - | SCALE 10:1 | SHEET 1 OF 1 | REV P | | | | | | | | | | | |