

## 5145098-1 Product Details

[Share](#) [Print](#) [Email](#)



**5145098-1**

TE Internal Number: 5145098-1

Active

[View 3D PDF](#)

### PCI & PCI Express Connectors

Always EU RoHS/ELV Compliant  
(Statement of Compliance)

### Product Highlights:

- Family Name = PCI
- PCB Mounting Orientation = Vertical
- 60 Dual Positions
- 120 Positions
- Housing Color = Natural

[View all Features](#)

### Quick Links

- ▶ [Pricing & Availability](#)
- ▶ [Search for Tooling](#)
- ▶ [Product Feature Selector](#)
- ▶ [Contact Us About This Product](#)

[Add to My Part List](#)

[Request Sample](#)

[Find Similar Products](#)

[Buy Product](#)

### Documentation & Additional Information

#### Product Drawings:

- [CONNECTOR ASSEMBLY, 60 DUAL POSITION, .050 SERIES, S...](#) (PDF, English)

#### Catalog Pages/Data Sheets:

- None Available

#### Product Specifications:

- [Connector, Card Edge, .050 Centerline](#) (PDF, English)

#### Application Specifications:

- [.050 Series Standard Edge Peripheral Computer Interc...](#) (PDF, English)

#### Instruction Sheets:

- None Available

#### CAD Files: (CAD Format & Compression Information)

- [2D Drawing](#) (DXF, Version 0)
- [3D Model](#) (IGES, Version 0)
- [3D Model](#) (STEP, Version 0)

[List all Documents](#)

#### Related Products:

- [Tooling](#)

### Product Features (Please use the Product Drawing for all design activity)

#### Product Type Features:

- Family Name = PCI
- PCB Mounting Orientation = Vertical
- [PCB Mount Style](#) = Surface Mount
- [PCB Mount Retention Type](#) = Hold Down Post(s)

#### Electrical Characteristics:

- [Voltage \(VAC\)](#) = 203
- Operating Voltage (VAC) = 203
- Operating Voltage Reference = AC

#### Dimensions:

- Length (mm [in]) = 3.44 [0.135]
- Width (mm [in]) = 0.35 [0.014]
- Height (mm [in]) = 0.61 [0.024]
- PCB Thickness, Accepted (mm [in]) = 0.62 [0.024]

#### Housing Features:

- Housing Color = Natural
- Centerline (mm [in]) = 1.27 [0.050]
- Housing Material = High Temperature Thermoplastic

#### Configuration Features:

- [Number of Dual Positions](#) = 60
- Number of Positions = 120
- Number of Holddowns = 2

#### Industry Standards:

- [RoHS/ELV Compliance](#) = RoHS compliant, ELV compliant
- [Lead Free Solder Processes](#) = Reflow solder capable to 245°C
- [RoHS/ELV Compliance History](#) = Always was RoHS compliant

**Body Features:**

- [Bus Width](#) = 32 Bit
- Ejector = Without
- Holddown Material = Brass
- Holddown Plating = Tin over Nickel

**Contact Features:**

- [Contact Plating](#), [Mating Area](#), [Material](#) = Gold (30)
- Contact Base Material = Phosphor Bronze
- Solder Tail Contact Plating = Tin over Nickel

**Environmental:**

- Operating Temperature Range (°C) = -55 – +85

**Operation/Application:**

- Pick and Place Cover = Without

**Packaging Features:**

- Packaging Method = Box/Carton

**Other:**

- Brand = AMP

**Corporate Information**

[About TE](#)  
[Investors](#)  
[News Room](#)  
[Supplier Portal](#)  
[Careers](#)  
[Terms & Conditions](#)  
[Privacy Policy](#)

**Quick Links**

[Distributor Inventory](#)  
[Product Cross Reference](#)  
[Documents & Drawings](#)  
[Product Compliance Support Center](#)  
[Site Map](#)

**Customer Support**

[Email or Chat With Us](#)  
[Find a Phone Number](#)  
[Knowledge Base](#)  
[Manage Your Account](#)

**Keep Me Informed**

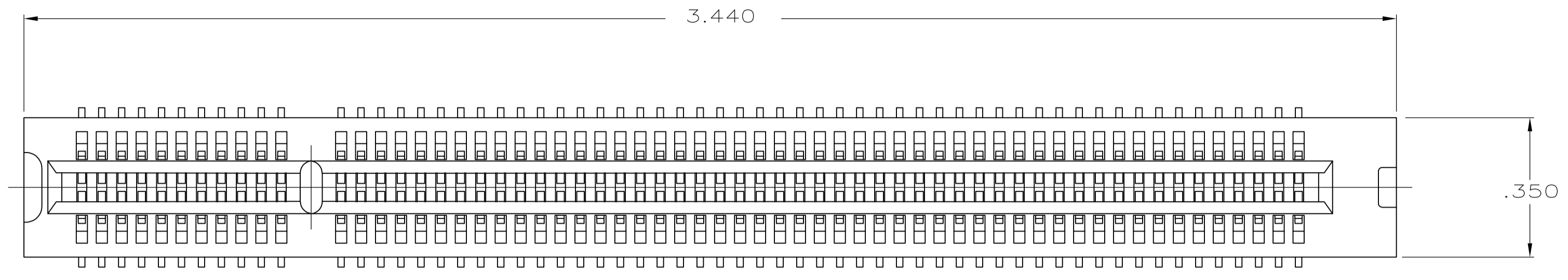

- ① HOUSING: HIGH TEMPERATURE THERMOPLASTIC.
- ② CONTACT: PHOSPHOR BRONZE.
- ③ CONTACT FINISH: .000100 MIN NICKEL ALL OVER, .000030 MIN GOLD OVER NICKEL IN CONTACT AREA, .000100 MIN MATTE TIN OVER NICKEL ON SOLDER TAILS.
- ④ METAL HOLD DOWN: BRASS
- ⑤ METAL HOLD DOWN FINISH: .000050 MIN NICKEL ALL OVER, .000150 MIN MATTE TIN ALL OVER.
- ⑥ DISTANCE FROM CONTACT POINT TO BOTTOM OF CARD SLOT.
- ⑦ AMP PART NUMBER, DATE CODE AND CSA LOGO MARKED IN APPROXIMATE AREA SHOWN.

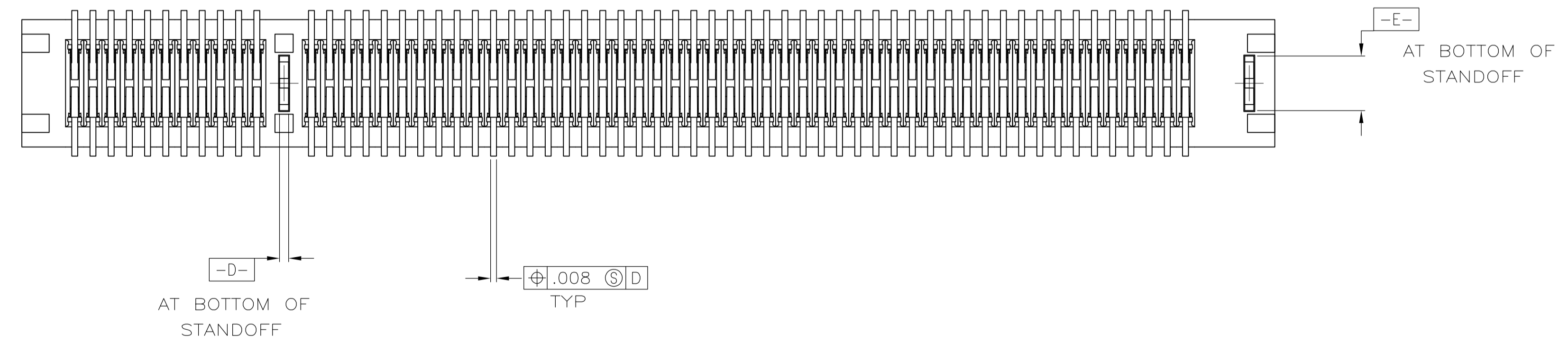
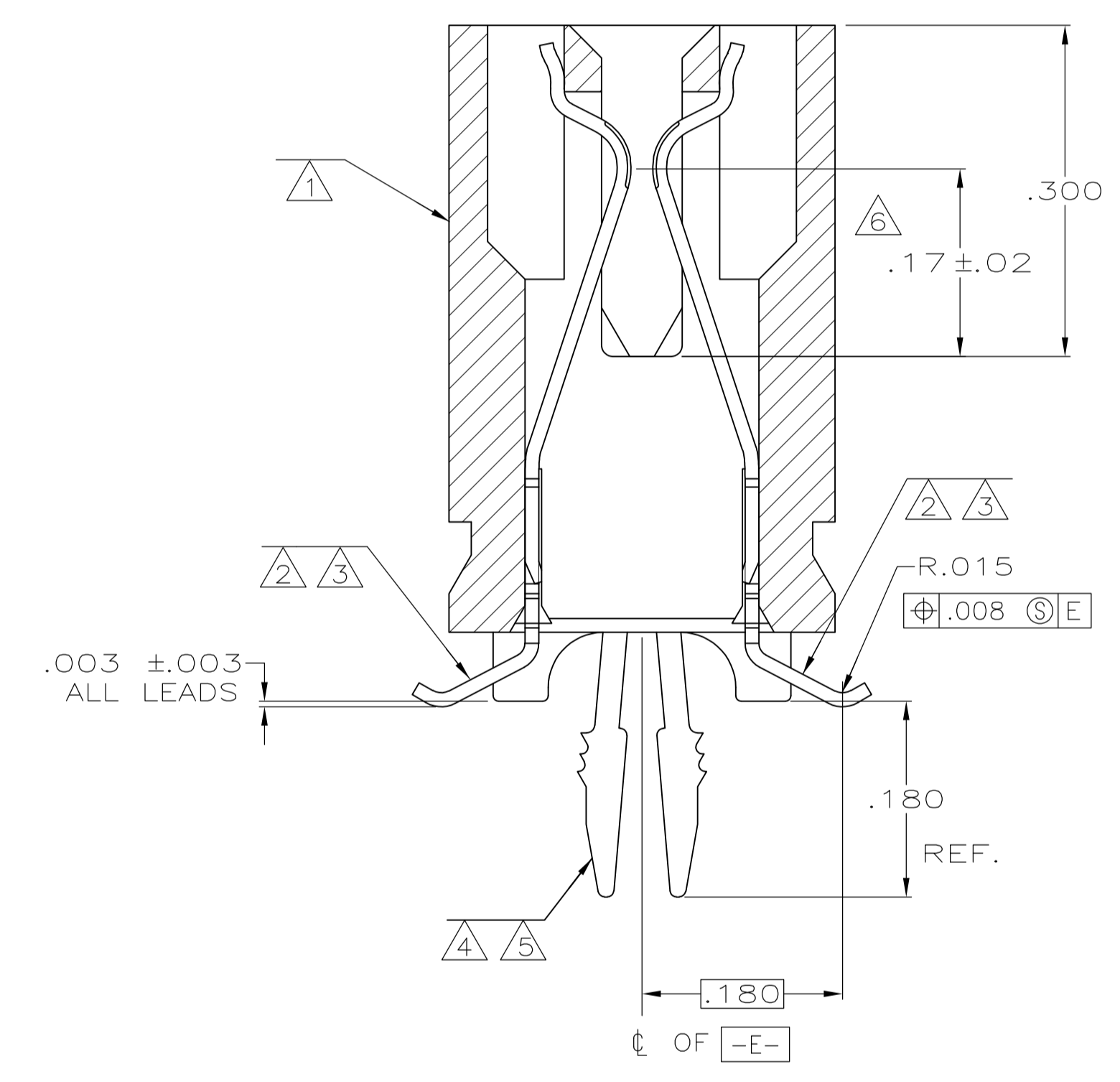
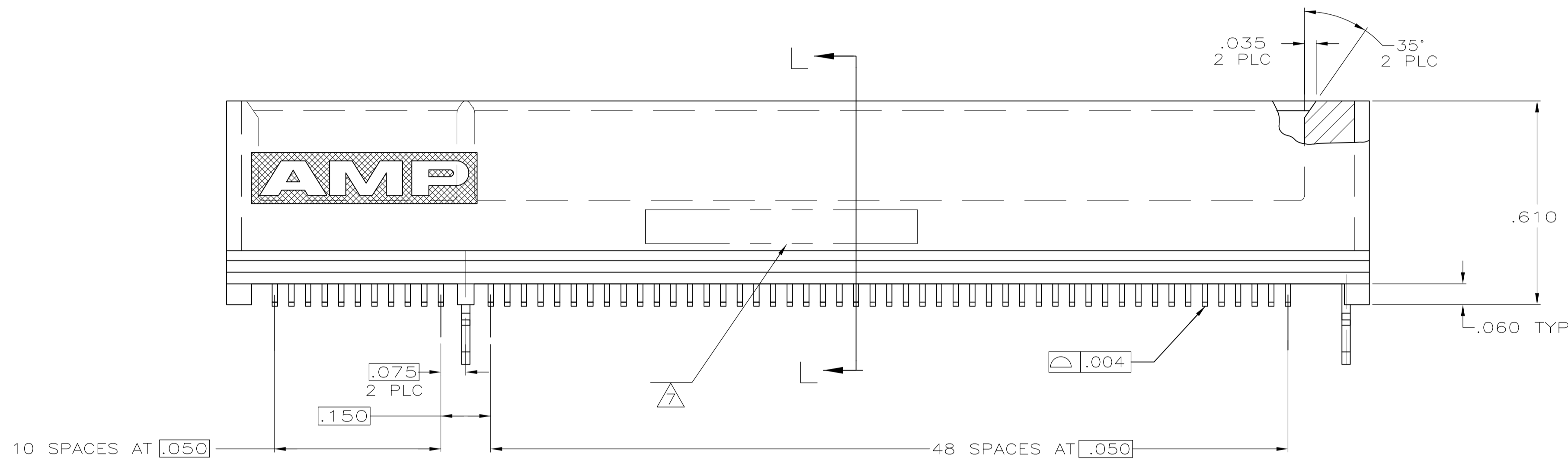

SECTION L-L  
SCALE 8:1

145098-1 AS SHOWN

THIS DRAWING IS A CONTROLLED DOCUMENT.		DN AL FRANTUM 09 JUN 05	TE Connectivity
DIMENSIONS: INCHES		CHK AL FRANTUM 09 JUN 05	
TOLERANCES UNLESS OTHERWISE SPECIFIED:		APVD	NAME
0 PLC ± -		PRODUCT SPEC	CONNECTOR ASSEMBLY, 60 DUAL POSITION, .050 SERIES, STANDARD EDGE, SURFACE MOUNT
1 PLC ± -		108-14034	SIZE
2 PLC ± -		APPLICATION SPEC	A1
3 PLC ± .005		114-13148	CAGE CODE
4 PLC ± -		WEIGHT	00779
ANGLES ± -		CUSTOMER DRAWING	5145098
FINISH		SCALE	4:1
SHEET		1	2
REV			R

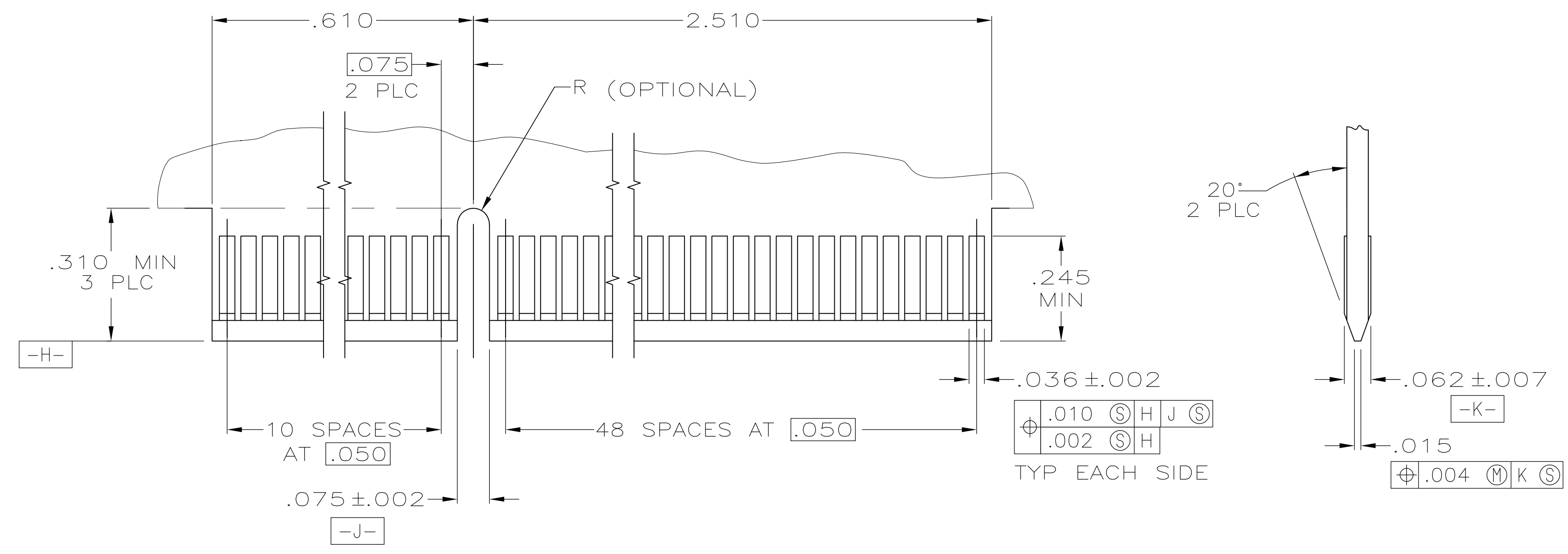

RECOMMENDED MATING BOARD EDGE CONFIGURATION

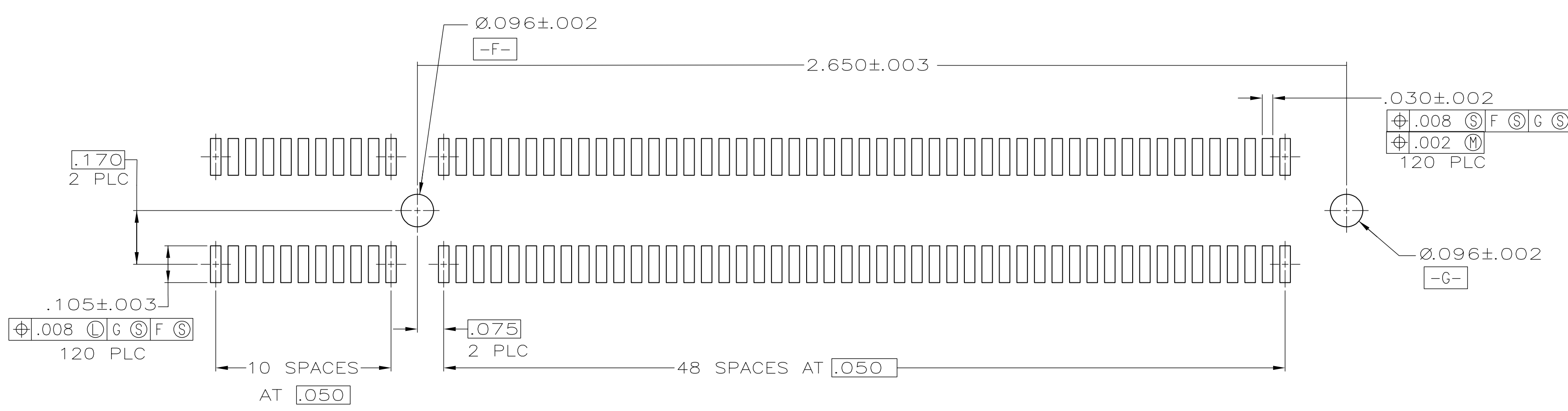

RECOMMENDED PC BOARD PATTERN  
 (CONNECTOR SIDE SHOWN)

THIS DRAWING IS A CONTROLLED DOCUMENT.		DWN AL FRANTUM 09 JUN 05	
DIMENSIONS: INCHES		CHK AL FRANTUM 09 JUN 05	
	TOLERANCES UNLESS OTHERWISE SPECIFIED:	APVD	NAME
	0 PLC ± -	PRODUCT SPEC	CONNECTOR ASSEMBLY, 60 DUAL POSITION, .050 SERIES, STANDARD EDGE, SURFACE MOUNT
	1 PLC ± -	108-14034	RESTRICTED TO
MATERIAL SEE SHEET 1	FINISH SEE SHEET 1	APPLICATION SPEC 114-13148	SIZE CAGE CODE DRAWING NO A1 00779 5145098
CUSTOMER DRAWING		SCALE 4:1	SHEET 2 OF 2 REV R