

SCALA NON IMPEGNATIVA  
(DO NOT SCALE)  
DIMENSIONI IN  
(DIMENSIONS IN) mm

**METRIC**

THIRD ANGLE  
PROJECTION

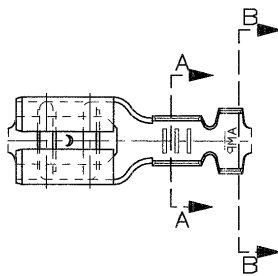

- 1) PER PEZZI IN NASTRO  
VEDERE DISEGNO 160430.  
(FOR STRIP VERSION  
SEE DRAWING 160430).
- 2) CONFEZIONAMENTO IN ACCORDO  
ALLA SPECIFICA AMP 107-20201.  
(PACKAGED ACCORDING TO AMP SPEC. 107-20201).

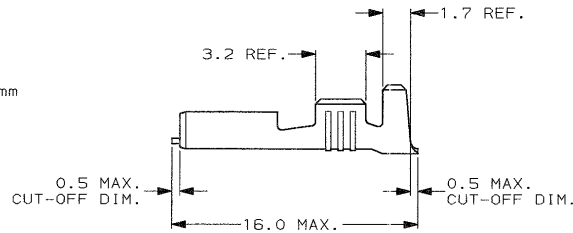
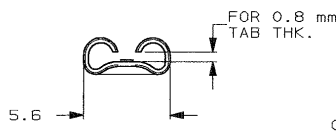

SEZIONE A-A  
(SECTION A-A)

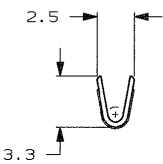

SEZIONE B-B  
(SECTION B-B)

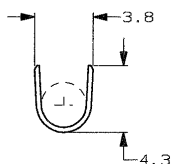

PRE NICHELATO (PRE-NICKEL PL.)	ACCIAIO (STEEL)	5-160490-4	G
STAGNATO (TIN PLATED)	BRONZO FOSF. (PHOS. BRONZE)	5-160490-3	G
STAGNATO (TIN PLATED)	OTTONE (BRASS)	5-160490-2	G
NUDO (PLAIN)	OTTONE (BRASS)	5-160490-1	G
FINITURA / COLORE (FINISH / COLOUR)	MATERIALE (MATERIAL)	NUMERO (AMP P/N)	REV

CUSTOMER DWG. FOR REFERENCE ONLY		DISEGNO PER CLIENTE SOLO PER RIFERIMENTO	
THIS DRAWING IS UNPUBLISHED		RELEASE FOR PUBLICATION	
TOLLERANZE, SE NON DIVERSAMENTE SPECIFICATO (TOLERANCES, UNLESS OTHERWISE SPECIFIED)		DIAM. ISOLANTE (INS. DIA. RANGE)	SCALA (SCALE)
± 0.3		RANGO FILLO (WIRE RANGE) mm2	4:1
ANGOLI (ANGLES) ± 2°		2,3-3,3	0,5-1,5
DIS. H. YAALI (DR.) 10 NOV 2000		<b>TE Connectivity</b>	
CONT. C. TARTARI (CON.) 10 NOV 2000			
DESCRIZIONE (DESCRIPTION)		FASTON Connector, 187 <sup>sr</sup> REC. CONTACT, LOOSE PIECE VERSION	
REV. 1	REVISIONI (REVISION RECORD)	LOC. SIZE NUMERO (DWG. NO)	REV. 1
G1	REVISED PER ECO-11-005294	I A3	C-160490
DIS. DATA (DATE)	10 NOV 2000	FOLIO (SHEET)	1 DI 1

SCALE: 1:1