

5-1814825-1 Product Details

[Share](#) [Print](#) [Email](#)



5-1814825-1

TE Internal Number: 5-1814825-1

 Active

F Series and G Series RF Connectors

 Always EU RoHS/ELV Compliant (Statement of Compliance)

Product Highlights:

- Connector - RF
- RF Connector Type = F Series
- Type of Connector = F Series
- Jack
- Mount = Printed Circuit Board

[View all Features](#)

Quick Links

- ▶ [Pricing & Availability](#)
- ▶ [Search for Tooling](#)
- ▶ [Product Feature Selector](#)
- ▶ [Contact Us About This Product](#)

[Add to My Part List](#) [Request Sample](#) [Find Similar Products](#) [Buy Product](#)

Documentation & Additional Information	
<p>Product Drawings:</p> <ul style="list-style-type: none"> • F TYPE STRAIGHT PCB SOCKET 75 OHM (PDF, English) <p>Catalog Pages/Data Sheets:</p> <ul style="list-style-type: none"> • None Available <p>Product Specifications:</p> <ul style="list-style-type: none"> • None Available <p>Application Specifications:</p> <ul style="list-style-type: none"> • None Available <p>Instruction Sheets:</p> <ul style="list-style-type: none"> • None Available <p>CAD Files:</p> <ul style="list-style-type: none"> • None Available 	<p>Related Products:</p> <ul style="list-style-type: none"> • Tooling

[List all Documents](#)

Product Features (Please use the Product Drawing for all design activity)	
<p>Product Type Features:</p> <ul style="list-style-type: none"> • Product Type = Connector - RF • RF Connector Type = F Series • Type of Connector = F Series • Gender = Jack • PCB Mount Style = Through Hole • PCB Mounting Orientation = Vertical • Dielectric Material = Polyethylene • Sealed = No <p>Mechanical Attachment:</p> <ul style="list-style-type: none"> • Mount = Printed Circuit Board <p>Termination Features:</p> <ul style="list-style-type: none"> • Termination Post Length (mm [in]) = 3.00 [0.118] <p>Body Features:</p> <ul style="list-style-type: none"> • Body Material = Zinc • Body Plating = Nickel 	<p>Contact Features:</p> <ul style="list-style-type: none"> • Center Contact Material = Phosphor Bronze • Center Contact Plating = Tin <p>Industry Standards:</p> <ul style="list-style-type: none"> • RoHS/ELV Compliance = RoHS compliant, ELV compliant • Lead Free Solder Processes = Wave solder capable to 240°C, Wave solder capable to 260°C, Wave solder capable to 265°C • RoHS/ELV Compliance History = Always was RoHS compliant <p>Conditions for Usage:</p> <ul style="list-style-type: none"> • Applies To = Printed Circuit Board <p>Packaging Features:</p> <ul style="list-style-type: none"> • Packaging Quantity = 100/Box <p>Other:</p> <ul style="list-style-type: none"> • Brand = TE Connectivity

Corporate Information

[About TE](#)
[Investors](#)
[News Room](#)
[Supplier Portal](#)
[Careers](#)
[Terms & Conditions](#)
[Privacy Policy](#)

Quick Links

[Distributor Inventory](#)
[Product Cross Reference](#)
[Documents & Drawings](#)
[Product Compliance Support Center](#)
[Site Map](#)

Customer Support

[Email or Chat With Us](#)
[Find a Phone Number](#)
[Knowledge Base](#)
[Manage Your Account](#)

Keep Me Informed

THIS DRAWING IS UNPUBLISHED. RELEASED FOR PUBLICATION AUGUST ,2006.

© COPYRIGHT 2006 By - ALL RIGHTS RESERVED.

LOC	DIST	REVISIONS			
P	LTR	DESCRIPTION	DATE	DWN	APVD
	C	REVISED PER ECO-09-003420	14FEB09	ANS	BOB
	D	REVISED PER ECO-11-021675	02NOV11	TITAN	MARTIN

NOTES:

- 1 PACK IN ACCORDANCE WITH AMP SPEC 107-3275
- 2 100 TRAY PACK IN ACCORDANCE WITH AMP SPEC 107-3275
- 3 Sn PLATING
- 4 Ni PLATING
- 5 FOR TECHNICAL DATA REFER TO YOUR LOCAL TYCO ELECTRONICS SALES OFFICE
- 6 ALL DIMENSIONS ARE NOMINAL FOR REFERENCE ONLY UNLESS OTHERWISE STATED

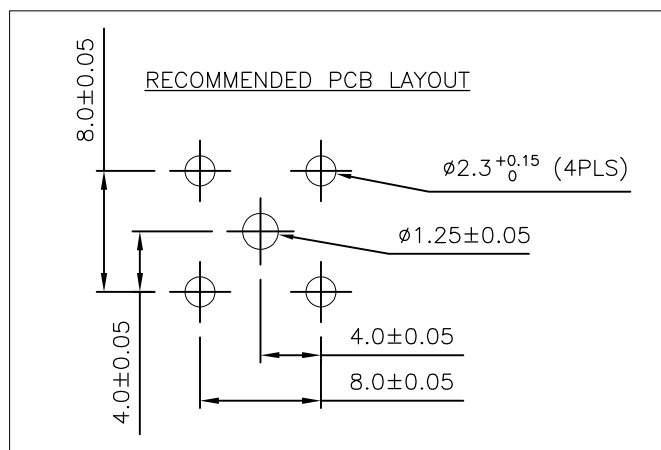
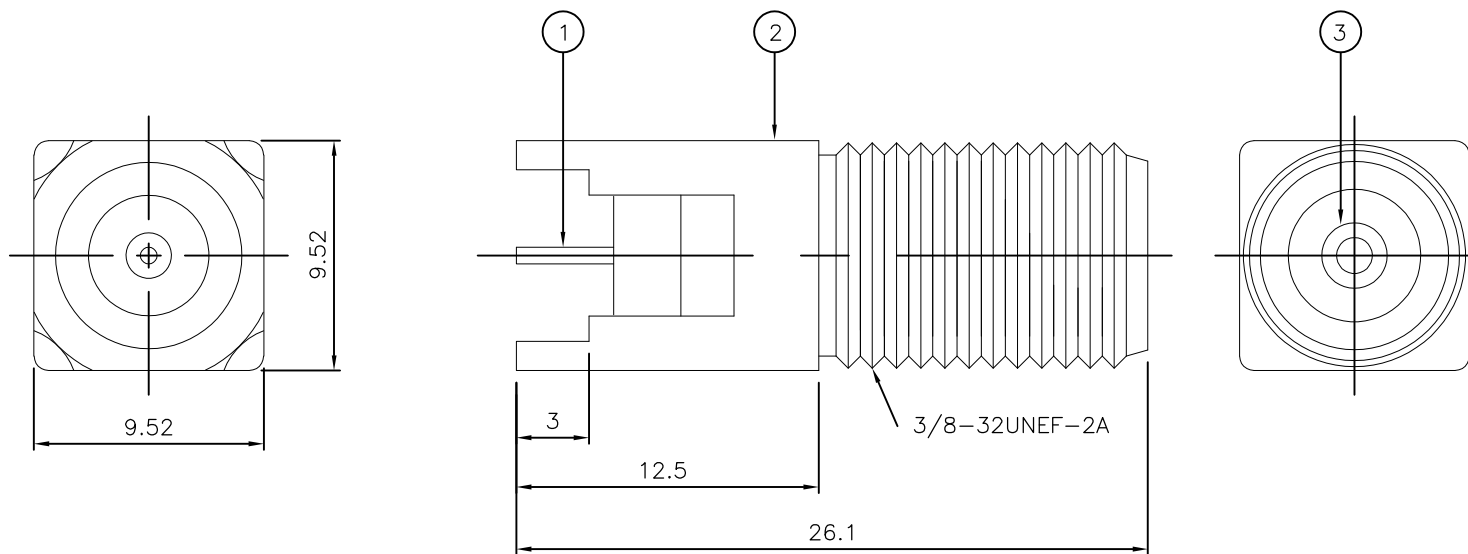

QTY	PLC	DESCRIPTION	ITEM
1	1	PE	INSULATION 3
1	1	ZINC	BODY 2
1	1	PHOSPHOR BRONZE	CONTACT 1
5--1	5--0	MATERIAL	DESCRIPTION

Obsolete

QUANTITY PER ASSY PARTS LIST

THIS DRAWING IS A CONTROLLED DOCUMENT.		DWN ANSON 14FEB09	STE TE Connectivity	
DIMENSIONS: mm		CHK RITA ZUO 14FEB09		
TOLERANCES UNLESS OTHERWISE SPECIFIED:		APVD BOB ZHAO 14FEB09	NAME F TYPE STRAIGHT PCB SOCKET 75 OHM	
0 PLC ± 0.5		PRODUCT SPEC 108-112000	SIZE CAGE CODE DRAWING NO RESTRICTED TO	
1 PLC ± 0.3		APPLICATION SPEC	A3 00779 C-1814825	
2 PLC ± 0.2		WEIGHT -	SCALE NTS SHEET 1 OF 1 REV D	
3 PLC ± -		CUSTOMER DRAWING		
4 PLC ± -				
ANGLES ± 0.3°				
MATERIAL SEE TABLE				
FINISH -				