

5221111-1 Product Details

[Share](#) [Print](#) [Email](#)



5221111-1

TE Internal Number: 5221111-1

Active

[View 3D PDF](#)

SMB RF Connectors

Always EU RoHS/ELV Compliant
(Statement of Compliance)

Product Highlights:

- Connector - RF
- Jack
- Standard
- Applies To Printed Circuit Board
- Coupler Style = Quick Connect/Disconnect

[View all Features](#)

Quick Links

- ▶ [Pricing & Availability](#)
- ▶ [Search for Tooling](#)
- ▶ [Product Feature Selector](#)
- ▶ [Contact Us About This Product](#)

[Add to My Part List](#) [Request Sample](#) [Find Similar Products](#)
[Buy Product](#)

Documentation & Additional Information

Product Drawings:

- [JACK,PCB, VERTICAL SMB](#) (PDF, English)

Catalog Pages/Data Sheets:

- [SMB Connectors](#) (PDF, English)

Product Specifications:

- None Available

Application Specifications:

- None Available

Instruction Sheets:

- None Available

CAD Files: (CAD Format & Compression Information)

- [2D Drawing](#) (DXF, Version 0)
- [3D Model](#) (IGES, Version 0)
- [3D Model](#) (STEP, Version 0)

[List all Documents](#)

Additional Product Images:

- [PCB Layout](#)

Related Products:

- [Tooling](#)

Product Features (Please use the Product Drawing for all design activity)

Product Type Features:

- [Product Type](#) = Connector - RF
- [Gender](#) = Jack
- [Connector Series](#) = Standard
- [Grade](#) = Commercial
- [PCB Mounting Orientation](#) = Vertical
- [Board Standoff](#) = Without
- [PCB Mount Style](#) = Through Hole
- [Dielectric Material](#) = Fluoropolymer

Mechanical Attachment:

- [Panel Mount Retention](#) = Without

Electrical Characteristics:

- [Connector Impedance](#) (Ω) = 50

Body Features:

- [Coupler Style](#) = Quick Connect/Disconnect

Contact Features:

- [Center Contact Plating](#) = Gold

Configuration Features:

- [Preloaded](#) = Yes
- [Solder Lug](#) = Without
- [Environmental Protection](#) = Without

Industry Standards:

- [RoHS/ELV Compliance](#) = RoHS compliant, ELV compliant
- [Lead Free Solder Processes](#) = Wave solder capable to 260°C, Wave solder capable to 240°C, Wave solder capable to 265°C
- [RoHS/ELV Compliance History](#) = Always was RoHS compliant

Conditions for Usage:

- [Body Style](#) = Straight
- [Pin Protection](#) = Without
- [Body Plating](#) = Nickel

- [Applies To](#) = Printed Circuit Board

Other:

- Brand = AMP

Corporate Information

- [About TE](#)
- [Investors](#)
- [News Room](#)
- [Supplier Portal](#)
- [Careers](#)
- [Terms & Conditions](#)
- [Privacy Policy](#)

Quick Links

- [Distributor Inventory](#)
- [Product Cross Reference](#)
- [Documents & Drawings](#)
- [Product Compliance Support Center](#)
- [Site Map](#)

Customer Support

- [Email or Chat With Us](#)
- [Find a Phone Number](#)
- [Knowledge Base](#)
- [Manage Your Account](#)

Keep Me Informed



THIS DRAWING IS UNPUBLISHED. RELEASED FOR PUBLICATION
 © COPYRIGHT - By - ALL RIGHTS RESERVED.

LOC	DIST	REVISIONS					
AJ	53	P	LTR	DESCRIPTION	DATE	DWN	APVD
		P1		ECR-12-005726	27MAR12	RK	MY

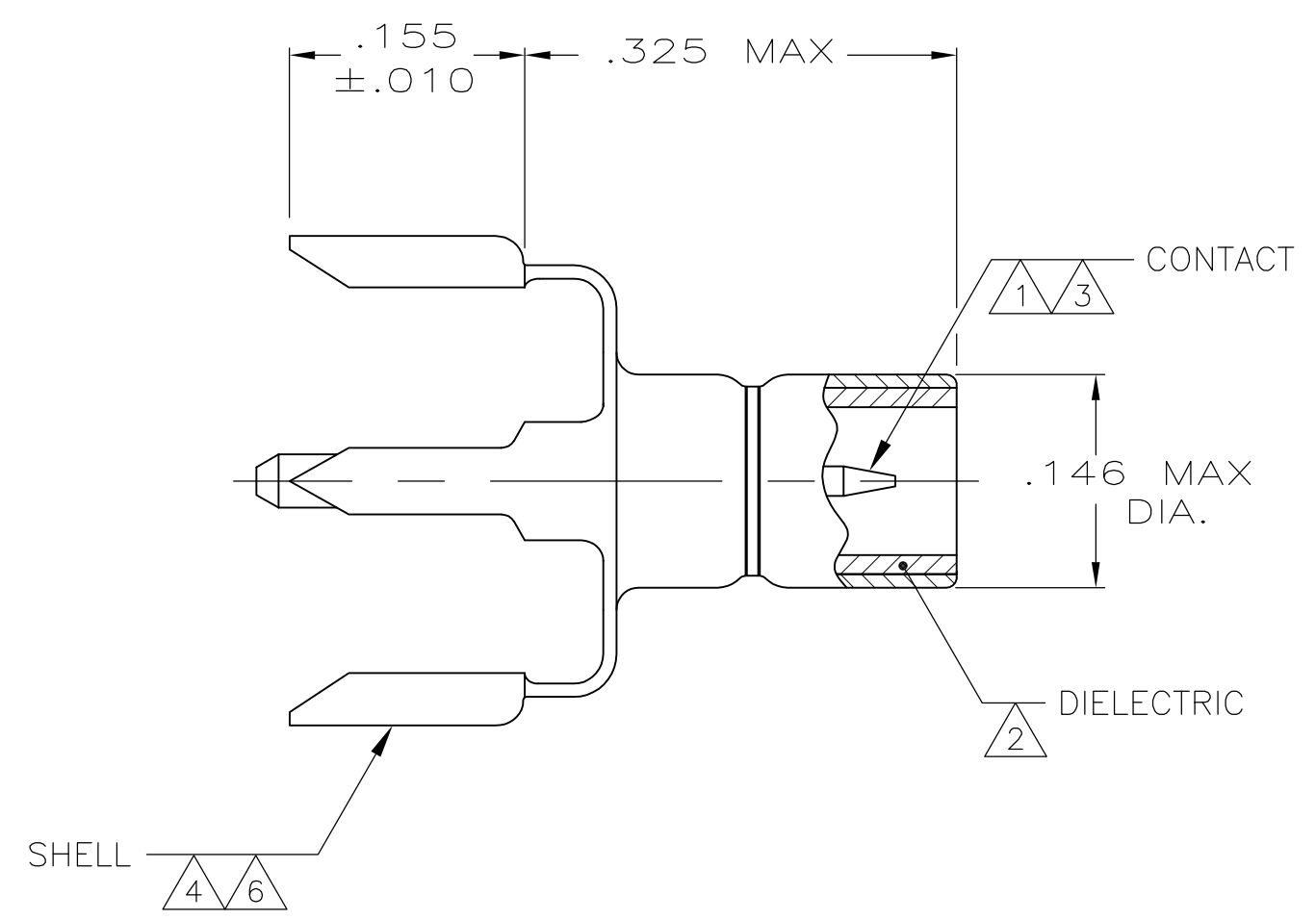

- 1 BRASS PER ASTM-B-16.
- 2 PTFE PER ASTM-D-1710.
- 3 GOLD PLATE PER ASTM-B-488.
- 4 TIN PLATE PER ASTM-B-545.
- 5 NICKEL PLATE PER QQ-N-290.
- 6 BRASS PER ASTM-B-36.

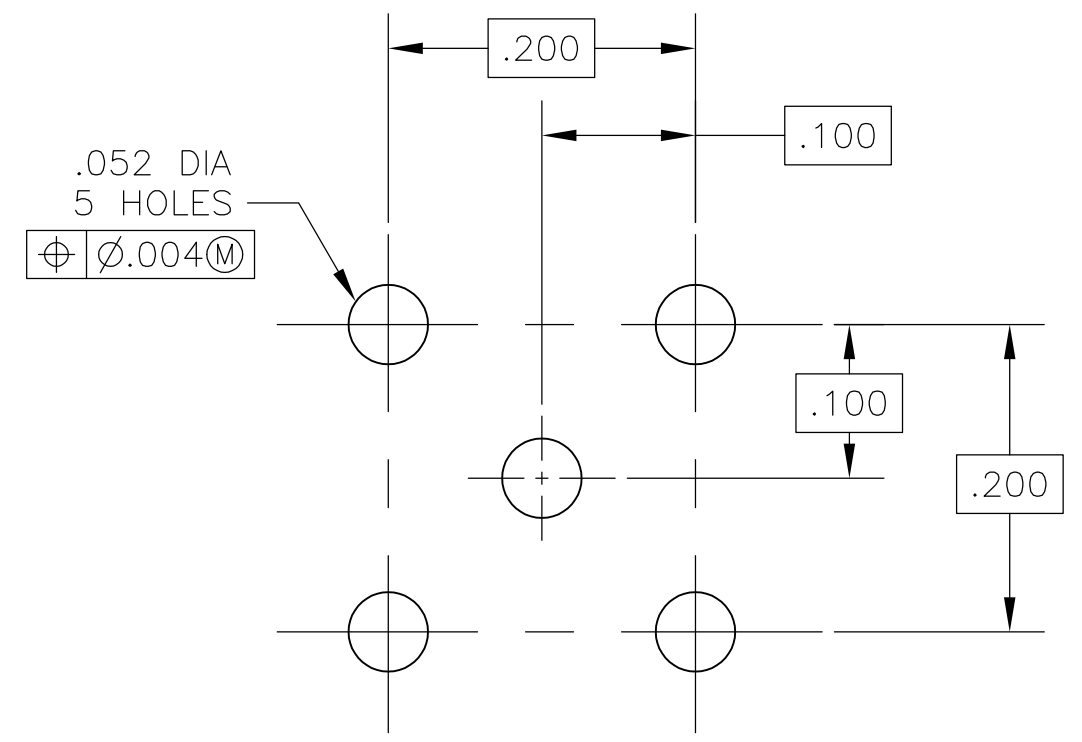

RECOMMENDED PCB HOLE CONFIGURATION

5221111-1
 PART NUMBER

THIS DRAWING IS A CONTROLLED DOCUMENT.		DWN J. HAVENER 24JAN2005	TE Connectivity	
DIMENSIONS: INCHES		CHK J. HAVENER 25JAN2005		
TOLERANCES UNLESS OTHERWISE SPECIFIED:		APVD J. HAVENER 25JAN2005	NAME JACK,PCB, VERTICAL SMB	
0 PLC ± - 1 PLC ± - 2 PLC ± - 3 PLC ± .002 4 PLC ± - ANGLES ± -		PRODUCT SPEC -	RESTRICTED TO -	
MATERIAL SEE NOTES		FINISH SEE NOTES	APPLICATION SPEC -	SIZE A3
		WEIGHT -	CAGE CODE 00779	DRAWING NO C-5221111
CUSTOMER DRAWING			SCALE 8:1	SHEET 1 OF 1
			REV P1	