

## 53891-1 Product Details

[Share](#) [Print](#) [Email](#)

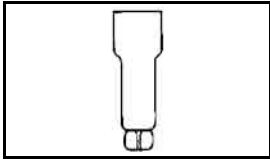

53891-1

TE Internal Number: 53891-1

Active

[View 3D PDF](#)

### Splices - Closed Barrel

Always EU RoHS/ELV Compliant  
(Statement of Compliance)

### Product Highlights:

- Splice
- Not Sealed
- Splice Type = Closed End
- Insulated
- Non-Insulation Support

[View all Features](#)

### Quick Links

- ▶ [Pricing & Availability](#)
- ▶ [Search for Tooling](#)
- ▶ [Product Feature Selector](#)
- ▶ [Contact Us About This Product](#)

[Add to My Part List](#)

[Request Sample](#)

[Find Similar Products](#)

[Buy Product](#)

### Documentation & Additional Information

#### Product Drawings:

- [SPLICE, WIRE, CLOSED END](#) (PDF, English)

#### Catalog Pages/Data Sheets:

- None Available

#### Product Specifications:

- None Available

#### Application Specifications:

- None Available

#### Instruction Sheets:

- [Closed End Splice Pressure Type Wire Connectors Type...](#) (PDF, English)

#### CAD Files: (CAD Format & Compression Information)

- [2D Drawing](#) (DXF, Version J)
- [3D Model](#) (IGES, Version J)
- [3D Model](#) (STEP, Version J)

[List all Documents](#)

#### Additional Product Images:

- [Vinyl Wire Combination Chart](#)

#### Related Products:

- [Tooling](#)

### Product Features (Please use the Product Drawing for all design activity)

#### Product Type Features:

- [Product Type](#) = Splice
- [Sealed](#) = No
- [Splice Type](#) = Closed End
- [Insulation](#) = Yes
- [Insulation Support](#) = Non-Insulation Support
- [Finish](#) = None
- [Color](#) = Blue

#### Termination Features:

- [Wire/Cable Size \(CMA\)](#) = 19,500 - 42,700

#### Dimensions:

- [Opening Diameter \[Min.\] \(mm \[in\]\)](#) = 12.70 [0.500]

#### Body Features:

- [Wire Range \(mm \[AWG\]\)](#) = 0.80-15.00<sup>2</sup> [18-6]
- [Material](#) = Copper

#### Industry Standards:

- [Government/Industry Qualification](#) = No
- [RoHS/ELV Compliance](#) = RoHS compliant, ELV compliant
- [Lead Free Solder Processes](#) = Not relevant for lead free process
- [RoHS/ELV Compliance History](#) = Always was RoHS compliant

#### Identification Marking:

- [Marking](#) = ECV

#### Packaging Features:

- [Packaging Method](#) = Loose Piece/Bulk

#### Other:

- [Brand](#) = AMP
- [Comment](#) = ECV-600V Max. Building Wiring. 1000V

### Corporate Information

[About TE](#)  
[Investors](#)  
[News Room](#)  
[Supplier Portal](#)  
[Careers](#)  
[Terms & Conditions](#)  
[Privacy Policy](#)

### Quick Links

[Distributor Inventory](#)  
[Product Cross Reference](#)  
[Documents & Drawings](#)  
[Product Compliance Support Center](#)  
[Site Map](#)

### Customer Support

[Email or Chat With Us](#)  
[Find a Phone Number](#)  
[Knowledge Base](#)  
[Manage Your Account](#)



### Keep Me Informed



THIS DRAWING IS UNPUBLISHED. RELEASED FOR PUBLICATION  
 © COPYRIGHT - BY TYCO ELECTRONICS CORPORATION. ALL RIGHTS RESERVED.

LOC	DIST	REVISIONS					
		P	LTR	DESCRIPTION	DATE	DWN	APVD
G	14		J	REV PER 0G3A-0256-04	13APR04	JR	TM

- 1 FOR 12.70 [.500] MAX WIRE INSULATION DIA
- △ 2 MATERIAL: BODY; COPPER PER ASTM B152  
INSULATION; PVC  
COLOR; BLUE

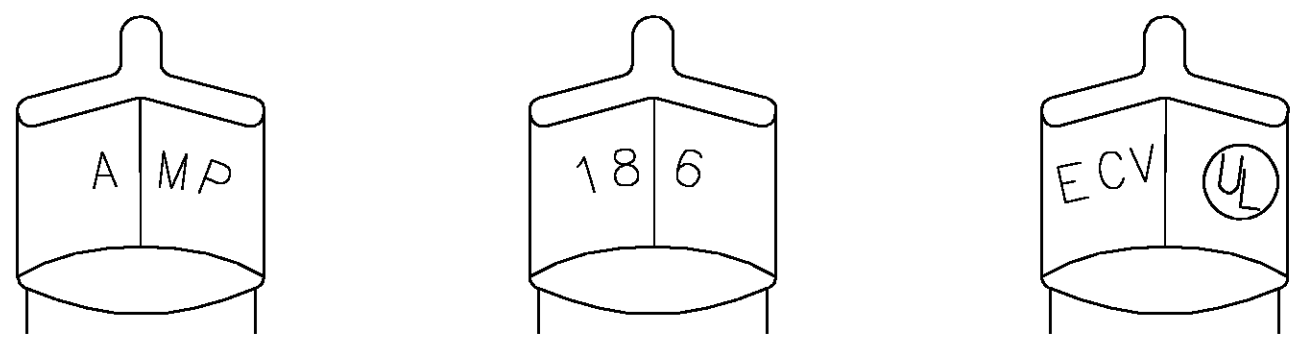

STAMPING DETAIL

<b>AMP</b> WIRE RANGE	Listed	LR7189 Certified
18-6 AWG SOLID OR STRANDED	18-6 AWG SOLID OR STRANDED	18-6 AWG SOLID OR STRANDED

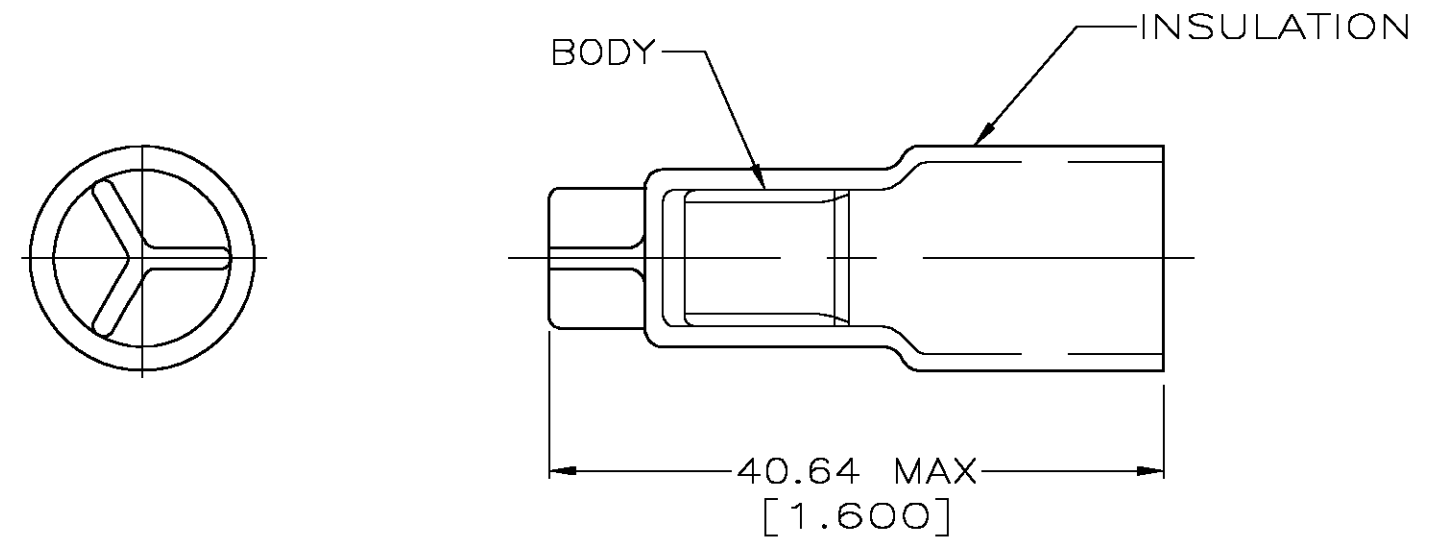

QTY	DESCRIPTION	PART NO
-	LOOSE PIECE	53891-1

<b>AMP INCORPORATED</b> <b>CUSTOMER SERVICE SYSTEMS</b>		MAX RECOMMENDED OPERATING TEMPERATURE: 105° C MAX	THIS DRAWING IS A CONTROLLED DOCUMENT.		DWN G KRUPER 12/21/92 CHK R HERSEY 1-8-93 APVD M ELLIS 1-8-93	Tyco Electronics Corporation Harrisburg, Pa 17105-3608					
FOR ADDITIONAL PRODUCT INFORMATION OR COPIES OF DRAWINGS AND TECHNICAL DOCUMENTS PRODUCT INFORMATION CENTER 1-800-522-6752	FOR APPLICATION TOOLING ASSISTANCE CENTER TOOLING INFORMATION 1-800-722-1111	VOLTAGE RATING: 600V MAX (BUILDING & WIRING) 1000V MAX (FIXTURES & SIGNS)	DIMENSIONS: INCHES	TOLERANCES UNLESS OTHERWISE SPECIFIED: 0 PLC ± - 1 PLC ± - 2 PLC ± 0.20[.008] 3 PLC ± - 4 PLC ± - ANGLES ± -	NAME SPLICE, WIRE, CLOSED END		SIZE A3	CAGE CODE 00779	DRAWING NO C-53891	RESTRICTED TO -	
FOR ORDER ENTRY 1-800-526-5142	THIS DRAWING IS A CONTROLLED DOCUMENT FOR AMP INCORPORATED. IT IS SUBJECT TO CHANGE AND THE CONTROLLING ENGINEERING ORGANIZATION SHOULD BE CONTACTED FOR THE LATEST REVISION.		MATERIAL - △ 2	FINISH -	WEIGHT -		CUSTOMER DRAWING		SCALE 2:1	SHEET 1 OF 1	REV J