

## 53892-4 Product Details

[Share](#) [Print](#) [Email](#)

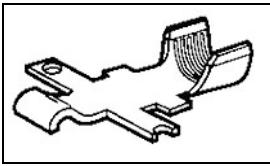

**53892-4**

TE Internal Number: 53892-4  
✔ Active

[View 3D PDF](#)

### Power Lock Connectors

✔ Always EU RoHS/ELV Compliant (Statement of Compliance)

#### Product Highlights:

- Wire-to-Wire
- Applies To Wire/Cable
- Contact
- Contact - Rated Current = 31 A
- Wire/Cable Size = 12 - 18 AWG

[View all Features](#)

### Quick Links

- ▶ [Pricing & Availability](#)
- ▶ [Search for Tooling](#)
- ▶ [Product Feature Selector](#)
- ▶ [Contact Us About This Product](#)

[Add to My Part List](#) [Request Sample](#) [Find Similar Products](#) [Buy Product](#)

### Documentation & Additional Information

#### Product Drawings:

- [CONTACT, CRIMP BARREL, SERIES 1, POWER LOCK \(PDF, English\)](#)

#### Catalog Pages/Data Sheets:

- None Available

#### Product Specifications:

- [Connector, Power Lock, Series I \(PDF, English\)](#)

#### Application Specifications:

- None Available

#### Instruction Sheets:

- [Power Lock Connectors \(Series I\) \(Accept Contact 53892 \(PDF, English\)](#)
- [Inspection of Series I Power Lock Contacts \(PDF, English\)](#)

#### CAD Files: (CAD Format & Compression Information)

- [2D Drawing \(DXF, Version M\)](#)
- [3D Model \(IGES, Version M\)](#)
- [3D Model \(STEP, Version M\)](#)

[List all Documents](#)

#### Additional Information:

- [Product Line Information](#)

#### Related Products:

- [Tooling](#)

### Product Features (Please use the Product Drawing for all design activity)

#### Product Type Features:

- Product Type = Contact
- Termination Method to Wire/Cable = Crimp
- UL File Number = E28476
- CSA File Number = LR7189
- Wire/Cable Type = Discrete Wire
- Make First / Break Last = No

#### Electrical Characteristics:

- Contact - Rated Current (A) = 31
- Operating Voltage Reference = AC
- Operating Voltage (VAC) = 600

#### Termination Features:

- Wire/Cable Size (AWG) = 12 - 18
- Wire/Cable Size (mm<sup>2</sup>) = 0.811 - 3.09
- Wire/Cable Size (CMA) = 1,601 - 6,098

#### Dimensions:

- Length (X-Axis) (mm [in]) = 18.29 [0.720]
- Width (Z-Axis) (mm [in]) = 3.76 [0.148]
- Profile Height (Y-Axis) (mm [in]) = 3.05 [0.120]

#### Contact Features:

- Contact Type = Pin/Socket
- Contact Plating, Mating Area, Material = Silver
- Contact Plating, Mating Area, Thickness (µm [µin]) = 5.08 [200]
- Contact Base Material = Copper
- Contact Design = Spring Latch

#### Industry Standards:

- [RoHS/ELV Compliance](#) = RoHS compliant, ELV compliant
- [Lead Free Solder Processes](#) = Not relevant for lead free process
- RoHS/ELV Compliance History = Always was RoHS compliant
- VDE Tested = No
- Agency/Standard = UL, CSA
- UL Rating = Recognized
- CSA Certified = Yes

#### Environmental:

- Operating Temperature (°C [°F]) = -40 - +75 [-40 - +167]

#### Conditions for Usage:

- Applies To = Wire/Cable
- Accepts Wire Insulation Diameter, Range (mm [in]) = 0.864 - 0.914 [0.034 - 0.036]
- Accepts Wire Material = Copper

#### Operation/Application:

- Application Use = Wire-to-Wire
- Contact Transmits (Typical Application) = Power

#### Packaging Features:

- Packaging Method = Loose Piece

#### Other:

- Brand = AMP

LOC	DIST	REVISIONS					
FT	60	P	LTR	DESCRIPTION	DATE	OWN	APVD
		M2		REVISED PER ECO-13-005883	23JUL2013	KH	MM

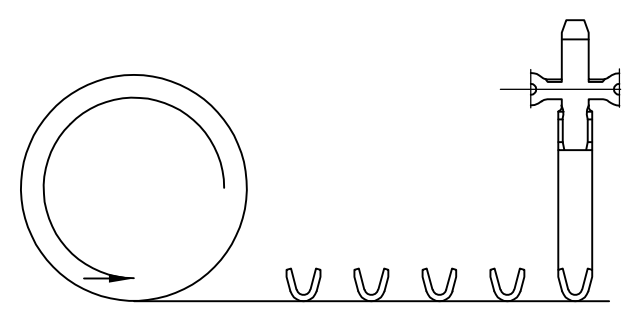
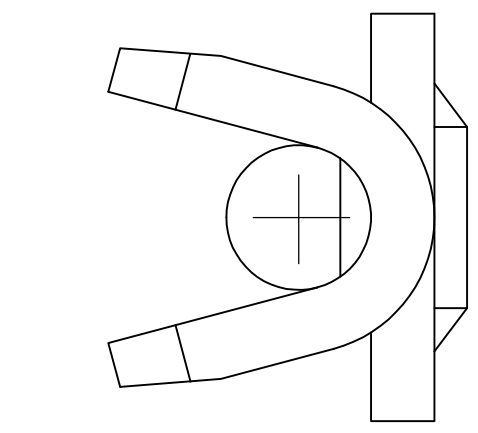
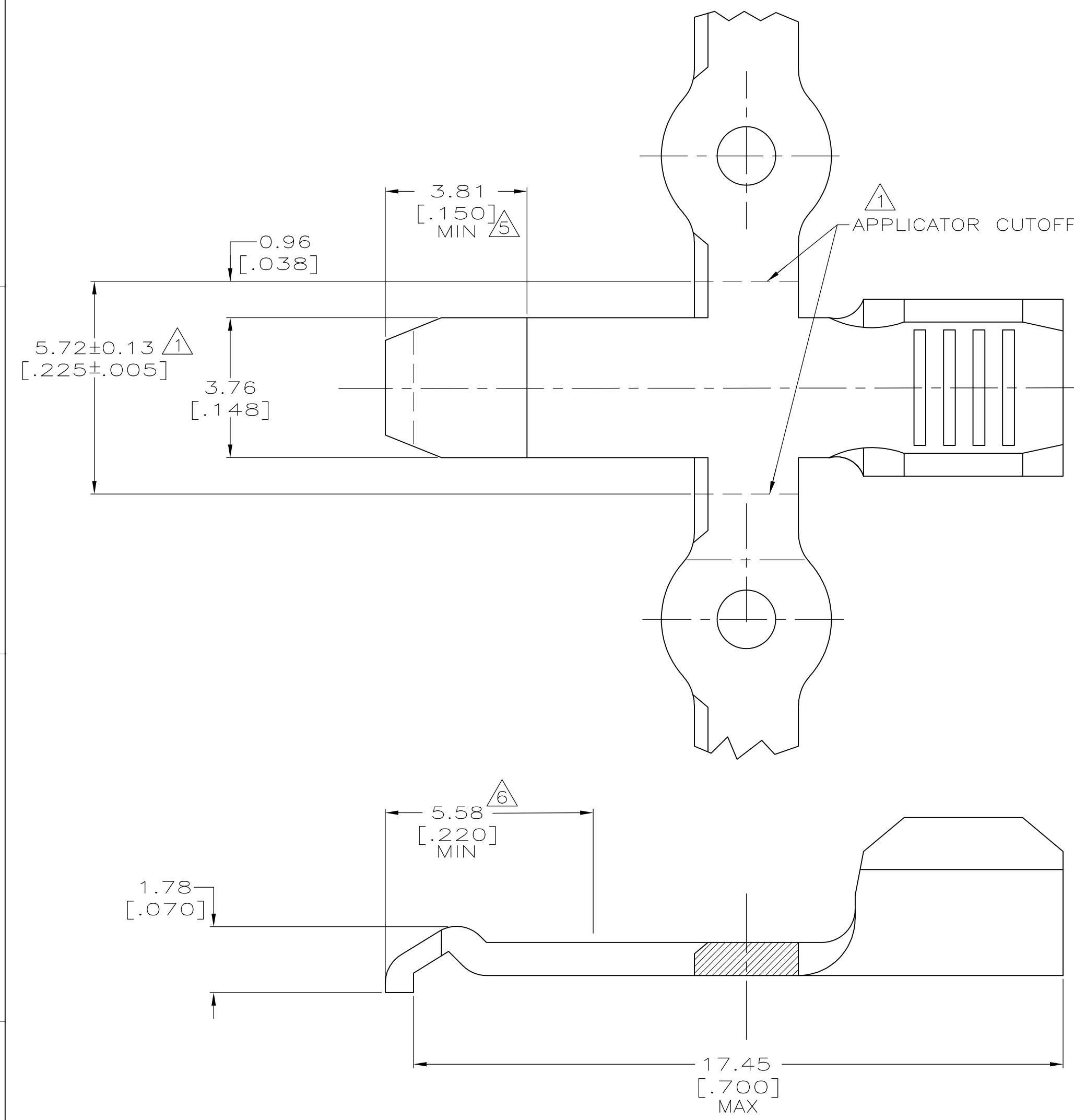

DIRECTION OFF OF REEL INTO THE APPLICATOR

SCALE: NONE

- 1 REFER TO AMP INSTRUCTION SHEET IS 2928 FOR APPLICATOR AND CUTOFF DETAILS.
- 2 MATERIAL: COPPER
- 3 FINISH: 0.05 [.000200] MINIMUM THICK SILVER PLATING.
- 4 FINISH: 0.00076 [.000030] MINIMUM THICK GOLD PLATING OVER 0.00127 [.000050] MINIMUM THICK NICKEL PLATING.
- 5 FINISH: 0.00076 [.000030] MINIMUM THICK GOLD PLATING OVER TOP SURFACE INDICATED AND GOLD FLASH OVER REMAINING SURFACES OVER 0.00127 [.000050] MINIMUM NICKEL PLATING.
- 6 TOP SURFACE IS GRAPHITE COATED IN AREA INDICATED.

SUPERSEDED BY -2	3 6	STRIP	1-53892-1
	5	STRIP	53892-8
OBSOLETE	4	LOOSE PIECE	53892-7
	3	LOOSE PIECE	53892-4
	3	STRIP	53892-2
		FINISH	DESCRIPTION
			PART NO

THIS DRAWING IS A CONTROLLED DOCUMENT.		DWN	K TILLMAN/UTA	3-21-94	<b>STE</b> TE Connectivity
DIMENSIONS: MM [INCHES]		CHK	D. HUSSEY	3-23-94	
TOLERANCES UNLESS OTHERWISE SPECIFIED:		APVD	D. KEMPKA	3-23-94	NAME
0 PLC ± -		PRODUCT SPEC		108-11026	CONTACT, CRIMP BARREL, SERIES 1, POWER LOCK
1 PLC ± -		APPLICATION SPEC		114-6032	SIZE
2 PLC ± 0.20 [.008]		WEIGHT		-	CAGE CODE
3 PLC ± -		CUSTOMER DRAWING			DRAWING NO
4 PLC ± -		SCALE		10:1	SHEET
ANGLES ± ± 5°		SHEET		1 OF 1	REV
FINISH	SEE TABLE	RESTRICTED TO		-	M2