

LOC	DIST	REV	DATE	BY	APPD
AA	22	A	28JUL2005	GA	SF

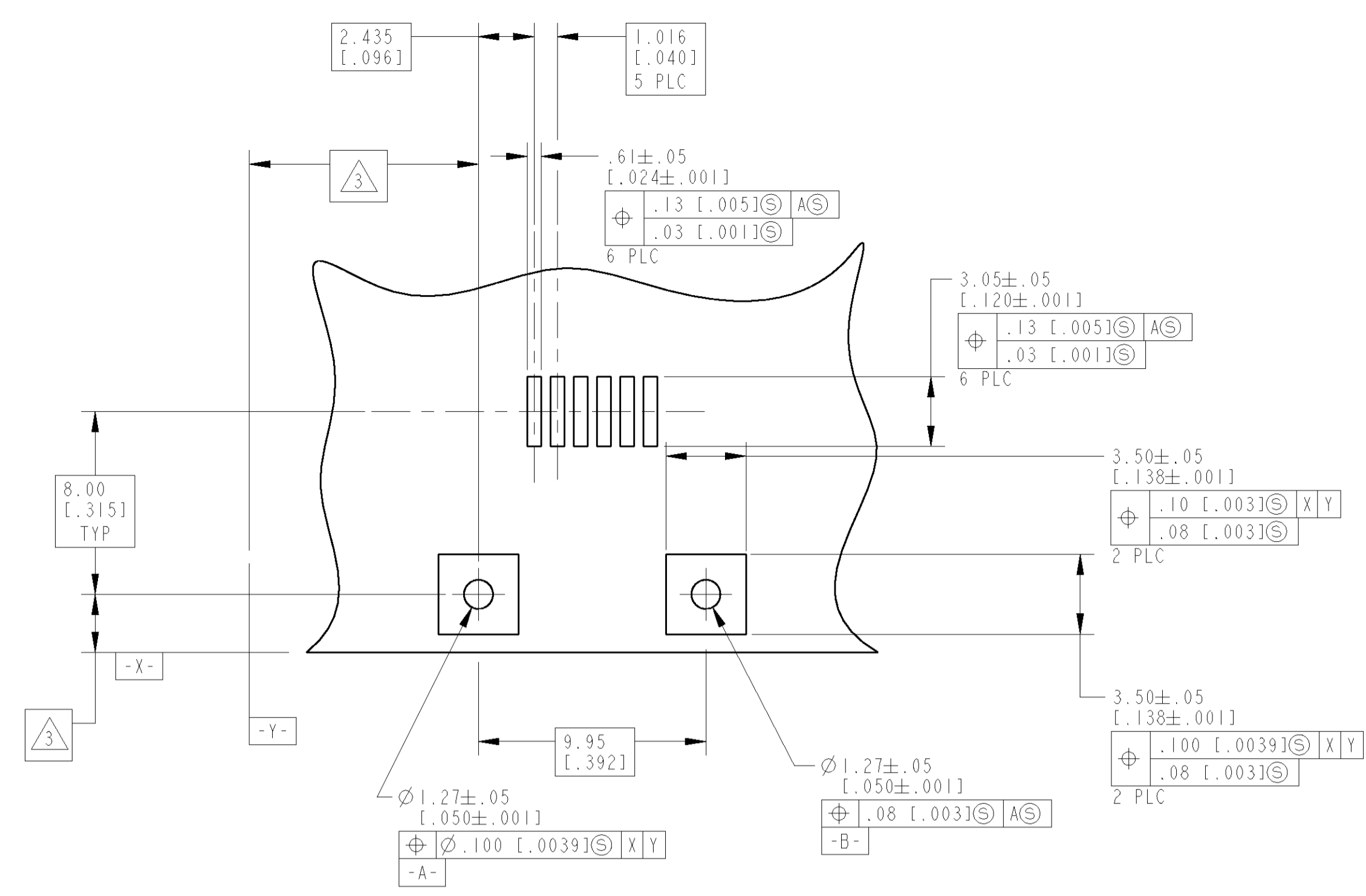

- △ MATERIAL: HOUSING - HIGH TEMPERATURE THERMOPLASTIC. COLOR - GRAY. TERMINALS - 0.31[.012] THICK COPPER ALLOY PLATED WITH 1.27µm[.000050] MINIMUM GOLD IN LOCALIZED GOLD PLATE AREA, 2.5 µm[.000100] MINIMUM MATTE TIN ON TERMINATION END, BOTH OVER 1.27µm[.000050] MINIMUM NICKEL OVER ENTIRE TERMINAL. BOARDLOCK - PHOS BRONZE, 1/2 HARD, 3.81µm[.000150] MINIMUM MATTE TIN OVER 1.27µm[.000050] MINIMUM NICKEL ON TERMINAL END.
- △ JACK CAVITY CONFORMS TO FCC 47 RULES AND REGULATIONS, PART 68 SUBPART F.
- △ DATUM ESTABLISHED BY CUSTOMER.
- △ PACKAGING TAPE AND REEL: (PER EIA 481 SPEC) 32mm WIDE TAPE, 24mm POCKET PITCH, 560mm REEL DIA, 600 PIECES PER REEL.
- △ PACKAGING TAPE AND REEL: (PER EIA 481 SPEC) 32mm WIDE TAPE, 24mm POCKET PITCH, 330mm REEL DIA, 200 PIECES PER REEL.
- △ CONNECTOR SHOULD BE POSITIONED THROUGH PANEL CUTOUT AS SHOWN TO SUPPORT TOP OF MODULAR JACK FOR STRAIN RELIEF.
- △ MANUFACTURING DATE CODE LOCATED APPROXIMATELY AS SHOWN. FIRST 2 DIGITS ARE YEAR, SECOND 2 DIGITS ARE WORK WEEK, AND LAST DIGIT IS THE DAY OF THE WEEK.

RECOMMENDED PRINTED CIRCUIT BOARD LAYOUT
 COMPONENT SIDE
 SCALE 5:1

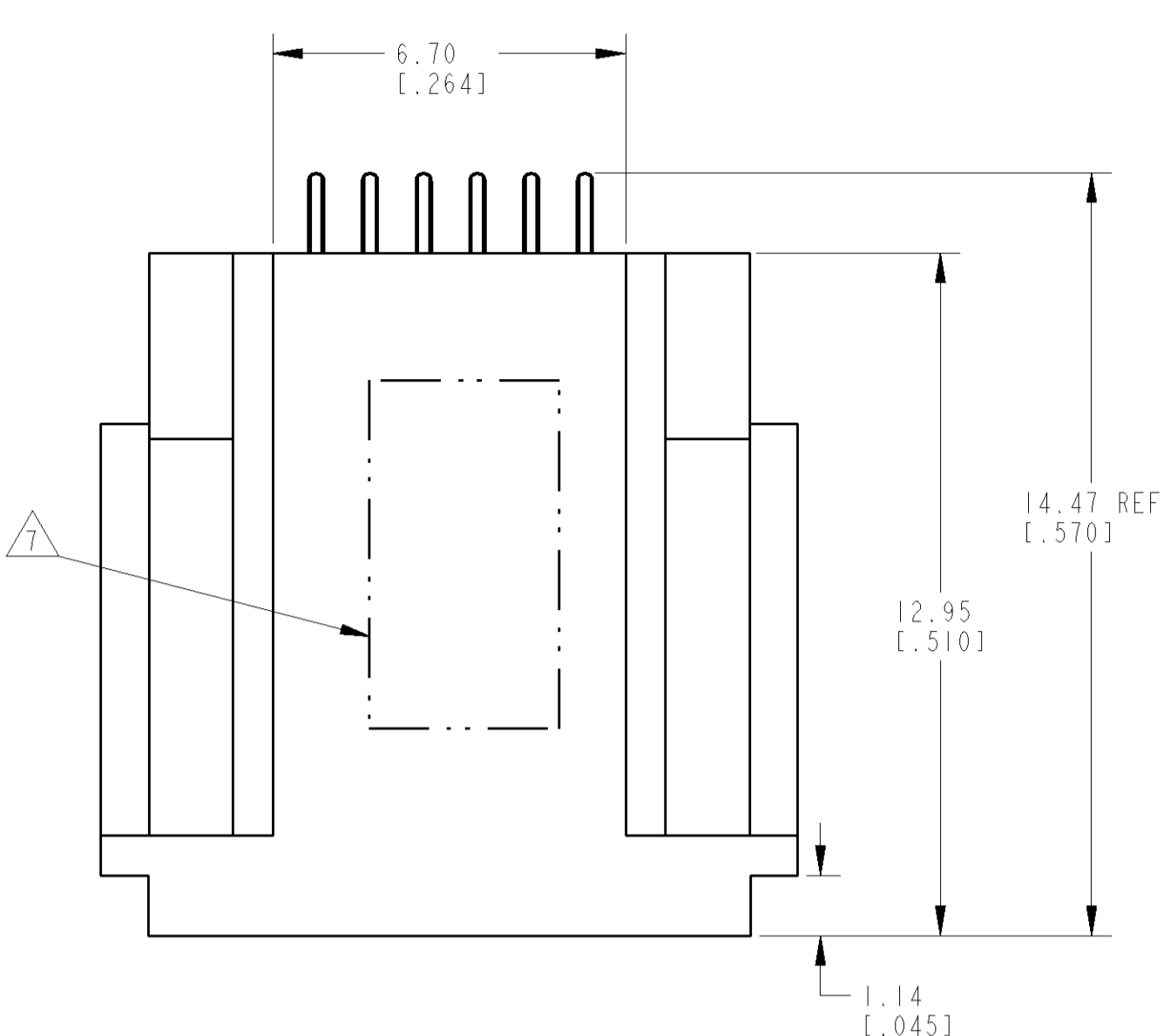
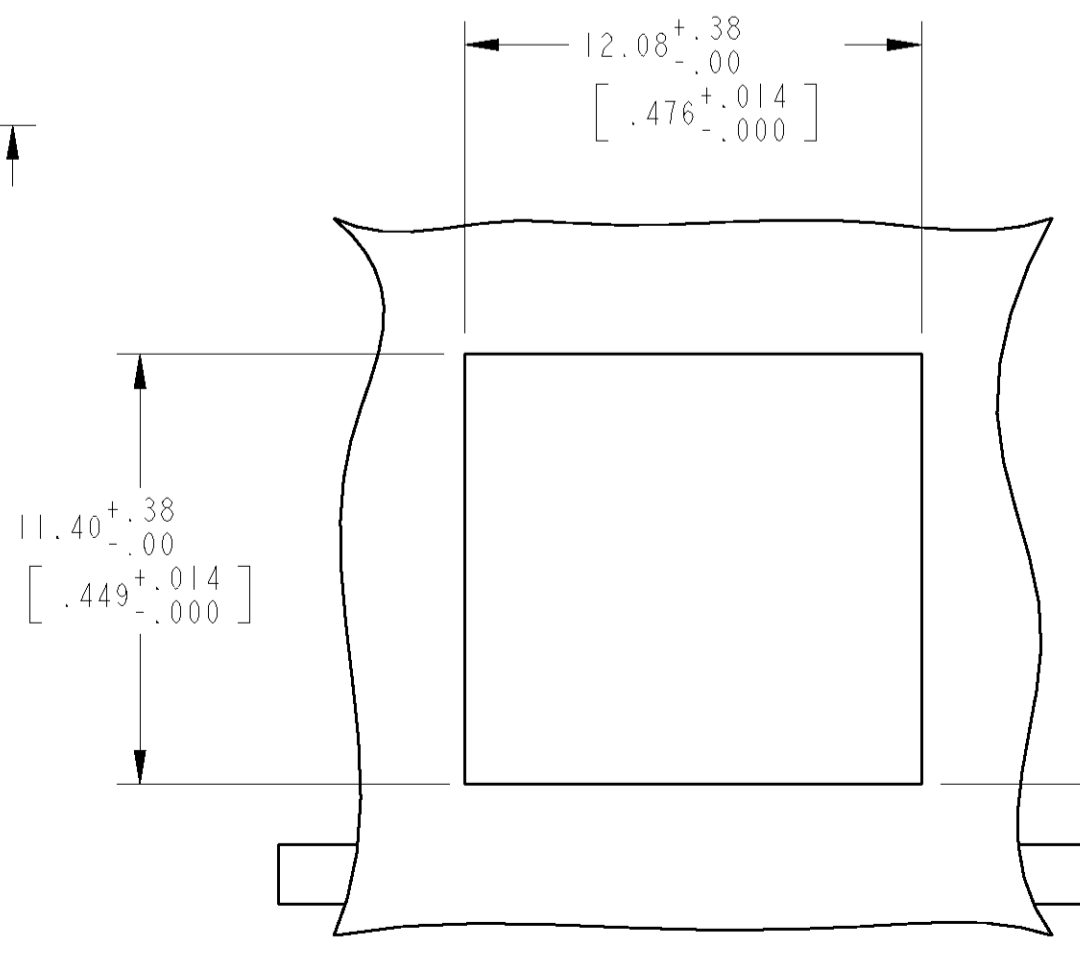
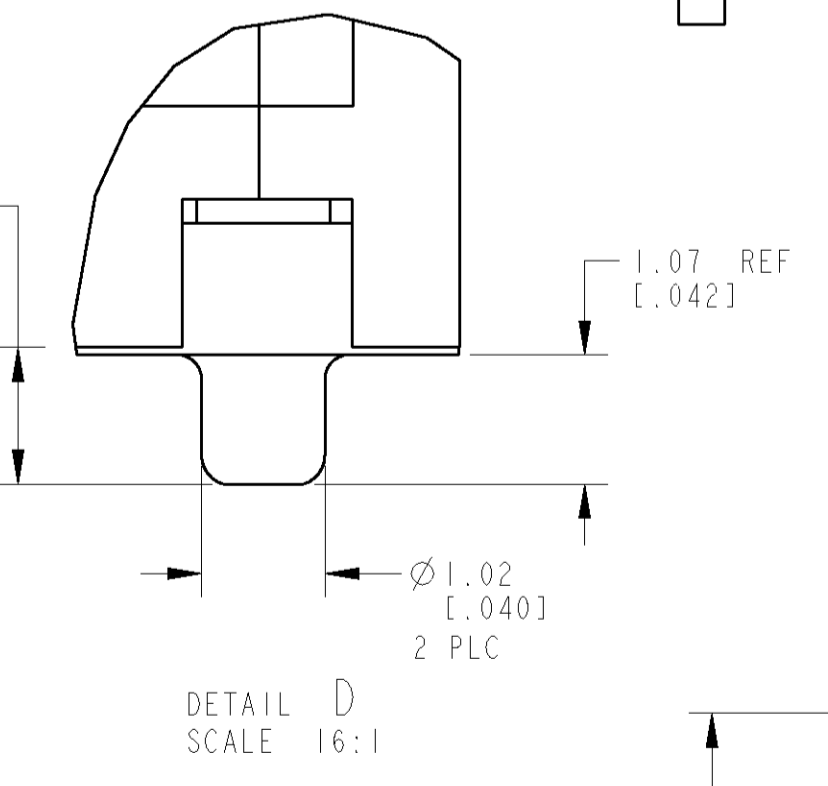
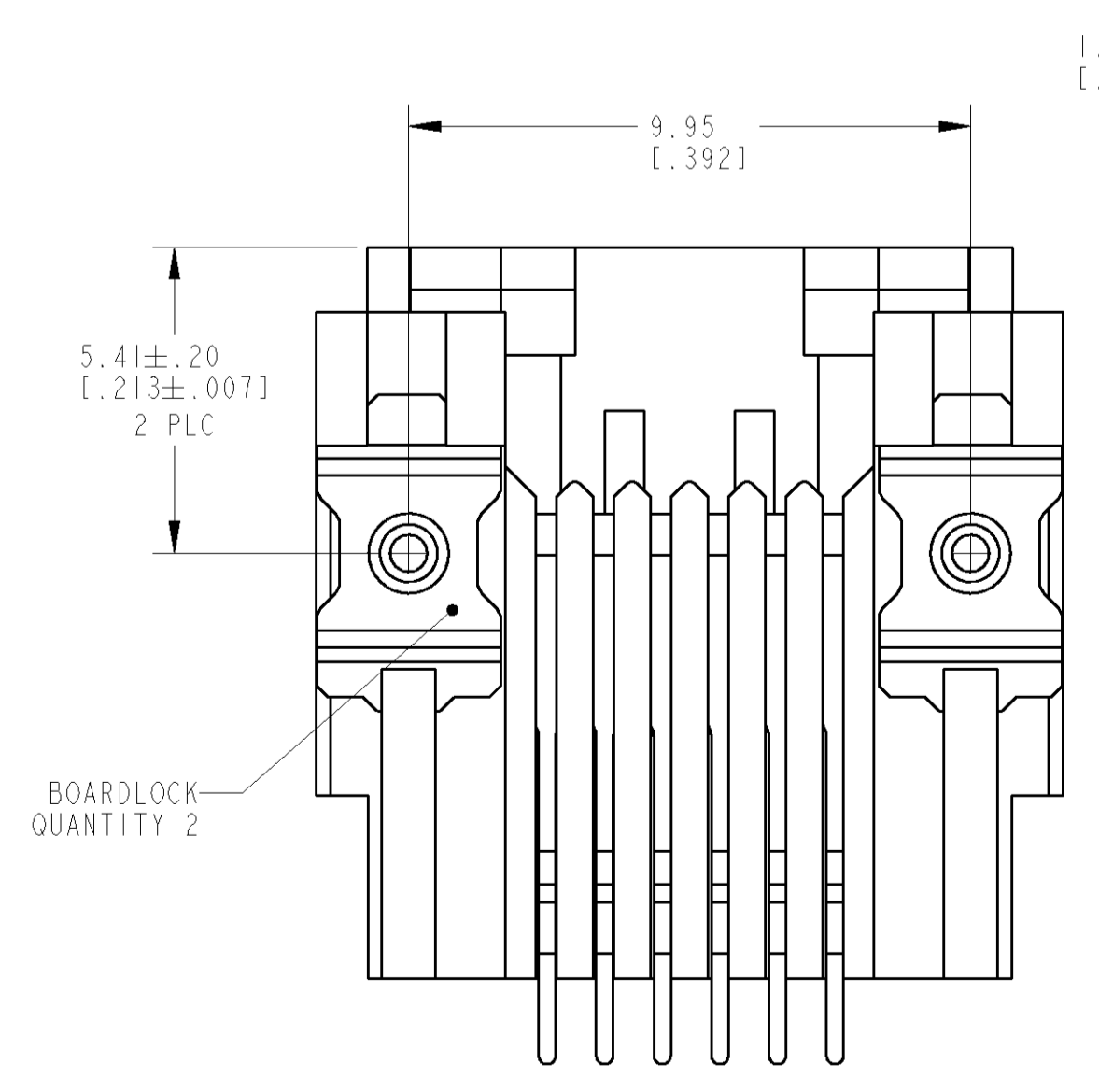
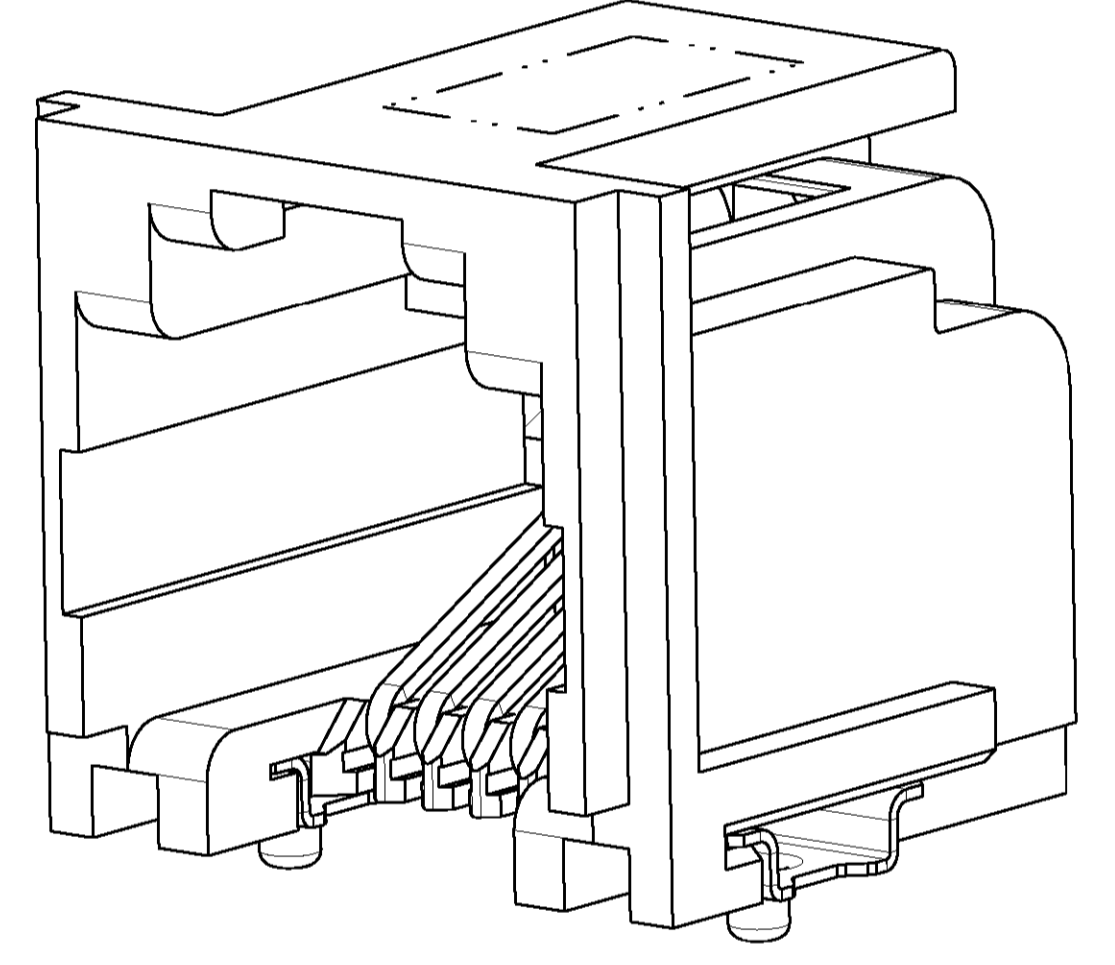
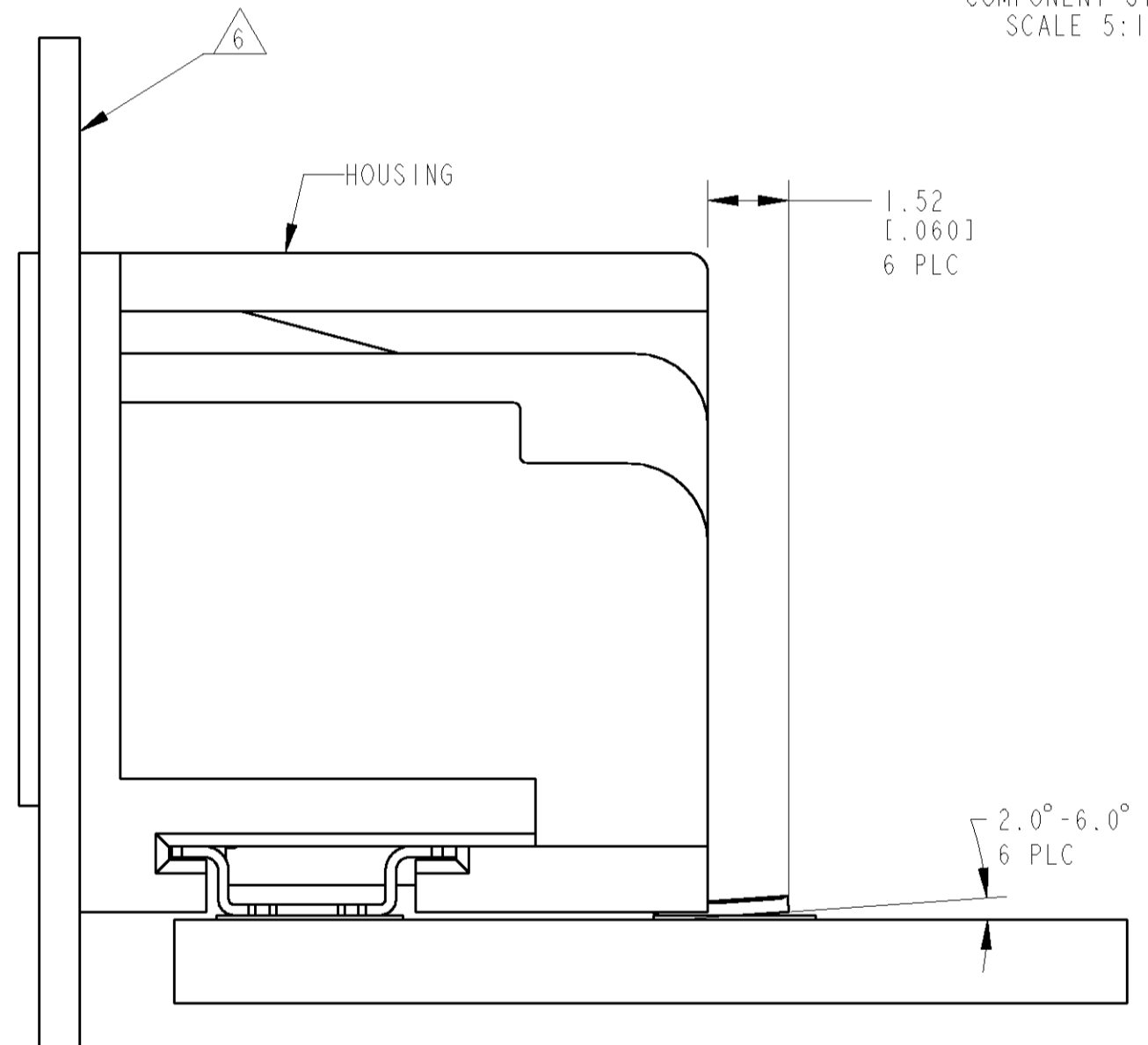
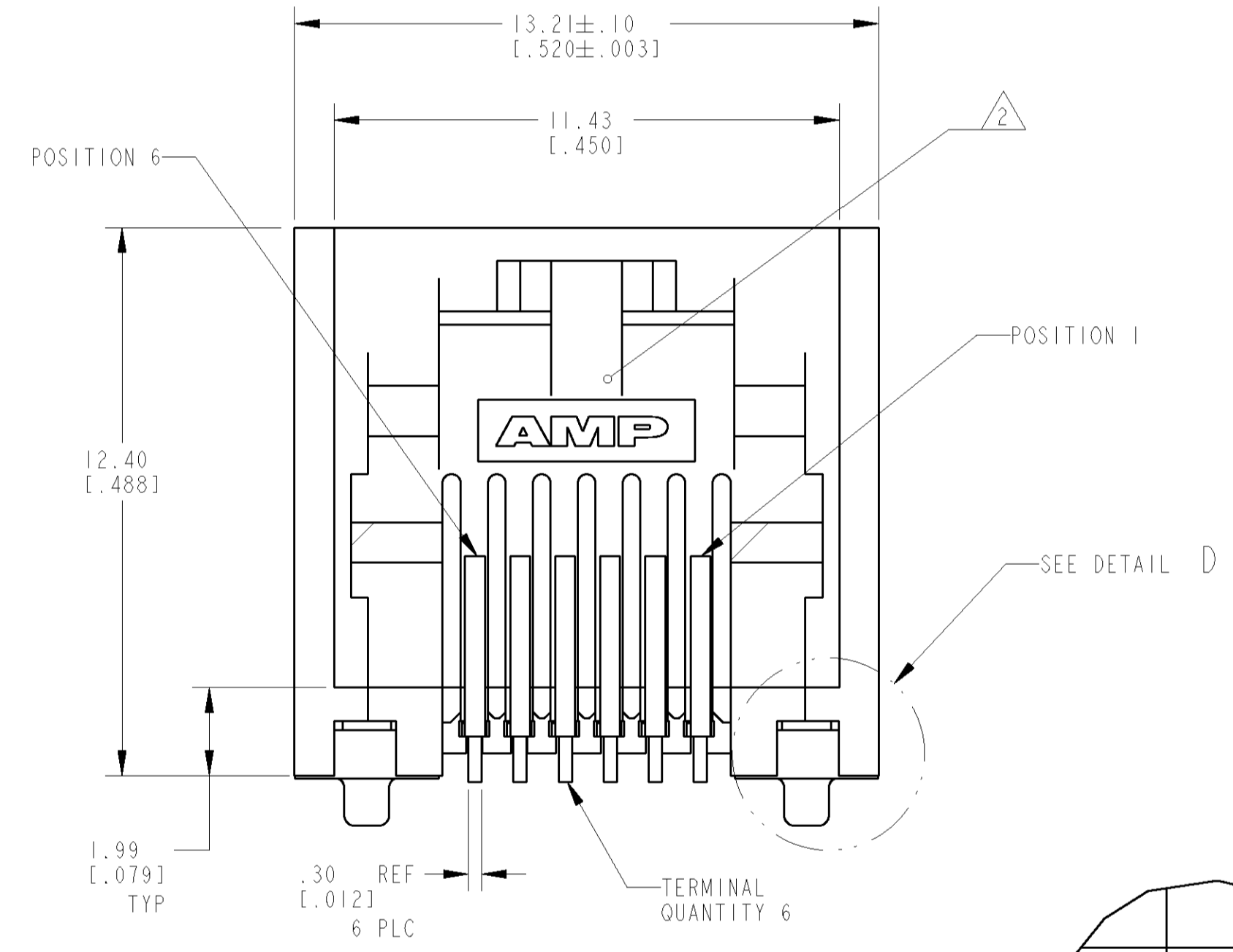

RECOMMENDED PANEL CUTOUT
 SCALE 5:1

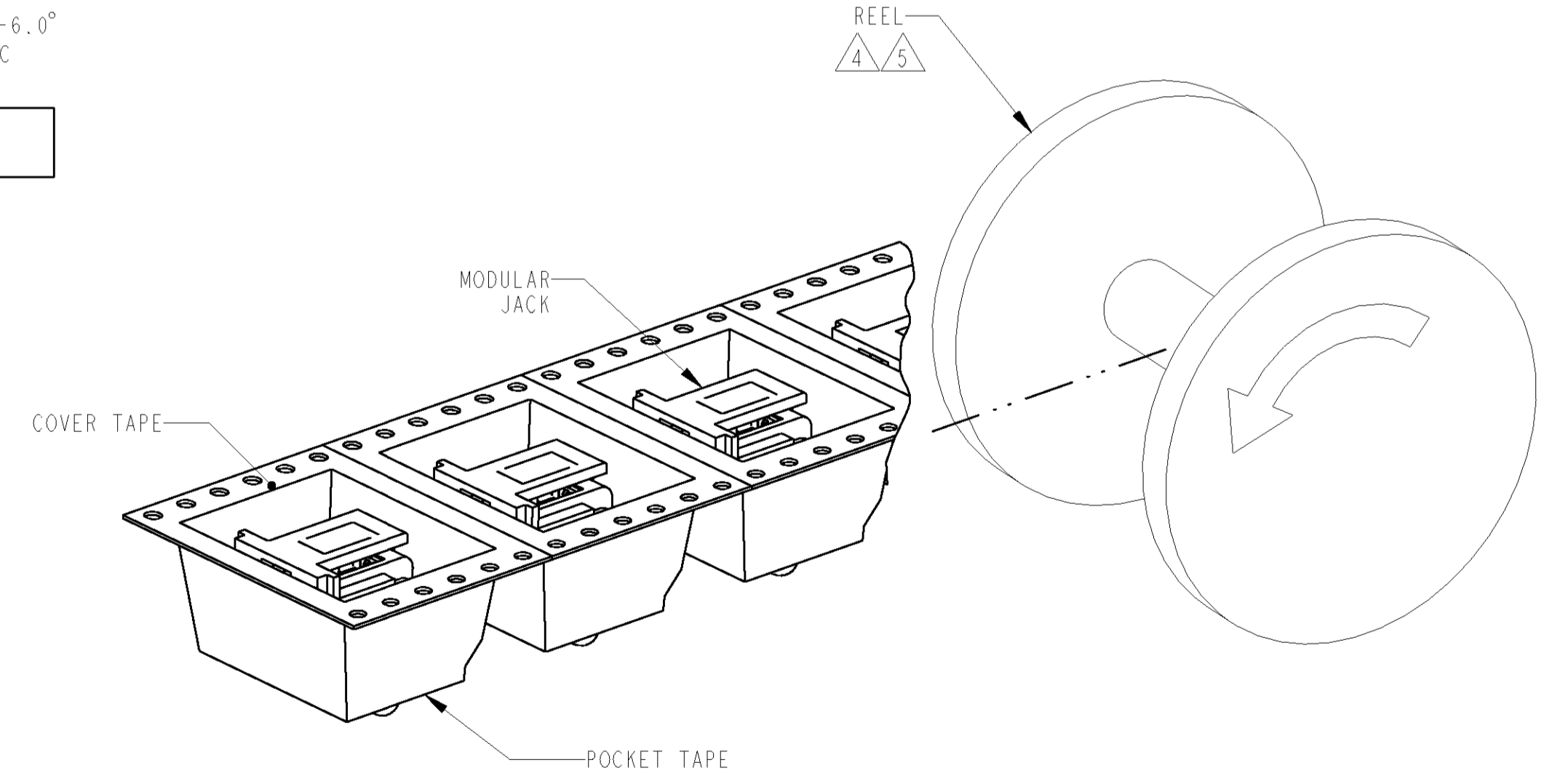

△ 5	5406514-2
△ 4	5406514-1
PACKAGING	PART NUMBER

DIMENSIONS: mm [INCHES] TOLERANCES UNLESS OTHERWISE SPECIFIED: 0 PLC ± 1 PLC ± 2 PLC ± 3 PLC ± 4 PLC ± ANGLES ±		DWN: 28 JUL 2005 ESK: ATTADIA - 00665 J. WESTMAN S. FLICKINGER PRODUCT SPEC: 108-1689 APPLICATION SPEC: 114-6040 WEIGHT: .95 GRAMS CUSTOMER DRAWING		AMP Incorporated Harrisburg, PA 17105-3608 MODULAR JACK ASSEMBLY, 6/6 POSITION, SURFACE MOUNT, RIGHT ANGLE, WITH INWARD BOARDLOCKS SIZE: CAGE CODE DRAWING NO. RESTRICTED TO A1 00779 C=5406514 SCALE 8:1 SHEET 1 OF 1 REV A	
--	--	--	--	---	--