

## 5413631-2 Product Details

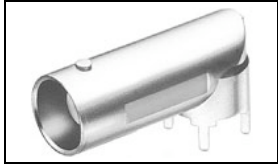

**5413631-2**

TE Internal Number: 5413631-2



Active

### BNC RF Connectors

 Always EU RoHS/ELV Compliant (Statement of Compliance)

#### Product Highlights:

- Connector - RF
- Jack
- Connector Style = Jack
- Applies To Printed Circuit Board
- PCB Mounting Orientation = Right Angle

### Documentation & Additional Information

#### Product Drawings:

- [JACK, RIGHT ANGLE, PCB, 50 OHM, SERIES BNC](#) (PDF, English)

#### Catalog Pages/Data Sheets:

- [BNC Connectors](#) (PDF, English)

#### Product Specifications:

- [BNC PCB Straight and Right Angle Connectors](#) (PDF, English)

#### Application Specifications:

- None Available

#### Instruction Sheets:

- None Available

#### CAD Files: (CAD Format & Compression Information)

- [2D Drawing](#) (DXF, Version A)
- [3D Model](#) (IGES, Version A)
- [3D Model](#) (STEP, Version A)

#### Related Products:

- [Tooling](#)

### Product Features (Please use the Product Drawing for all design activity)

#### Product Type Features:

- [Product Type](#) = Connector - RF
- Gender = Jack
- [PCB Mounting Orientation](#) = Right Angle
- [Grade](#) = Commercial
- [PCB Mount Retention](#) = Without
- [Sealed](#) = No
- [Isolated](#) = No
- [Dielectric Material](#) = Fluoropolymer
- [Solder Terminal](#) = Without

#### Mechanical Attachment:

- [Surface Mountable](#) = No
- [Hardware Included](#) = No
- [Panel Mount Retention](#) = Without

#### Electrical Characteristics:

- [Connector Impedance](#) ( $\Omega$ ) = 50

#### Dimensions:

- [PCB Height](#) (mm [in]) = 10.97 [0.432]

#### Body Features:

- [Body Material](#) = Zinc
- [Body Plating](#) = Tin
- [Body Insulation](#) = Without
- [Polarized](#) = No

#### Contact Features:

- [Center Contact Material](#) = Beryllium Copper
- [Center Contact Plating](#) = Gold

#### Housing Features:

- [Connector Style](#) = Jack

#### Configuration Features:

- [Number of Ports](#) = 1

#### Industry Standards:

- [Government/Industry Qualification](#) = No
- [RoHS/ELV Compliance](#) = RoHS compliant, ELV compliant
- [Lead Free Solder Processes](#) = Wave solder capable to 260°C, Wave solder capable to 240°C, Wave solder capable to 265°C
- [RoHS/ELV Compliance History](#) = Always was RoHS compliant

#### Conditions for Usage:

- [Applies To](#) = Printed Circuit Board

#### Other:

- [Brand](#) = AMP

THIS DRAWING IS UNPUBLISHED. RELEASED FOR PUBLICATION  
 © COPYRIGHT - By - ALL RIGHTS RESERVED.

Loc		DIST		REVISIONS			
P	LTR	DESCRIPTION		DATE	DWN	APVD	
	B3	REVISED PER ECO-11-005030		11MAR11	RK	HMR	
	C	ECO-12-018113		27DEC2012	TD	MY	

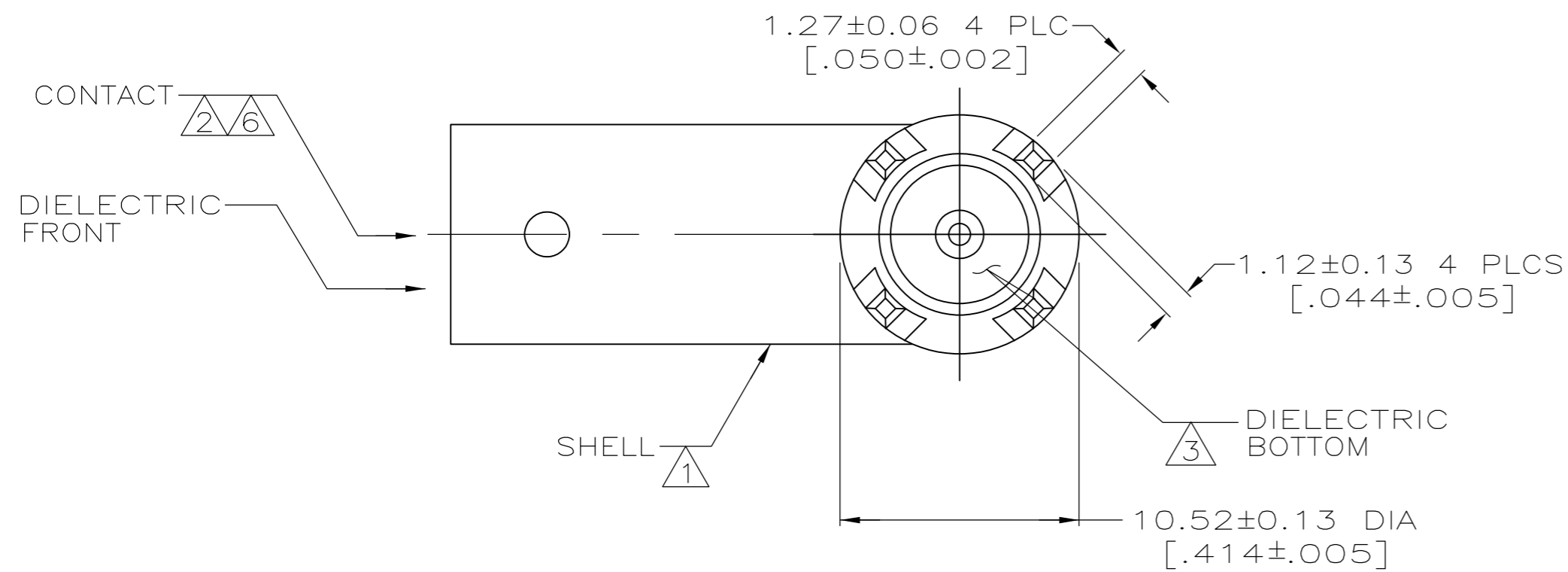
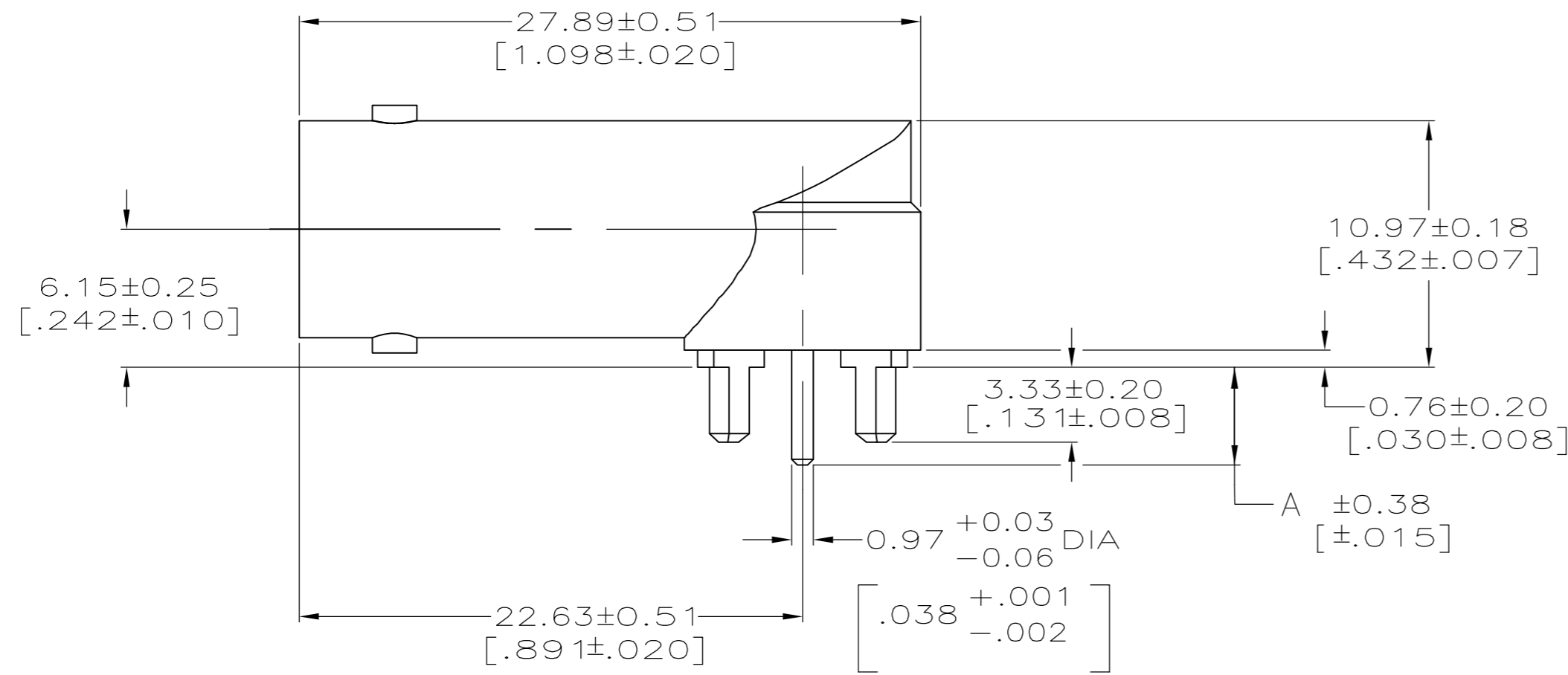

- ① ZINC PER QQ-Z-363.
- ② BERYLLIUM COPPER PER QQ-C-530.
- ③ PTFE PER MIL-P-19468.
- ④ NICKEL PLATE PER QQ-N-290, 3.81µm [.000150] MINIMUM THICK.
- ⑤ TIN PLATE PER ASTM-B-545, 3.04µm [.000120] MINIMUM THICK OVER NICKEL PLATE PER MIL-C-26074, 7.62µm [.000300] MINIMUM THICK.
- ⑥ GOLD PLATE PER MIL-G-45204, 1.27µm [.000050] MINIMUM THICK.
- ⑦ INTERFACE PER MIL-C-39012.
- ⑧ POLYMETHYLPENTENE, GENERAL PURPOSE

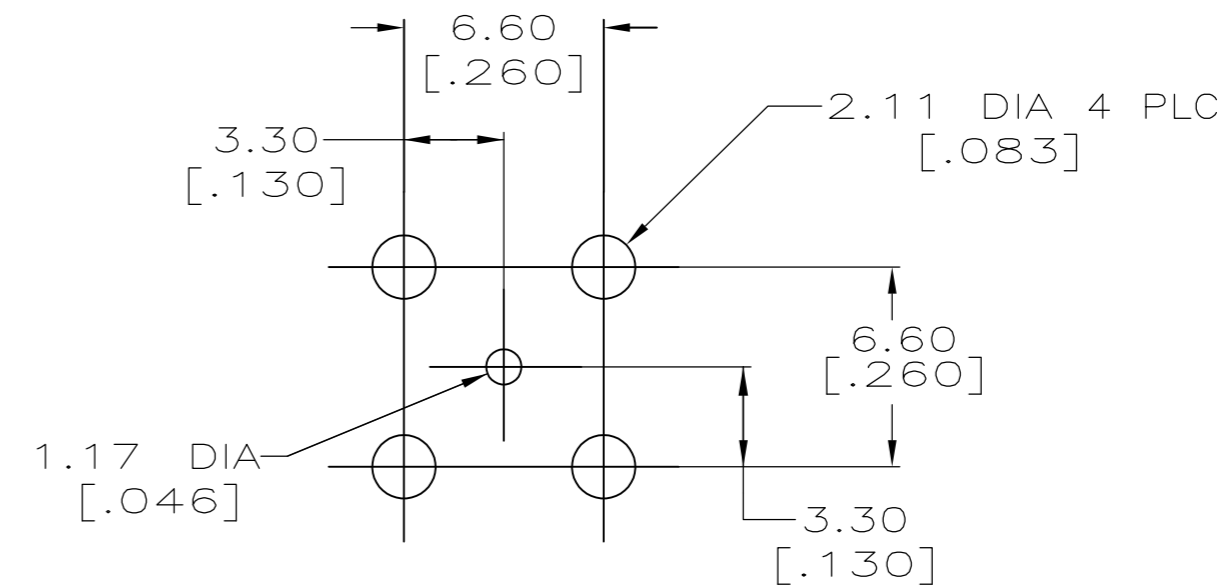

PCB CONFIGURATION

OBSOLETE	3.33 [.131]	④	⑤	5413631-5
	3.33 [.131]	④	⑧	5413631-3
	4.34 [.171]	⑤	③	5413631-2
	4.34 [.171]	④	⑧	5413631-1
	A	FINISH: SHELL	MATERIAL: DIELECTRIC, FRONT	PART NUMBER

THIS DRAWING IS A CONTROLLED DOCUMENT.		DWN	B.MCMASTER	03JAN05												
DIMENSIONS: INCHES		CHK	J.LIPPERT	03JAN05												
TOLERANCES UNLESS OTHERWISE SPECIFIED:		APVD	J.LIPPERT	03JAN05												
<table border="1"> <tr><td>0 PLC</td><td>± -</td></tr> <tr><td>1 PLC</td><td>± -</td></tr> <tr><td>2 PLC</td><td>± 0.08 [.003]</td></tr> <tr><td>3 PLC</td><td>± -</td></tr> <tr><td>4 PLC</td><td>± -</td></tr> <tr><td>ANGLES</td><td>± -</td></tr> </table>		0 PLC	± -	1 PLC		± -	2 PLC	± 0.08 [.003]	3 PLC	± -	4 PLC	± -	ANGLES	± -	PRODUCT SPEC	NAME
0 PLC	± -															
1 PLC	± -															
2 PLC	± 0.08 [.003]															
3 PLC	± -															
4 PLC	± -															
ANGLES	± -															
MATERIAL	FINISH	APPLICATION SPEC	JACK, RIGHT ANGLE, PCB, 50 OHM, SERIES BNC													
SEE NOTES 1-3	SEE NOTES 4-6	WEIGHT	-	SIZE	CAGE CODE	DRAWING NO	RESTRICTED TO									
CUSTOMER DRAWING		SCALE	4:1	SHEET	1 of 1	REV	C									