

## 5492642-2 Product Details

[Share](#) [Print](#) [Email](#)



**5492642-2**

TE Internal Number: 5492642-2  
 Active

### ST Connectors

Always EU RoHS/ELV Compliant (Statement of Compliance)

#### Product Highlights:

- Connector
- Fiber Optic Connector Type = LIGHTCRIMP PLUS Simplex
- Epoxyless
- Pre-Polished
- Multimode

[View all Features](#)

### Quick Links

- ▶ [Pricing & Availability](#)
- ▶ [Search for Tooling](#)
- ▶ [Product Feature Selector](#)
- ▶ [Contact Us About This Product](#)

[Add to My Part List](#)

[Request Sample](#)

[Find Similar Products](#)

[Buy Product](#)

### Documentation & Additional Information

#### Product Drawings:

- [CONNECTOR KIT, LightCrimp Plus, ST STYLE CERAMIC, 62...](#) (PDF, English)

#### Catalog Pages/Data Sheets:

- [Fiber Optic Catalog - Fiber Optic Products](#) (PDF, English)
- [Enterprise Networks EMEA Product Catalog](#) (PDF, English)
- [LightCrimp Plus Connectors](#) (PDF, English)

#### Product Specifications:

- None Available

#### Application Specifications:

- None Available

#### Instruction Sheets:

- [Fiber Optic Cleaver 1871696-1](#) (PDF, English)
- [Cleave Tool 492674-1](#) (PDF, English)
- [LightCrimp Plus ST Fiber Optic Connector Kits](#) (PDF, English)

#### CAD Files:

- None Available

#### Related Products:

- [Tooling](#)

[List all Documents](#)

### Product Features (Please use the Product Drawing for all design activity)

#### Product Type Features:

- **Product Type** = Connector
- Fiber Optic Connector Type = LIGHTCRIMP PLUS Simplex
- **Coupling Nut Material** = Zinc
- Sleeve Style = Stepped
- Sleeve Material = Copper
- Sleeve Finish = Nickel

#### Electrical Characteristics:

- Insertion Loss (dB) = 0.20

#### Termination Features:

- Fiber Type (Micron) = OM1 62.5/125

#### Dimensions:

- **Cable Diameter (Max.) (mm [in])** = 3.00 [0.118]

#### Body Features:

- **Epoxyless** = Yes
- **Pre-Polished** = Yes
- **Ferrule Hole Size (µm)** = 125
- **Boot Type** = Bend Limiting
- Boot Color = Beige
- **Body Material** = Aluminum
- **Ferrule Material** = Ceramic
- Boot Material = Thermoplastic Elastomer
- Body Plating = Nickel

#### Configuration Features:

- **Mode** = Multimode

#### Industry Standards:

- **RoHS/ELV Compliance** = RoHS compliant, ELV compliant
- **Lead Free Solder Processes** = Not relevant for lead free process
- **RoHS/ELV Compliance History** = Always was RoHS compliant

#### Identification Marking:

- AMP Logo = With

#### Packaging Features:

- Packaging Method = Individual Kit
- Packaging Quantity = 200

#### Product Availability:

- Region = Asia, EMEA, North America, Australia/New Zealand

#### Other:

- Brand = TE Connectivity
- Proprietary Name = LIGHTCRIMP PLUS

THIS DRAWING IS UNPUBLISHED. RELEASED FOR PUBLICATION 20  
 © COPYRIGHT 20 ALL RIGHTS RESERVED.

LOC	DIST	REVISIONS					
CE	00	P	LTR	DESCRIPTION	DATE	DWN	APVD
			D2	REVISED PER ECO-13-003766	04MAR2013	JM	TE

- 1 MATERIAL:  
 CONNECTOR ASSY  
 REAR BODY: ALUMINUM ALLOY  
 PLUNGER: ALUMINUM ALLOY  
 FERRULE: CERAMIC  
 COUPLING NUT: ZINC, NICKEL PLATED  
 INTERNAL COMPONENTS: PEI, COLOR: NATURAL  
 SPRING: STAINLESS STEEL  
 PROTECTIVE COVER: LDPE, COLOR: BLACK, NON-FR  
 PROTECTIVE CAP: VINYL, COLOR: BLACK  
 CRIMP EYELET: COPPER, NICKEL PLATED  
 INNER EYELET: BRASS  
 POLYMER TUBING: TYGON, COLOR: CLEAR  
 HYTREL, COLOR: WHITE  
 PVC, COLOR: BLACK  
 STRAIN RELIEF: POLYOLEFIN ELASTOMER, COLOR: SEE TABLE, NON-FR  
 BOOT: POLYOLEFIN ELASTOMER, COLOR: SEE TABLE\*  
 \*UL94 V-0 RATED AT QUALIFYING THICKNESS.

2. INSTRUCTION SHEET: 408-4457 AVAILABLE FOR DOWNLOAD AT  
[www.tycoelectronics.com/documents](http://www.tycoelectronics.com/documents) OR [www.ampnetconnect.com/foguide](http://www.ampnetconnect.com/foguide).
3. THIS KIT WILL TERMINATE:  
 900um TIGHT BUFFERED FIBER  
 250um COATED FIBER  
 2.0-3.0mm JACKETED CABLE  
 900um EASY STRIP OR SEMI-TIGHT BUFFERED FIBER

- 4 PROTECTIVE CAP AND COVER ARE SHOWN REMOVED FROM CONNECTOR ASSEMBLY FOR CLARITY ONLY.
5. TIGHT BUFFER TO BE 900±50um.

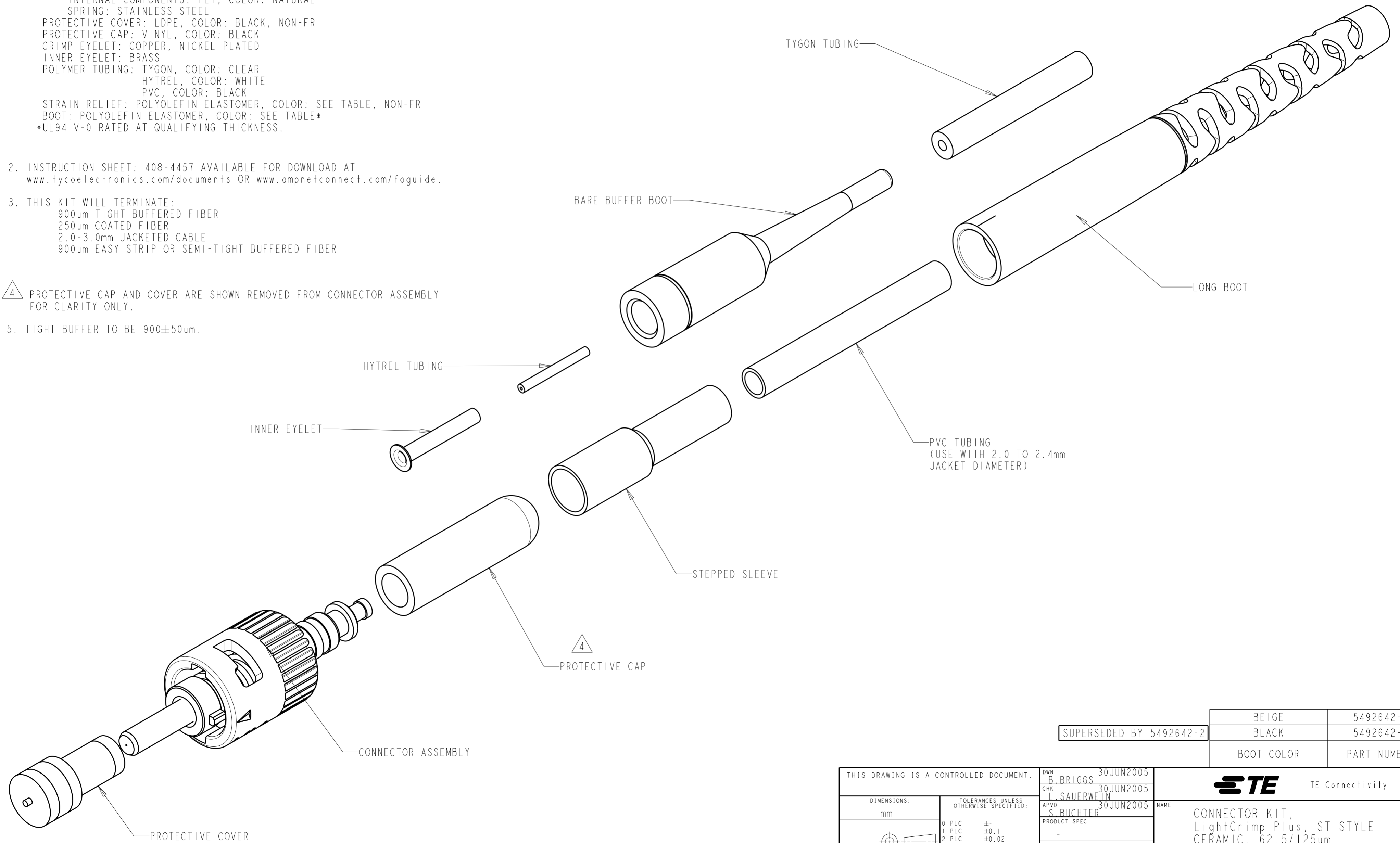

SUPERSEDED BY 5492642-2	BEIGE	5492642-2
	BLACK	5492642-1
	BOOT COLOR	PART NUMBER

THIS DRAWING IS A CONTROLLED DOCUMENT.		DWN B. BRIGGS 30 JUN 2005	 TE Connectivity
DIMENSIONS: mm		CHK L. SAUERWEIN 30 JUN 2005	
TOLERANCES UNLESS OTHERWISE SPECIFIED: 0 PLC ± 1 PLC ±0.1 2 PLC ±0.02 3 PLC ±0.005 4 PLC ±0.0005 ANGLES ± FINISH		APVD S. BUCHTER 30 JUN 2005	
MATERIAL		PRODUCT SPEC APPLICATION SPEC WEIGHT	
		NAME CONNECTOR KIT, LightCrimp Plus, ST STYLE CERAMIC, 62.5/125um	RESTRICTED TO
		SIZE A2	CAGE CODE 00779
CUSTOMER DRAWING		DRAWING NO G-5492642	SCALE 4:1
		SHEET 1	OF 1
		REV D2	