

## 5520259-4 Product Details

[Share](#) [Print](#) [Email](#)

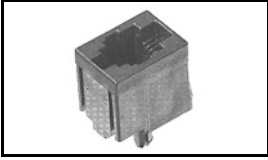

**5520259-4**

TE Internal Number: 5520259-4

 **Active**

 [View 3D PDF](#)

### PCB Mounted Jacks - Single Port, Multi-port and Stacked

 Always EU RoHS/ELV Compliant  
(Statement of Compliance)

#### Product Highlights:

- Connector
- Preloaded
- Single Port Configuration
- 1 x 1 Jack Configuration
- Jack Type = RJ45

[View all Features](#)

#### Quick Links

- ▶ [Pricing & Availability](#)
- ▶ [Search for Tooling](#)
- ▶ [Product Feature Selector](#)
- ▶ [Contact Us About This Product](#)

[Add to My Part List](#)

[Request Sample](#)

[Find Similar Products](#)

[Buy Product](#)

### Documentation & Additional Information

#### Product Drawings:

- [MODULAR JACK ASSEMBLY, TOP ENTRY, 8 POSITION, FLANGE...](#) (PDF, English)

#### Catalog Pages/Data Sheets:

- [1-1773464-9\\_MODULAR JACKS\\_SINGLE\\_PORT\\_PCB\\_MOUNT](#) (PDF, English)
- [82066 - Modular Jacks and MRJ21 Product catalog - Si...](#) (PDF, English)

#### Product Specifications:

- [Modular Plugs, Thru-Hole and Surface Mount Jacks, Da...](#) (PDF, English)

#### Application Specifications:

- [Modular Jacks](#) (PDF, English)

#### Instruction Sheets:

- None Available

#### CAD Files: (CAD Format & Compression Information)

- [2D Drawing](#) (DXF, Version A)
- [3D Model](#) (IGES, Version A)
- [3D Model](#) (STEP, Version A)

[List all Documents](#)

#### Additional Information:

- [Product Line Information](#)

#### Related Products:

- [Tooling](#)

### Product Features (Please use the Product Drawing for all design activity)

#### Product Type Features:

- Product Type = Connector
- Jack Type = RJ45
- PCB Mounting Orientation = Top Entry (Vertical)
- PCB Mount Style = Through Hole
- Termination Method to PC Board = Solder
- Performance Category = Cat 3
- LED = Without
- Grounding Options = Without
- Panel Stops = With
- Keyed = No
- Profile = Standard
- Color = Black

#### Body Features:

- Inverted Jack Face = No

#### Contact Features:

- Contact Plating, Mating Area, Material = Gold (50)
- Contact Base Material = Phosphor Bronze

#### Housing Features:

- Housing Material = PBT - GF
- UL Flammability Rating = UL 94V-0

#### Configuration Features:

- Preloaded = Yes

- Latch Style = Standard

**Mechanical Attachment:**

- [Panel Mount Retention](#) = With
- Flanged = No

**Electrical Characteristics:**

- [Shielded](#) = No

**Termination Features:**

- [Solder Tail Contact Plating](#) = Tin over Nickel

**Dimensions:**

- [Height \(mm \[in\]\)](#) = 16.50 [0.650]
- [PCB Tail Length \(mm \[in\]\)](#) = 3.80 [0.150]
- [PCB Thickness, Recommended \(mm \[in\]\)](#) = 1.57 [0.062]

- Port Configuration = Single
- [Jack Configuration](#) = 1 x 1
- [Number of Positions](#) = 8
- Number of Contacts Loaded = 8

**Industry Standards:**

- [RoHS/ELV Compliance](#) = RoHS compliant, ELV compliant
- [Lead Free Solder Processes](#) = Wave solder capable to 240°C, Wave solder capable to 260°C, Wave solder capable to 265°C
- [RoHS/ELV Compliance History](#) = Always was RoHS compliant

**Packaging Features:**

- Packaging Method = Tray

**Product Availability:**

- Region = Asia, North America

**Other:**

- Brand = AMP

**Corporate Information**

[About TE](#)  
[Investors](#)  
[News Room](#)  
[Supplier Portal](#)  
[Careers](#)  
[Terms & Conditions](#)  
[Privacy Policy](#)

**Quick Links**

[Distributor Inventory](#)  
[Product Cross Reference](#)  
[Documents & Drawings](#)  
[Product Compliance Support Center](#)  
[Site Map](#)

**Customer Support**

[Email or Chat With Us](#)  
[Find a Phone Number](#)  
[Knowledge Base](#)  
[Manage Your Account](#)

**Keep Me Informed**

- MATERIAL: HOUSING- PBT POLYESTER, BLACK.  
TERMINAL- 0.35 [.0138] THICK PHOS BRONZE PLATED WITH 1.27μm [.000050] THICK HARD GOLD IN LOCALIZED GOLD PLATE AREA AND 2.03μm [.000080] THICK MATTE TIN IN SOLDER AREA OVER 1.27μm [.000050] THICK NICKEL UNDERPLATE.
- CAVITY CONFORMS TO FCC RULES AND REGULATIONS PART 68 AND REA BULLETIN 345-81, PE-76 SPECIFICATION FOR MODULAR TELEPHONE HARDWARE.
- ALL DIMENSIONS SHOWN ARE MAXIMUM UNLESS OTHERWISE SPECIFIED.

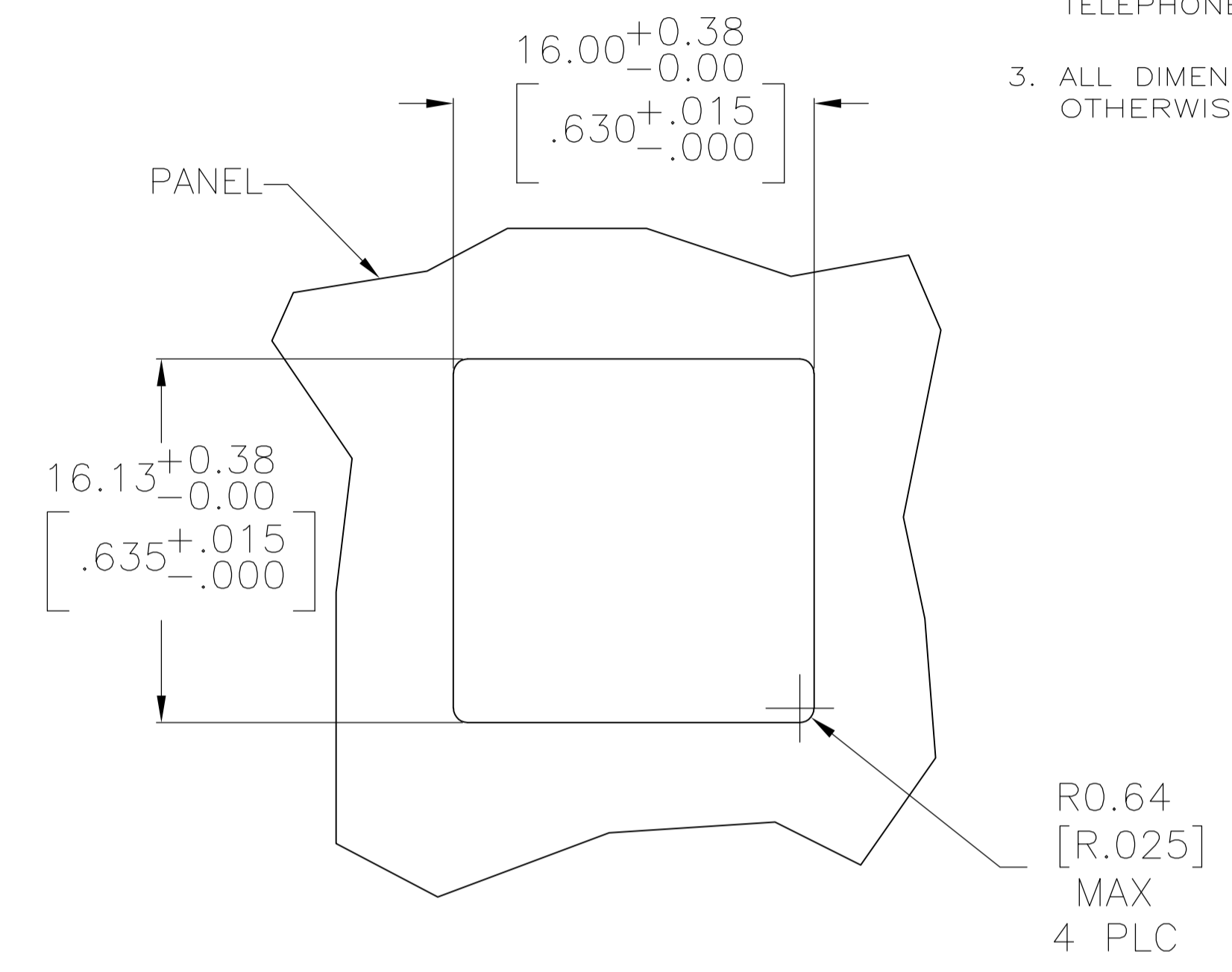
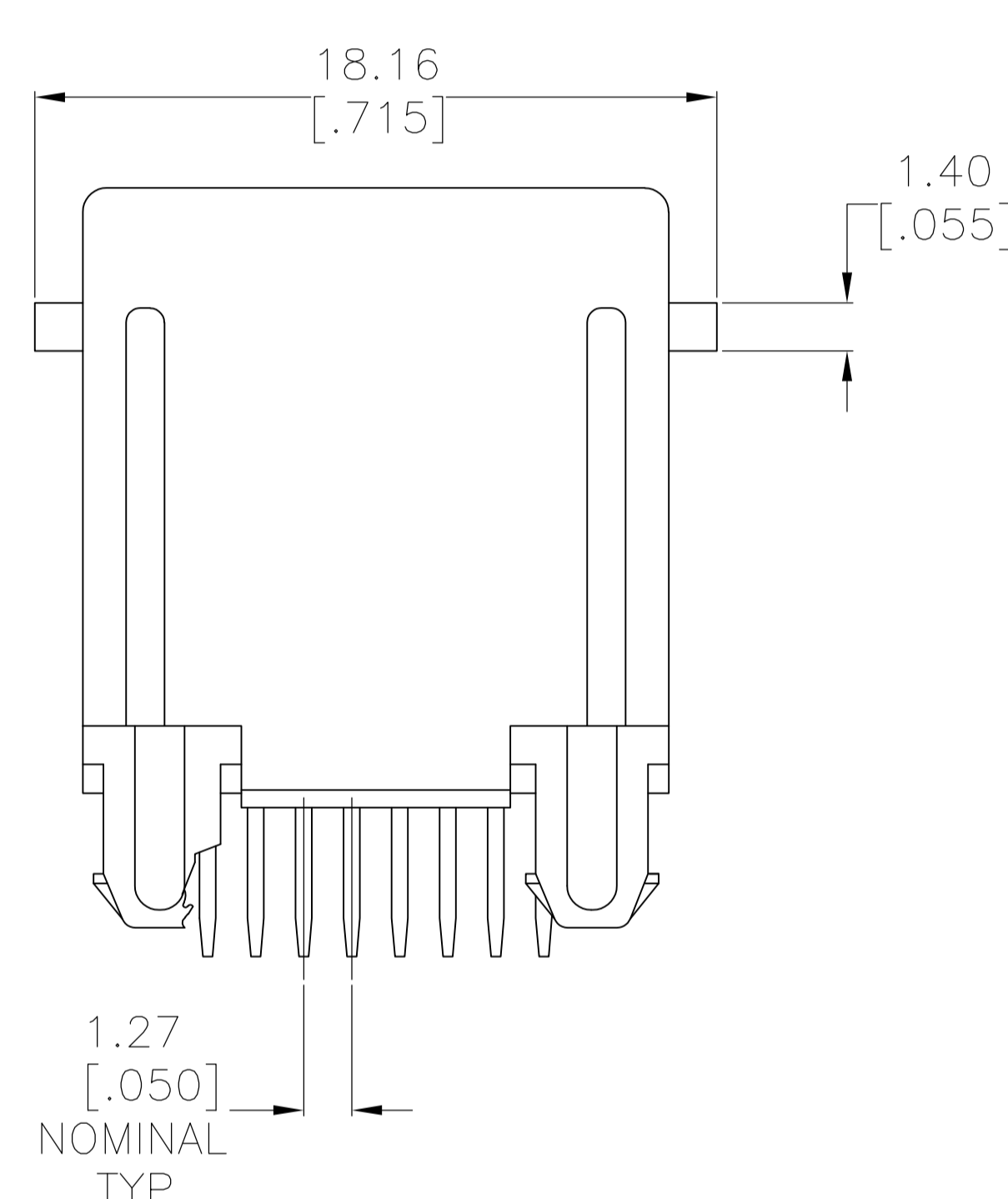
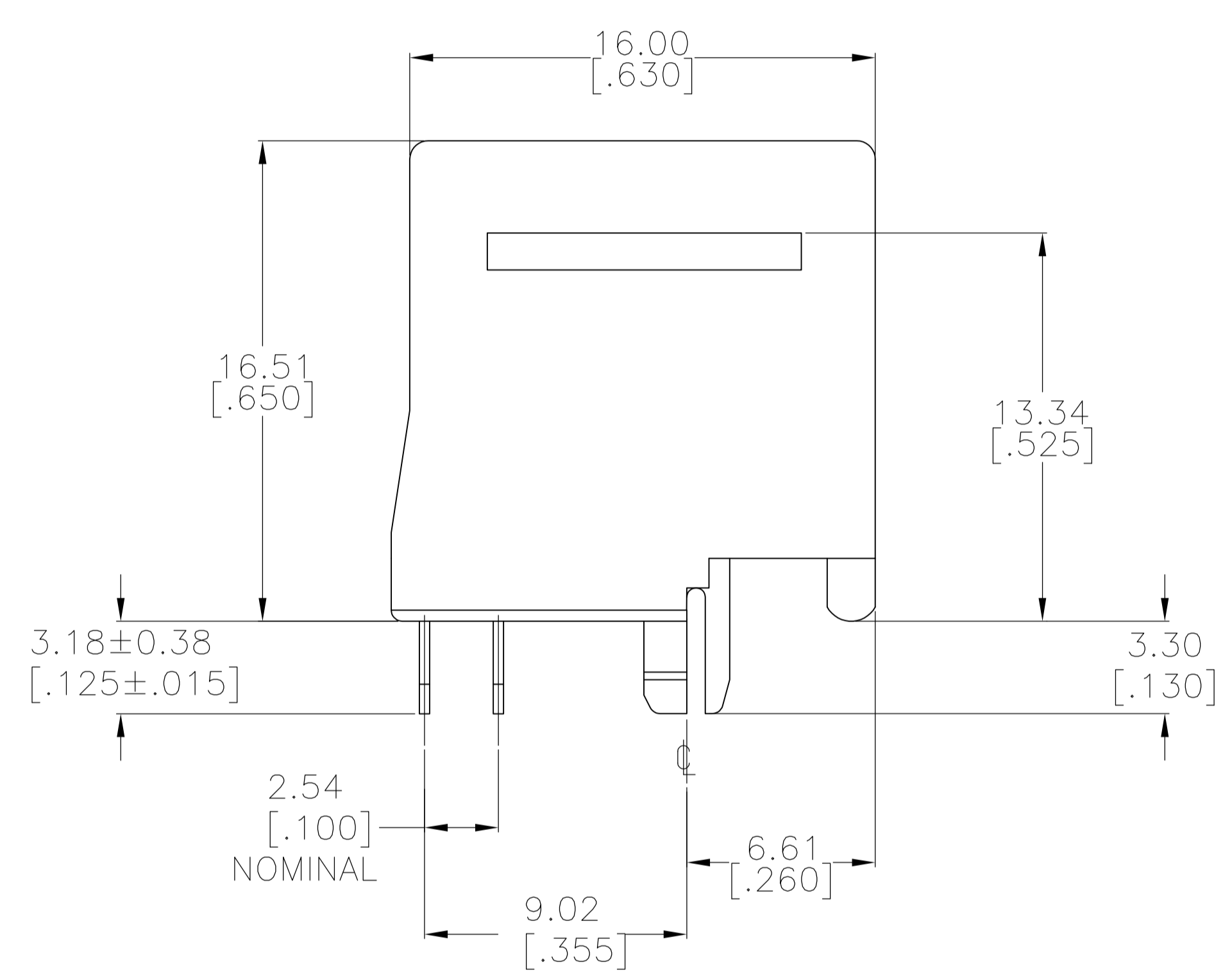
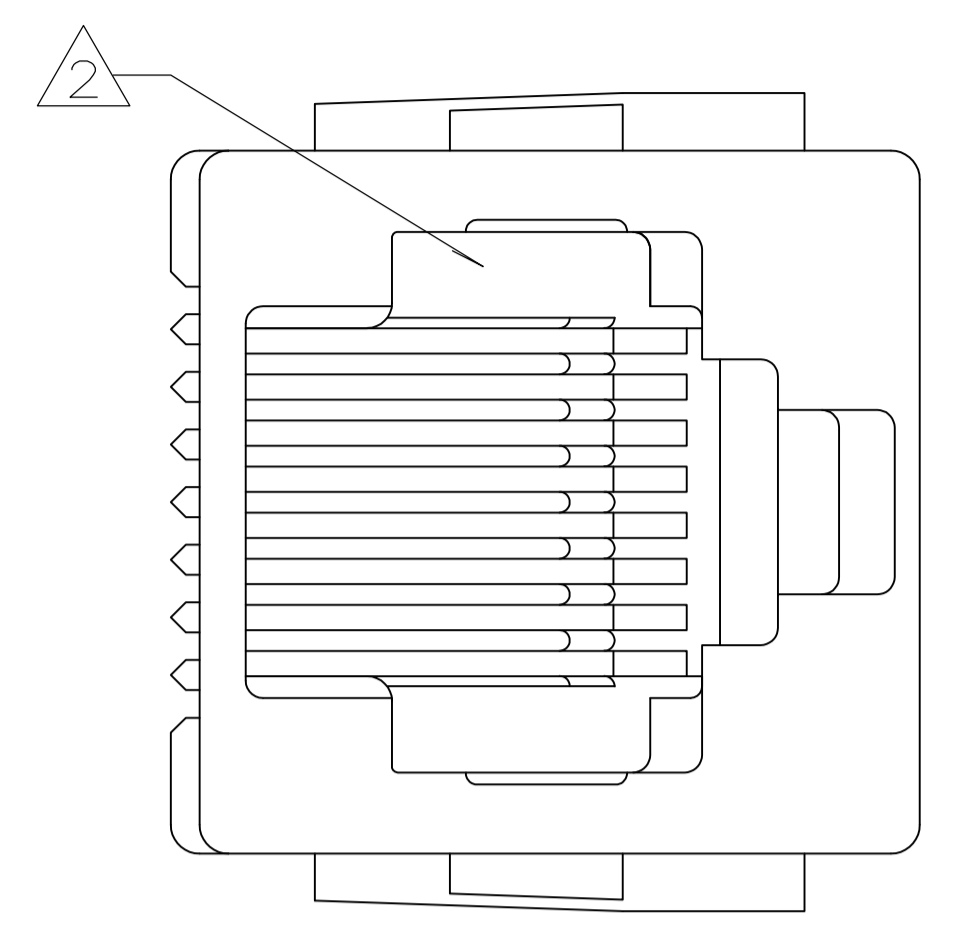

RECOMMENDED PANEL CUTOUT SCALE 4:1

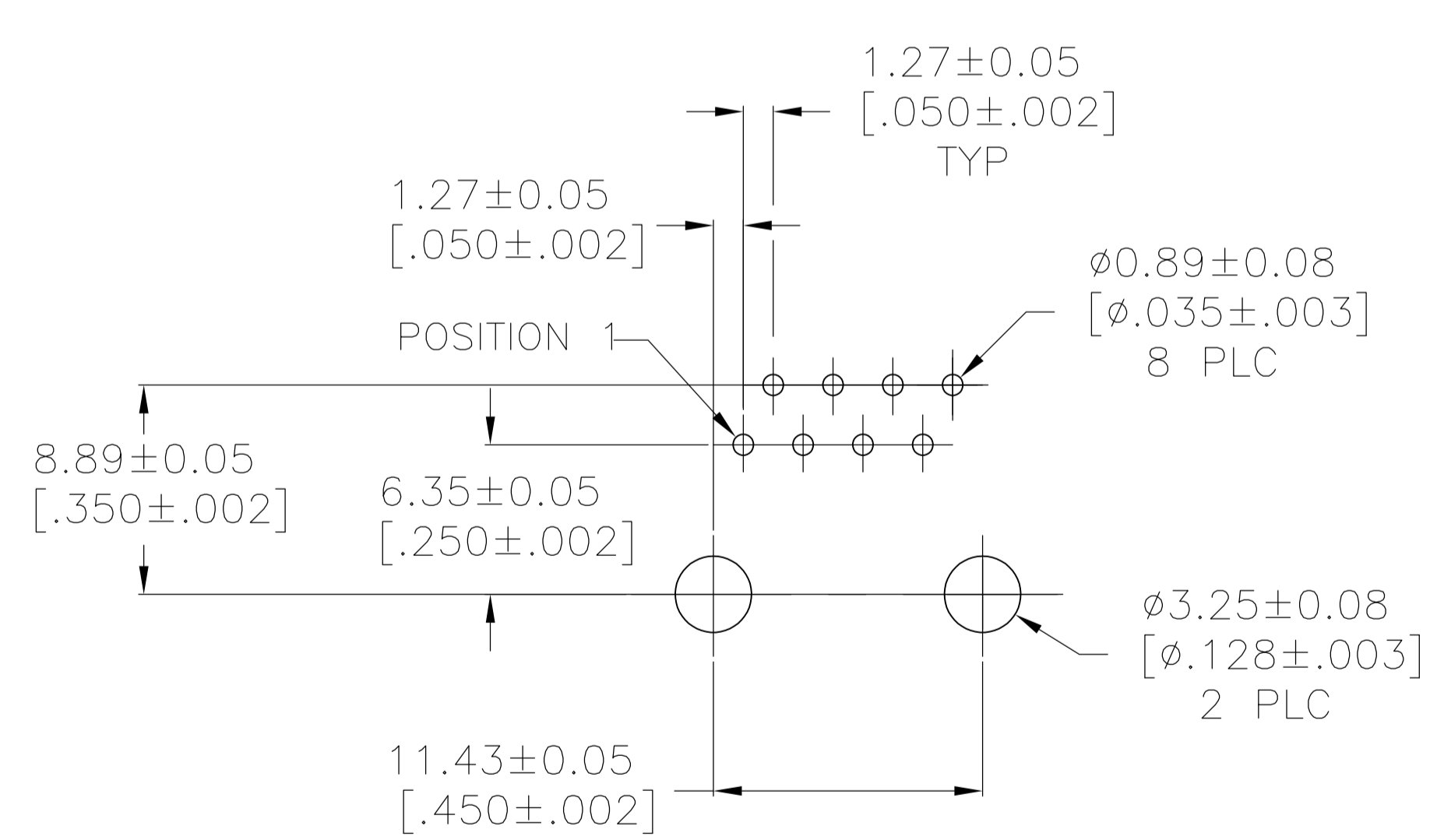

RECOMMENDED PRINTED CIRCUIT BOARD LAYOUT COMPONENT SIDE SCALE 4:1

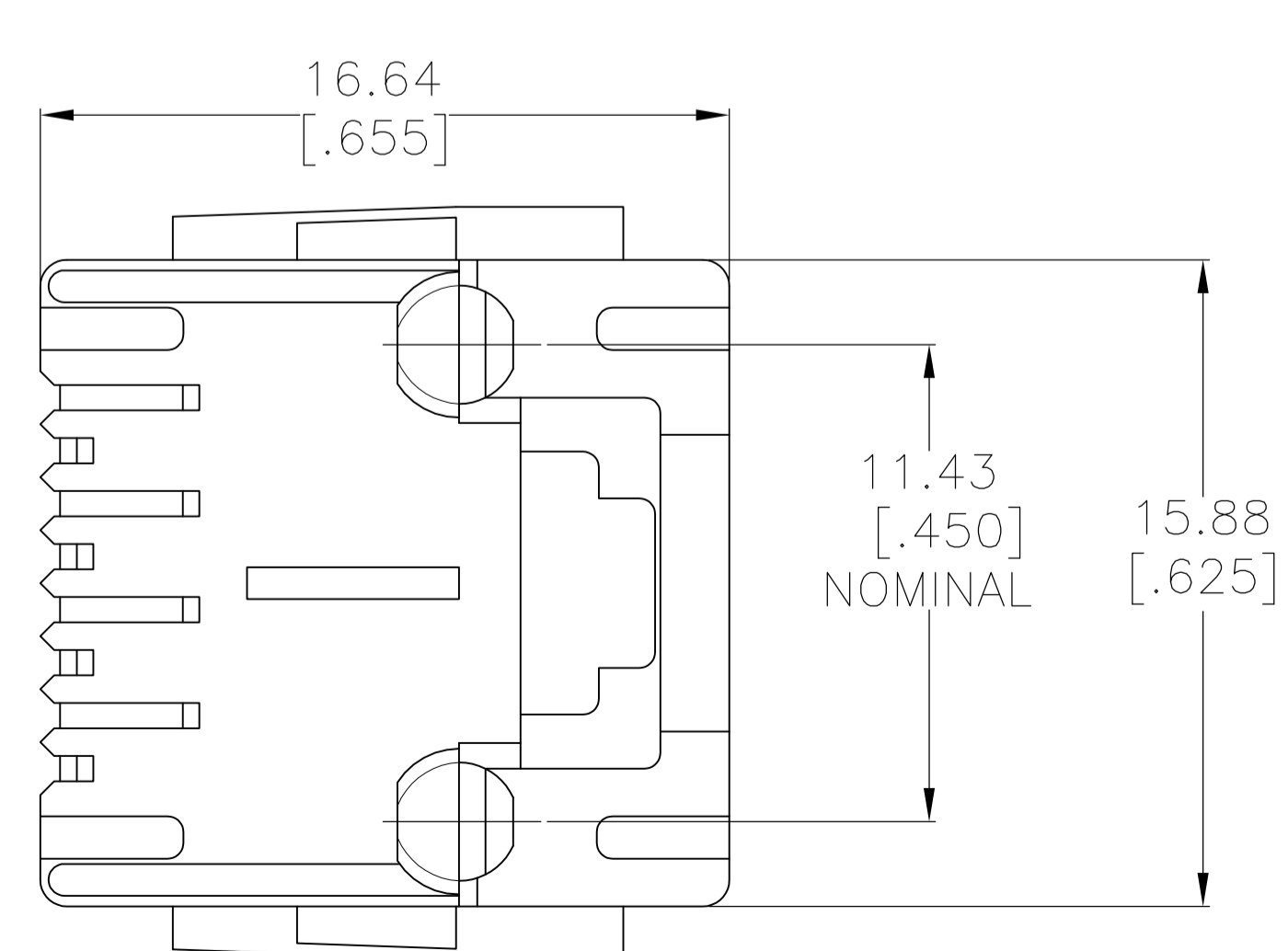

5520259-4  
PART NO

|  |  |   |                    |                 |                     |
|--|--|---|--------------------|-----------------|---------------------|
| THIS DRAWING IS A CONTROLLED DOCUMENT. DIMENSIONING AND TOLERANCING PER ASME Y14.5M-2009 |  | DWG: R.GRZYBOWSKI 05MAY05<br>CHK: P.RECCCE 10SEP2007<br>APPVD: S.FLICKINGER 10SEP2007 | NAME: S.FLICKINGER | DATE: 10SEP2007 | RESTRICTED TO: -    |
| DIMENSIONS: mm [INCHES]  | TOLERANCES UNLESS OTHERWISE SPECIFIED: | PRODUCT SPEC: 108-1163  |                    | SIZE: A1        | CAGE CODE: 114-2048 |
| 0 PLC ± -  | 1 PLC ± -                              | APPLICATION SPEC: 114-2048  |                    | SCALE: 6:1      | SHEET 1 OF 1        |
| 2 PLC ± -  | 3 PLC ± -                              | CUSTOMER DRAWING  |                    | REV: B2         |                     |
| 4 PLC ± -  | ANGLES ± -                             | DRAWING NO: 5520259   |                    |                 |                     |
| MATERIAL: SEE NOTE 1   | FINISH: SEE NOTE 1                     | WEIGHT: -   |                    |                 |                     |