

## 5530843-2 Product Details



**5530843-2**

TE Internal Number: 5530843-2



### Standard Edge II Card Edge & Power Connectors

 Always EU RoHS/ELV Compliant (Statement of Compliance)

#### Product Highlights:

- Connector
- Product Series = Standard Edge II
- Type of Connector = Standard
- 2.54 mm Centerline
- 15 Dual Positions

### Documentation & Additional Information

#### Product Drawings:

- [CONNECTOR ASSEMBLY STANDARD EDGE II, .100 CENTERLINE](#) (PDF, English)

#### Catalog Pages/Data Sheets:

- [POWER\\_CONNECTORS\\_CATALOG\\_SEC03\\_CARD\\_EDGE](#) (PDF, English)

#### Product Specifications:

- [Connector, Standard Edge](#) (PDF, English)

#### Application Specifications:

- [Standard Edge Card \(SEC\) II, SEC II Power, and High ...](#) (PDF, English)

#### Instruction Sheets:

- None Available

#### CAD Files: (CAD Format & Compression Information)

- [2D Drawing](#) (DXF, Version F)
- [3D Model](#) (IGES, Version F)
- [3D Model](#) (STEP, Version F)

#### Related Products:

- [Tooling](#)

### Product Features (Please use the Product Drawing for all design activity)

#### Product Type Features:

- Product Type = Connector
- Product Series = Standard Edge II
- Type of Connector = Standard
- Post Type = Solder Post
- PCB Mounting Orientation = Vertical
- PCB Mount Retention = Without

#### Mechanical Attachment:

- Mounting Ears = Without

#### Electrical Characteristics:

- High Current = No

#### Termination Features:

- Termination Post Length (mm [in]) = 3.18 [0.125]
- Solder Tail Contact Plating = Tin

#### Body Features:

- Retention Latch = Without

#### Contact Features:

- Contact Plating, Mating Area, Material = Gold (30)
- Contact Base Material = Phosphor Bronze
- Underplate Material = Nickel

#### Housing Features:

- Centerline (mm [in]) = 2.54 [0.100]
- Housing Material = Polyester GF
- Housing Color = Black
- UL Flammability Rating = UL 94V-0

#### Configuration Features:

- Number of Dual Positions = 15
- Positions Unloaded = None

#### Industry Standards:

- RoHS/ELV Compliance = RoHS compliant, ELV compliant
- Lead Free Solder Processes = Wave solder capable to 240°C, Wave solder capable to 260°C, Wave solder capable to 265°C
- RoHS/ELV Compliance History = Always was RoHS compliant

#### Identification Marking:

- Keyed Position = 0

#### Other:

- Brand = AMP

| LOC | DIST | REVISIONS                   |           |     |      |
|-----|------|-----------------------------|-----------|-----|------|
| P   | LTN  | DESCRIPTION                 | DATE      | DWN | APVD |
| E8  |      | ADD NEW PART -87            | 20FEB2012 | AY  | SZ   |
| E9  |      | ADD NEW PART -88            | 25FEB2013 | AY  | SZ   |
| F   |      | CHANGE PART -88 TAIL LENGTH | 25APR2013 | AY  | SZ   |
| F1  |      | UPDATE THE OMITTED PINS     | 20FEB2013 | AY  | SZ   |

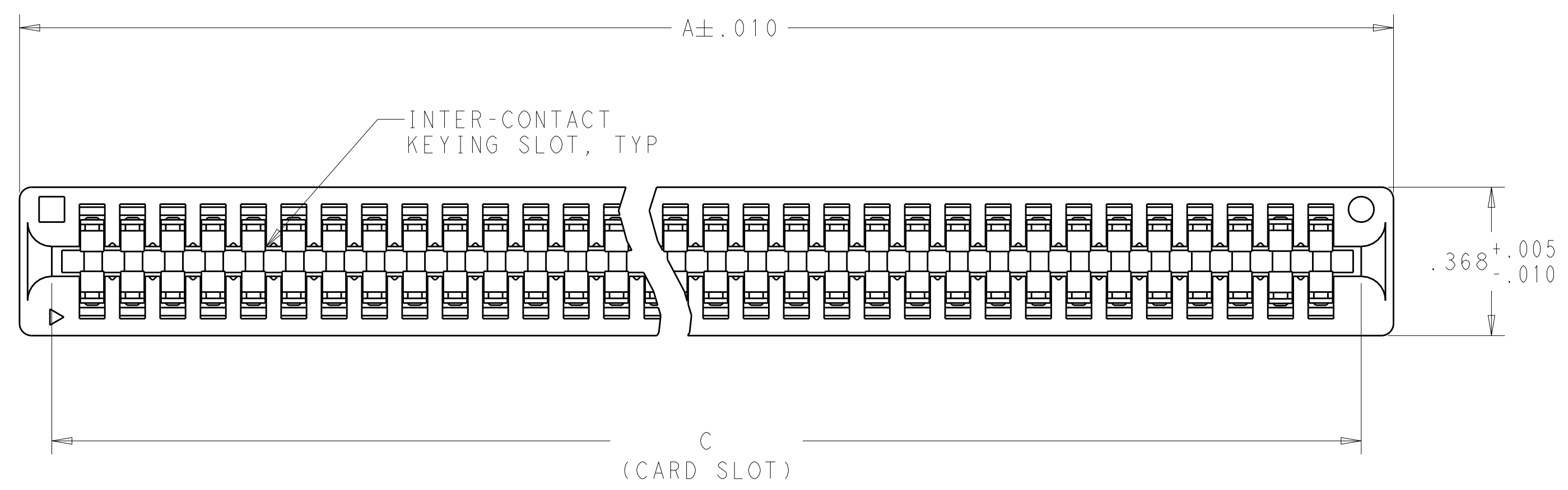

- 1 MATERIAL:  
HOUSING - GLASS FILLED POLYESTER, COLOR BLACK  
CONTACT - PHOSPHOR BRONZE
- 2 FINISH:  
(SEE TABLE FOR GOLD PLATING) IN CONTACT AREA.  
.000100 MIN MATTE TIN ON SOLDER POSTS. ALL OVER  
.000050 MIN THK. NICKEL
- 3 AMP LOGO, TE PART NUMBER, DATE CODE AND CSA LOGO INK STAMPED WHITE (HOT STAMPED OR LAZER PRINTED) IN THE APPROXIMATE AREA SHOWN, EITHER SIDE PERMISSABLE WHEN HOUSING SIZE PERMITS
- 4. RECOMMENDED PCB FINISHED HOLE  $\varnothing .040 \pm .003$
- 5 .000015 MIN
- 6 .000030 MIN
- 7 OBSOLETE PARTS: OBSOLETE CIS STREAMLINING PER D.RENAUD/D.SINISI

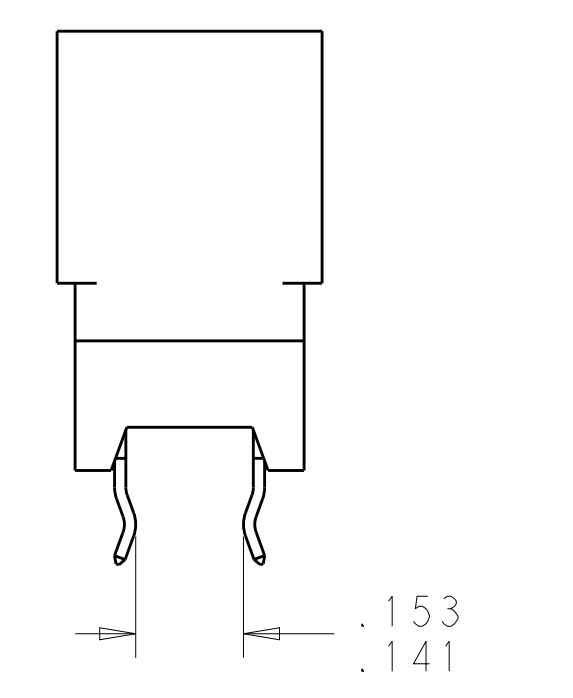
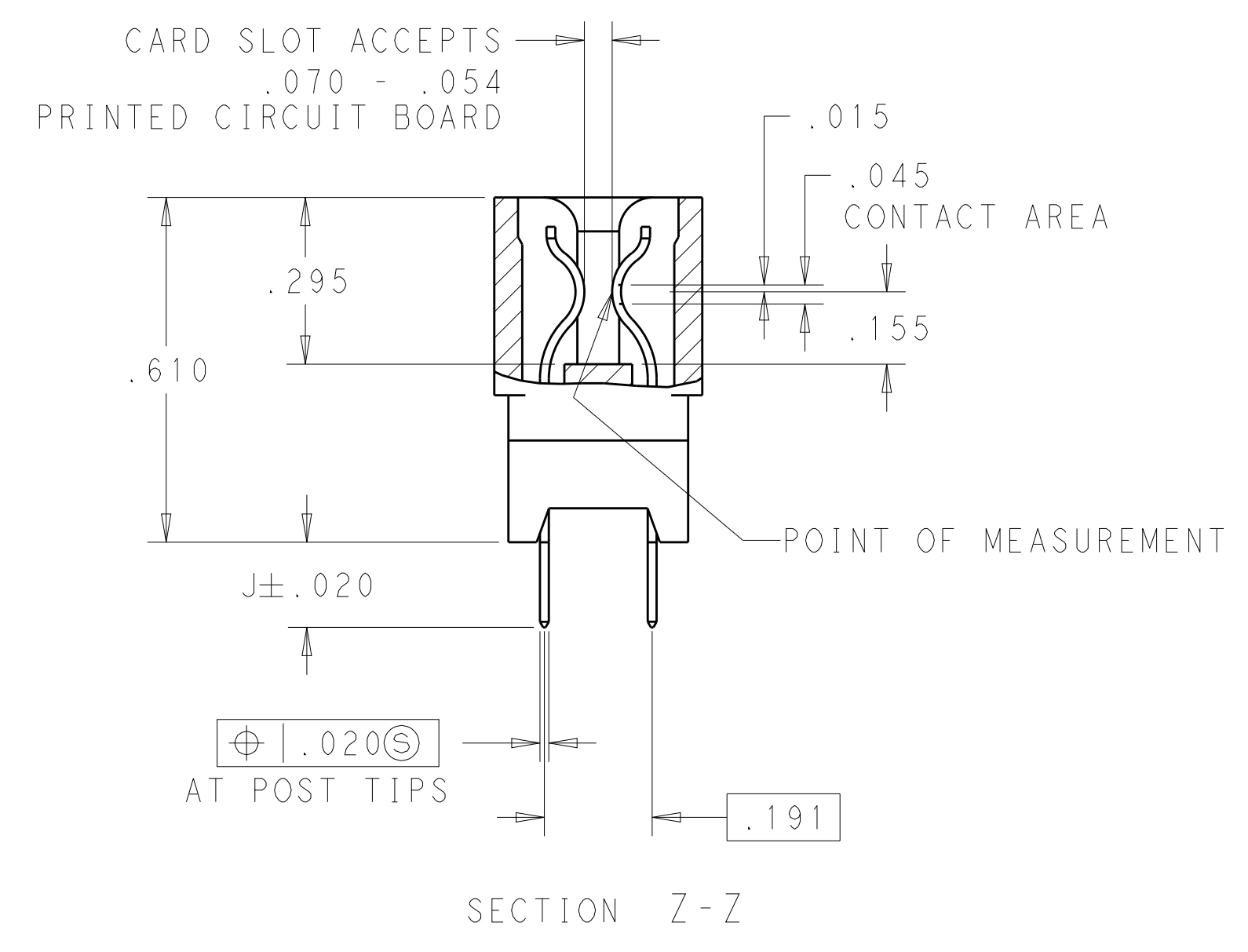
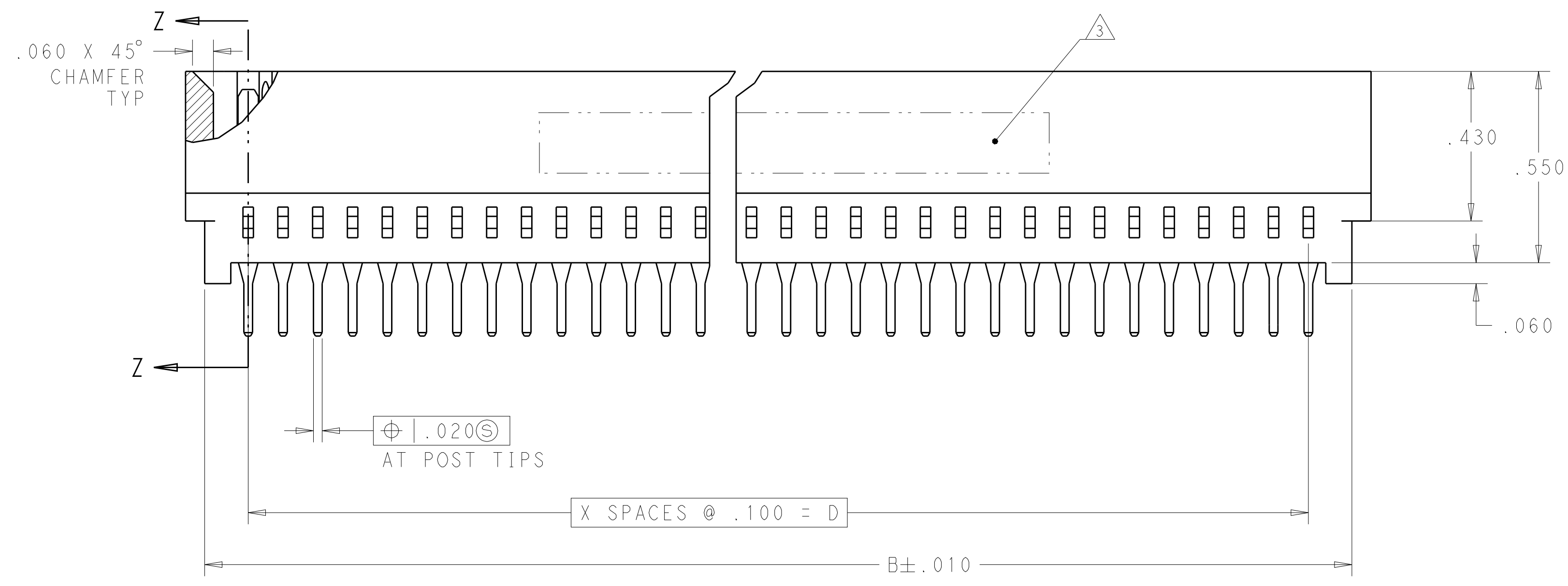

BOARD RETENTION FEATURE  
8-530843-3 ONLY

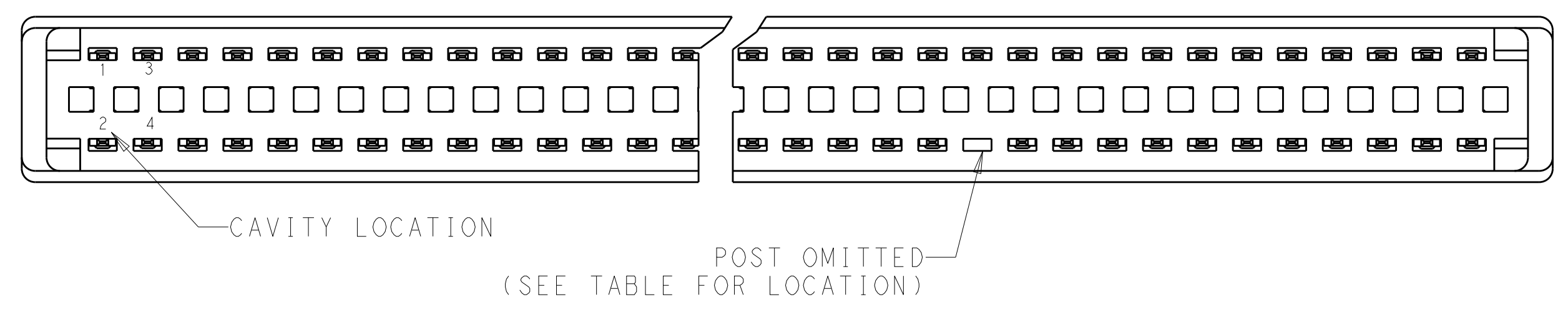

|  |        |                          |                                   |  |
|--|--------|--------------------------|-----------------------------------|--|
| THIS DRAWING IS A CONTROLLED DOCUMENT.   |        | DWN<br>AWF/GRZYBOWSKI    | 30OCT2009                         | <br>TE Connectivity  |
| DIMENSIONS:<br>INCHES  |        | CHK<br>E.HOWARD          | 30OCT2009                         |  |
| TOLERANCES UNLESS OTHERWISE SPECIFIED:   |        | APVD<br>M.PERCHEK        | 30OCT2009                         | NAME<br>CONNECTOR ASSEMBLY<br>STANDARD EDGE II,<br>.100 CENTERLINE |
| 0 PLC $\pm$<br>1 PLC $\pm .005$<br>2 PLC $\pm$<br>3 PLC $\pm$<br>4 PLC $\pm$<br>ANGLES $\pm$ |        | PRODUCT SPEC<br>108-9039 | APPLICATION SPEC<br>114-13018     |  |
| MATERIAL   | FINISH | WEIGHT                   | SIZE<br>A100779                   | RESTRICTED TO  |
|  |        |                          | CAGE CODE DRAWING NO<br>C=5530843 |  |
| CUSTOMER DRAWING   |        |                          | SCALE 4:1                         | SHEET 1 OF 4   |
|  |        |                          | REV F1                            |  |

| LOC | DIST | REVISIONS   |      |     |      |
|-----|------|-------------|------|-----|------|
| P   | LTN  | DESCRIPTION | DATE | DWN | APVD |
| -   | -    | SEE SHEET 1 | -    | -   | -    |
|     |      |             |      |     |      |
|     |      |             |      |     |      |

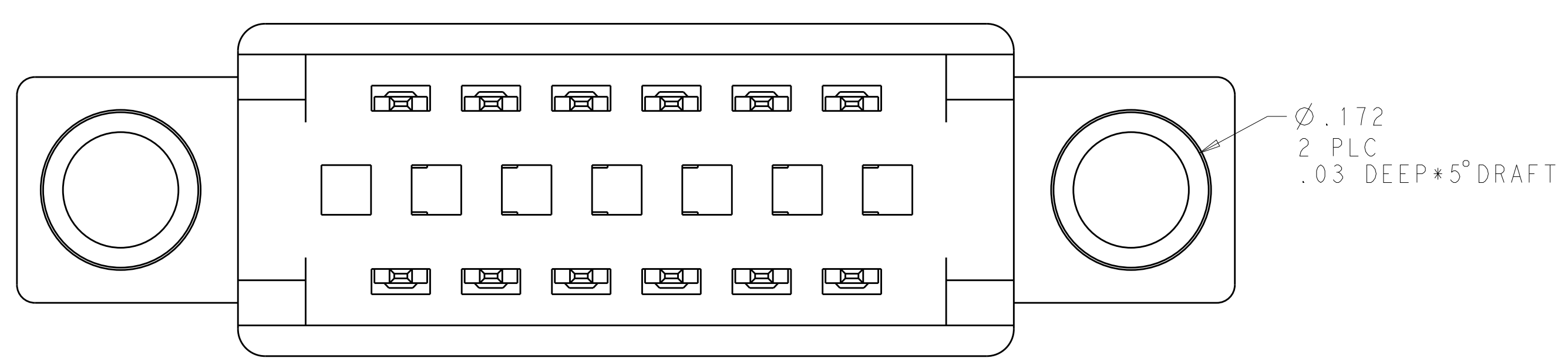
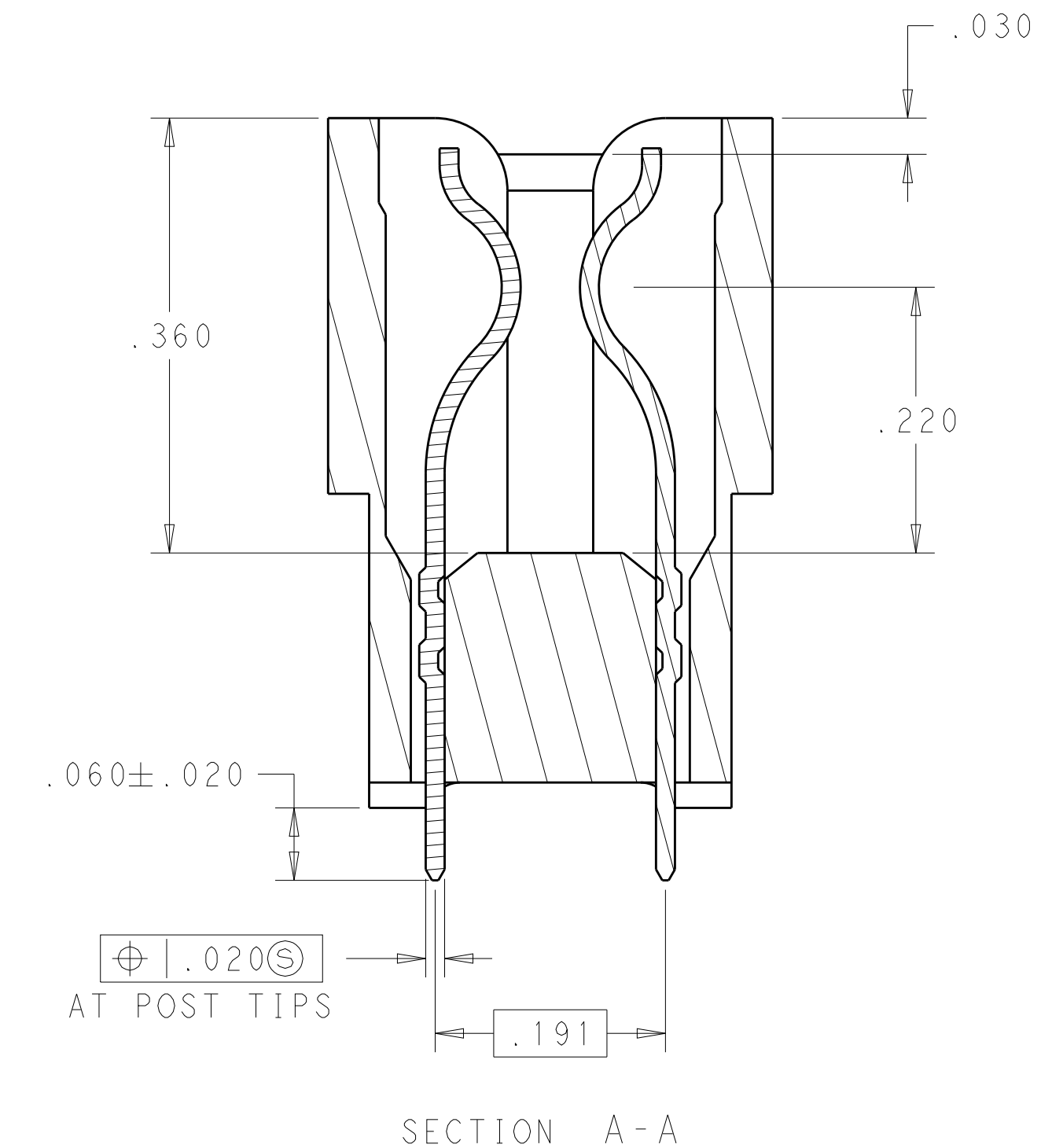
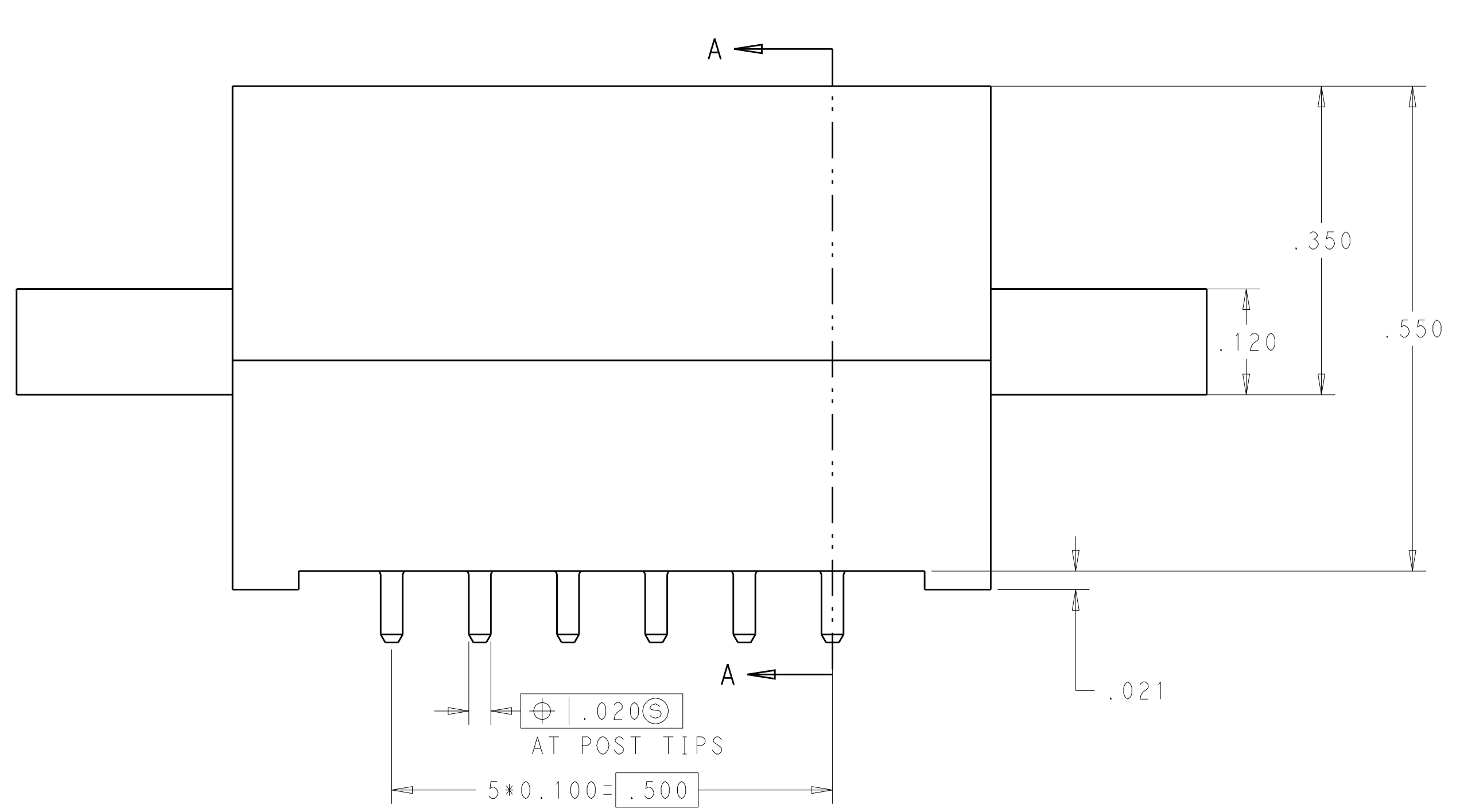
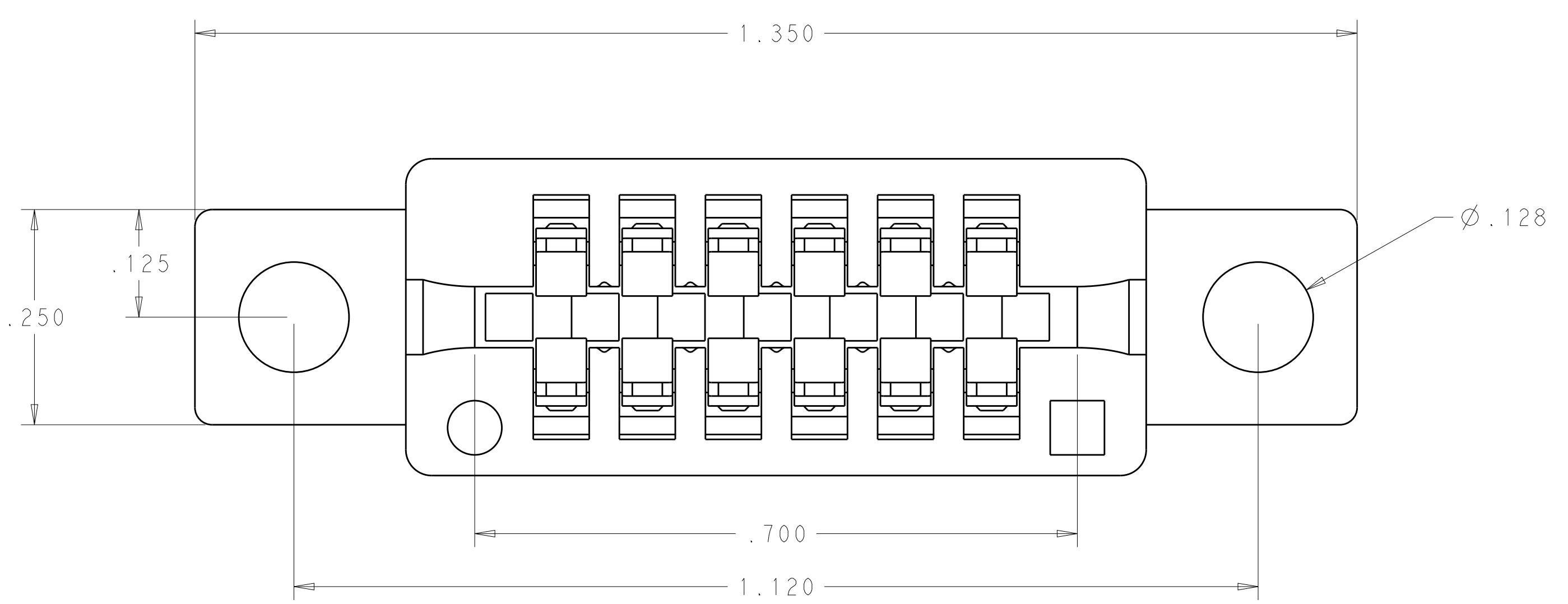

PART 8-5530843-6

|  |  |   |   |
|--|--|---|---|
| THIS DRAWING IS A CONTROLLED DOCUMENT.   |  | DWN: AWF/GRZYBOWSKI 30OCT2009   | TE Connectivity   |
| DIMENSIONS: INCHES   |  | CHK: E.HOWARD   |   |
| TOLERANCES UNLESS OTHERWISE SPECIFIED:<br>0 PLC ±.<br>1 PLC ±.005<br>2 PLC ±.<br>3 PLC ±.<br>4 PLC ±.<br>ANGLES ±2 |  | APVD: M.PERCHEK 30OCT2009<br>PRODUCT SPEC: 108-9039<br>APPLICATION SPEC: 114-13018<br>WEIGHT: | NAME: CONNECTOR ASSEMBLY STANDARD EDGE II, .100 CENTERLINE<br>SIZE: A1<br>CAGE CODE: 5530843<br>DRAWING NO: 8-5530843-6 |
| MATERIAL:  |  | FINISH:   | RESTRICTED TO:  |
| CUSTOMER DRAWING   |  | SCALE: 4:1  | SHEET 2 OF 4 REV F1   |

| LOC | DIST | REVISIONS |     |             |      |     |      |
|-----|------|-----------|-----|-------------|------|-----|------|
| GP  | 00   | P         | LTN | DESCRIPTION | DATE | DWN | APVD |
| -   | -    | -         | -   | SEE SHEET 1 | -    | -   | -    |
|     |      |           |     |             |      |     |      |
|     |      |           |     |             |      |     |      |

|             |             |
|-------------|-------------|
| OBSOLETE    | 8-5530843-2 |
| OBSOLETE    | 8-5530843-1 |
| OBSOLETE    | 4-5530843-1 |
| OBSOLETE    | 1-5530843-9 |
| OBSOLETE    | 1-5530843-2 |
| PART NUMBER |             |

| NO. OF DUAL POSITIONS | PART NUMBER | X  | A     | B     | C     | D     | J    | Z     | FINISH | BOARD RETENTION FEATURE LOCATION (SEE DETAIL Y)  | OMITTED PIN |
|-----------------------|-------------|----|-------|-------|-------|-------|------|-------|--------|--|-------------|
| 14                    | 8-5530843-8 | 15 | 1.650 | 1.760 | 1.400 | 1.586 | .187 | .125  | △6     | 17, 18, 21, 22, 23, 24   |             |
| 11                    | 8-5530843-7 | 12 | 1.350 | 1.460 | 1.100 | 1.286 | .125 | .125  | △6     | 17, 18, 19, 20   |             |
| 5                     | 8-5530843-6 | 6  | -     | -     | .500  | .700  | -    | .500  | △6     |  |             |
| 11                    | 8-5530843-5 | 12 | 1.350 | 1.460 | 1.100 | 1.286 | .187 | .125  | △6     |  |             |
| 30                    | 8-5530843-4 | 31 | 3.250 | 3.360 | 3.200 | 3.186 | .125 | 3.000 | △6     | 19, 20, 21, 22, 23, 24, 27, 28, 31, 32, 35, 36, 39, 40, 43, 44, 45, 46, 47, 48, 51, 52, 55, 56, 59, 60 |             |
| 11                    | 8-5530843-3 | 12 | 1.350 | 1.460 | 1.100 | 1.286 | .125 | .125  | △6     | 3, 4, 5, 6, 19, 20, 21, 22   |             |
| 2                     | 7-5530843-7 | 3  | .450  | .560  | .400  | .386  | .125 | .200  | △6     | -  |             |
| 5                     | 7-5530843-6 | 6  | .750  | .860  | .700  | .686  | .187 | .500  | △6     | -  |             |
| 5                     | 7-5530843-5 | 6  | .750  | .860  | .700  | .686  | .125 | .500  | △6     | -  |             |
| 30                    | 7-5530843-0 | 31 | 3.250 | 3.360 | 3.200 | 3.186 | .125 | 3.000 | △5     | -  |             |
| 30                    | 6-5530843-5 | 31 | 3.250 | 3.360 | 3.200 | 3.186 | .125 | 3.000 | △6     | -  |             |
| 59                    | 5-5530843-5 | 60 | 6.150 | 6.260 | 6.100 | 6.086 | .125 | 5.900 | △6     | -  | △ OBSOLETE  |
| 19                    | 5-5530843-4 | 20 | 2.150 | 2.260 | 2.100 | 2.086 | .125 | 1.900 | △6     | -  |             |
| 16                    | 5-5530843-3 | 17 | 1.850 | 1.960 | 1.800 | 1.786 | .125 | 1.600 | △6     | -  |             |
| 9                     | 5-5530843-0 | 10 | 1.150 | 1.260 | 1.100 | 1.086 | .125 | .900  | △6     | -  |             |
| 17                    | 2-5530843-7 | 18 | 1.950 | 2.060 | 1.900 | 1.886 | .125 | 1.700 | △5     | -  |             |
| 34                    | 2-5530843-3 | 35 | 3.650 | 3.760 | 3.600 | 3.586 | .125 | 3.400 | △6     | -  |             |
| 49                    | 2-5530843-2 | 50 | 5.150 | 5.260 | 5.100 | 5.086 | .187 | 4.900 | △6     | -  |             |
| 39                    | 2-5530843-0 | 40 | 4.150 | 4.260 | 4.100 | 4.086 | .187 | 3.900 | △6     | -  |             |
| 29                    | 1-5530843-8 | 30 | 3.150 | 3.260 | 3.100 | 3.086 | .187 | 2.900 | △6     | -  |             |
| 24                    | 1-5530843-6 | 25 | 2.650 | 2.760 | 2.600 | 2.586 | .187 | 2.400 | △6     | -  |             |
| 42                    | 1-5530843-0 | 43 | 4.450 | 4.560 | 4.400 | 4.386 | .125 | 4.200 | △6     | -  |             |
| 35                    | 5530843-8   | 36 | 3.750 | 3.860 | 3.700 | 3.686 | .125 | 3.500 | △6     | -  |             |
| 29                    | 5530843-7   | 30 | 3.150 | 3.260 | 3.100 | 3.086 | .125 | 2.900 | △6     | -  |             |
| 27                    | 5530843-6   | 28 | 2.950 | 3.060 | 2.900 | 2.886 | .125 | 2.700 | △6     | -  |             |
| 24                    | 5530843-5   | 25 | 2.650 | 2.760 | 2.600 | 2.586 | .125 | 2.400 | △6     | -  |             |
| 21                    | 5530843-4   | 22 | 2.350 | 2.460 | 2.300 | 2.286 | .125 | 2.100 | △6     | -  |             |
| 17                    | 5530843-3   | 18 | 1.950 | 2.060 | 1.900 | 1.886 | .125 | 1.700 | △6     | -  |             |
| 14                    | 5530843-2   | 15 | 1.650 | 1.760 | 1.600 | 1.586 | .125 | 1.400 | △6     | -  |             |
| 11                    | 5530843-1   | 12 | 1.350 | 1.460 | 1.300 | 1.286 | .125 | 1.100 | △6     | -  |             |

THIS DRAWING IS A CONTROLLED DOCUMENT. DWN: JAW/GRZYBOWSKI 30OCT2009  
 CHK: E. HOWARD  
 APVD: M. PERCZYNSKI 30OCT2009

**STE** TE Connectivity

NAME: CONNECTOR ASSEMBLY STANDARD EDGE II, .100 CENTERLINE

PRODUCT SPEC: 108-9039  
 APPLICATION SPEC: 114-13018

SIZE: A1 CAGE CODE: 5530843 DRAWING NO: 100779

MATERIAL: - FINISH: - WEIGHT: -

CUSTOMER DRAWING SCALE: 4:1 SHEET 3 OF 4 REV: F1

| LOC | DIST | REVISIONS |     |             |      |     |      |
|-----|------|-----------|-----|-------------|------|-----|------|
| GP  | 00   | P         | LTN | DESCRIPTION | DATE | DWN | APVD |
|     |      | -         |     | SEE SHEET 1 |      |     |      |

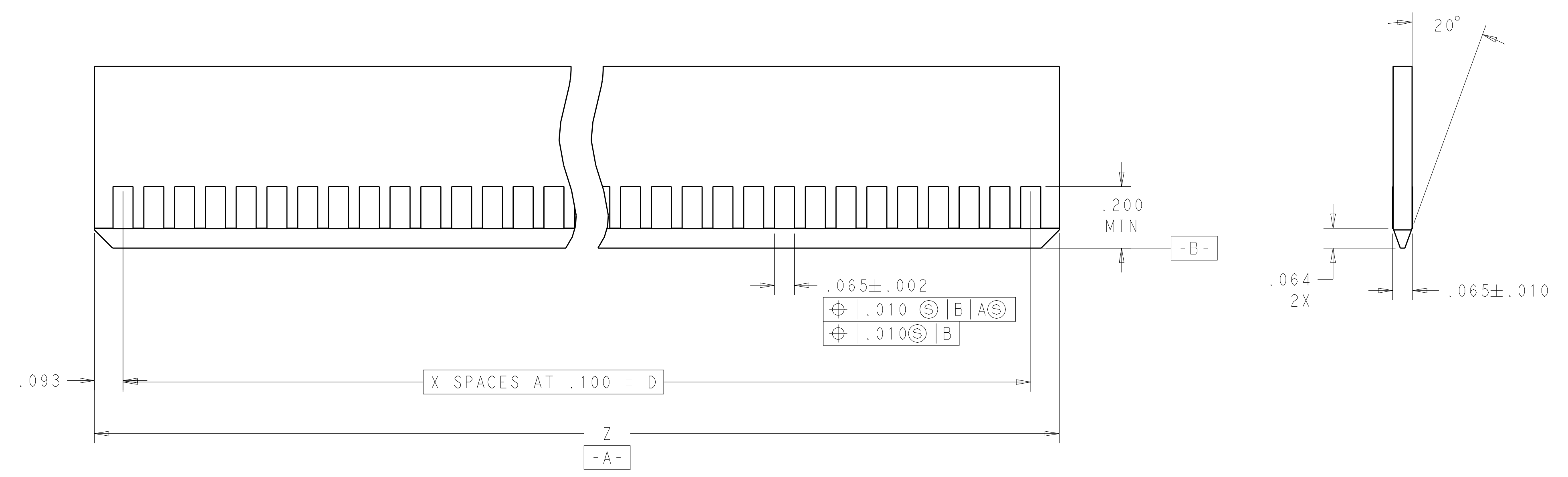

RECOMMENDED MAIN BOARD EDGE CONFIGURATION

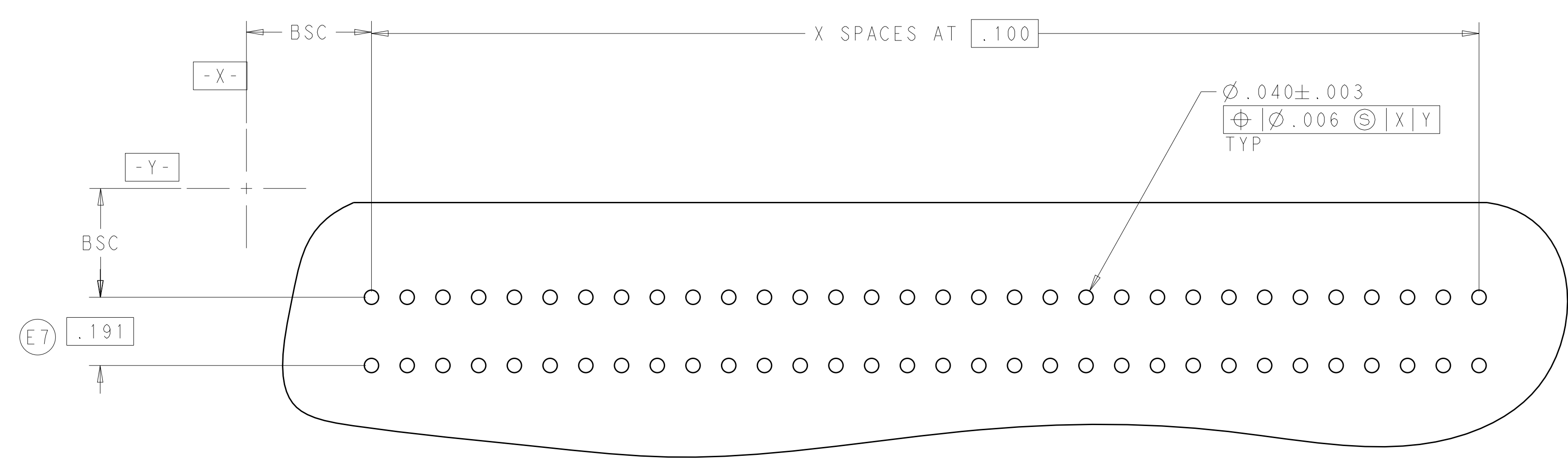

RECOMMENDED PC BOARD HOLE LAYOUT

|  |  |  |                  |   |
|--|--|--|------------------|---|
| THIS DRAWING IS A CONTROLLED DOCUMENT.   |  | DWN: AWF/GRZYBOWSKI  | 30OCT2009        | <br>TE Connectivity   |
| DIMENSIONS: INCHES   |  | CHK: E. HOWARD   | APVD: M. PERCHER |   |
| TOLERANCES UNLESS OTHERWISE SPECIFIED:<br>0 PLC ±<br>1 PLC ±.005<br>2 PLC ±<br>3 PLC ±<br>4 PLC ±<br>ANGLES ±° |  | PRODUCT SPEC: 108-9039<br>APPLICATION SPEC: 114-13018<br>WEIGHT: |                  | NAME: CONNECTOR ASSEMBLY STANDARD EDGE II, .100 CENTERLINE<br>SIZE: A100779<br>CAGE CODE: C=5530843 |
| MATERIAL: FINISH:  |  | CUSTOMER DRAWING   |                  | RESTRICTED TO:<br>SCALE: 4:1 SHEET 4 OF 4 REV: F1   |