

Distributed by:

JAMECO[®]
ELECTRONICS

www.Jameco.com ♦ 1-800-831-4242

The content and copyrights of the attached
material are the property of its owner.

Jameco Part Number 754662

THIS DRAWING IS UNPUBLISHED. RELEASED FOR PUBLICATION .19
 (C) COPYRIGHT 19 BY AMP INCORPORATED. ALL RIGHTS RESERVED.

LOC	DIST	REVISIONS			
P	LTR	DESCRIPTION	DATE	DWN	APVD
AA	20	L	REVISED; EC 0UF0-0130-01	28SEP01	DLD EWB

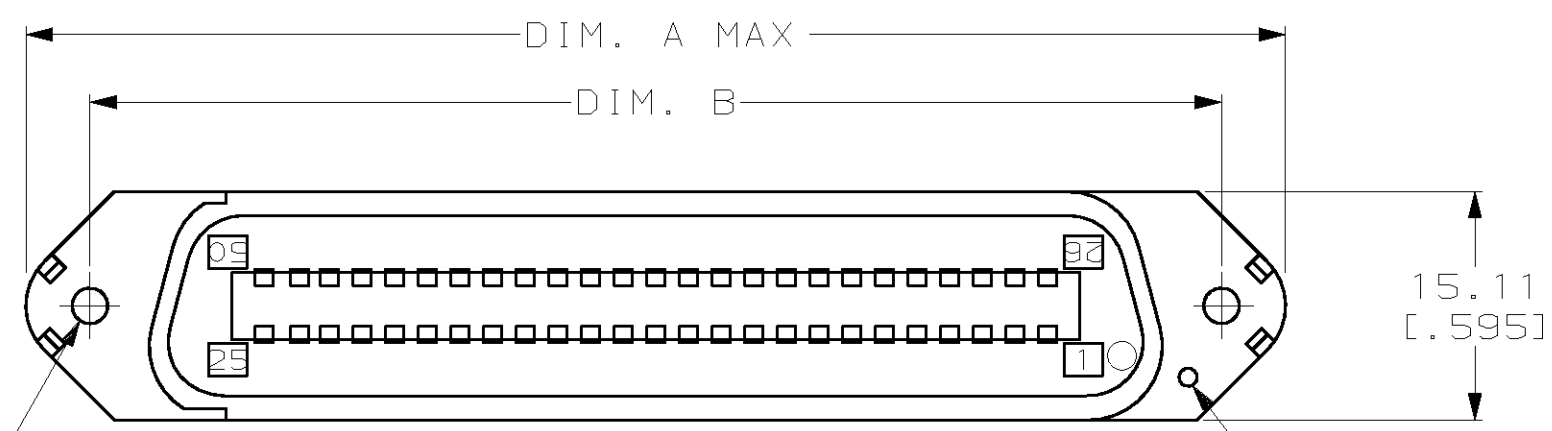

SEE TABLE FOR HOLE SIZE 2 HOLES

VIEW SHOWN WITH RETAINER REMOVED

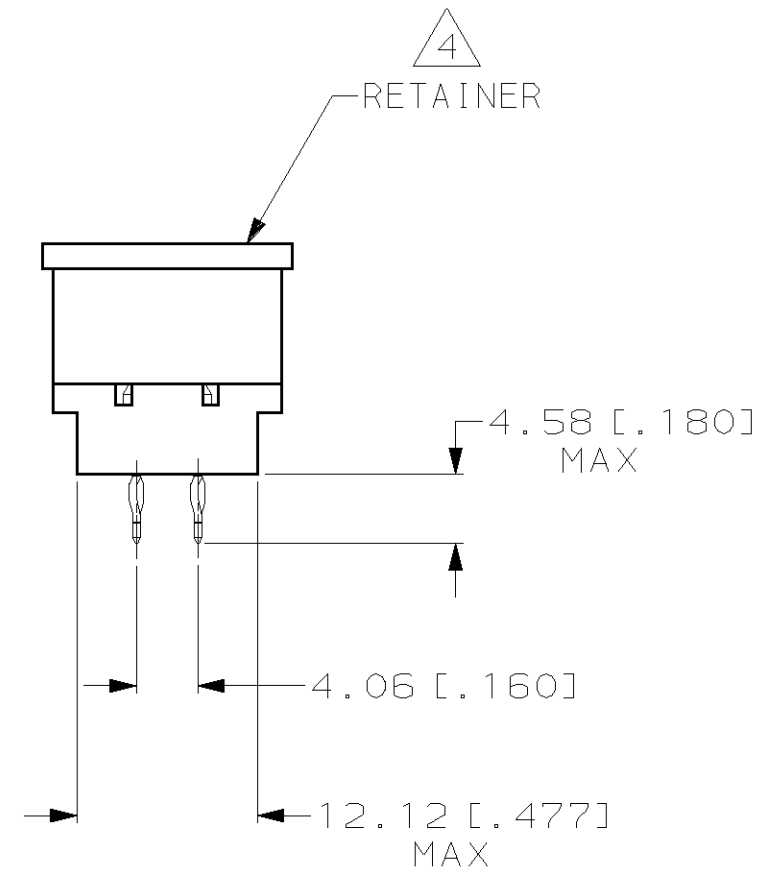
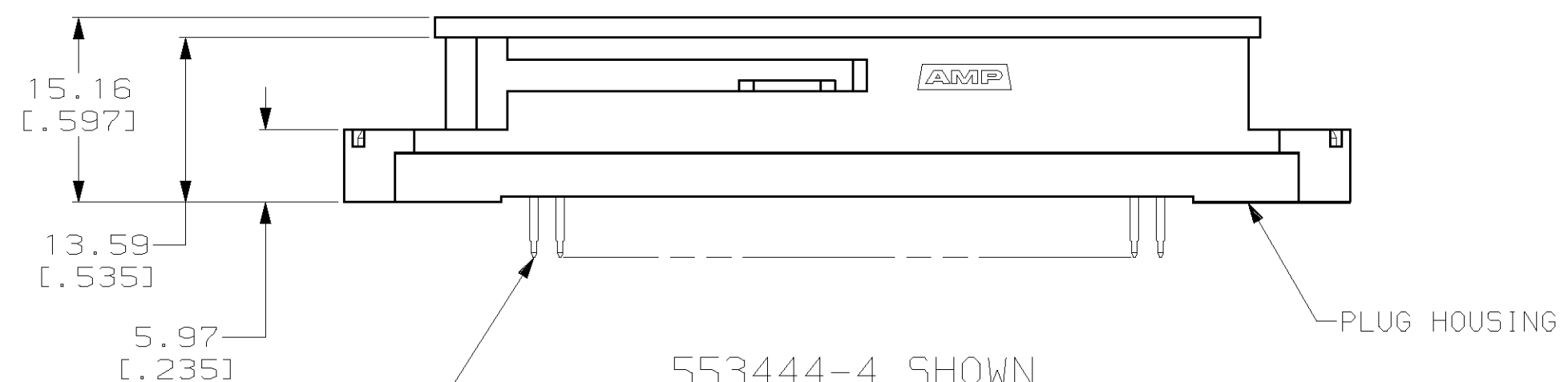

- 1 MATERIAL: HOUSING - POLYESTER MOLDING COMPOUND BLACK.
 TERMINAL - COPPER ALLOY PLATED WITH 0.76µm [.000030] MINIMUM THICK GOLD ON MATING SURFACE AND 0.13µm [.000005] MINIMUM THICK GOLD ON ACTION PIN AREA OVER 1.27µm [.000050] MINIMUM THICK NICKEL UNDERPLATE OVER ENTIRE TERMINAL.
 RETAINER - POLYETHYLENE, NATURAL.
- 2. THE CONTACT SURFACES OF THE TERMINALS ARE COATED WITH LUBRICANT.
- 3 ALL DIMENSIONS SHOWN ARE FOR REFERENCE ONLY UNLESS OTHERWISE SPECIFIED.
- 4 RETAINER MUST REMAIN INSTALLED UNTIL AFTER CONNECTOR HAS BEEN INSERTED INTO PCB HOLES.
- 5 OPTIONAL MOUNTING HOLE FOR SELF-TAPPING SCREW.
- 6. CENTER-TO-CENTER SPACING OF TERMINALS IS 2.16 [.085] NOMINAL.
- 7 ALL PLATED-THRU HOLES SHALL BE PER AMP SPEC 115-6072.
- 8 THRU HOLE ON HOUSING FLANGE INDICATES POSITION 1 LOCATION.

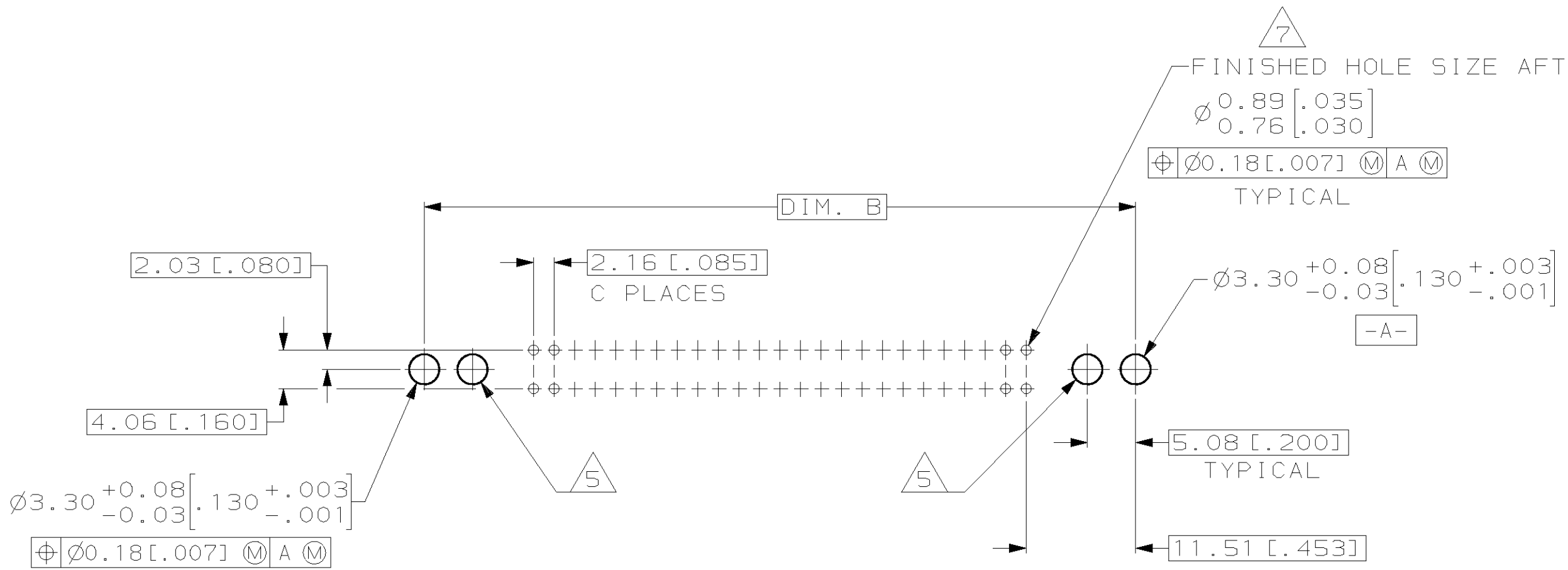

7 PRINTED CIRCUIT BOARD MOUNTING DIMENSIONS

31		89.97 [3.542]	98.43 [3.875]	64	553444-5
24	4-40 UNC-2B	74.83 [2.946]	83.31 [3.280]	50	553444-4
17		59.74 [2.352]	68.20 [2.685]	36	553444-3
11		46.79 [1.842]	55.25 [2.175]	24	553444-2
C		HOLE SIZE	DIM. B	DIM. A	POSITION

THIS DRAWING IS A CONTROLLED DOCUMENT FOR AMP INCORPORATED. IT IS SUBJECT TO CHANGE AND THE CONTROLLING ENGINEERING ORGANIZATION SHOULD BE CONTACTED FOR THE LATEST REVISION.

DIMENSIONS: mm [INCHES]	TOLERANCES UNLESS OTHERWISE SPECIFIED:	DWN A. HOLT 05 APR 85	AMP Incorporated Harrisburg, PA 17105-3608
	0 PLC ±-	CHK M. FRIEL 05 JUN 85	
	1 PLC ±-	APVD S. HEGE 05 JUN 85	
	2 PLC ±-	PRODUCT SPEC	
MATERIAL	FINISH	APPLIC. SPEC	SIZE A2
		WEIGHT	CAGE CODE 00779
		CUSTOMER DRAWING	DRAWING NO C-553444
			RESTRICTED TO
			SCALE 2:1
			SHEET 1 OF 1
			REV L

553444