

THIS DRAWING IS UNPUBLISHED. RELEASED FOR PUBLICATION
 © COPYRIGHT - By - ALL RIGHTS RESERVED.

LOC		DIST		REVISIONS			
P	LTR	DESCRIPTION	DATE	DWN	APVD		
AA	20	N	PER ECO-12-012349	01APR13	BL	AC	

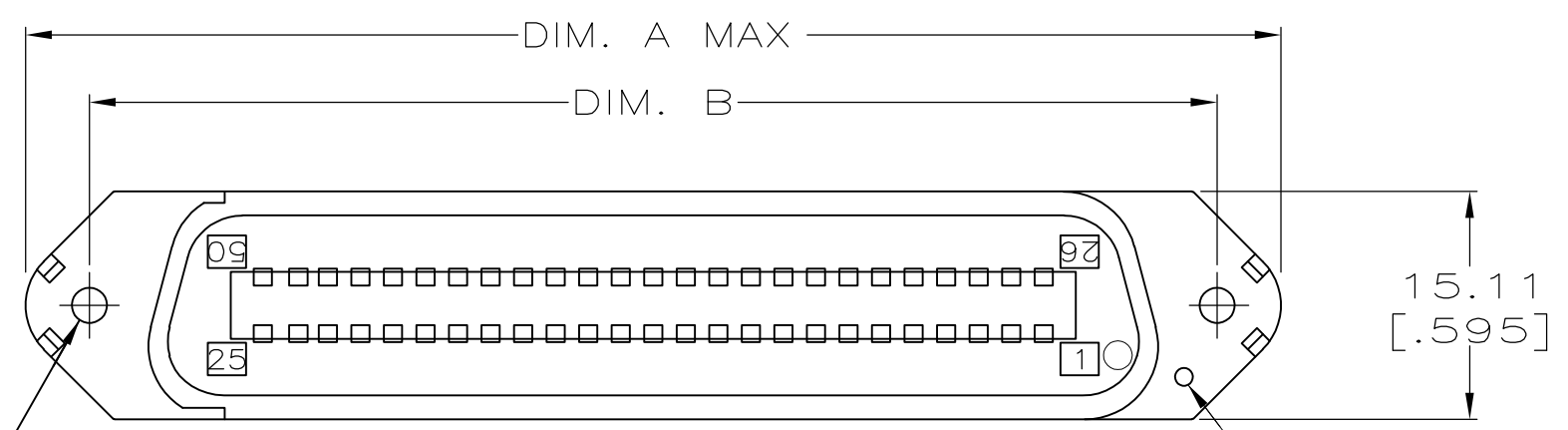

SEE TABLE FOR HOLE SIZE 2 HOLES

VIEW SHOWN WITH RETAINER REMOVED

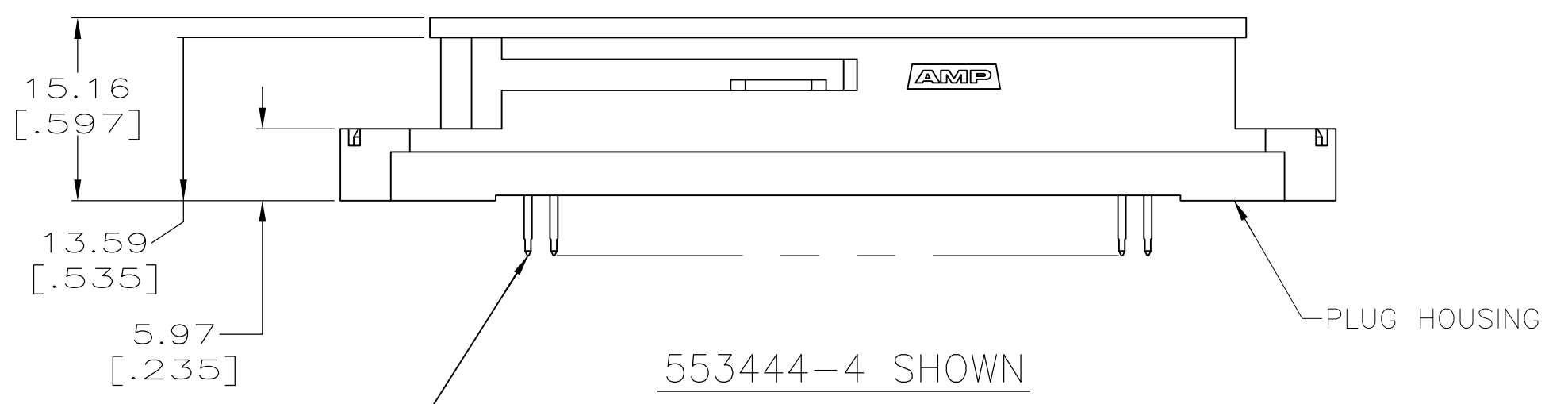

553444-4 SHOWN

TERMINAL QUANTITY 50

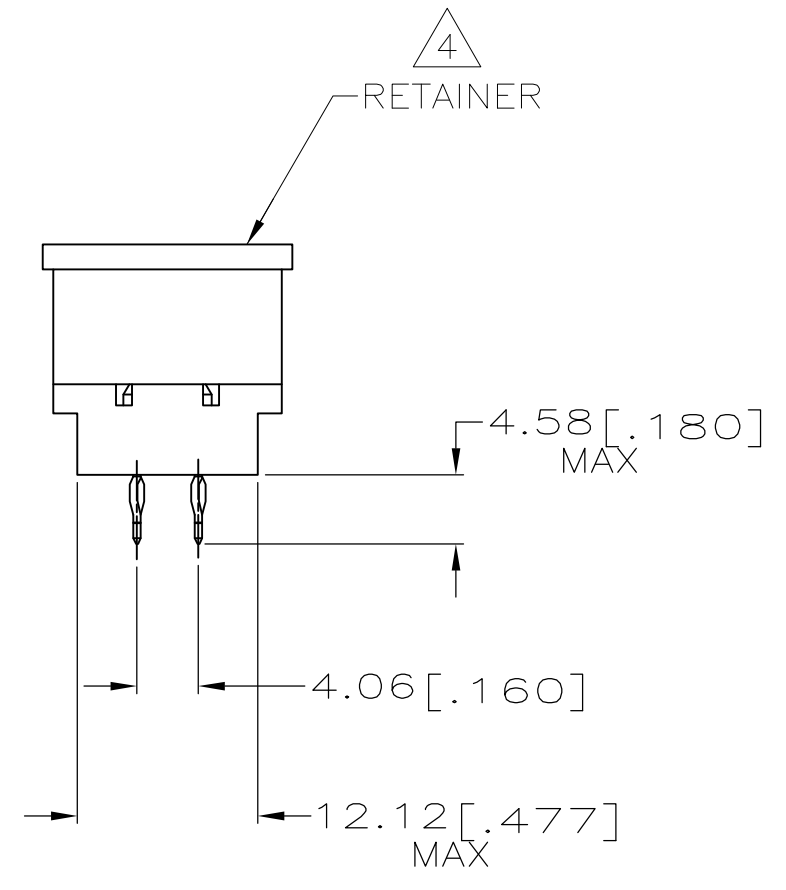

- 1 MATERIAL: HOUSING - POLYESTER MOLDING COMPOUND BLACK.
 TERMINAL - COPPER ALLOY PLATED WITH 0.76µm [.000030] MINIMUM THICK GOLD ON MATING SURFACE AND 0.13µm [.000005] MINIMUM THICK GOLD ON ACTION PIN AREA OVER 1.27µm [.000050] MINIMUM THICK NICKEL UNDERPLATE OVER ENTIRE TERMINAL.
 RETAINER - POLYETHYLENE, NATURAL.
- 2. THE CONTACT SURFACES OF THE TERMINALS ARE COATED WITH LUBRICANT.
- 3 ALL DIMENSIONS SHOWN ARE FOR REFERENCE ONLY UNLESS OTHERWISE SPECIFIED.
- 4 RETAINER MUST REMAIN INSTALLED UNTIL AFTER CONNECTOR HAS BEEN INSERTED INTO PCB HOLES.
- 5 OPTIONAL MOUNTING HOLE FOR SELF-TAPPING SCREW.
- 6. CENTER-TO-CENTER SPACING OF TERMINALS IS 2.16 [.085] NOMINAL.
- 7 ALL PLATED-THRU HOLES SHALL BE PER AMP SPEC 115-6072.
- 8 THRU HOLE ON HOUSING FLANGE INDICATES POSITION 1 LOCATION.

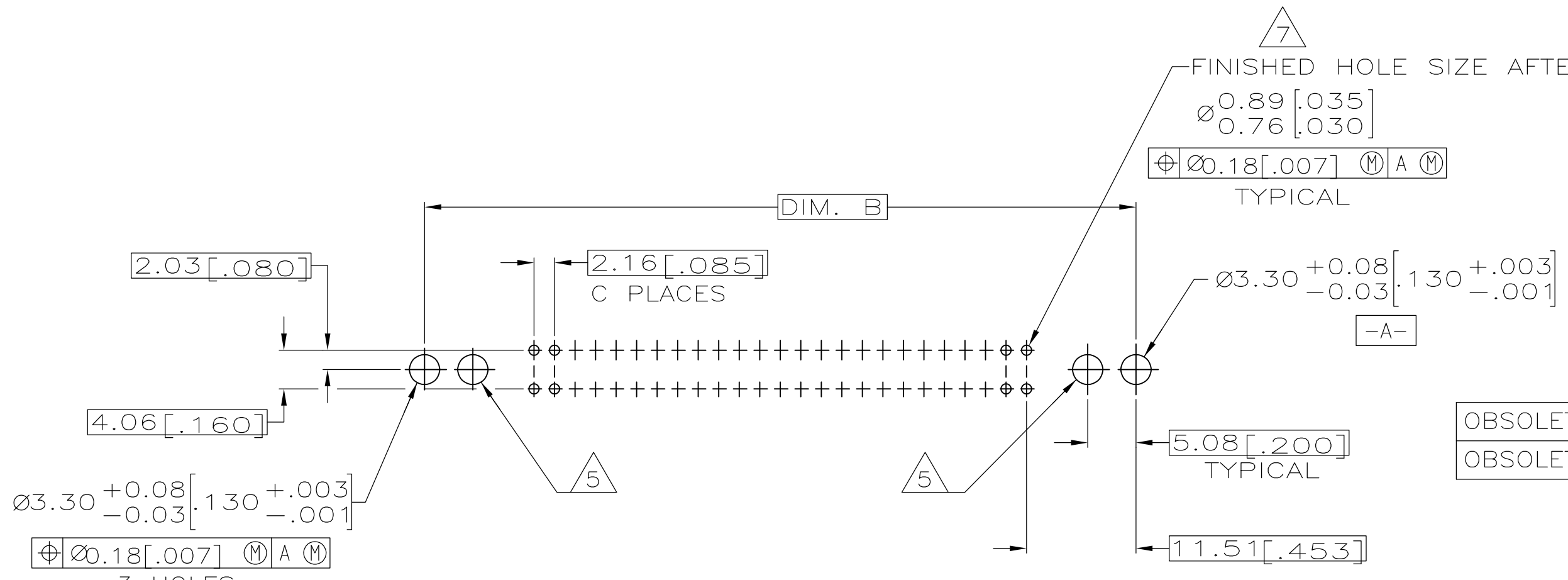

PRINTED CIRCUIT BOARD MOUNTING DIMENSIONS

OBSOLETE
OBSOLETE

24	3.18[0.125]	74.83[2.946]	83.31[3.280]	50	553444-8
31		89.97[3.542]	98.43[3.875]	64	553444-5
24	4-40 UNC-2B	74.83[2.946]	83.31[3.280]	50	553444-4
17		59.74[2.352]	68.20[2.685]	36	553444-3
11		46.79[1.842]	55.25[2.175]	24	553444-2
C	HOLE SIZE	DIM. B	DIM. A	POSITION	PART NUMBER

THIS DRAWING IS A CONTROLLED DOCUMENT.

DWN	A. HOLT	05 APR 85
CHK	M. FRIEL	05 JUN 85
APVD	S. HEGE	05 JUN 85

TE Connectivity

PLUG ASSEMBLY, ACTION PIN, CHAMP-LOK

SIZE	A2	CAGE CODE	00779	DRAWING NO	C=553444	RESTRICTED TO	-
SCALE	2:1	SHEET	1 of 1	REV	N		

- 553444