

DETAIL X
SCALE 10:1

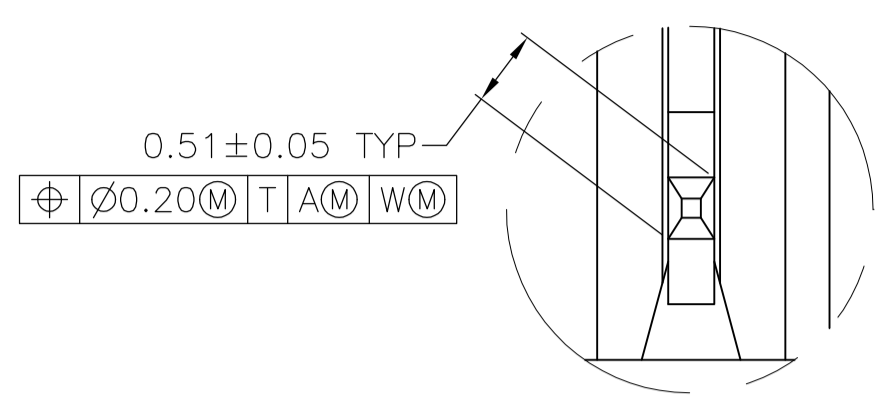

DETAIL Z
SCALE 20:1

- 1 HOUSING MATERIAL: LIQUID CRYSTAL POLYMER.
COLOR: NATURAL.
- 2 CONTACT MATERIAL: PHOSPHOR-BRONZE.
- 3 CONTACT FINISH:
UNDERPLATE (ENTIRE CONTACT) -
0.00127 MIN NICKEL PER SAE-AMS-QQ-N-290.
ON MATING SURFACES-
CONFORMS TO ALL TESTING SPECIFIED FOR TELCORDIA
UNCONTROLLED ENVIRONMENT
ON LEADS-
0.00381 MIN TIN PER ASTM B 545, OVER UNDERPLATE
LUBRICATION (MIN MATING SURFACES):
SURFACE CONDITIONER AFTER PLATING.
- 4 PART MARKING, LOCATED APPROXIMATELY AS SHOWN.
- 5 CUSTOMIZED PART, HOUSING MOLDED WITHOUT END GUIDE LUGS.
- 6 OBSOLETE PART NUMBER.
- 7 CONTACT FINISH:
UNDERPLATE (ENTIRE CONTACT) -
0.00127 MIN NICKEL PER SAE-AMS-QQ-N-290.
ON MATING SURFACES-
CONFORMS TO ALL TESTING SPECIFIED FOR TELCORDIA
UNCONTROLLED ENVIRONMENT
ON LEADS-
FLASH GOLD PER ASTM B 488, OVER UNDERPLATE
LUBRICATION (MIN MATING SURFACES):
SURFACE CONDITIONER AFTER PLATING.

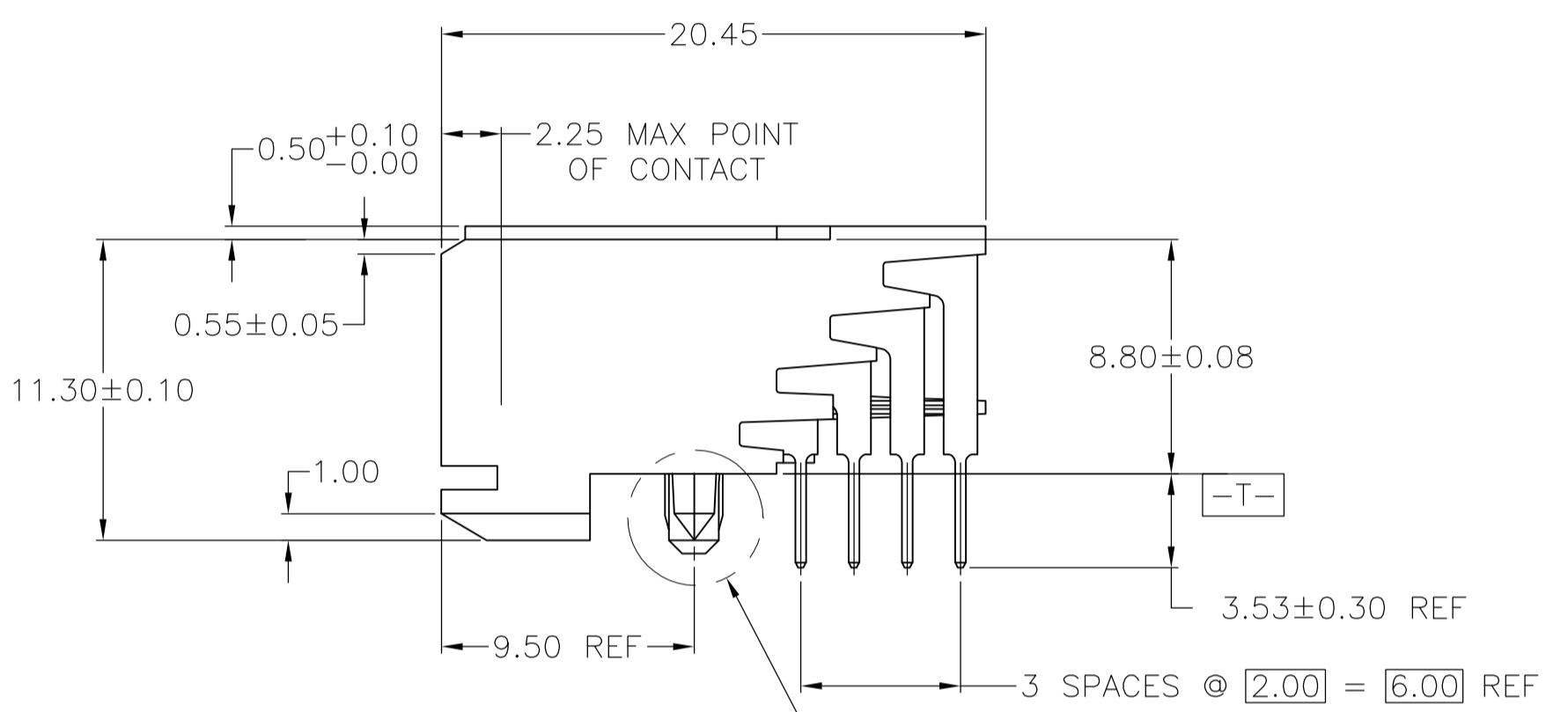
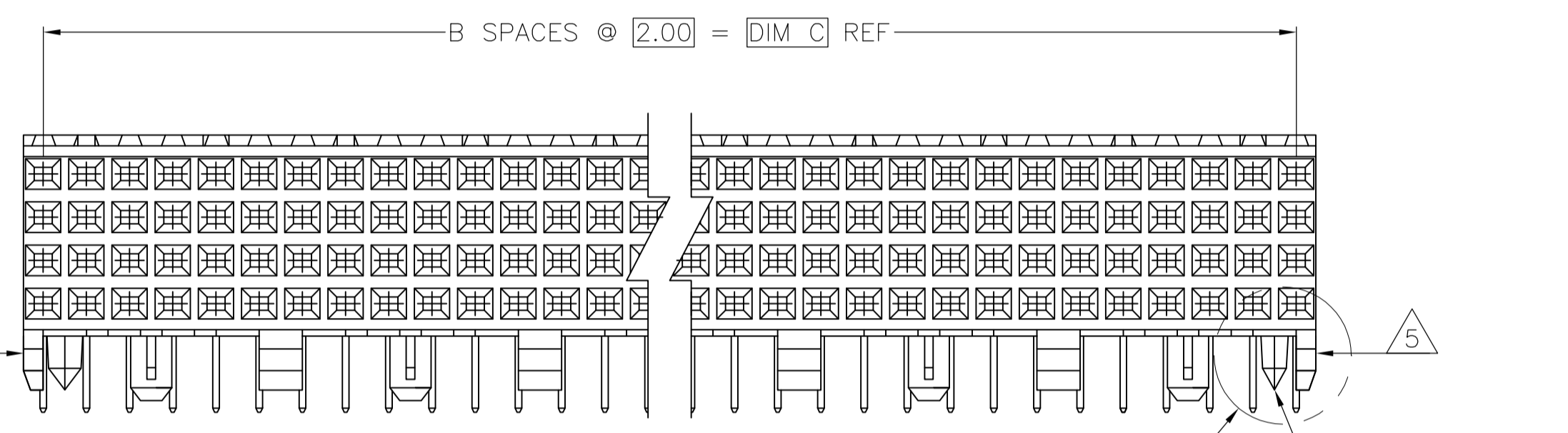

REFER TO DETAIL FOR COLD HOLD CONFIGURATION

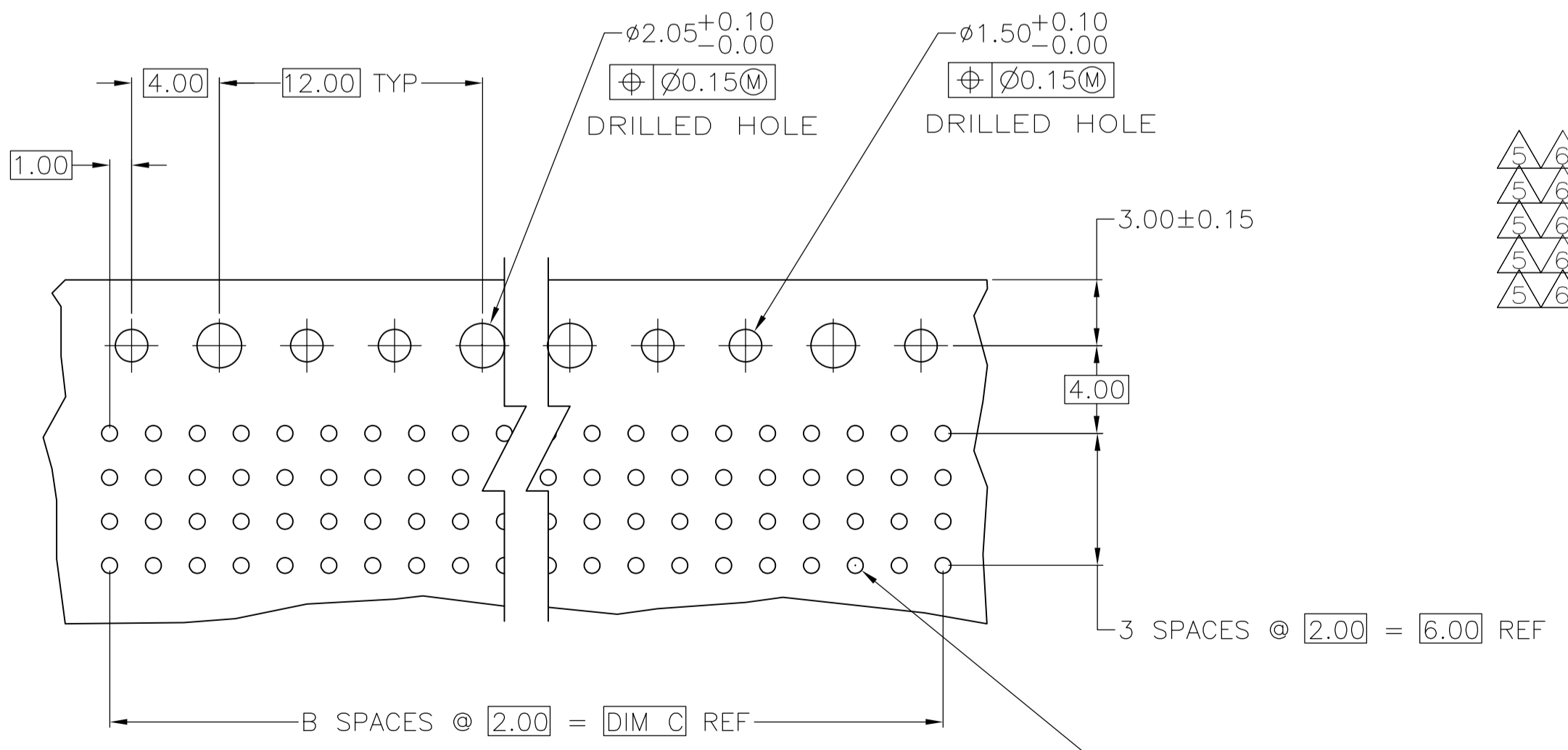
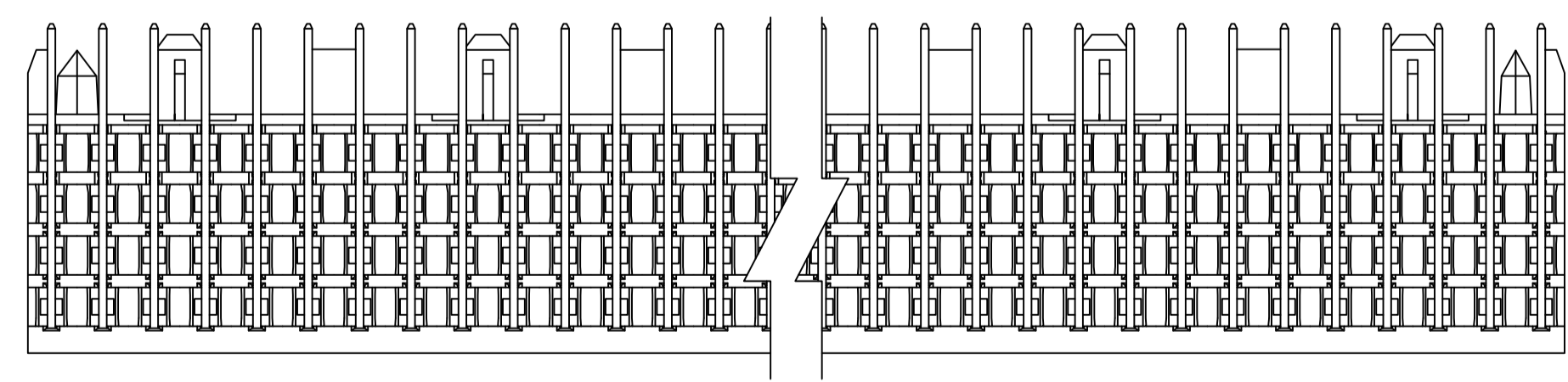
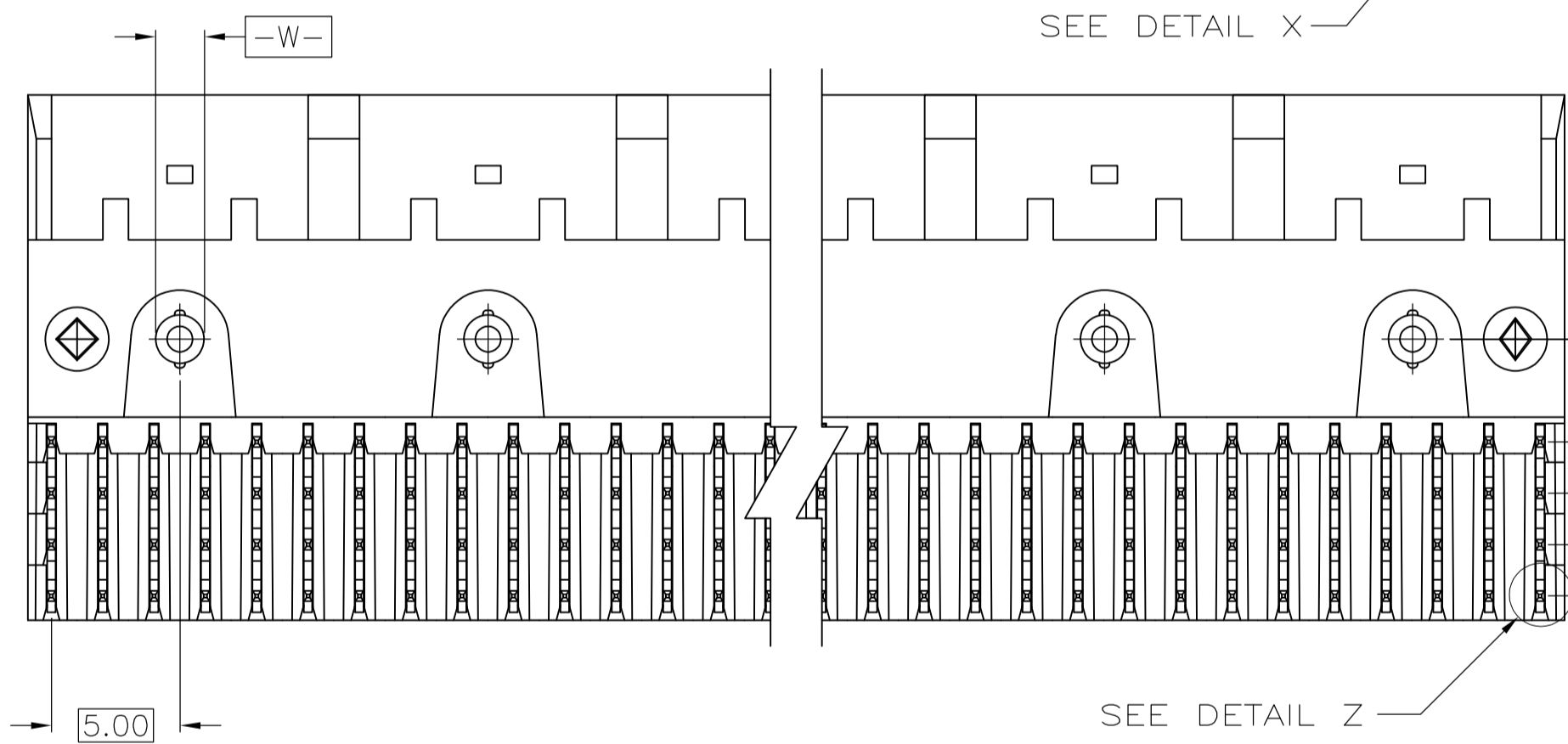

RECOMMENDED CIRCUIT PATTERN
PER IPC-D300 TYPE II, CLASS C
(COMPONENT SIDE)

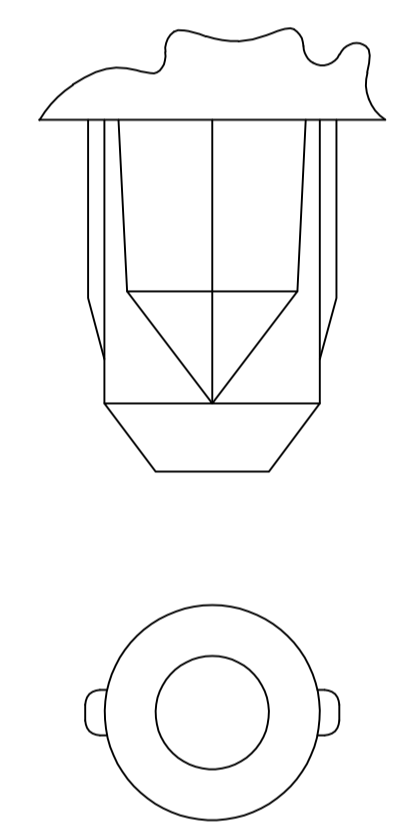

TYPICAL COLD HOLD
FOR ALL ASSEMBLIES

| | | | | | | |
|------------------|-----|----|--------|--------|------------|-------------|
| NO | 70 | 35 | 71.88 | 7 | 144 | 2-5536510-8 |
| NO | 94 | 47 | 95.88 | 7 | 192 | 2-5536510-7 |
| NO | 46 | 23 | 47.88 | 7 | 96 | 2-5536510-6 |
| NO | 22 | 11 | 23.88 | 7 | 48 | 2-5536510-5 |
| YES | 94 | 47 | 95.88 | 3 | 192 | 2-5536510-4 |
| YES | 46 | 23 | 47.88 | 3 | 96 | 2-5536510-3 |
| NO | 34 | 17 | 35.88 | 3 | 72 | 1-5536510-5 |
| NO | 22 | 11 | 23.88 | 3 | 48 | 1-5536510-4 |
| NO | 94 | 47 | 95.88 | 3 | 192 | 1-5536510-3 |
| NO | 106 | 53 | 107.88 | 3 | 216 | 1-5536510-2 |
| NO | 70 | 35 | 71.88 | 3 | 144 | 1-5536510-1 |
| NO | 130 | 65 | 131.88 | 3 | 264 | 1-5536510-0 |
| NO | 106 | 53 | 107.88 | 3 | 216 | 5536510-9 |
| NO | 118 | 59 | 119.88 | 3 | 240 | 5536510-8 |
| NO | 82 | 41 | 83.88 | 3 | 168 | 5536510-7 |
| NO | 58 | 29 | 59.88 | 3 | 120 | 5536510-6 |
| NO | 70 | 35 | 71.88 | 3 | 144 | 5536510-5 |
| NO | 94 | 47 | 95.88 | 3 | 192 | 5536510-4 |
| NO | 46 | 23 | 47.88 | 3 | 96 | 5536510-3 |
| NO | 22 | 11 | 23.88 | 3 | 48 | 5536510-2 |
| YES | 10 | 5 | 11.88 | 3 | 24 | 5536510-1 |
| POSITIONING PEGS | C | B | A | FINISH | NO OF POSN | PART NUMBER |

THIS DRAWING IS A CONTROLLED DOCUMENT.

| | | | | | | | |
|----------------|--|-----------|-------------|-------------|-------------|-----------|------------|
| DIMENSIONS: mm | TOLERANCES UNLESS OTHERWISE SPECIFIED: | 0 PLC ± - | 1 PLC ± .13 | 2 PLC ± .13 | 3 PLC ± .13 | 4 PLC ± - | ANGLES ± - |
|----------------|--|-----------|-------------|-------------|-------------|-----------|------------|

MATERIAL: 1 2 FINISH: 3 7

THIS DRAWING IS A CONTROLLED DOCUMENT. DWN: B. MCMASTER 31AUG04. CJK: R. WERTZ 31AUG04. APVD: R. WERTZ 31AUG04. NAME: Tyco Electronics Corporation, Harrisburg, PA 17105-3608. PRODUCT SPEC: RECEPTACLE ASSEMBLY, SIGNAL MODULE, Z-PACK 2mm FB, 4 ROW, 3.53mm LEAD LENGTH. APPLICATION SPEC: SIZE: A1. CAGE CODE: 00779. DRAWING NO: 5536510. WEIGHT: -. RESTRICTED TO: CUSTOMER DRAWING. SCALE: 4:1. SHEET: 1 of 1. REV: A2.