

5553636-2 Product Details

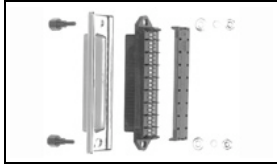

5553636-2

TE Internal Number: 5553636-2



Active

2.16 [.085] Accessories and Hardware

 Always EU RoHS/ELV Compliant (Statement of Compliance)

Product Highlights:

- Accessory Type = Hardware Kits
- Hardware Type = Metric Screw Lock
- Used With IEEE-488 Metric
- 24 Positions
- Cable-to-Panel

Documentation & Additional Information

Product Drawings:

- [HARDWARE KIT, SHIELDED, CHAMP LATCH](#) (PDF, English)

Catalog Pages/Data Sheets:

- None Available

Product Specifications:

- None Available

Application Specifications:

- None Available

Instruction Sheets:

- None Available

CAD Files:

- None Available

Additional Information:

- [Product Line Information](#)

Related Products:

- [Tooling](#)

Product Features (Please use the Product Drawing for all design activity)

Product Type Features:

- Accessory Type = Hardware Kits

Mechanical Attachment:

- [Hardware Type](#) = Metric Screw Lock
- Panel Attachment Style = Front Mount
- Panel Mount Retention = With

Dimensions:

- Panel Thickness (mm [in]) = 1.57 – 3.18 [0.062 – 0.125]

Body Features:

- Used With = IEEE-488 Metric
- Material = Carbon Steel

Configuration Features:

- [Number of Positions](#) = 24

Industry Standards:

- [RoHS/ELV Compliance](#) = RoHS compliant, ELV compliant
- [Lead Free Solder Processes](#) = Not relevant for lead free process
- [RoHS/ELV Compliance History](#) = Always was RoHS compliant

Conditions for Usage:

- For Use With = CHAMP Latch Low Profile Connectors, Shielded CHAMP Latch Connectors, Shielded Panel Mount Connectors

Operation/Application:

- [Application Use](#) = Cable-to-Panel

Other:

- Brand = AMP
- Comment = One kit required per assembly.

THIS DRAWING IS UNPUBLISHED. RELEASED FOR PUBLICATION
 © COPYRIGHT BY TYCO ELECTRONICS CORPORATION. ALL RIGHTS RESERVED.

LOC	DIST	REVISIONS			
P	LTR	DESCRIPTION	DATE	DWN	APVD
GP	00	0	RELEASED PER EC 0513-0288-05	17OCT05	BM WM

- 1. MATERIAL: METRIC MOUNTING STUD – BLACK OXIDE COATED CARBON STEEL.
WASHER, LOCKWASHER AND HEX NUT – ZINC PLATED STEEL.
- 2. ALL HARDWARE SHIPPED UNASSEMBLED.

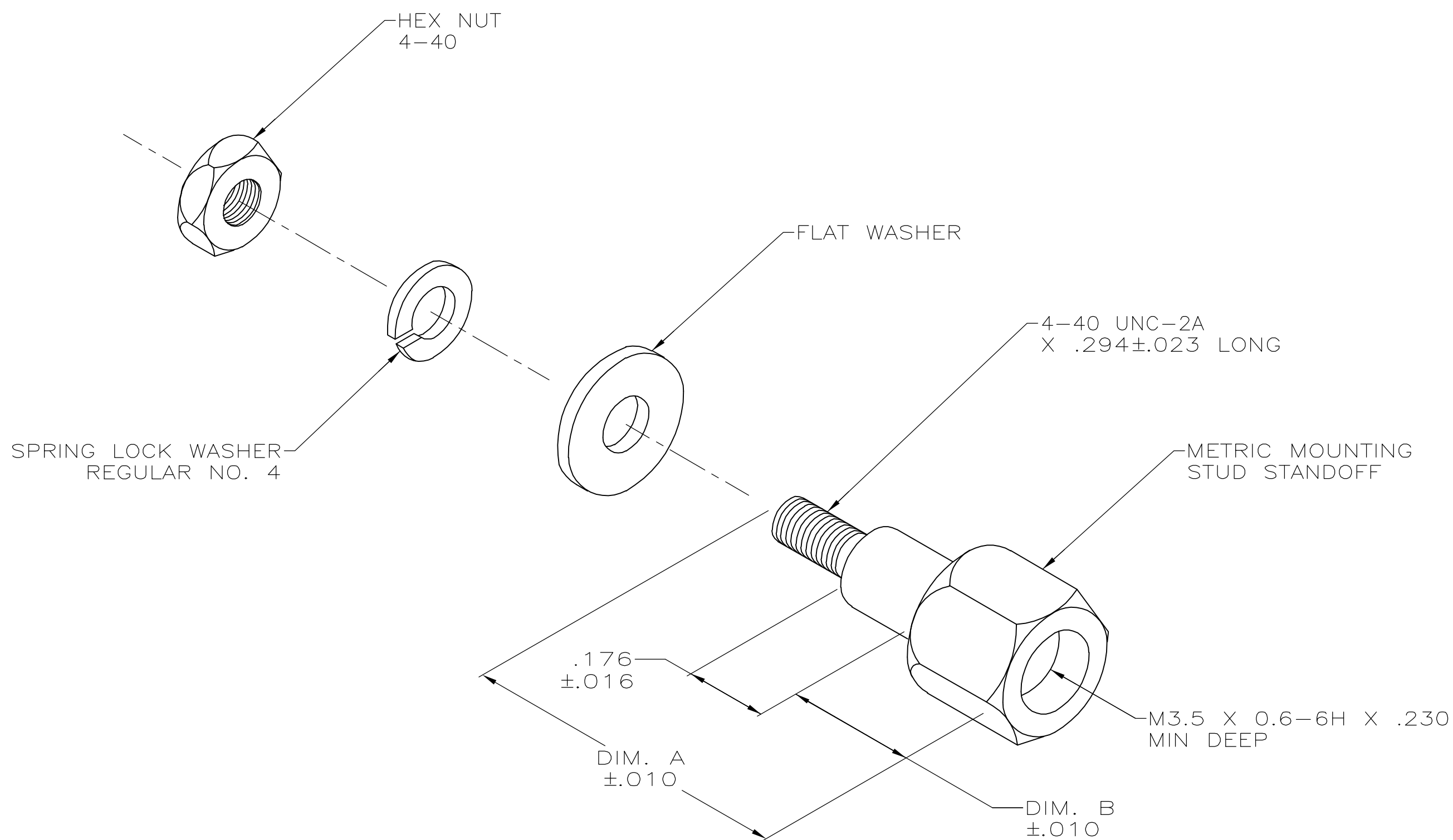

.193	.688	5553636-3
.256	.750	5553636-2
DIM. B	DIM. A	PART NUMBER

THIS DRAWING IS A CONTROLLED DOCUMENT.		DWN B. MCMASTER 17OCT05	Tyco Electronics Corporation Harrisburg, PA 17105-3608													
DIMENSIONS: INCHES		CHK W. MILLHIMES 17OCT05														
TOLERANCES UNLESS OTHERWISE SPECIFIED:		APVD W. MILLHIMES 17OCT05														
<table border="1"> <tr><td>0 PLC</td><td>± -</td></tr> <tr><td>1 PLC</td><td>± -</td></tr> <tr><td>2 PLC</td><td>± -</td></tr> <tr><td>3 PLC</td><td>± -</td></tr> <tr><td>4 PLC</td><td>± -</td></tr> <tr><td>ANGLES</td><td>± -</td></tr> <tr><td>FINISH</td><td>± -</td></tr> </table>		0 PLC			± -	1 PLC	± -	2 PLC	± -	3 PLC	± -	4 PLC	± -	ANGLES	± -	FINISH
0 PLC	± -															
1 PLC	± -															
2 PLC	± -															
3 PLC	± -															
4 PLC	± -															
ANGLES	± -															
FINISH	± -															
MATERIAL		WEIGHT	SIZE A2	CAGE CODE 00779	DRAWING NO C=5553636	RESTRICTED TO										
		CUSTOMER DRAWING	SCALE 4:1	SHEET 1 of 1	REV 0											