

5-583853-3 Product Details

[Share](#) [Print](#) [Email](#)

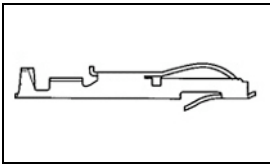

5-583853-3

TE Internal Number: 5-583853-3

Active

[View 3D PDF](#)

.100, .125, .156 Centerline Connectors (Crimp Snap Twin Leaf)

Always EU RoHS/ELV Compliant (Statement of Compliance)

Product Highlights:

- Contact
- Contact Configuration = Bifurcated
- 2.54 mm Centerline, 3.18 mm Centerline, 3.96 mm Centerline
- Crimp Termination Method to Wire/Cable
- Wire Range = 0.20-0.60² [24-20] mm [AWG]

[View all Features](#)

Quick Links

- ▶ [Pricing & Availability](#)
- ▶ [Search for Tooling](#)
- ▶ [Product Feature Selector](#)
- ▶ [Contact Us About This Product](#)

[Add to My Part List](#) [Request Sample](#) [Find Similar Products](#) [Buy Product](#)

Documentation & Additional Information

Product Drawings:

- [CONTACT-TWIN LEAF \(CRIMP-SNAP\)](#) (PDF, English)

Catalog Pages/Data Sheets:

- None Available

Product Specifications:

- [Twin Leaf Crimp Snap Connector](#) (PDF, English)
- [Tin Plated Non-Bifurcated Crimp Twin Leaf Connector](#) (PDF, English)

Application Specifications:

- [Twin Leaf Contacts](#) (PDF, English)

Instruction Sheets:

- None Available

CAD Files: (CAD Format & Compression Information)

- [2D Drawing](#) (DXF, Version V1)
- [3D Model](#) (IGES, Version V1)
- [3D Model](#) (STEP, Version V1)

[List all Documents](#)

Additional Information:

- [Product Line Information](#)

Related Products:

- [Tooling](#)

Product Features (Please use the Product Drawing for all design activity)

Product Type Features:

- [Product Type](#) = Contact
- [Wire Insulation Diameter \(mm \[in\]\)](#) = 1.22 – 1.52 [0.048 – 0.060]
- [Color Code](#) = Green

Mechanical Attachment:

- [Contact Retention in Housing](#) = Crimp Snap-In

Termination Features:

- [Termination Method to Wire/Cable](#) = Crimp

Body Features:

- [Wire Range \(mm \[AWG\]\)](#) = 0.20-0.60² [24-20]

Contact Features:

- [Contact Configuration](#) = Bifurcated
- [Contact Plating, Mating Area, Material](#) = Gold (30)
- [Solder Tail Contact Plating](#) = Matte Tin
- [Contact Base Material](#) = Phosphor Bronze

Housing Features:

- [Centerline \(mm \[in\]\)](#) = 2.54 [0.100], 3.18 [0.125], 3.96 [0.156]

Industry Standards:

- [RoHS/ELV Compliance](#) = RoHS compliant, ELV compliant
- [Lead Free Solder Processes](#) = Not relevant for lead free process
- [RoHS/ELV Compliance History](#) = Always was RoHS compliant

Packaging Features:

- [Contact Packaging Method](#) = Strip Form

Other:

- [Brand](#) = AMP

Corporate Information

- [About TE](#)
- [Investors](#)
- [News Room](#)
- [Supplier Portal](#)

Quick Links

- [Distributor Inventory](#)
- [Product Cross Reference](#)
- [Documents & Drawings](#)
- [Product Compliance Support Center](#)

Customer Support

- [Email or Chat With Us](#)
- [Find a Phone Number](#)
- [Knowledge Base](#)
- [Manage Your Account](#)

THIS DRAWING IS UNPUBLISHED. RELEASED FOR PUBLICATION
 © COPYRIGHT - By - ALL RIGHTS RESERVED.

LOC		DIST		REVISIONS			
P	LTR	DESCRIPTION		DATE	DWN	APVD	
AD	00	V3		REVISED PER ECO-11-004820	11MAR11	RK	HMR

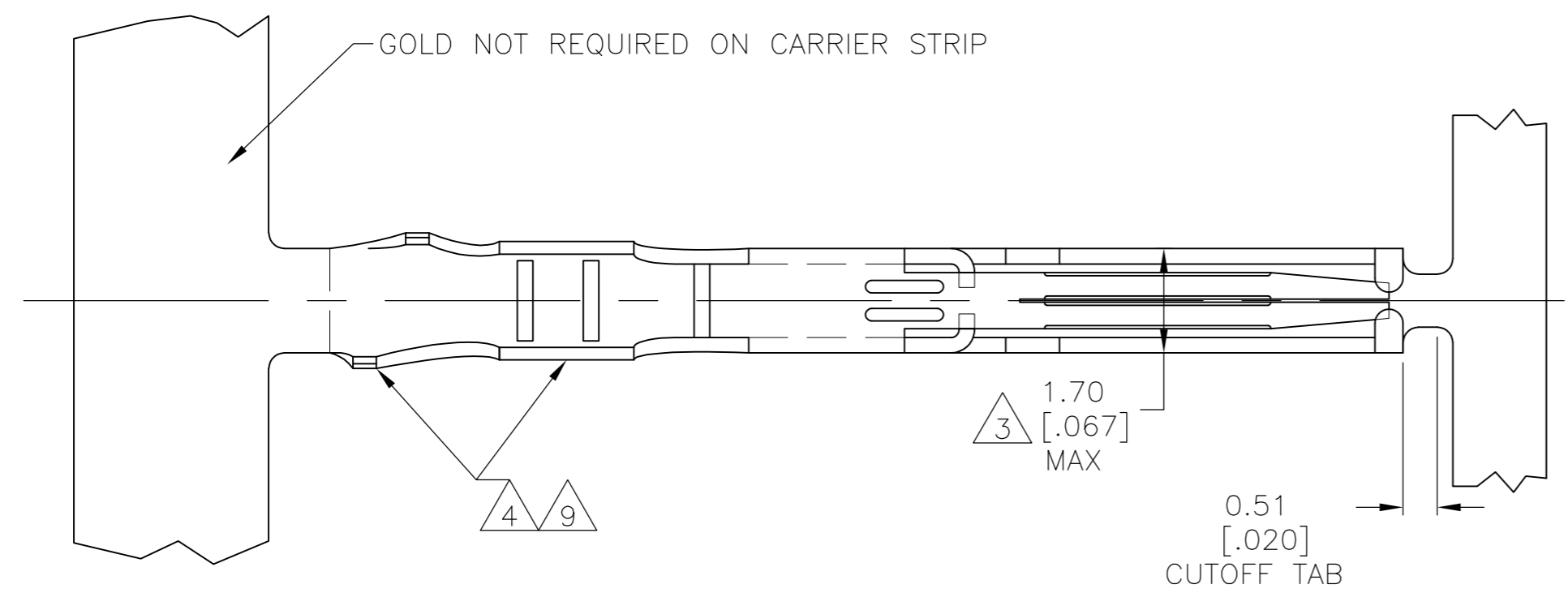

- 1 .000030 GOLD OVER .000030 NICKEL IN CONTACT AREA.
- 2 .000015 GOLD OVER .000030 NICKEL IN CONTACT AREA.
- 3 .067 MAX ALLOWED IN LOCKING LANCE AREA
- 4 TIN-LEAD IN CRIMP AREA.
- 5 OBSOLETE
- 6 .000050 GOLD OVER .000050 NICKEL IN CONTACT AREA. REMAINDER OF CONTACT GOLD FLASH OVER NICKEL.
- 7 .000015 GOLD OVER .000030 NICKEL IN CONTACT AREA. REMAINDER OF CONTACT GOLD FLASH OVER NICKEL.
- 8 UNPLATED PARTS IN STRIP FORM REELED ON CORRUGATED REEL FOR SALABLE PART.
- 9 TIN PLATE IN CRIMP AREA
- 10 OBSOLETE PARTS: OBSOLETE CIS STREAMLINING PER D.RENAUD/D.SINISI

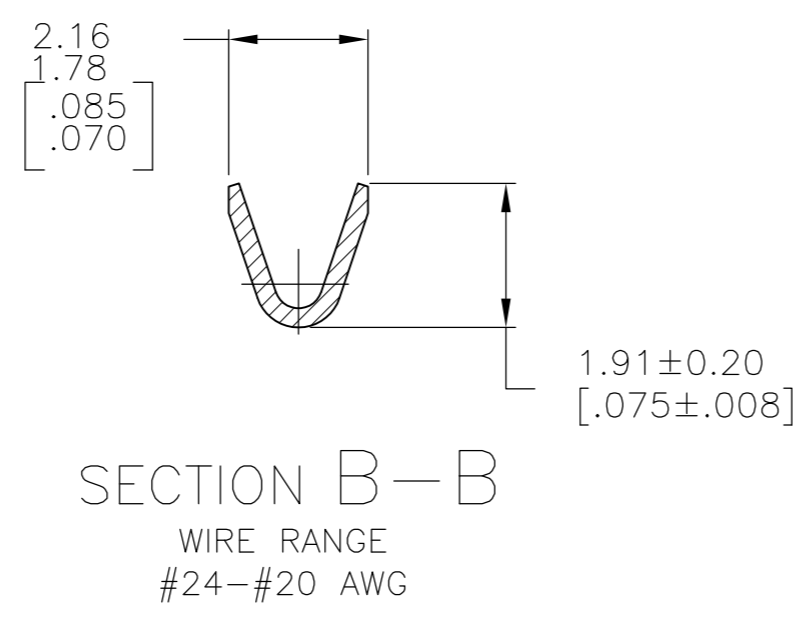
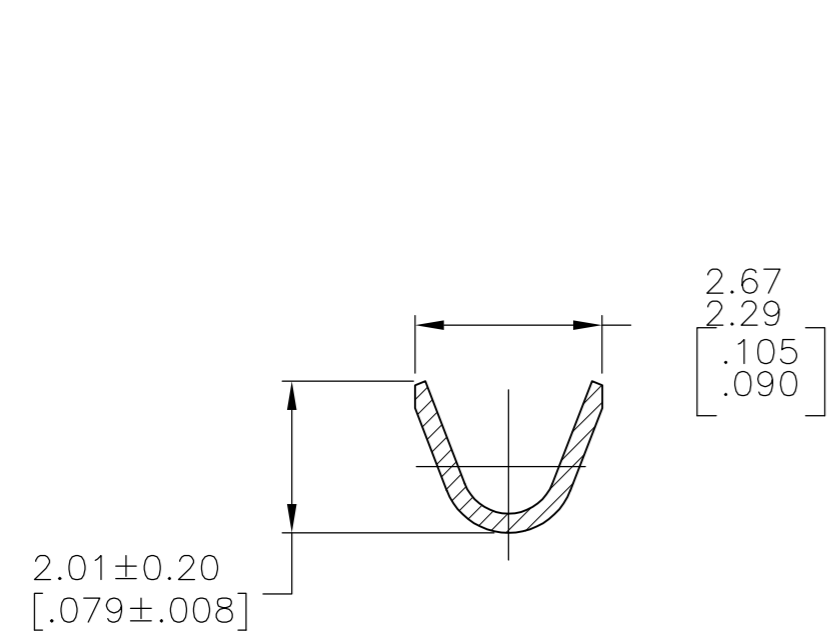
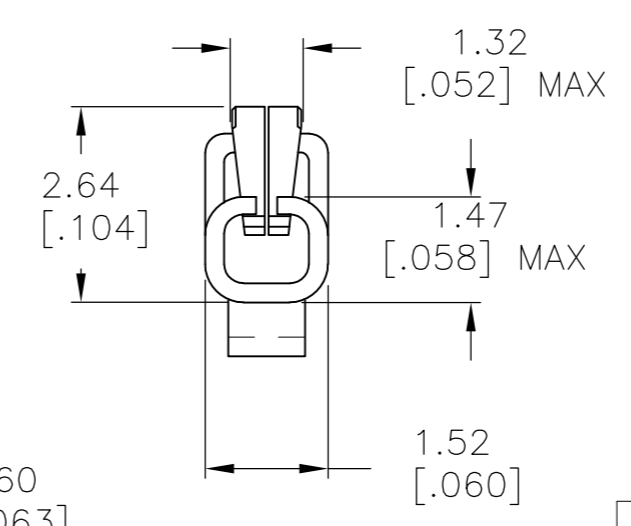
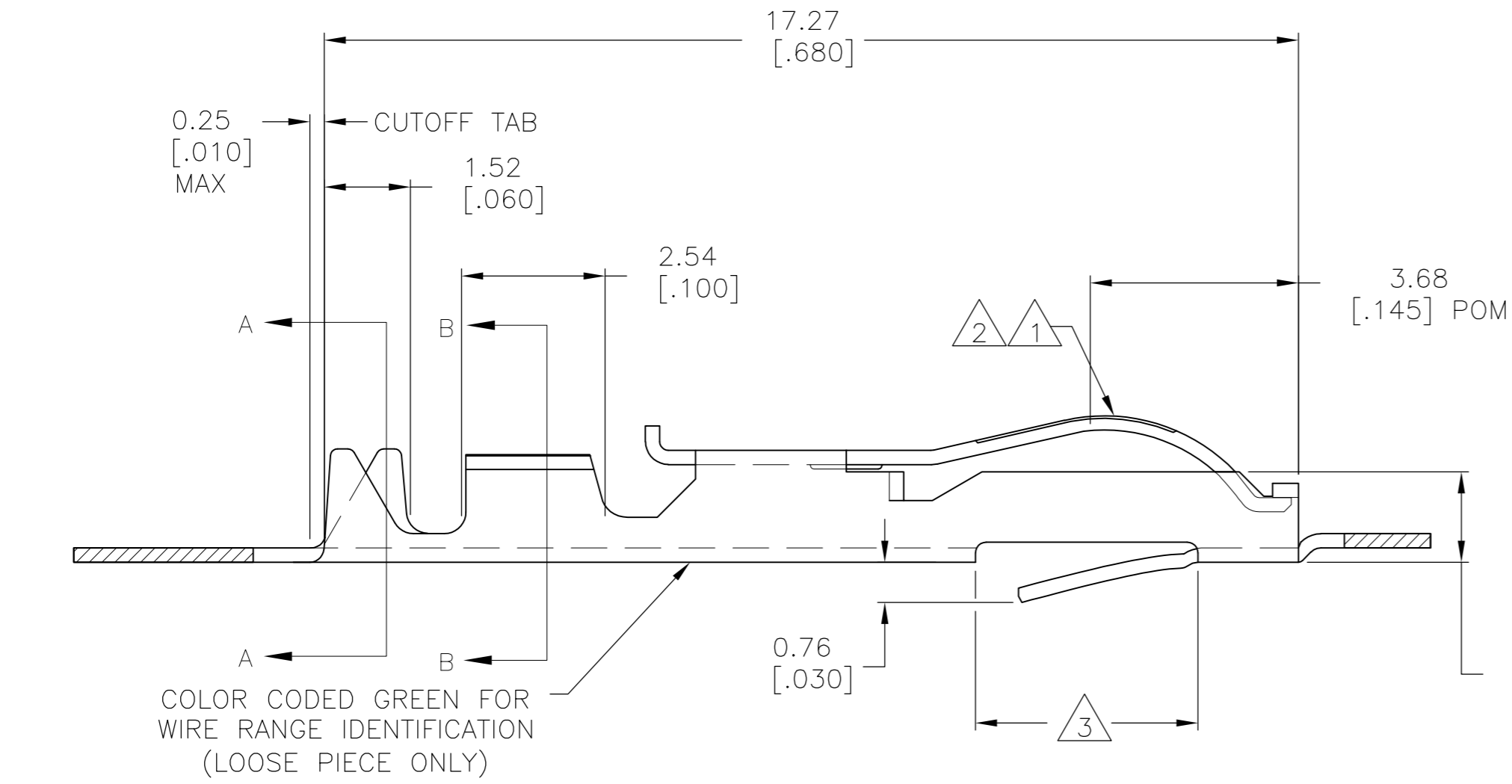

10	DESCRIPTION	STRIP PART # REELING LEFT TO RIGHT	STRIP PART # REELING RIGHT TO LEFT	FINISH	LOOSE PIECE
		5-583853-3	-	1 9	5-583853-5
10	OBSOLETE	5-583853-2	5-583853-7	2 9	5-583853-4
		1-583853-3	-	8	1-583853-1
	OBSOLETE	1-583853-0	1-583853-2	7	1-583853-1
		583853-8	-	6	583853-9
	OBSOLETE	583853-3	583853-6	1 4	583853-5
10	OBSOLETE	583853-2	583853-7	2 4	583853-4

THIS DRAWING IS A CONTROLLED DOCUMENT.

DWN A. STAUB BG 02AUG93
 CHK H ROSE 18FEB94
 APVD H ROSE 18FEB94

TE Connectivity

CONTACT-TWIN LEAF (CRIMP-SNAP)

SIZE A2 CAGE CODE 00779 DRAWING NO C=583853 RESTRICTED TO -

MATERIAL PHOS BRONZE FINISH SEE TABLE WEIGHT - SCALE 10:1 SHEET 1 OF 1 REV V3