

## 5749070-7 Product Details

[Share](#) [Print](#) [Email](#)

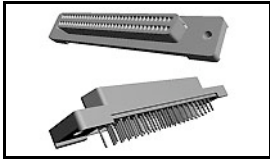

5749070-7

TE Internal Number: 5749070-7

Active

[View 3D PDF](#)

### .050 Series Board Mount Connectors

Always EU RoHS/ELV Compliant  
(Statement of Compliance)

#### Product Highlights:

- Connector
- Connector Style = Receptacle
- 68 Positions
- PCB Mounting Orientation = Vertical
- Termination Method to PC Board = Through Hole - Solder

[View all Features](#)

### Quick Links

- ▶ [Pricing & Availability](#)
- ▶ [Search for Tooling](#)
- ▶ [View Mating Products \(8\)](#)
- ▶ [Product Feature Selector](#)
- ▶ [Contact Us About This Product](#)

[Add to My Part List](#) [Request Sample](#) [Find Similar Products](#)  
[Buy Product](#)

### Documentation & Additional Information

#### Product Drawings:

- [RECEPTACLE ASSEMBLY, SHIELDED, VERTICAL, AMPLIMITE .0...](#) (PDF, English)

#### Catalog Pages/Data Sheets:

- [AMPLIMITE Subminiature D Connectors - .050 Series Co...](#) (PDF, English)

#### Product Specifications:

- [Connector, AMPLIMITE, Shielded, .050 Series](#) (PDF, English)

#### Application Specifications:

- [AMPLIMITE .050 Series Cable End Insulation Displacem...](#) (PDF, English)

#### Instruction Sheets:

- None Available

#### CAD Files: (CAD Format & Compression Information)

- [2D Drawing](#) (DXF, Version 0)
- [3D Model](#) (IGES, Version 0)
- [3D Model](#) (STEP, Version 0)

[List all Documents](#)

#### Additional Information:

- [Product Line Information](#)

#### Additional Product Images:

- [Product Photo](#)
- [Panel Cutout](#)

#### Related Products:

- [Tooling](#)
- [Mating Products \(8\)](#)

### Product Features (Please use the Product Drawing for all design activity)

#### Product Type Features:

- [Product Type](#) = Connector
- PCB Mounting Orientation = Vertical
- PCB Mount Retention = With
- PCB Mount Retention Type = Mounting Hole(s)
- [PCB Mount Alignment](#) = Without
- [Shell Type](#) = Full Metal
- [Product Series](#) = Series III

#### Mechanical Attachment:

- Mating Retention Type = Jackscrew(s)

#### Termination Features:

- Termination Method to PC Board = Through Hole - Solder

#### Contact Features:

- [Contact Plating, Mating Area, Material](#) = Gold (30), Gold Flash over Palladium Nickel
- Contact Base Material = Phosphor Bronze

#### Housing Features:

- Connector Style = Receptacle
- Mating Alignment = Without
- Centerline (mm [in]) = 1.27 [0.050]
- Housing Material = Thermoplastic - GF
- UL Flammability Rating = UL 94V-0

#### Configuration Features:

- [Number of Positions](#) = 68
- [Shielded](#) = Yes

- Termination Post Length (mm [in]) = 3.18 [0.125]

**Body Features:**

- Mating Retention = With
- Post Plating = Tin
- Shell Material = Steel
- Shell Plating = Tin over Copper
- Bracket Material = Zinc
- Bracket Plating = Nickel over Copper

**Industry Standards:**

- [RoHS/ELV Compliance](#) = RoHS compliant, ELV compliant
- [Lead Free Solder Processes](#) = Reflow solder capable to 245°C, Reflow solder capable to 260°C
- RoHS/ELV Compliance History = Always was RoHS compliant

**Other:**

- Brand = AMP
- Comment = Female screwlocks must be used to mate with cable assemblies with male jackscrew hardware.

---

**Corporate Information**

[About TE](#)  
[Investors](#)  
[News Room](#)  
[Supplier Portal](#)  
[Careers](#)  
[Terms & Conditions](#)  
[Privacy Policy](#)

**Quick Links**

[Distributor Inventory](#)  
[Product Cross Reference](#)  
[Documents & Drawings](#)  
[Product Compliance Support Center](#)  
[Site Map](#)

**Customer Support**

[Email or Chat With Us](#)  
[Find a Phone Number](#)  
[Knowledge Base](#)  
[Manage Your Account](#)

**Keep Me Informed**

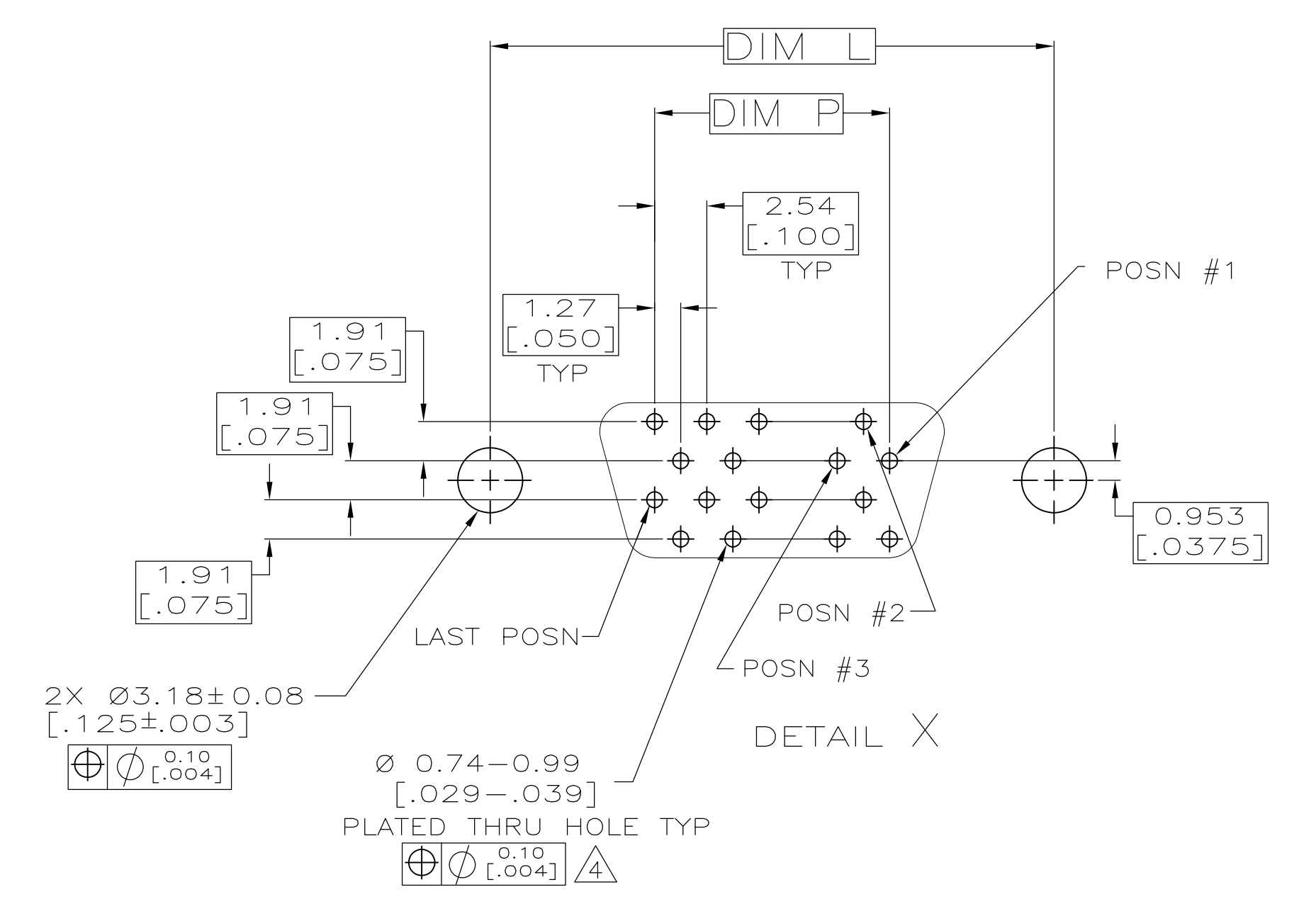
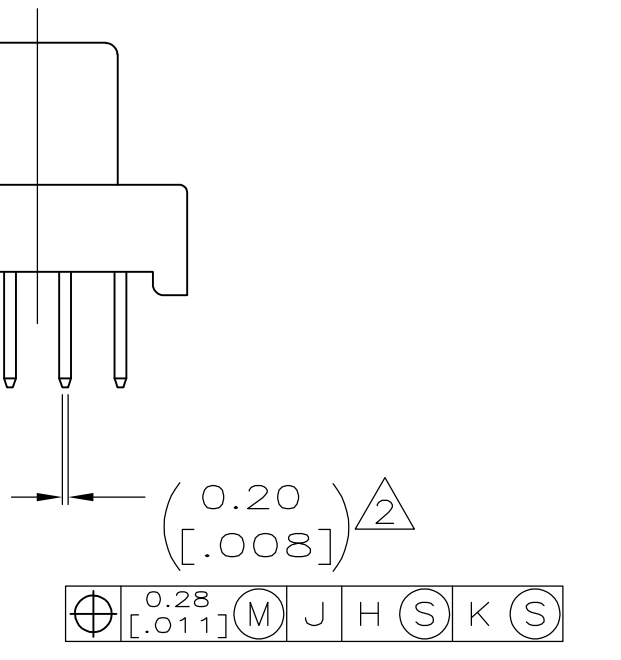
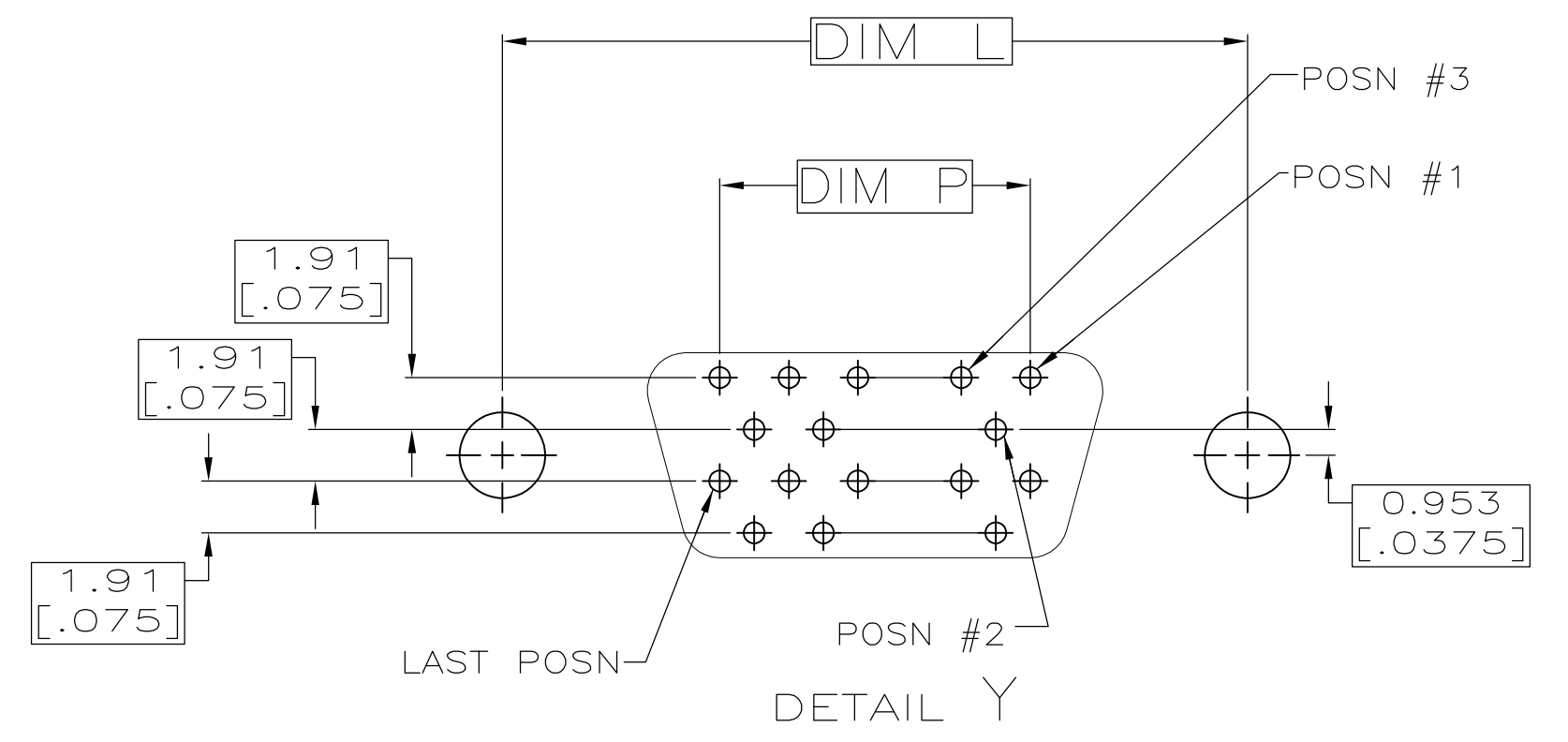
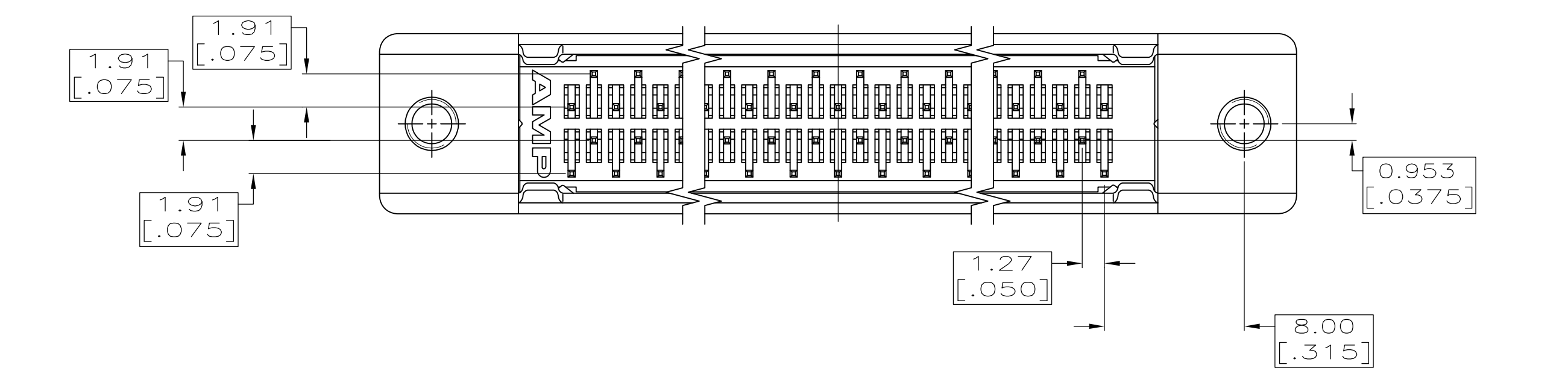
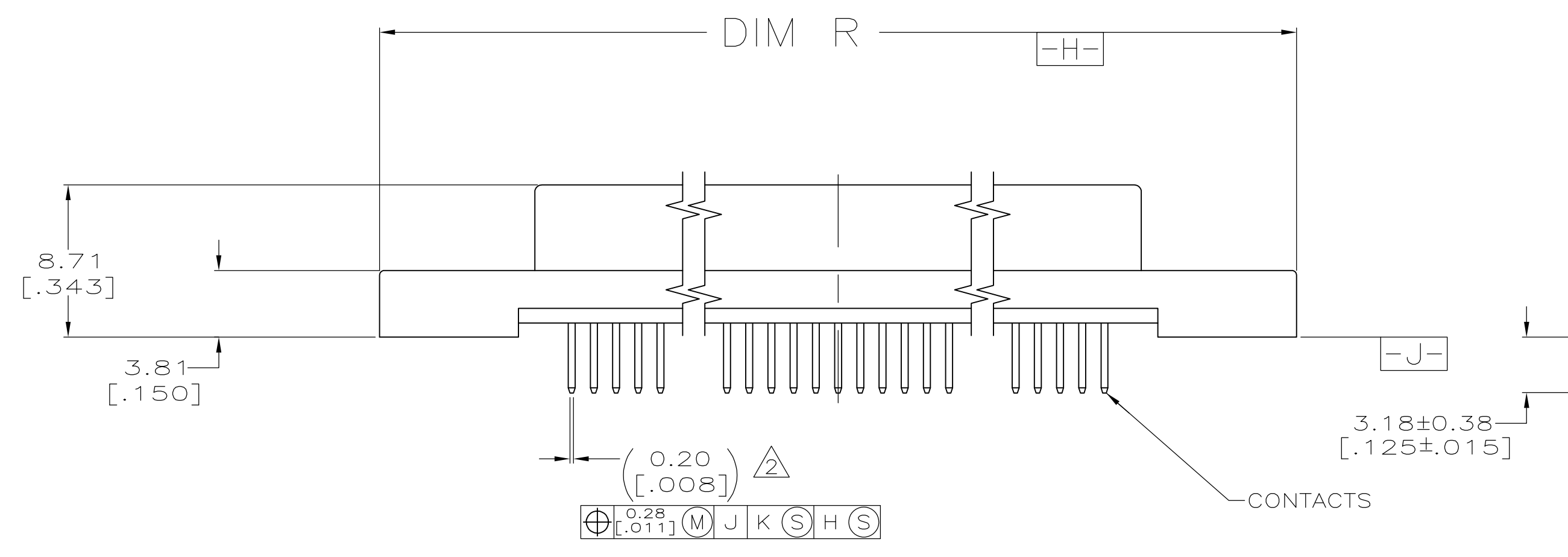
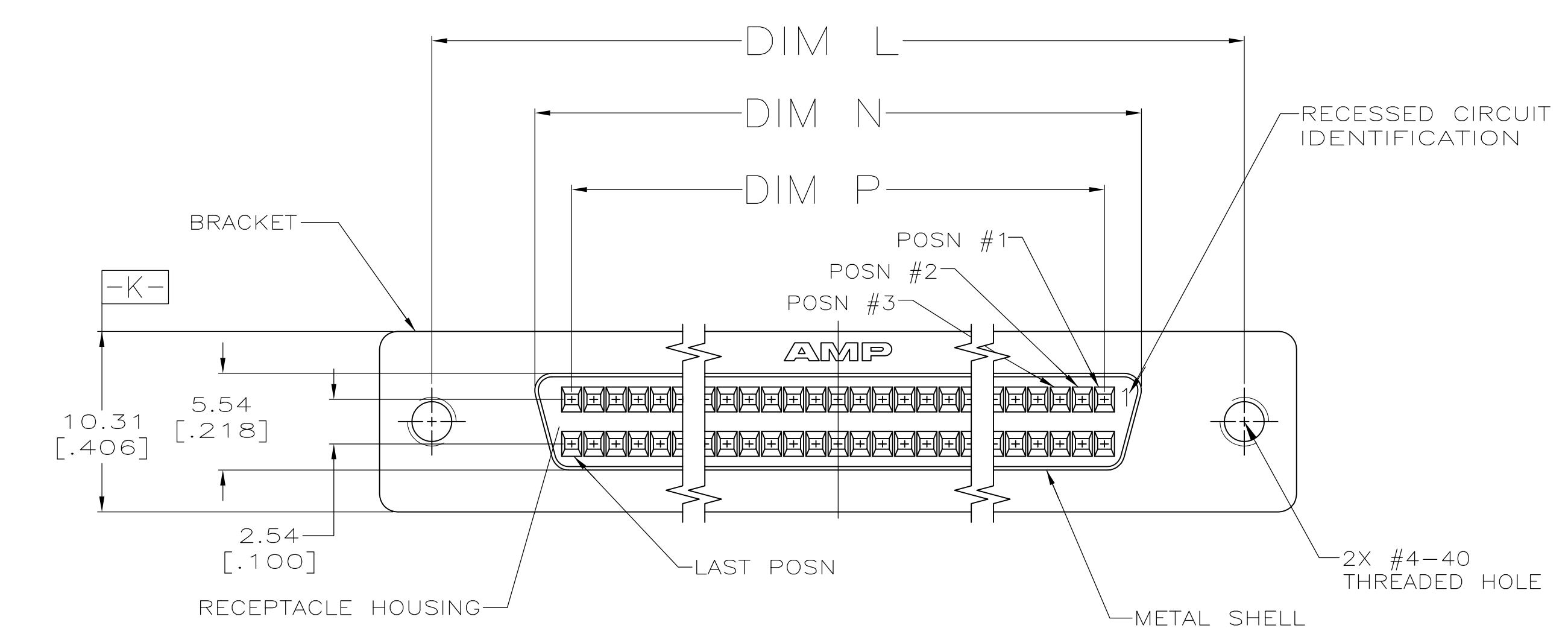

P.C.BOARD MOUNTING DIMENSIONS (CONNECTOR SIDE)

- 1 FINISH  
CONTACTS: EITHER .76µm [.000030] MIN GOLD OR GOLD FLASH OVER PALLADIUM NICKEL, 0.76µm [.000030] MIN TOTAL ON MATING END. TIN PLATED 3.05µm [.000120] MINIMUM THICK ON SOLDER LEAD, ALL OVER 1.27µm [.000050] MINIMUM THICK NICKEL UNDERPLATE.  
METAL SHELL: 5.08µm [.000200] MIN NICKEL OVER 1.27µm [.000050] MIN COPPER.  
BRACKET: NICKEL PLATE.
- 2 POSITION TOLERANCE APPLIES AT TIP ONLY.
- 3 MATERIAL  
CONTACTS: PHOSPHOR BRONZE  
RECEPTACLE HOUSING: UL V-O RATED THERMOPLASTIC COLOR BLACK  
BRACKET: ZINC  
METAL SHELL: CARBON STEEL.
- 4 ACTUAL HOLE SIZE USED WILL DEPEND ON TRACE ROUTING REQUIREMENTS BETWEEN HOLES AND CONNECTOR PLACEMENT TECHNIQUE.

|             |                  |                  |                  |                  |             |             |
|-------------|------------------|------------------|------------------|------------------|-------------|-------------|
| X           | 84.20<br>[3.315] | 62.23<br>[2.450] | 66.45<br>[2.616] | 78.23<br>[3.080] | 100         | 5749070-9   |
| X           | 63.88<br>[2.515] | 41.91<br>[1.650] | 46.13<br>[1.816] | 57.91<br>[2.280] | 68          | 5749070-7   |
| Y           | 52.45<br>[2.065] | 30.48<br>[1.200] | 34.70<br>[1.366] | 46.48<br>[1.830] | 50          | 5749070-5   |
| PWB PATTERN | R                | P                | N                | L                | NO. OF POSN | PART NUMBER |

THIS DRAWING IS A CONTROLLED DOCUMENT.

|                        |  |  |                        |                            |                  |
|------------------------|--|--|------------------------|----------------------------|------------------|
| DIMENSIONS: mm(INCHES) | TOLERANCES UNLESS OTHERWISE SPECIFIED: | DWN: A. FERNANDEZ-DOCKES 02-28-05                              | CHK: S. SHUEY 02-28-05 | APVD: M. WALMSLEY 02-28-05 | NAME: S. SHUEY   |
| 0 PLC ± .01            | 1 PLC ± .012                           | 2 PLC ± .012   | 3 PLC ± .012           | 4 PLC ± .012               | ANGLES ± .01     |
| MATERIAL: 3            | FINISH: 1                              | APVD: M. WALMSLEY 02-28-05                                     |                        | NAME: S. SHUEY             |                  |
| CUSTOMER DRAWING       |  | RECEPTACLE ASSEMBLY, SHIELDED, VERTICAL, AMPLIMITE .050 Series |                        | SIZE: A1                   | CAGE CODE: 00779 |
| SCALE: 4:1             |  | DRAWING NO: 5749070  |                        | REV: B1                    |                  |