

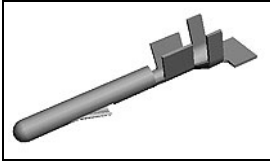

60618-6 Product Details



60618-6

TE Internal Number: 60618-6

 Active

 View 3D PDF

.200" Centerline, 250 V, 13 A max.

 Always EU RoHS/ELV Compliant (Statement of Compliance)

Product Highlights:

- Commercial MATE-N-LOK Product Line
- Contact
- Applies To Wire/Cable
- Contact Type = Pin
- Crimp Termination Method to Wire/Cable

Documentation & Additional Information

Product Drawings:

- [PIN, LOOSE PIECE, COMMERCIAL MATE N LOK \(PDF, English\)](#)

Catalog Pages/Data Sheets:

- [SOFT_SHELL_PIN_SOCKET_CONNECTORS_STANDARD_DENSITY \(PDF, English\)](#)

Product Specifications:

- None Available

Application Specifications:

- [Commercial MATE-N-LOK Pin And Socket Contacts \(PDF, English\)](#)
- [MATE-N-LOK Commercial Pin and Socket Contacts \(PDF, Japanese\)](#)

Instruction Sheets:

- [Universal, Commercial, and .140 MATE-N-LOK Contact ... \(PDF, English\)](#)

CAD Files: (CAD Format & Compression Information)

- [2D Drawing \(DXF, Version S\)](#)
- [3D Model \(IGES, Version S\)](#)
- [3D Model \(STEP, Version S\)](#)

Additional Information:

- [Product Line Information](#)

Related Products:

- [Tooling](#)
- [Housings \(69\)](#)

Product Features (Please use the Product Drawing for all design activity)

Product Type Features:

- Product Line = Commercial MATE-N-LOK
- Product Type = Contact
- Termination Method to Wire/Cable = Crimp
- Wire/Cable Type = Discrete Wire

Electrical Characteristics:

- Contact - Rated Current (A) = 13
- Operating Voltage Reference = AC
- Operating Voltage (VAC) = 250

Body Features:

- Wire Range (mm [AWG]) = 0.20-0.80² [24-18]

Contact Features:

- Contact Type = Pin
- Contact Plating, Mating Area, Material = Gold (30)
- Contact Diameter (mm [in]) = 2.13 [0.084]
- Contact Base Material = Phosphor Bronze

Industry Standards:

- [RoHS/ELV Compliance](#) = RoHS compliant, ELV compliant
- [Lead Free Solder Processes](#) = Not relevant for lead free process
- [RoHS/ELV Compliance History](#) = Always was RoHS compliant

Conditions for Usage:

- Applies To = Wire/Cable
- Accepts Wire Insulation Diameter, Range (mm [in]) = 1.52 - 2.54 [0.060 - 0.100]

Packaging Features:

- Packaging Method = Loose Piece

Other:

- Brand = AMP
- Comment = Use Hand Tool No. 90123-5 for 1.09-1.90 [.043-.075] insulation diameter.; Insertion Tools: No. 455830-1 (IS 7984); Extraction Tools: Pins- No. 1-305183-1(IS 408-7158); Sockets- No. 1-305183-2(IS 408-7158); Pins and Sockets- No. 465644-1(IS 408-7211)