

## 61118-4 Product Details

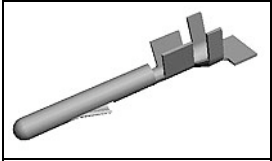

**61118-4**

TE Internal Number: 61118-4

 [Active](#)

 [View 3D PDF](#)

**.200" Centerline, 250 V, 13 A max.**

 [Always EU RoHS/ELV Compliant \(Statement of Compliance\)](#)

**Product Highlights:**

- Commercial MATE-N-LOK Product Line
- Contact
- Contact Type = Pin
- Crimp Termination Method to Wire/Cable
- Pre-Tin Contact Plating, Mating Area, Material

[View all Features](#)

### Documentation & Additional Information

**Product Drawings:**

- [PIN, MATE-N-LOK](#) (PDF, English)

**Catalog Pages/Data Sheets:**

- [REPRESENTATIVE TERMINALS AND CONNECTORS](#) (PDF, English)
- [SOFT SHELL PIN SOCKET CONNECTORS STANDARD DENSITY](#) (PDF, English)

**Product Specifications:**

- [Connector, MATE-N-LOK, Header, Commercial](#) (PDF, English)
- [Connector, MATE-N-LOK, Header, Commercial](#) (PDF, Japanese)

**Application Specifications:**

- [MATE-N-LOK Commercial Pin And Socket Contacts](#) (PDF, English)
- [MATE-N-LOK Commercial Pin and Socket Contacts](#) (PDF, Japanese)

**Instruction Sheets:**

- None Available

**CAD Files:** ([CAD Format & Compression Information](#))

- [2D Drawing](#) (DXF, Version AF)
- [3D Model](#) (IGES, Version AF)
- [3D Model](#) (STEP, Version AF)

[List all Documents](#)

**Additional Information:**

- [Product Line Information](#)

**Related Products:**

- [Tooling](#)
- [Housings \(70\)](#)

### Product Features (Please use the Product Drawing for all design activity)

**Product Type Features:**

- Product Line = Commercial MATE-N-LOK
- Product Type = Contact
- Termination Method to Wire/Cable = Crimp
- Wire/Cable Type = Discrete Wire
- Industry Application = Standard

**Electrical Characteristics:**

- Contact Current Rating (A) = 13
- Operating Voltage Reference = AC
- Operating Voltage (VAC) = 250

**Body Related Features:**

- Wire Range (mm [AWG]) = 0.50-2.00<sup>2</sup> [20-14]
- Contact Diameter (mm [in]) = 2.13 [0.084]

**Contact Related Features:**

- Contact Type = Pin
- Contact Plating, Mating Area, Material = Pre-Tin
- Contact Base Material = Phosphor Bronze

**Industry Standards:**

- [RoHS/ELV Compliance](#) = RoHS compliant, ELV compliant
- [Lead Free Solder Processes](#) = Not relevant for lead free process
- RoHS/ELV Compliance History = Always was RoHS compliant

**Conditions for Usage:**

- Accepts Wire Insulation Diameter, Range (mm [in]) = 2.54 – 3.30 [0.100 – 0.130]
- Applies To = Wire

**Packaging Related Features:**

- Packaging Method = Strip

**Other:**

- Brand = AMP
- Comment = HDM Applicator part number ending in -1 is used on AMPOMATOR CLS Machine with T or G terminators, -2 used on AMP-O-LECTRIC Model K Machine; -3,-4, or -6 is used on AMP-O-LECTRIC Model G Machine.; Extraction Tools: Pins- No. 1-305183-1(IS 408-7158); Sockets- No. 1-305183-2(IS 408-7158); Pins and Sockets- No. 465644-1(IS 408-7211)