



Product Facts

- Reduced insertion force
- Designed for correct lead-in of tab
- Mates with typical 110, 187 and 250 Series tab styles including those with shoulders
- UL rated at +105°C
- 110 Series accepts 22-18 AWG [0.3–1 mm²], 187 Series accepts 20-16 AWG [0.5–1.4mm²] wire and 250 Series accepts 22-10 AWG [0.3–5 mm²] wire
- Visual inspection of crimp and wire brush
- Terminated by automatic or semi-automatic equipment to meet production requirements
- Complies with the IEC 380, 601 and 950 and UL 1950 requirements for a secondary means of insulation fixing
- Listed by Underwriters Laboratories Inc., File No. E66717 
- CSA Certified, File No. LR 7189 
- VDE tested according to DIN VDE 0627/9.91, VDE Reg. No. 

Technical Documents

Product Specification

108-1285
108-2215

Application Specification

114-2124

Hand Tools — Insertion

250 Series—314916-1
250 Series Flag—314919-1

Hand Tools — Extraction

250 Series—314917-1

Ultra-Pod Fully Insulated FASTON Receptacles and Tabs

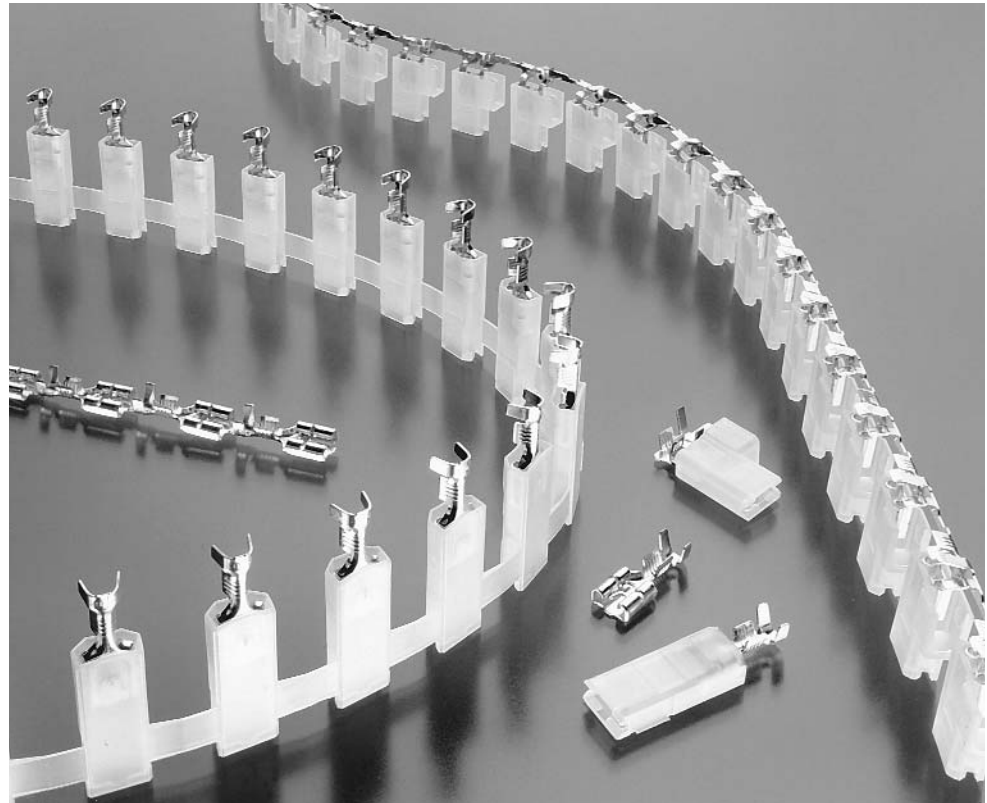

Ultra-Pod Fully Insulated FASTON Receptacles offer the newest in one-step automatic application of insulated quick connects. The unique integral plastic carrier designed specifically for this product allows insulated F-Crimp terminations to be produced quickly and easily. Applied cost savings are attainable with either bench or high-speed automatic termination equipment and the elimination of any secondary insulation operations. Both the crimping of the terminal and the terminal insulating occur in a single stroke of the press and applicator—the crimping on the down-stroke and the insulating on the up-stroke.

The receptacles contained within the Ultra-Pod FASTON Receptacle assemblies are tested and customer qualified and can be immediately used in existing applications where insulation has been accomplished by other means. The low insertion force design provides easier tab insertion, reduces operator fatigue and improves the productivity and reliability of the end assembly operation.

The insulating housing is produced by a unique molding process which provides an integral carrier and eliminates the crimp location problems related to secondary carriers. This housing, produced from 130°C rated 6/6 nylon,

covers the FASTON receptacle sufficiently to provide for use in 600-volt applications. Most importantly, this insulating system helps eliminate the workplace hazards and labor costs of chemically expanded or heat shrink tubing.

Depending on production requirements, Tyco Electronics provides a complete selection of terminating equipment from bench press to automatic lead maker.

Ultra-Pod Fully Insulated FASTON Receptacles and Tabs (Continued)

Insulation Support

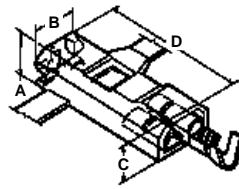

| Description | Wire Range | Ins. Dia. Range | Dimensions | | | | Mating Tab | UL 94 ¹ | Color | Material and Finish | Part Numbers | | | | | | |
|-------------|------------------------|------------------------|--------------|--------------|---------------|---------------|--------------|--------------------|---------|---------------------|---------------------|-----------------------|--|------------------|------------------|-----------------------|-----------------------|
| | | | A | B | C | D | | | | | | | | | | | |
| .110 Series | 22-18 | .080-.120 2.03-3.05 | .151 3.83 | .224 5.69 | .205 5.21 | .805 20.45 | .020 0.51 | V-2 | Natural | Brass | 521228-1 | | | | | | |
| | | | | | | | | | | | | | | Tin-Plated Brass | 521228-2 | | |
| | | | | | | | | | | | | | | | Brass | 521436-1 | |
| | | | | | | | | | | | | | | | Tin-Plated Brass | 521436-2 | |
| | | | | | | | | | | | | | | | Brass | 521437-1 ² | |
| | | | | | | | | | | | | | | | Tin-Plated Brass | 521437-2 ² | |
| .187 Series | 20-16 | .090-.130 2.29-3.30 | .170 4.32 | .295 7.49 | .200 5.08 | .775 19.68 | .020 0.51 | V-2 | Natural | Brass | 520973-1 | | | | | | |
| | | | | | | | | | | | | | | Tin-Plated Brass | 520973-2 | | |
| | | | | | | | | | | | | | | | Brass | 521225-1 | |
| | | | | | | | | | | | | | | | Tin-Plated Brass | 521225-2 | |
| | 18-16 or 2-18 | (2) .105 Max. 2.67 | .170 5.33 | .295 7.49 | .200 5.08 | .775 19.68 | .020 0.51 | | V-2 | Natural | Brass | 520982-1 | | | | | |
| | | | | | | | | | | | | | | | Tin-Plated Brass | 520982-2 | |
| | | | | | | | | | | | | | | | | Brass | 521284-1 |
| | | | | | | | | | | | | | | | | Tin-Plated Brass | 521284-2 |
| | | | | | | | | | | | | | | | | Brass | 521293-1 ⁴ |
| | | | | | | | | | | | | | | | | Tin-Plated Brass | 521293-2 ⁴ |
| .250 Series | 22-18 | .090-.130 2.29-3.30 | .195 4.95 | .370 9.40 | .225 5.72 | .945 24.00 | .032 0.81 | | V-2 | Natural | Brass | 520988-1 | | | | | |
| | | | | | | | | | | | | | | | Tin-Plated Brass | 520988-2 | |
| | | | | | | | | | | | | | | | | Brass | 521368-1 |
| | | | | | | | | | | | | | | | | Tin-Plated Brass | 521368-2 |
| | 18-14 | .120-.170 3.05-4.32 | .195 4.95 | .370 9.40 | .225 5.72 | .945 24.00 | .032 0.81 | | V-2 | Natural | Brass | 520963-1 | | | | | |
| | | | | | | | | | | | | | | | Tin-Plated Brass | 520963-2 | |
| | | | | | | | | | | | | | | | | Brass | 521367-1 |
| | | | | | | | | | | | | | | | | Tin-Plated Brass | 521367-2 |
| | 18-14 or 2-18 | (2) .105 Max. 2.67 | .195 4.95 | .370 9.40 | .225 5.72 | .945 24.00 | .032 0.81 | | V-2 | Black | Nickel Plated Steel | 521011-2 ³ | | | | | |
| | | | | | | | | | | | | | | | Brass | 521637-1 | |
| | | | | | | | | | | | | | | | | Tin-Plated Brass | 521637-2 |
| | | | | | | | | | | | | | | | | Brass | 521632-1 |
| 14-10 | .130-.180 3.30-4.57 | .195 4.95 | .370 9.40 | .225 5.72 | .945 24.00 | .032 0.81 | | V-2 | Natural | Brass | 520974-1 | | | | | | |
| | | | | | | | | | | | | | | Tin-Plated Brass | 520974-2 | | |
| | | | | | | | | | | | | | | | Brass | 521366-1 | |
| | | | | | | | | | | | | | | | Tin-Plated Brass | 521366-2 | |

¹ Flammability rating of plastic material.
² 150°C rated nylon.
³ UL Recognized.
⁴ UL pending for double wire termination.

Flag Insulation Support

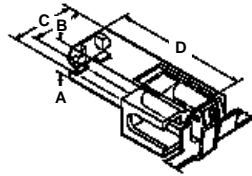

Ultra-Pod Fully Insulated FASTON Receptacles and Tabs

| Description | Wire Range | Ins. Dia. Range | Dimensions | | | | Mating Tab | UL 94 ¹ | Color | Material and Finish | Part Numbers |
|------------------------------|------------------------------|------------------------|--------------|---------------|---------------|---------------|--------------|--------------------|---------------------|-----------------------|-----------------------|
| | | | A | B | C | D | | | | | |
| .187 Series | 22-18 | .060-.110 1.52-2.79 | .170 4.32 | .295 7.49 | .485 12.32 | .680 17.27 | .020 0.51 | V-2 | Natural | Brass | 521470-1 |
| | | | | | | | | | | Tin-Plated Brass | 521470-2 |
| | | | | | | | | | Natural | Brass | 521596-1 |
| | | | | | | | | | | Tin-Plated Brass | 521596-2 |
| | | | | | | | | | Natural | Brass | 521598-1 |
| | | | | | | | | | | Tin-Plated Brass | 521598-2 |
| | 18-14 (2) 20 or (2) 18 | (2) .105 Max. 2.66 | .170 4.32 | .295 7.49 | .485 12.32 | .680 17.27 | .032 0.81 | V-2 | Natural | Brass | 521598-1 |
| | | | | | | | | | | Tin-Plated Brass | 521598-2 |
| | | | | | | | | | Natural | Brass | 521600-1 |
| | | | | | | | | | | Tin-Plated Brass | 521600-2 |
| | | | | | | | | | Natural | Brass | 521471-1 ² |
| | | | | | | | | | | Tin-Plated Brass | 521471-2 ² |
| .250 Series | 22-18 | .050-.100 1.27-2.54 | .200 5.08 | .370 9.40 | .585 14.86 | .680 17.27 | .032 0.81 | V-2 | Natural | Brass | 521050-1 |
| | | | | | | | | | | Tin-Plated Brass | 521050-2 |
| | | | | | | | | V-0 | Natural | Brass | 521411-1 |
| | Tin-Plated Brass | 521411-2 | | | | | | | | | |
| | 18-14 | (2) .105 Max. 2.66 | .200 5.08 | .370 9.40 | .585 14.86 | .680 17.27 | .032 0.81 | V-2 | Natural | Brass | 520971-1 |
| | | | | | | | | | Tin-Plated Brass | 520971-2 | |
| Black | | | | | | | | | Tin-Plated Brass | 520971-4 | |
| 18-14 (2) 20 or (2) 18 | (2) .105 Max. 2.66 | .200 5.08 | .370 9.40 | .585 14.86 | .680 17.27 | .032 0.81 | V-0 | Natural | Nickel Plated Steel | 521087-1 ³ | |
| | | | | | | | | | Brass | 521282-1 | |
| | | | | | | | | | Tin-Plated Brass | 521282-2 | |
| 18-14 (2) 20 or (2) 18 | (2) .105 Max. 2.66 | .200 5.08 | .370 9.40 | .585 14.86 | .680 17.27 | .032 0.81 | V-2 | Natural | Brass | 521112-1 | |
| | | | | | | | | | Brass | 521633-1 | |
| | | | | | | | V-0 | Natural | Tin-Plated Brass | 521633-2 | |

¹ Flammability rating of plastic material.
² UL pending for double wire terminations.
³ No UL or CSA approvals.

Ultra-Pod Fully Insulated FASTON Receptacles and Tabs (Continued)

Positive Lock Insulation Support

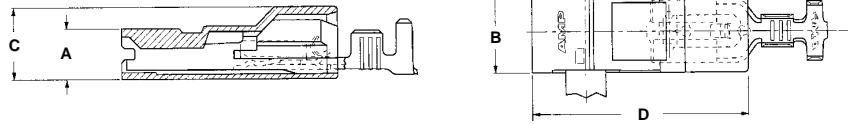

| Description | Wire Range | Ins. Dia. Range | Dimensions | | | | Mating Tab | UL 94 ¹ | Color | Material and Finish | Part Numbers |
|-------------|------------|------------------------|--------------|--------------|--------------|---------------|--------------|--------------------|---------|---------------------|-----------------------|
| | | | A | B | C | D | | | | | |
| .187 Series | 18-14 | .110-.180 2.79-4.57 | .186 4.72 | .307 7.80 | .265 6.73 | .812 20.62 | .020 0.51 | V-2 | Natural | Brass | 521271-1 ² |
| | | | | | | | | | | Tin-Plated Brass | 521271-2 ² |
| | | | | | | | | | | Tin-Plated Brass | 521212-2 ² |
| | | | | | | | | | | Brass | 521213-1 ² |
| .250 Series | 18-14 | .110-.180 2.79-4.57 | .205 5.21 | .370 9.40 | .245 6.22 | .950 24.13 | .032 0.81 | V-2 | Natural | Tin-Plated Brass | 521213-2 ² |
| | | | | | | | | | | Brass | 521317-1 ² |
| | | | | | | | | | | Tin-Plated Brass | 521317-2 ² |
| | | | | | | | | | | Brass | 521317-2 ² |

¹ Flammability rating of plastic material.
² UL Recognized, CSA Certified

Tabs Insulation Support

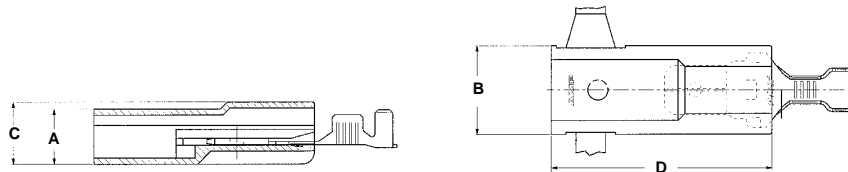

| Description | Wire Range | Ins. Dia. Range | Dimensions | | | | Tab | UL 94 ¹ | Color | Material and Finish | Part Numbers |
|-------------|------------|------------------------|--------------|---------------|--------------|----------------|--------------|--------------------|---------|---------------------|-----------------------|
| | | | A | B | C | D | | | | | |
| .250 Series | 18-14 | .130-.180 3.30-4.57 | .275 6.99 | .450 11.43 | .310 7.87 | 1.120 28.45 | .032 0.81 | V-2 | Natural | Brass | 521217-1 |
| | | | | | | | | | | Tin-Plated Brass | 521217-2 |
| | | | | | | | | | | Brass | 521451-1 |
| | | | | | | | | | | Tin-Plated Brass | 521451-2 |
| | 12-10 | .150-.200 3.81-5.08 | .275 6.99 | .450 11.43 | .310 7.87 | 1.120 28.45 | .032 0.81 | V-2 | Natural | Brass | 521227-1 ² |
| | | | | | | | | | | Tin-Plated Brass | 521227-2 ² |

¹ Flammability rating of plastic material.
² No UL or CSA approvals

Ultra-Pod Fully Insulated FASTON Receptacles and Tabs

Electronics

Product Facts

- Pre-insulated terminal designed for complete and uniformed reliability in the most difficult circuit environment
- Consists of an unplated or tin-plated brass body or a tin-plated phosphor bronze body with a specially designed copper sleeve and insulation sleeve fitted over the terminal barrel
- Design of the tool dies and construction of the terminal insures uniform insulation thickness under crimping pressure, transmitting this pressure evenly to the center of the crimp area

The Tyco Electronics Mated Tool/Terminal Concept

- Tyco Electronics compression crimping produces crimps for a given size wire and terminal that are precisely alike in appearance and performance
- Terminal and the crimping tool are designed as precisely matched devices
- Dies are precision-engineered from the finest hard-metal alloys
- Crimping pressure is controlled by a ratchet device on the hand tool or a corresponding pre-calibration in the crimping jaws of Tyco Electronics automated crimping machines

The Crimp

- Crimping pressure does not overstress nor understress the terminal barrel — machined dies fully bottom to the precise crimp height
- Resulting termination is free of contamination
- Resistant to most shock and critical environments
- Tensile strength approaches that of the wire itself

PIDG FASTON Receptacles and Tabs

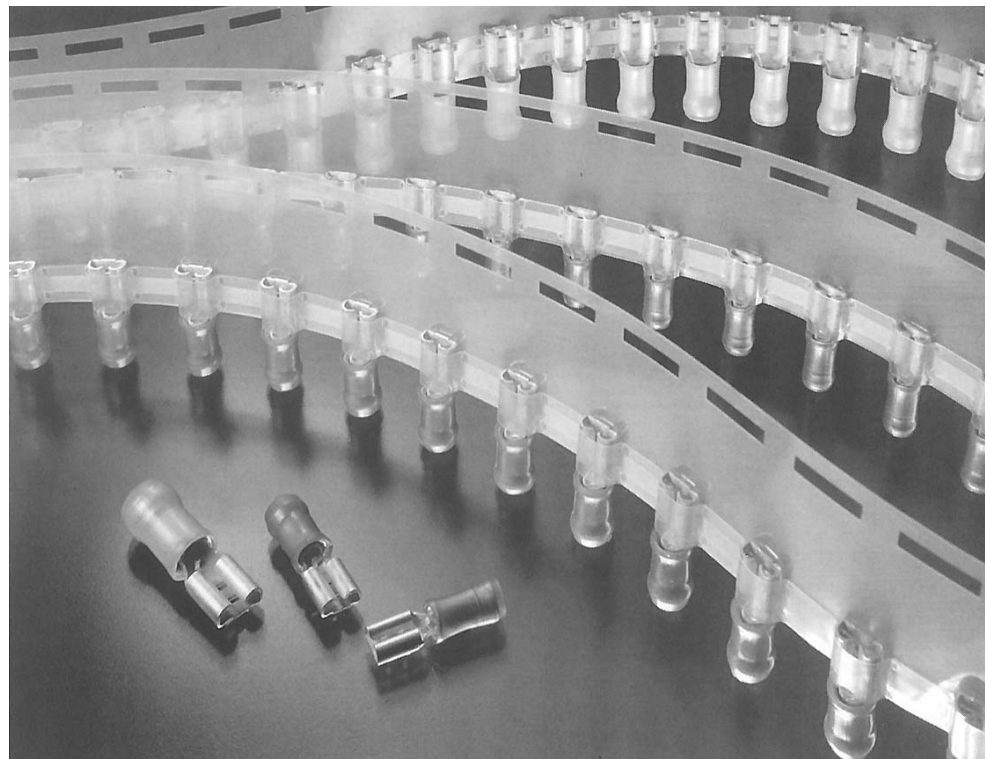

Here is a pre-insulated terminal designed for complete and uniform reliability in most difficult circuit environments. Each PIDG Terminal consists of a tin-plated brass body with a specially designed copper sleeve and insulation sleeve fitted over the terminal barrel. The design of the tool dies and the construction of the terminal promotes uniform insulation thickness under crimping pressure, transmitting this pressure evenly to the center of the crimp area.



Tyco Electronics compression crimping produces crimps for a given size wire and terminal that are precisely alike in appearance and performance. This is a calculated result made possible by designing the terminal and the crimping tool as precisely matched devices. The dies are precision-engineered from the finest hard-metal alloys. Crimping pressure is controlled by a ratchet device on the hand tool or a corresponding pre-

calibration in the crimping jaws of Tyco Electronics automated crimping machines.

Crimping pressure can neither over-stress nor understress the terminal barrel — machined dies fully bottom to the precise crimp height required.

The resulting termination is free of contamination, is resistant to shock and critical environments, and its tensile strength approaches that of the wire itself.

Temperature Rating: 105° C

| Wire Range |  E66717 Recognized |  LR7189 Certified |
|------------|---|---|
| 22-16 | 22-16 Stranded | 300 V Max., 105°C Max. ¹ |
| 16-14 | 16-14 Stranded | |
| 12-10 | 12-10 Stranded | |

¹ UL and CSA — Nylon.

PIDG FASTON
Receptacles and Tabs

PIDG FASTON Receptacles and Tabs (Continued)

Receptacles

Receptacle Style

- A** — No dimple with wire stop
- B** — Dimple with wire stop
- C** — No dimple, no wire stop

Material

- Insulation** — Nylon
- Receptacle Body** — Brass per ASTM B-36 or Phosphor Bronze per ASTM B-139
- Plating** — Tin per MIL-T-10727 except where noted.
- Metallic Sleeve** — Copper per ASTM B-152
- Plating** — Tin per MIL-T-10727

Related Product Data

Application Tooling — reference page 73 of Catalog 82042 for tooling

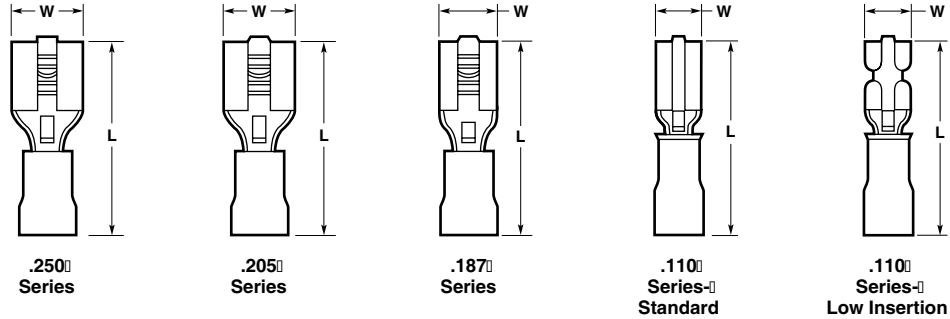

| Series | Wire Size Circular Mils [mm ²] | Style | Dimensions | | Terminal Insulation Color | Wire Insulation Diameter Max. | Recept. Matl. | Stock Thk. | Fits Tab Thk. | Part Numbers | | |
|--------------------------------------|--|--------------|----------------|----------------|---------------------------------|--|------------------|---------------|-----------------------|------------------------|-----------------------|-----------------------|
| | | | W Nom. | L Max. | | | | | | Loose Piece | Tape Mounted | Strip Form |
| .250 | 22-18 509-1,900 [0.26-0.96] | B | .300 7.62 | .900 22.86 | Red | .140 3.56 | Brass | .018 0.46 | .032 0.81 | 640903-1* | 640903-2 | 640902-1 |
| | | | | | Red | .140 3.56 | Brass | .018 0.46 | .032 0.81 | 55675-1 ² | 55675-2 ² | — |
| | 16-14 2,050-5,180 [1.04-2.62] | B | .300 7.62 | .900 22.86 | Blue | .170 4.32 | Brass | .018 0.46 | .032 0.81 | 640905-1* | 640905-2 | 640904-1 |
| | 14-12 3,831-6,470 ¹ [1.94-3.28] | B | .300 7.62 | 1.012 25.70 | Blue | .250 6.35 | Brass | .018 0.46 | .032 0.81 | 696108-1 | 696108-2 | 696109-1 |
| | | | | | Green | .250 6.35 | Brass | .018 0.46 | .032 0.81 | 42844-1 ^{††} | 42844-3 [†] | 60544-3 [†] |
| | | | | | Green | .250 6.35 | Phos. Brz. | .018 0.46 | .032 0.81 | 42844-2 ^{††} | — | — |
| 12-10 5,180-13,100 [2.62-6.64] | B | .300 7.62 | 1.012 25.70 | Yellow | .250 6.35 | Brass | .018 0.46 | .032 0.81 | 640907-1* | 640907-2 | 640906-1 | |
| | | | | Yellow | .250 6.35 | Phos. Brz. | .018 0.46 | .032 0.81 | 61198-2 ^{3†} | 61198-4 ^{4†} | — | |
| .250 Low Insertion | 22-18 509-1,900 [0.26-0.96] | B | .300 7.62 | .900 22.86 | Red | .145 3.68 | Brass | .016 0.41 | .032 0.81 | 184262-1 | 184262-2 | 184261-1 |
| | 16-14 2,050-5,180 [1.04-2.62] | B | .300 7.62 | .900 22.86 | Blue | .173 4.39 | Brass | .016 0.41 | .032 0.81 | 184265-1 | 184265-2 | 184264-1 |
| .205 | 22-18 509-1,900 [0.26-0.96] | B | .250 6.35 | .800 20.32 | Red | .135 3.43 | Brass | .016 0.41 | .020 0.51 | 696018-1 | 696018-2 | — |
| | | | | | Red | .140 3.56 | Brass | .016 0.41 | .020 0.51 | 640909-1* | 640909-2 | 640908-1 |
| | | | | | Red/Black | .140 3.56 | Brass | .016 0.41 | .020 0.51 | 640174-1 | — | — |
| | | | | | Red | .140 3.56 | Brass | .016 0.41 | .032 0.81 | 640911-1* | 640911-2 | 640910-1 |
| | 16-14 2,050-5,180 [1.04-2.62] | B | .250 6.35 | .800 20.32 | Blue | .170 4.32 | Brass | .016 0.41 | .020 0.51 | 640913-1* | 640913-2 | — |
| | | | | | Blue | .170 4.32 | Brass | .016 0.41 | .032 0.81 | 640915-1* | 640915-2 | — |
| .187 | 26-24 238-475 [0.12-0.24] | B | .230 5.84 | .700 17.78 | Yellow | .082 2.08 | Brass | .016 0.41 | .020 0.51 | 641321-1 ^{††} | 641321-2 [†] | 641320-1 [†] |
| | 22-18 509-1,900 [0.26-0.96] | B | .230 5.84 | .800 20.32 | Red | .140 3.56 | Brass | .016 0.41 | .020 0.51 | 640917-1* | 640917-2 | 640916-1 |
| | | | | Red | .140 3.56 | Brass | .016 0.41 | .040 1.02 | — | 640578-2 [†] | — | |

† Not UL or CSA approved or listed.

* Available in small packaging quantities.

¹ Wire range is limited as noted.

² Unplated receptacle body.

³ Requires Tool 90276-2

⁴ Requires Die 90281-1

Receptacles (Continued)

| Series | Wire Size Circular Mills [mm ²] | Style | Dimensions | | Terminal Insulation Color | Wire Insulation Diameter Max. | Recept. Matl. | Stock Thk. | Fits Tab Thk. | Part Numbers | | | |
|--------------------------|---|-------|--------------|---------------|---------------------------------|--|------------------|---------------|---------------------|----------------|-----------------|---------------|----------|
| | | | W Nom. | L Max. | | | | | | Loose Piece | Tape Mounted | Strip Form | |
| .187 | 16-14 2,050-5,180 [1.04-2.62] | B | .230 5.84 | .800 20.32 | Blue | .170 4.32 | Brass | .016 0.41 | .020 0.51 | 640919-1* | 640919-2 | 640918-1 | |
| | | | .230 5.84 | .900 22.86 | Blue | .250 6.35 | Brass | .016 0.41 | .032 0.81 | 696108-1† | 696108-2† | — | |
| .187 Low Insertion | 22-18 509-1,900 [0.26-0.96] | B | .235 5.84 | .800 20.32 | Blue | .170 4.32 | Brass | .016 0.41 | .032 0.81 | 184235-1 | 184235-2 | 184234-1 | |
| | | | .230 5.84 | .800 22.86 | Red | .145 3.68 | Brass | .016 0.41 | .032 0.81 | 184268-1† | 184268-2† | 184267-1† | |
| .110 Standard | 22-18 509-1,900 [0.26-0.96] | B | .148 3.76 | .734 18.64 | Natural | .110 2.79 | Brass | .012 0.30 | .016 0.41 | 61048-1*† | 61048-2† | — | |
| | | | .148 3.76 | .734 18.64 | Natural | .110 2.79 | Brass | .012 0.30 | .020 0.51 | 61060-1*† | 61060-2† | 61059-2† | |
| | | | .148 3.76 | .734 18.64 | Natural | .110 2.79 | Brass | .012 0.30 | .032 0.81 | 60894-1*† | 60894-2† | 60893-2† | |
| | | | .148 3.76 | .734 18.64 | Black | .110 2.79 | Brass | .012 0.30 | .032 0.81 | — | 61678-2† | — | |
| .110 Low Insertion | 26-24 238-475 [0.12-0.24] | A | .160 4.06 | .700 17.78 | Yellow | .082 2.08 | Brass | .016 0.41 | .020 0.51 | 641324-1† | 641324-2† | — | |
| | | | .160 4.06 | .796 20.22 | Red | .140 3.56 | Brass | .016 0.41 | .012 0.30 | — | — | 350871-1† | |
| .110 Low Insertion | 22-18 509-1,900 [0.26-0.96] | A | .160 4.06 | .800 20.32 | Red | .140 3.56 | Brass | .016 0.41 | .016 0.41 | .016 0.41 | 640921-1 | 640921-2 | — |
| | | | .160 4.06 | .800 20.32 | Red | .140 3.56 | Brass | .016 0.41 | .020 0.51 | .032 0.81 | 640923-1* | 640923-2 | 640922-1 |
| | | | .160 4.06 | .800 20.32 | Red | .140 3.56 | Brass | .016 0.41 | .020 0.51 | .032 0.81 | 640925-1* | 640925-2 | 640924-1 |
| .110 Low Insertion | 16-14 2,050-5,180 [1.04-2.62] | A | .160 4.06 | .800 20.32 | Blue | .170 4.32 | Brass | .016 0.41 | .020 0.51 | .032 0.81 | 640929-1* | 640929-2 | — |
| | | | .160 4.06 | .800 20.32 | Blue | .170 4.32 | Brass | .016 0.41 | .016 0.41 | .032 0.81 | 640931-1* | 640931-2 | — |
| | | | .160 4.06 | .800 20.32 | Blue | .170 4.32 | Brass | .016 0.41 | .016 0.41 | .032 0.81 | 640927-1 | 640927-2 | — |
| .110 Low Insertion | 16-14 2,050-5,180 [1.04-2.62] | C | .160 4.06 | .796 20.19 | Blue | .170 4.32 | Brass | .016 0.41 | .032 0.81 | 641317-1 | — | — | |

†Not UL or CSA approved or listed.
*Available in small packaging quantities.

PIDG FASTON Receptacles and Tabs

Receptacles
(Insulation Restricting)

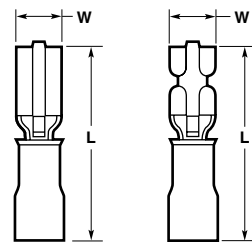

.110□ Series-□
Standard .110□ Series-□
Low Insertion

Material

- Insulation — Nylon
- Receptacle Body — Brass per ASTM B-36
- Receptacle Style B — Dimple with wire stop
- Plating — Tin per MIL-T-10727
- Metallic Sleeve — Copper per ASTM B-152
- Plating — Tin per MIL-T-10727 or Nickel per QQ-N-290

Related Product Data

Application Tooling — reference page 73 of Catalog 82042 for tooling

| Series | Wire Size Circular Mills [mm ²] | Style | Dimensions | | Terminal Insulation Color | Wire Insulation Diameter Max. | Recept. Matl. | Stock Thk. | Fits Tab Thk. | Part Numbers | | |
|-----------------------|---|-------|--------------|---------------|---------------------------------|--|------------------|---------------|---------------------|----------------|-----------------|---------------|
| | | | W Nom. | L Max. | | | | | | Loose Piece | Tape Mounted | Strip Form |
| .110 Standard | 22 754 [0.38] | B | .148 3.76 | .780 19.81 | Red/ Green | .040-.080 1.02-2.03 | Brass | .012 0.30 | .016 0.41 | 55319-1 | 55319-3 | — |
| .110 Low Insertion | 16 2,800 [1.42] | B | .160 4.06 | .821 20.85 | Blue/ Blue | .064-.130 1.63-3.30 | Brass | .016 0.41 | .016 0.41 | — | 55318-3 | — |

PIDG FASTON Receptacles and Tabs (Continued)

Insulated FASTON — 26 to 10 AWG Wire Range

| Wire Size | Hand Tool | Tools for Tape Mounted Terminations | | | Tools for Strip Form Terminations |
|-----------------|-----------|---|--|---|---|
| | | Tape Dies for 69875 AMP-TAPETRONIC No Applicator Required | Tape Dies for AMP-O-LECTRIC ¹ Model "G" Applicator 567200-3 | Tape Dies for AMPOMATOR CLS III G, CLS IV Applicator 687658-1 | AMPOMATOR CLS III G, CLS IV Applicators |
| 26-24 | 48518-2 | 69877-2 | 69877-2 | 69877-2 | — |
| 22-18 | 59824-1 | 59826-1 | 59826-1* | 59826-1 | 466788-3 ² |
| 22-18 (Natural) | 90185-1 | 90248-2 | 90248-2 | 90248-2 | 466554-3 |
| 16-14 | 59824-1 | 59827-1 | 59827-1* | 59827-1 | 466789-3 ² |
| 14-12 | 90246-1 | 90240-2 | 90240-2 | 90240-2 | — |
| 12-10 | 59824-1 | 59828-1 | 59828-1* | 59828-1 | 466790-4 ² |

*Only UL and CSA approved.
¹AMP-O-LECTRIC Model "K" 565435-5 uses applicator 567200-2.
²Die included with applicator.

Positive Lock Receptacle
Low Insertion Force with
Locking Device

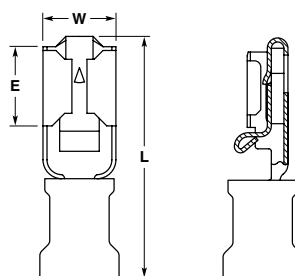

| Description | Wire Range | Ins. Dia. Max. | Dimensions | | | Material and Finish | Part Number |
|---------------------|------------|----------------|------------|-------|------|----------------------------|-------------|
| | | | W | L | E | | |
| For Tab .250 x .032 | 16-14 | .190 4.83 | .362 | .850 | .315 | Tin-Plated Brass | 165536-1 |
| | | | 9.19 | 21.59 | 8.00 | Tin-Plated Phosphor Bronze | 165536-2 |

Tab

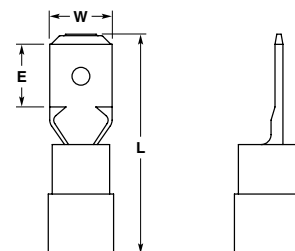

| Description | Wire Range | Ins. Dia. Max. | Dimensions | | | Material and Finish | Part Number |
|----------------------------|------------|----------------|------------|-------|------|---------------------|-------------|
| | | | W | L | E | | |
| For Receptacle .250 x .032 | 22-18 | .157 3.99 | .250 | .866 | .300 | Tin-Plated Brass | 696362-1 |
| | | | 6.35 | 22.00 | 7.62 | | |
| | 16-14 | .197 5.00 | .250 | .866 | .300 | Tin-Plated Brass | 696369-1 |
| | 12-10 | .256 6.50 | .250 | .950 | .300 | Tin-Plated Brass | 696372-1 |
| | | | 6.35 | 24.13 | 7.62 | | |

PIDG Flag FASTON

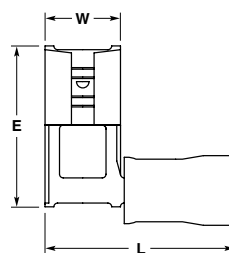

| Description | Wire Range | Ins. Dia. Max. | Dimensions | | | Material and Finish | Part Number |
|---------------------|------------|----------------|------------|-------|-------|---------------------|-------------|
| | | | W | L | E | | |
| For Tab .250 x .032 | 22-18 | .134 3.40 | .300 | .720 | .610 | Tin-Plated Brass | 156667-1 |
| | | | 7.62 | 18.29 | 15.49 | | |
| | 16-14 | .157 3.99 | .300 | .720 | .610 | Tin-Plated Brass | 156666-1 |
| | | | 7.62 | 18.29 | 15.49 | | |

Electronics

PIDG FASTON Receptacles and Tabs (Continued)

Fully Insulated Receptacles

Insulation Sleeve — Nylon

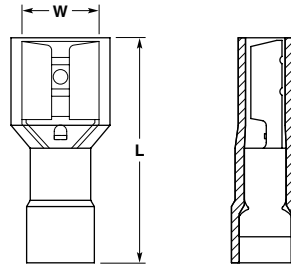

| Description | Wire Range | Ins. Dia. Range | Dimensions | | Material and Finish | Part Number |
|------------------------|------------|-----------------|--------------|---------------|---------------------|-------------|
| | | | W | L | | |
| For Tab .250 x .032 | 22-18 | .128 3.25 | .375 9.53 | .891 22.63 | Tin-Plated Brass | 696357-1 |
| | 16-14 | .165 4.19 | .375 9.53 | .881 22.38 | Tin-Plated Brass | 696366-1 |
| | 12-10 | .225 5.72 | .375 9.53 | .998 25.35 | Tin-Plated Brass | 696371-1 |

Piggyback FASTON Receptacles

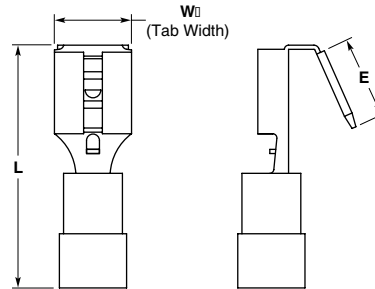

| Description | Wire Range | Ins. Dia. Range | Dimensions | | | Material and Finish | Part Number |
|------------------------|------------|-----------------|--------------|---------------|--------------|---------------------|-------------|
| | | | W | L | E | | |
| For Tab .250 x .032 | 22-18 | .157 3.99 | .250 6.35 | .905 22.99 | .323 8.20 | Tin-Plated Brass | 696363-1* |
| | 16-14 | .197 5.00 | .250 6.35 | .905 22.99 | .323 8.20 | Tin-Plated Brass | 696370-1* |
| | 12-10 | .256 6.50 | .250 6.35 | .945 24.00 | .323 8.20 | Tin-Plated Brass | 696373-1* |

* Piggyback FASTON Receptacles must be crimped with Hand Tool 696374-1.

PIDG Budget Line FASTON Receptacles

Material

Insulation — PVC, UL 94V-0

Receptacle Body — Brass

Plating — Tin

Metallic Sleeve — Copper

Plating — Tin

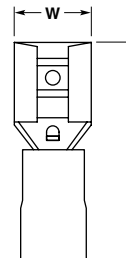

| Series | Wire Size Circular Mils [mm ²] | Dimensions | | Terminal Color | Wire Insulation Diameter Max. | Fits Tab Thk. | Part Numbers | |
|--------|--|--------------|---------------|----------------|-------------------------------|---------------|--------------|--------------|
| | | W Nom. | L Nom. | | | | Loose Piece | Tape Mounted |
| .250 | 22-18 | .300 7.62 | .819 20.80 | Red | .150 3.81 | .032 0.81 | 696301-1 | 696301-2 |
| | 16-14 | .300 7.62 | .819 20.80 | Blue | .185 4.70 | .032 0.81 | 696302-1 | 696302-2 |
| | 16-14 | .300 7.62 | .917 23.29 | Yellow | .244 6.20 | .032 0.81 | 696303-1 | 696303-2 |