

Distributed by:

**JAMECO**<sup>®</sup>  
ELECTRONICS

**www.Jameco.com ♦ 1-800-831-4242**

The content and copyrights of the attached  
material are the property of its owner.

Jameco Part Number 837425

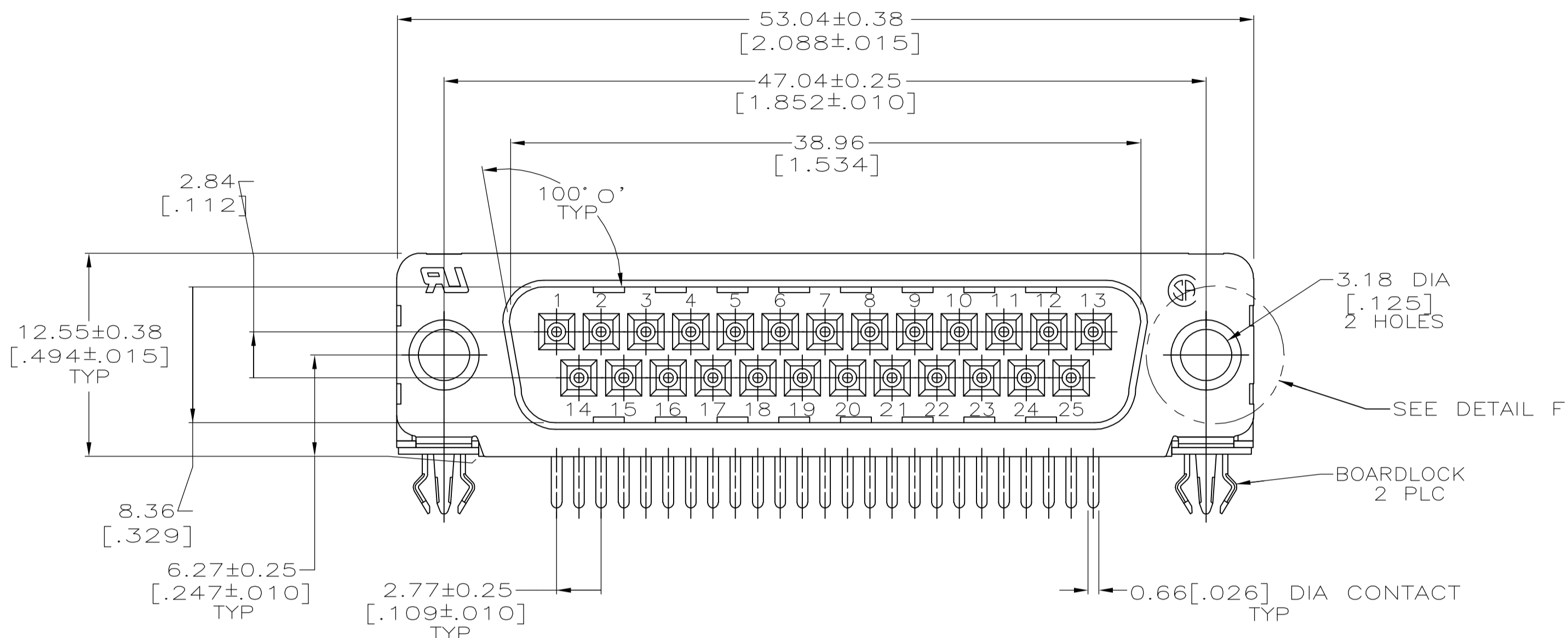

- 1 NYLON OR POLYESTER, FLAME RETARDANT, UL 94V-0 RATED, GLASS FILLED, BLACK.
- 2 BRASS PER MIL-C-50.
- 3 CARBON STEEL PER ASTM A109.
- 4 EYELETS: BRASS; BOARDLOCKS: COPPER ALLOY.
- 5 GOLD PLATING PER MIL-G-45204; NICKEL PLATING PER QQ-N-290; TIN PLATING PER MIL-T-10727; COPPER PLATING PER MIL-C-14550.
- 6 SHELL: 2.54µm[.000100] MIN TIN OVER 1.27µm[.000050] MIN COPPER. EYELETS: 5.08µm[.000200] MIN TIN OVER COPPER FLASH. CONTACTS: SEE TABLE. BOARDLOCKS: SEE TABLE. INSERTS: CLEAR CHROMATE. SCREWLOCKS: CLEAR CHROMATE.
- 7 GOLD PLATED FOR LENGTH OF 3.81 [.150] MIN FROM MATING END, GOLD FLASH IN MATED AREA, 2.54µm [.000100] MIN TIN OR TIN-LEAD FOR A LENGTH OF 3.56[.140] MIN FROM OPPOSITE END, BOTH OVER 1.27µm[.000050] MIN NICKEL.
- 8 GOLD PLATED FOR LENGTH OF 3.81 [.150] MIN FROM MATING END, 0.76µm [.000030] MIN GOLD IN MATED AREA, 2.54µm[.000100] MIN TIN OR TIN-LEAD FOR A LENGTH OF 3.56[.140] MIN FROM OPPOSITE END, BOTH OVER 1.27µm[.000050] MIN NICKEL.
- 9 DIMENSION APPLIES FROM CENTER OF CONTACTS.
- 10 5.08µm[.000200] MIN TIN-LEAD OVER 1.27µm[.000050] MIN NICKEL.
- 11 5.08µm[.000200] MIN TIN OVER 1.27µm[.000050] MIN NICKEL.
- 12 SUPERSEDED BY 747842-2.

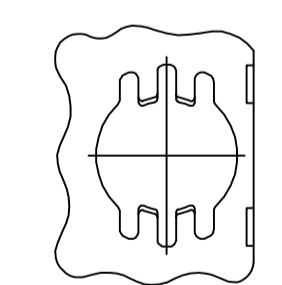
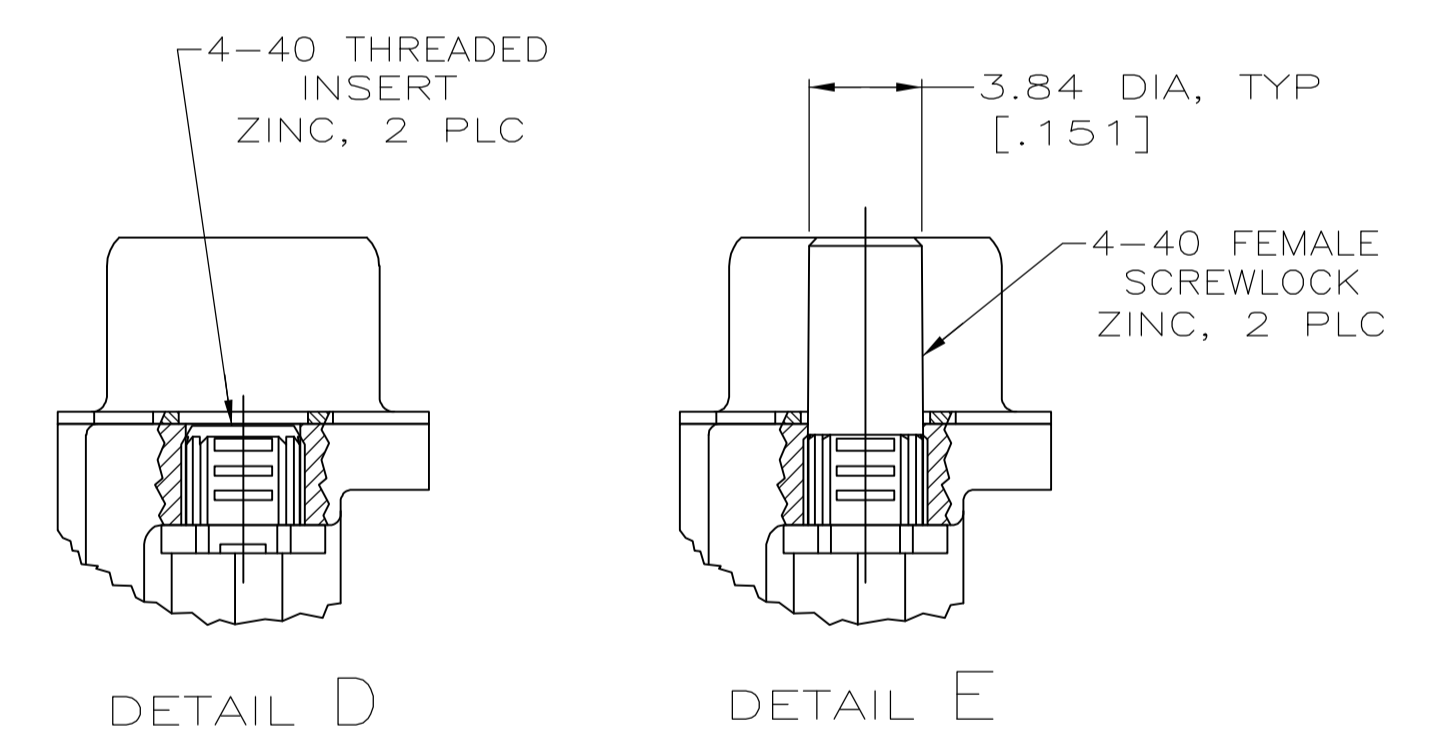
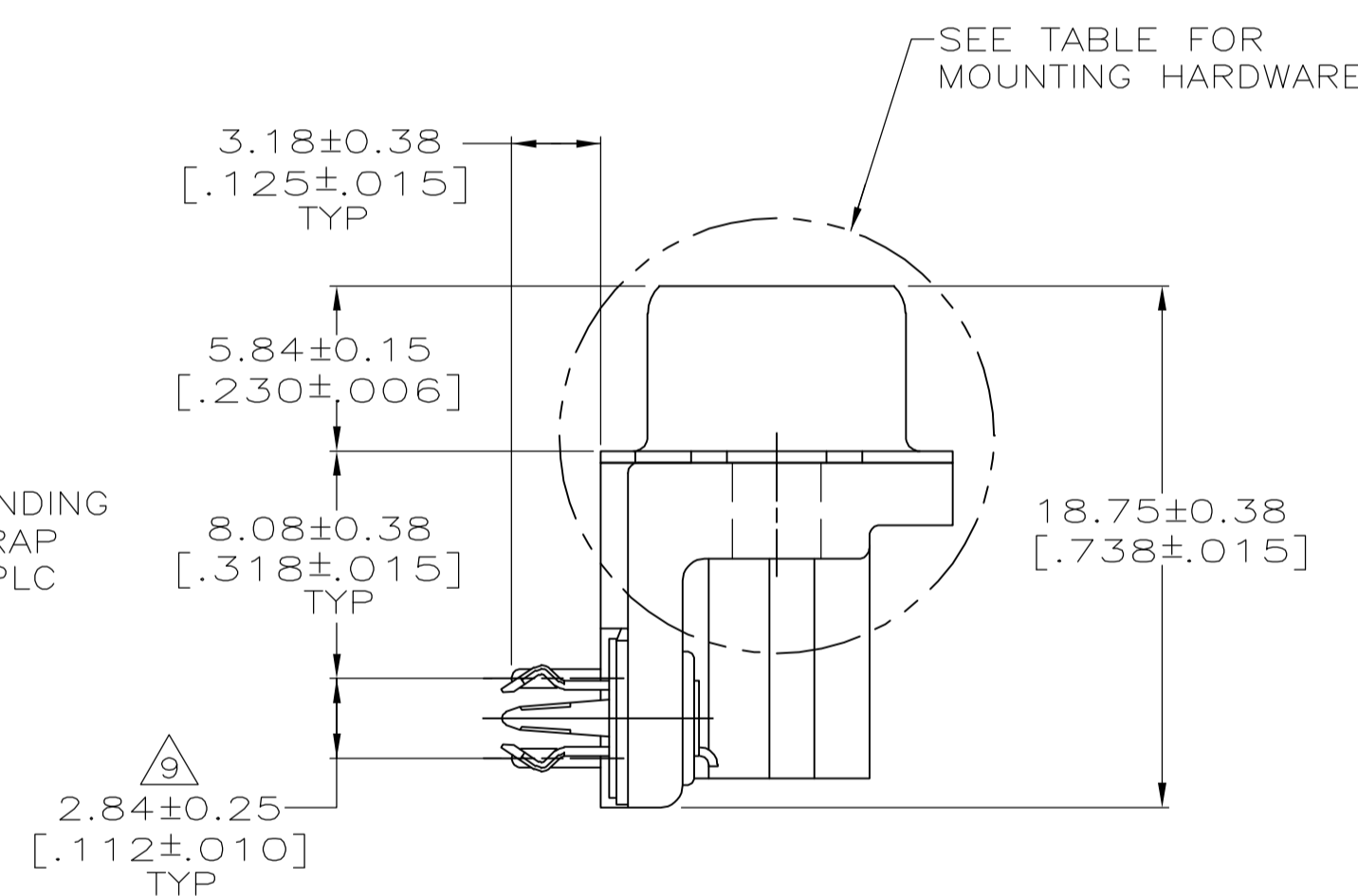
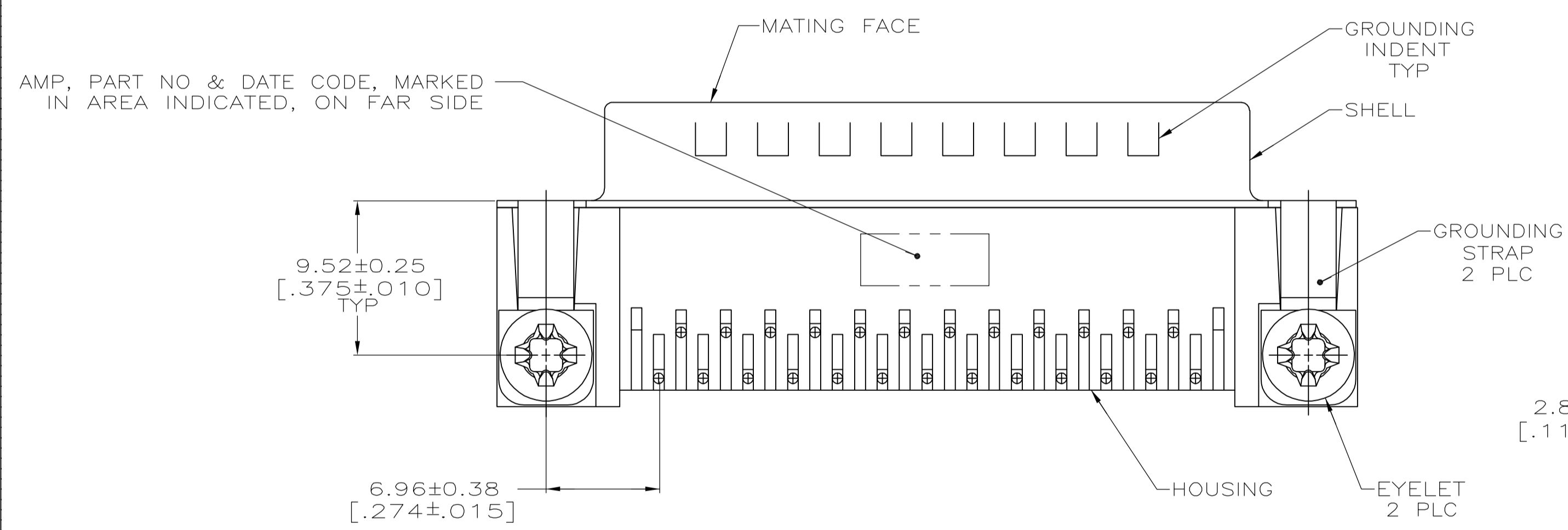

FOR -5 AND -6 ONLY  
 DETAIL F  
 2 PLC

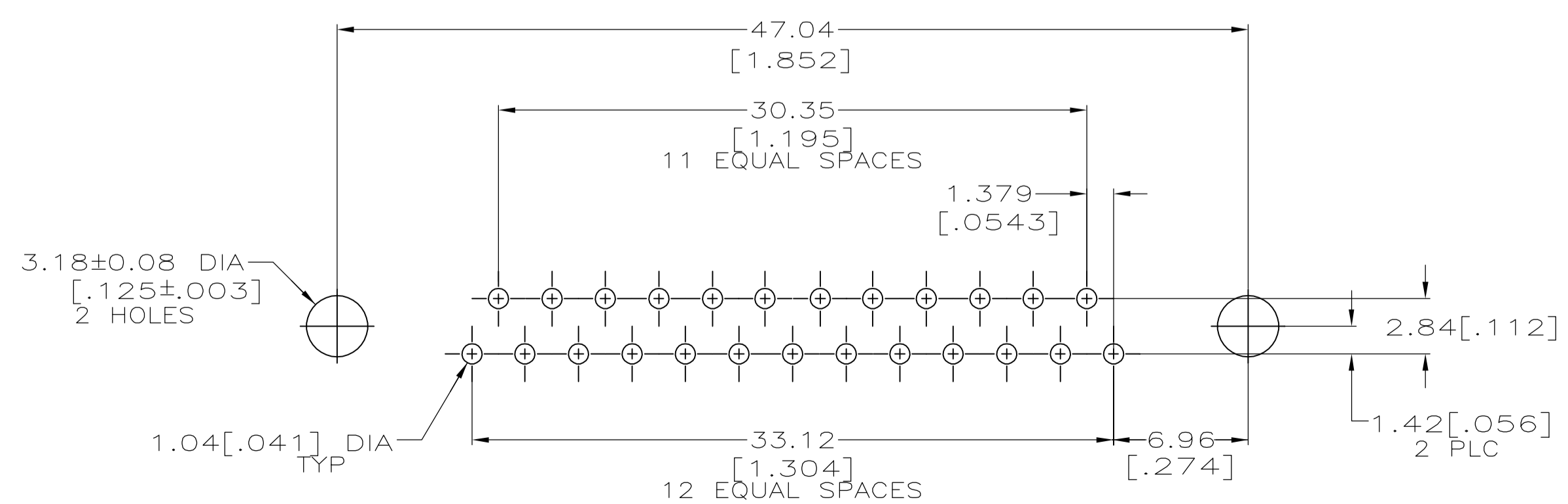

RECOMMENDED P.C. BOARD MOUNTING DIMENSIONS  
 P.C. BOARD THICKNESS: 1.57[.062]

OBSOLETE	SEE DETAIL E	11	8	6-747842-9
	SEE DETAIL D	11	8	6-747842-8
	SEE DETAIL E	10	8	6-747842-7
	SEE DETAIL E	10	8	747842-6
	SEE DETAIL D	10	8	747842-5
		10	8	747842-4
		10	8	747842-3
		10	8	747842-2
		10	8	747842-1
	MOUNTING HARDWARE	BOARDLOCK FINISH	CONTACT FINISH	PART NO

THIS DRAWING IS A CONTROLLED DOCUMENT.		DWN: W.GLENKER 10-5-89	Tyco Electronics Corporation Harrisburg, PA 17105-3608	
DIMENSIONS: INCHES		CHK: R. STONE 2-5-90	PLUG ASSEMBLY, SIZE 3, 25 POSITION, RIGHT ANGLE, FRONT METAL SHELL, .318 SERIES, BOARDLOCKS, AMPLIMITE HD-20	
TOLERANCES UNLESS OTHERWISE SPECIFIED:		APVD: -	PRODUCT SPEC: 108-40025	RESTRICTED TO: -
0 PLC ± -		APPLICATION SPEC: 114-40010	SIZE: A1	DRAWING NO: 00779
1 PLC ± -		WEIGHT: -	SCALE: 4:1	SHEET 1 OF 1
2 PLC ± 0.13[.005]		CUSTOMER DRAWING	REV: P	
3 PLC ± -				
4 PLC ± -				
ANGLES ± -				