

796966-1 Product Details

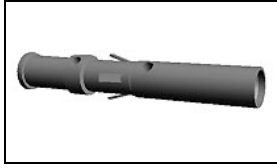

796966-1

TE Internal Number: 796966-1



Multimate

 Always EU RoHS/ELV Compliant (Statement of Compliance)

Product Highlights:

- Contact Type = Socket
- Contact Classification = Power
- Type II Series
- High Current
- Silver Contact Plating, Mating Area, Material

Documentation & Additional Information

Product Drawings:

- [SOCKET ASSY, 18-16 AWG HIGH CURRENT TYPE II/III+](#) (PDF, English)

Catalog Pages/Data Sheets:

- [Power Contacts](#) (PDF, English)
- [AMP Circular Connectors for Commercial Signal & Powe...](#) (PDF, English)

Product Specifications:

- None Available

Application Specifications:

- None Available

Instruction Sheets:

- None Available

CAD Files: (CAD Format & Compression Information)

- [2D Drawing](#) (DXF, Version A)
- [3D Model](#) (IGES, Version A)
- [3D Model](#) (STEP, Version A)

Additional Information:

- [Product Line Information](#)

Related Products:

- [Tooling](#)

Product Features (Please use the Product Drawing for all design activity)

Product Type Features:

- Series = Type II
- [Insulation Support](#) = No
- [Termination Method to Wire/Cable](#) = Crimp
- Wire/Cable Type = Discrete Wire
- Retention Clip = With
- Grade = Commercial

Electrical Characteristics:

- High Current = Yes

Body Features:

- [Wire Range \(mm \[AWG\]\)](#) = 0.80-1.40² [18-16]
- Louvertac Band Material = Beryllium Copper
- Louvertac Band Plating = Gold
- Retention Clip Material = Stainless Steel
- Used With = Econoseal Metrimate Square Grid, Drawer Connectors, CMPC (Circular Multipin Connector), CMC (Circular Metal Connector), CPC Connectors, M Series Connectors, G Series Connectors

Contact Features:

- Contact Type = Socket
- Contact Classification = Power
- [Contact Plating, Mating Area, Material](#) = Silver
- [Contact Base Material](#) = Copper Alloy
- [Contact Size](#) = 16

Industry Standards:

- [RoHS/ELV Compliance](#) = RoHS compliant, ELV compliant
- [Lead Free Solder Processes](#) = Not relevant for lead free process
- RoHS/ELV Compliance History = Always was RoHS compliant

Conditions for Usage:

- [Applies To](#) = Wire/Cable
- Test Current (A) = 23.0

Packaging Features:

- [Packaging Method](#) = Loose Piece/Bulk

Other:

- Brand = AMP
- Comment = Mates with Part Number 193844-1.

THIS DRAWING IS UNPUBLISHED. RELEASED FOR PUBLICATION

© COPYRIGHT BY TYCO ELECTRONICS CORPORATION. ALL RIGHTS RESERVED.

LOC	DIST	REVISIONS					
FT	0	P	LTR	DESCRIPTION	DATE	DWN	APVD
			A	REVISED PER ECO-06-27943	11/29/06	SS	GS

- ① MATERIAL: COPPER ALLOY
- ② FINISH: SOCKET; 200uINCHES MIN. SILVER OVER 50uINCHES MIN. NICKEL BAND; 10uINCHES MIN. GOLD OVER 40 uINCHES MIN. NICKEL.
- ③ WIRE BARREL WILL ACCEPT 18-16 AWG WIRE.
- 4. MATES WITH 796964-1.
- ⑤ WHEN ORDERING CONTACT ASSEMBLIES ON TAPE, ORDER BY PART NUMBER PLUS THE PACKAGING CODE AS FOLLOWS:
A. 5000 PARTS PER REEL ADD PACKAGING CODE: 5MREEL
I.E. ORDER # 796966-2, 5MREEL.

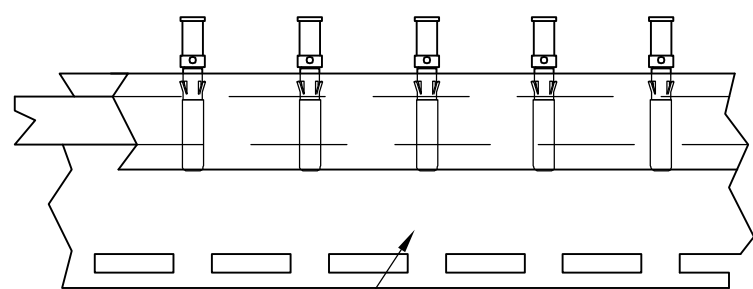
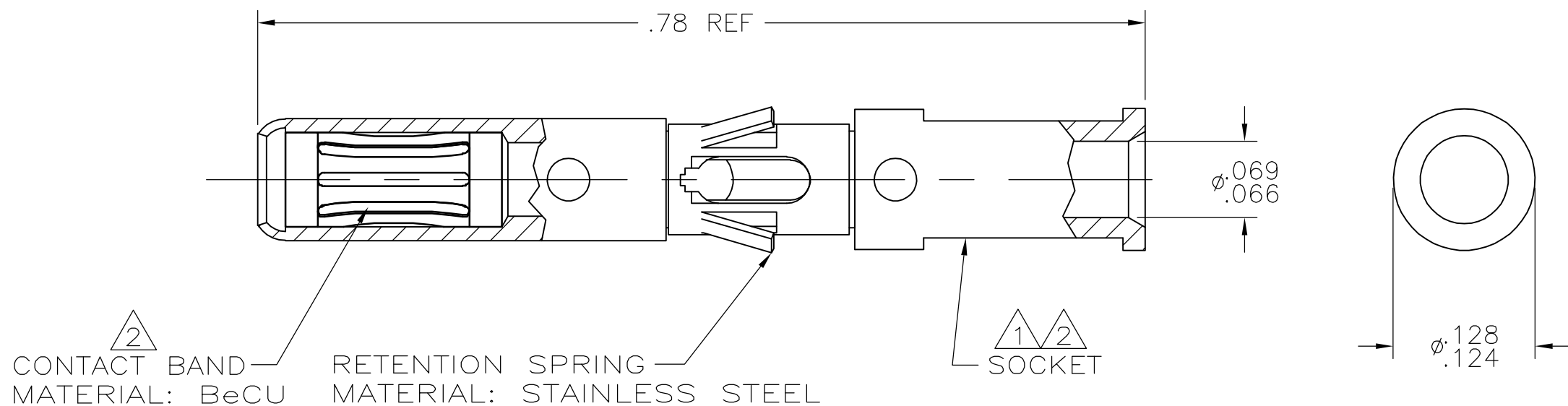

MYLAR TAPE
796966-2 TAPE MTG DETAIL ⑤
SCALE: 1:1

⑤ PRELIMINARY	TAPE MTG (SEE DETAIL)	796966-2
	STANDARD	796966-1
	PACKAGING TYPE	PART NO

THIS DRAWING IS A CONTROLLED DOCUMENT.		DWN S SCHLEGEL 12/19/02	Tyco Electronics Corporation Harrisburg, PA 17105-3608	
DIMENSIONS: INCHES		CHK G STEINHAUER 12/19/02		
TOLERANCES UNLESS OTHERWISE SPECIFIED:		APVD G STEINHAUER 12/19/02	NAME SOCKET ASSY, 18-16 AWG HIGH CURRENT TYPE II/III+	
0 PLC ± -		PRODUCT SPEC -	APPLICATION SPEC -	
1 PLC ± -		SIZE A3	CAGE CODE 00779	DRAWING NO C-796966
2 PLC ± -		WEIGHT -	RESTRICTED TO -	
3 PLC ± -		CUSTOMER DRAWING		
4 PLC ± -		SCALE 8:1	SHEET 1 OF 1	REV A
ANGLES ± -				
FINISH				
① MATERIAL	②			