

THIS DRAWING IS UNPUBLISHED. RELEASED FOR PUBLICATION 2003
 © COPYRIGHT 2003 BY TYCO ELECTRONICS CORPORATION. ALL RIGHTS RESERVED.

LOC	DIST	REVISIONS					
AP	-	P	LTR	DESCRIPTION	DATE	DWN	APVD
			P1	REV PER ECO-09-026444	27NOV09	KK	AEG
			P2	REV. BY ECO-10-006997	09APR10	HC	WLS

CAD
 Pro
 DO NOT REVISE
 EXCEPT BY CAD

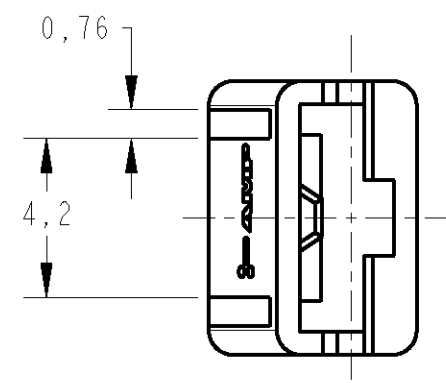
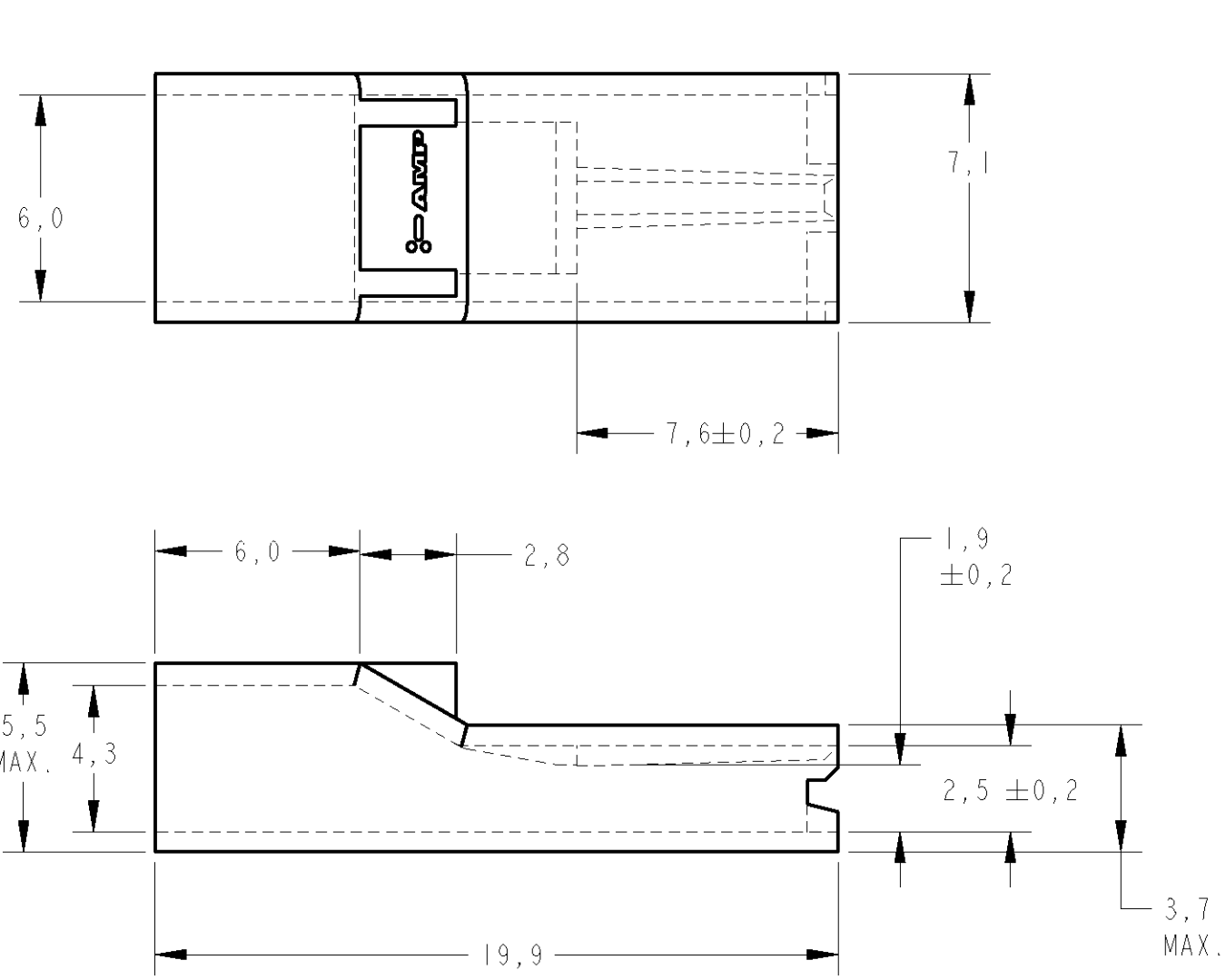

1 - MATÉRIA-PRIMA CONFORME ESPECIFICAÇÃO IEC 60335-1, GWT 750°C, SEM CHAMA.
 RAW MATERIAL ACC. TO SPEC. IEC 60335-1, GWT 750°C, WITHOUT FLAME.

2 - OBSOLETE PARTS: OBSOLETE CIS STREAMLINING PER D.RENAUD/D.SINISI

OBSOLETE
 2

NATURAL		2-880488-2
NATURAL	PA6.6V0 OR PA6.6V0+PA6V0	2-880488-1
AMARELO/YELLOW	PA 6.6	1-880488-5
VERMELHO/RED	PA 6.6	1-880488-4
AZUL/BLUE	PA 6.6	1-880488-3
PRETO/BLACK	PA 6.6	1-880488-2
NATURAL/NATURAL	PA 6.6	1-880488-1
VERMELHO/RED	POLIPROPILENO/POLYPROPYLENE	880488-4
AZUL/BLUE	POLIPROPILENO/POLYPROPYLENE	880488-3
NATURAL/NATURAL	POLIPROPILENO/POLYPROPYLENE	880488-2
PRETO/BLACK	POLIPROPILENO/POLYPROPYLENE	880488-1

FINISH	MATERIAL	PART NUMBER
DWN M.R.BRIZ 05SEP2003 CHK P.L.FARIA 05SEP2003 APVD D.A.OLIVEIRA 05SEP2003 PRODUCT SPEC N/A APPLICATION SPEC N/A WEIGHT -		
TYCO ELECTRONICS do Brasil LTDA. São Paulo, Brasil		
NAME .187 S. FASTON RECEPTACLE HOUSING		
SIZE A3	CAGE CODE 00779	DRAWING NO C-880488
CUSTOMER DRAWING SCALE 5:1 SHEET 1 OF 1 REV P2		

DIMENSIONS: mm		TOLERANCES UNLESS OTHERWISE SPECIFIED:	
		0 PLC ±-	
		1 PLC ±0,5	
		2 PLC ±-	
		3 PLC ±-	
		4 PLC ±-	
		ANGLES ±-	
MATERIAL	SEE TABLE	FINISH	SEE TABLE