

Receptacle Contacts

**Technical Features**

**Material**

Contact: CuNiSi  
Pin Contact: Copper-Alloy  
Cantilever Spring: Stainless Steel

**Contact Finish:**

Tin plated, silver plated,  
gold plated

**Conductor Binding:**

Crimp Technology/  
Insulation Displacement

**Wire Size Range:**

0.14–0.75 mm<sup>2</sup>  
Single Wires (FLR)

**Current Carrying Capacity:**

Up to 7.5 A at 80 °C

**Temperature Range:**

–40 °C ... +120 °C (tin plated)  
–40 °C ... +130 °C (silver plated)  
–40 °C ... +140 °C (gold plated)

**Centerline:**

2.54 x 2.54 mm Standard  
4.0 x 4.0 mm SWS Standard  
4.0 x 3.5 mm SWS Staggered

**Mating Cycles:**

20 tin plated  
20 silver plated  
100 gold plated

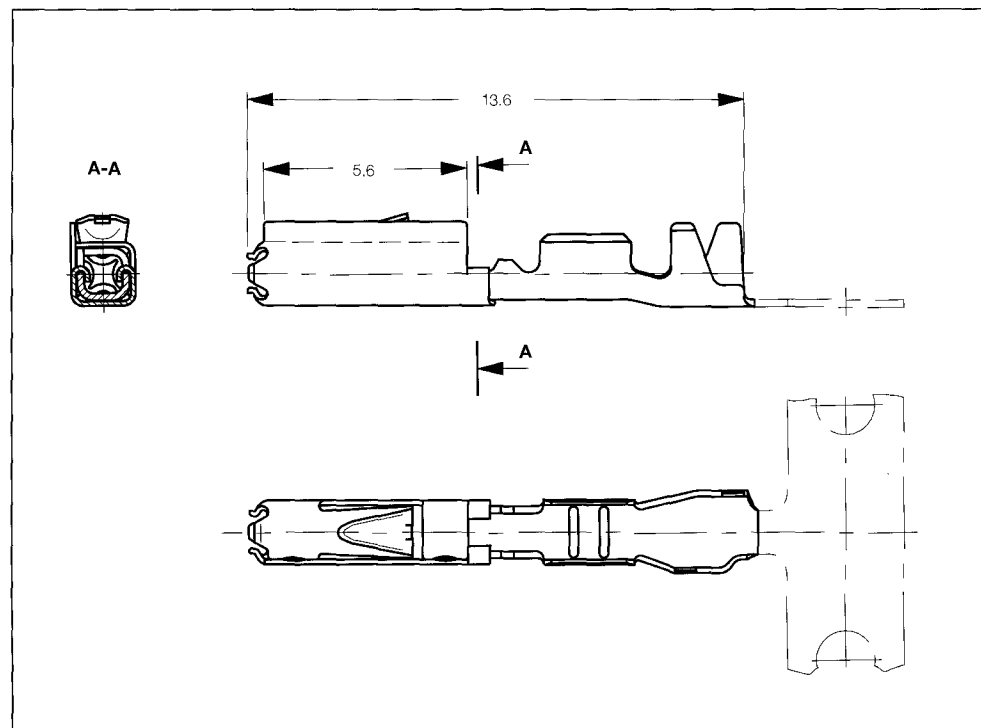

**Special Applications:**

Inmoldable Pin Contact,  
Insulation Displacement  
Receptacle Contact,  
Receptacle Contact with  
Short Circuit Area

**Table Drawings:**

929454 (Receptacle Contact)  
929453 (Pin Contact)

**Product Specification:**

108-18030

**Application Specification:**

114-18021 Standard  
114-18025 SWS System

**Insertion and Extraction Tool:**

Part No. 6-1579007-0

**Standard Receptacle Contacts**

Wire Size Range (mm <sup>2</sup> )	Insulation Diameter		Material and Finish	Part Numbers				Applicator		Hand Tool 539635-1 with Die Set
	FLK (mm)	FLR (mm)		Strip Form	Package Quantity	Loose-Piece	Package Quantity	Standard	Fine Adjust	
0.14–0.22	–	0.9–1.2	tin plated	1355717-1	13,000	1355718-1	500	1426402	1528009	5-1579001-2
			gold plated	1355717-5	13,000	1355718-5	500			
0.20–0.50	–	0.9–1.6	tin plated	928999-1	13,000	963726-1	1,000	1238043*	1528035*	539682-2
			gold plated	928999-5	13,000	963726-5	1,000			
			silver plated	928999-6	13,000	963726-6	1,000			
			tin plated	963715-1	10,000	963729-1	500			
0.50–0.75	–	1.6–1.9	gold plated	963715-5	10,000	963729-5	500	1238051	1528037	3-1579001-5
			silver plated	963715-6	10,000	963729-6	500			

\*) Applicator: Part No. 1426459 and 1528313 for use with 0.2 mm<sup>2</sup> wire

**Single Wire Sealing System**

Wire Size Range (mm <sup>2</sup> )	Insulation Diameter		Material and Finish	Part Numbers				Applicator		Hand Tool 539635-1 with Die Set
	FLK (mm)	FLR (mm)		Strip Form	Package Quantity	Loose-Piece	Package Quantity	Standard	Fine Adjust	
0.20–0.50	–	0.9–1.6	tin plated	962885-1	9,000	963727-1	500	1426108	1528022	539685-2
			gold plated	962885-5	9,000	963727-5	500			
			silver plated	962885-6	9,000	963727-6	500			
0.50–0.75	–	1.6–1.9	tin plated	965906-1	9,000	965907-1	500	1426123	1528071	5-1579001-1
			gold plated	965906-5	9,000	965907-5	500			
			silver plated	965906-6	9,000	965907-6	500			