

Shrouds

Shroud — Threaded

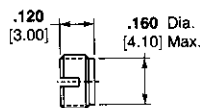

Description	M/A-COM Part No. (Ref. only)	Part No.
Full Detent	2998-5045-02	1056745-1
Limited Detent	2998-5043-02	1056743-1
Smooth Bore	2998-5044-02	1056744-1

**Shroud — 2 Hole Flange
Surface Mount**

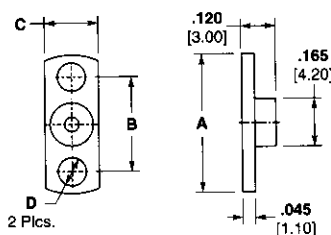

Description	Dim. A	Dim. B	Dim. C	Dim. D	M/A-COM Part No. (Ref. only)	Part No.
Full Detent	.480 12.20	.328 8.30	.187 4.70	.098 2.50	2998-5001-02	1056721-1
	.625 15.80	.481 12.20	.223 5.70	.102 2.60	2998-5002-02	1056722-1
	.400 10.20	.282 7.20	.165 4.20	.073 1.90	2998-5003-02	1056724-1
Limited Detent	.480 12.20	.328 8.30	.187 4.70	.098 2.50	2998-5028-02	1056729-1
	.400 10.20	.282 7.20	.165 4.20	.073 1.90	2998-5030-02	1056731-1
Smooth Bore	.400 10.20	.282 7.20	.165 4.20	.073 1.90	2998-5049-02	1056749-1

RF Connectors

Shroud — Press Fit

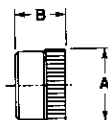

Description	Dim. A	Dim. B	M/A-COM Part No. (Ref. only)	Part No.
Full Detent	.182 4.60	.115 2.90	2998-5005-02	1056726-1
Limited Detent	.174 4.40	.120 3.00	2998-5033-02	1056734-1
	.154 3.90	.080 2.00	2998-5035-02	1056736-1