



Search bar: What can we help you find?

- Products
- Industries
- Resources
- About TE
- My Account
- Innovation
- Support Center

Home > Products > Rectangular Industrial Products > Product Feature Selector > Product Details

1-1102242-7 Product Details

Share | Print | Email

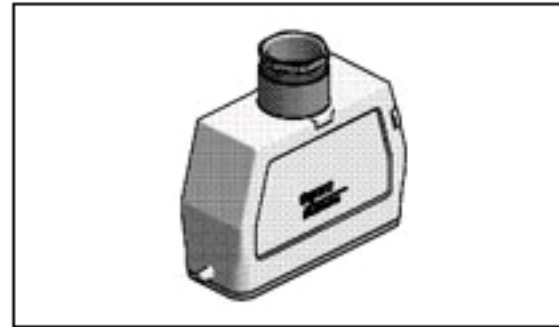

1-1102242-7

TE Internal Number: 1-1102242-7

Active

HTS Connectors and Accessories

Always EU RoHS/ELV Compliant (Statement of Compliance)

Product Highlights:

- HB.6 Series
- Accessory
- Accessory Type = Hood
- Product Size = 3
- Locking Device Type = Side Clip at Housing Bottom

[View all Features](#)

- [Add to My Part List](#)
- [Request Sample](#)
- [Find Similar Products](#)
- [Buy Product](#)

Quick Links

- ▶ Pricing & Availability
- ▶ Search for Tooling
- ▶ Product Feature Selector
- ▶ Contact Us About This Product

Documentation & Additional Information	
<p>Product Drawings:</p> <ul style="list-style-type: none"> • None Available <p>Catalog Pages/Data Sheets:</p> <ul style="list-style-type: none"> • None Available <p>Product Specifications:</p> <ul style="list-style-type: none"> • None Available <p>Application Specifications:</p> <ul style="list-style-type: none"> • None Available <p>Instruction Sheets:</p> <ul style="list-style-type: none"> • None Available <p>CAD Files:</p> <ul style="list-style-type: none"> • None Available 	<p>Additional Information:</p> <ul style="list-style-type: none"> • Product Line Information <p>Related Products:</p> <ul style="list-style-type: none"> • Tooling

Product Features (Please use the Product Drawing for all design activity)	
<p>Product Type Features:</p> <ul style="list-style-type: none"> • Series = HB.6 • Product Type = Accessory • Accessory Type = Hood • Product Size = 3 • Thread Size = PG16 <p>Body Features:</p> <ul style="list-style-type: none"> • Entry Style = Top • Dimensions (L x H x W) (mm [in]) = 74.0 x 48.0 x 43.0 [2.92 x 1.89 x 1.69] • Material = Die Cast Aluminum <p>Contact Features:</p> <ul style="list-style-type: none"> • Corrosion Protected = No 	<p>Configuration Features:</p> <ul style="list-style-type: none"> • Locking Device Type = Side Clip at Housing Bottom <p>Industry Standards:</p> <ul style="list-style-type: none"> • RoHS/ELV Compliance = RoHS compliant, ELV compliant • Lead Free Solder Processes = Not relevant for lead free process • RoHS/ELV Compliance History = Always was RoHS compliant <p>Packaging Features:</p> <ul style="list-style-type: none"> • Packaging Method = Loose Piece • Packaging Quantity = 5 <p>Other:</p> <ul style="list-style-type: none"> • Brand = AMP • Comment = Hood assembly includes cable adapter.

Corporate Information

- [About TE](#)
- [Investors](#)
- [News Room](#)
- [Supplier Portal](#)
- [Careers](#)
- [Terms & Conditions](#)
- [Privacy Policy](#)

Quick Links

- [Distributor Inventory](#)
- [Product Cross Reference](#)
- [Documents & Drawings](#)
- [Product Compliance Support Center](#)
- [Site Map](#)

Customer Support

- [Email or Chat With Us](#)
- [Find a Phone Number](#)
- [Knowledge Base](#)
- [Manage Your Account](#)

Keep Me Informed

