

4

3

2

1

CONVERSION CHART	
INCH	MM
.010	0.25
.020	0.51
.035	0.89
.100	2.54
.105	2.67
.125	3.18
.180	4.57
.210	5.33
.180	4.57
.295	7.50
.305	7.74
.300	7.62
.395	10.04
.405	10.28
.400	10.16
.595	15.12
.605	15.36
.600	15.24
.700	17.78
.800	20.32
.895	22.74
.905	22.98
.900	22.86
1.000	25.40
1.200	30.48
1.400	35.56
1.600	40.64
2.000	50.8
3.200	81.28

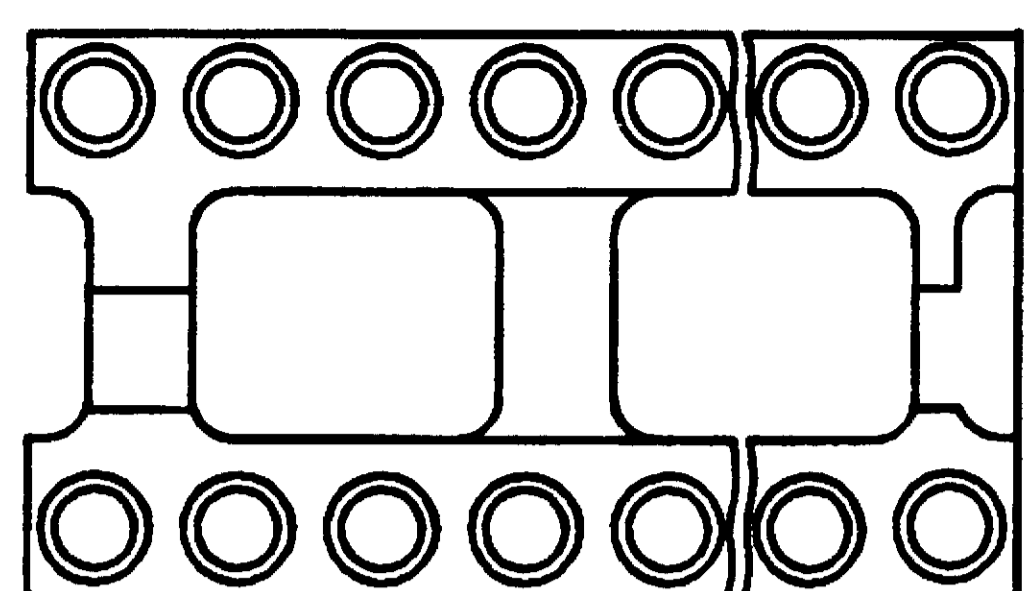

FIG. 1

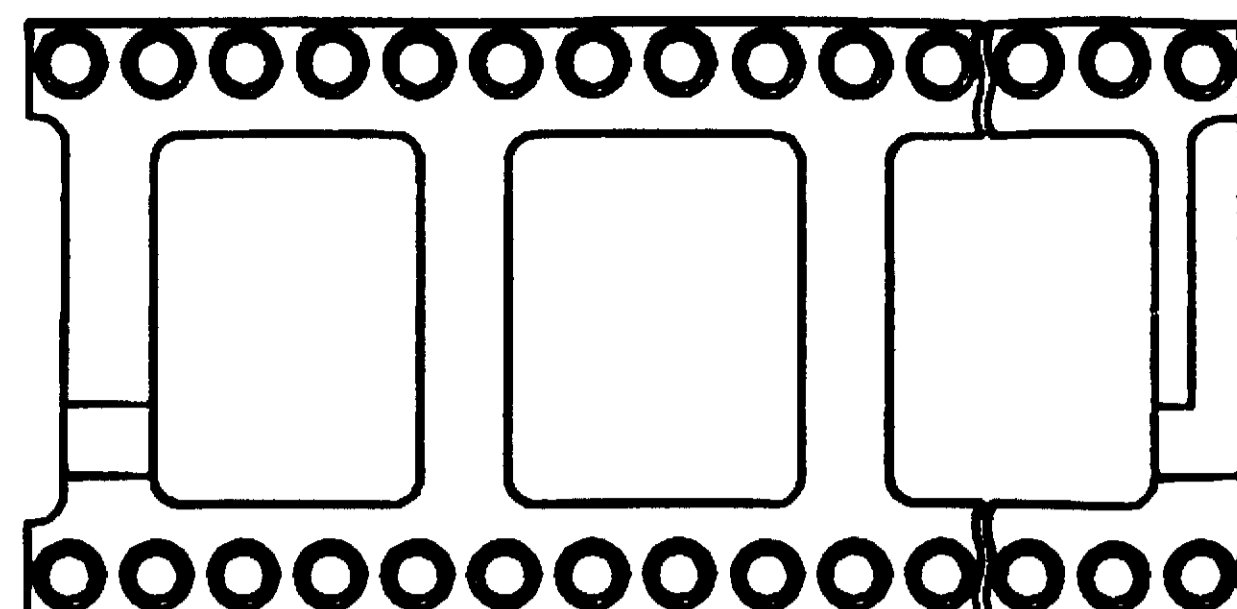
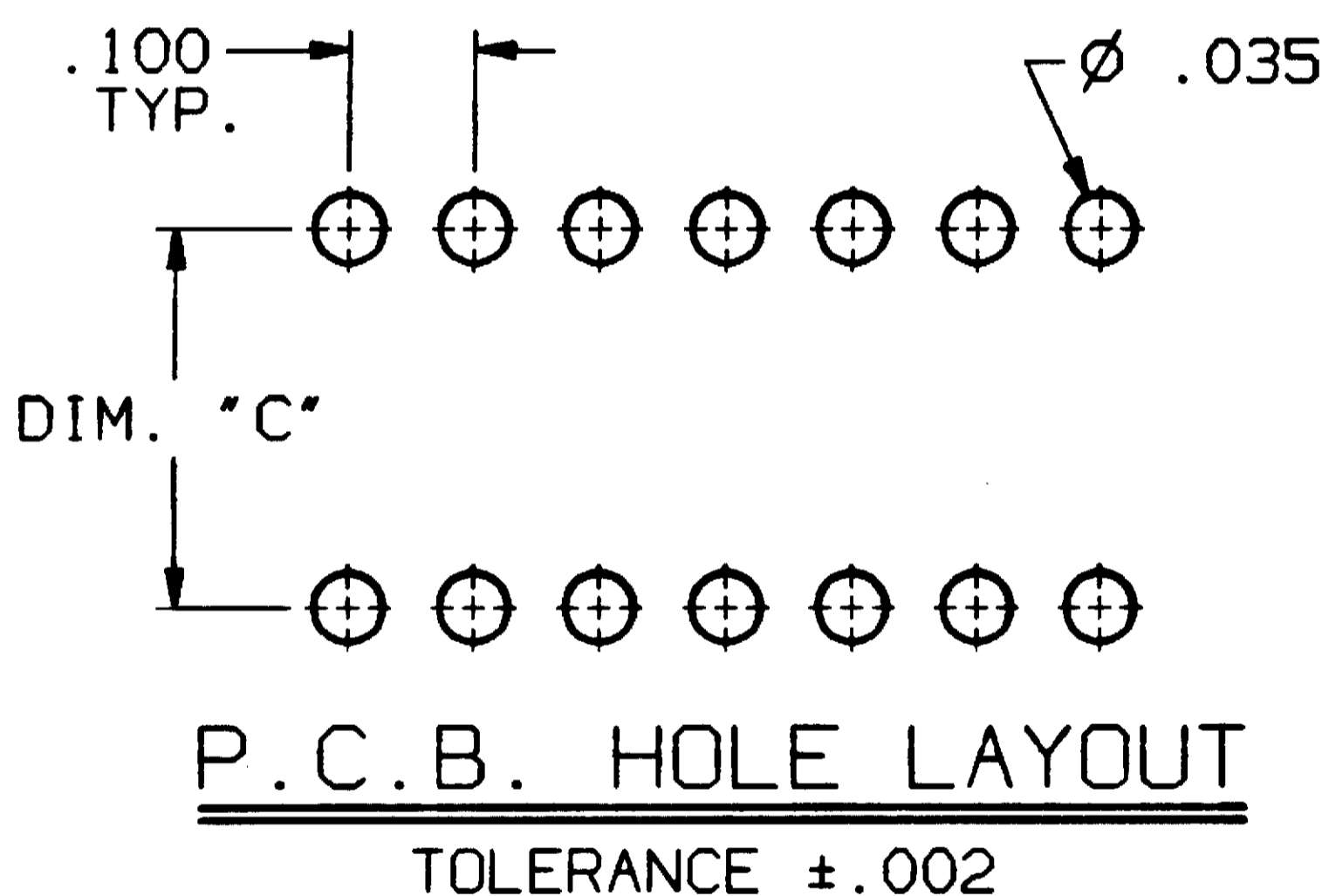
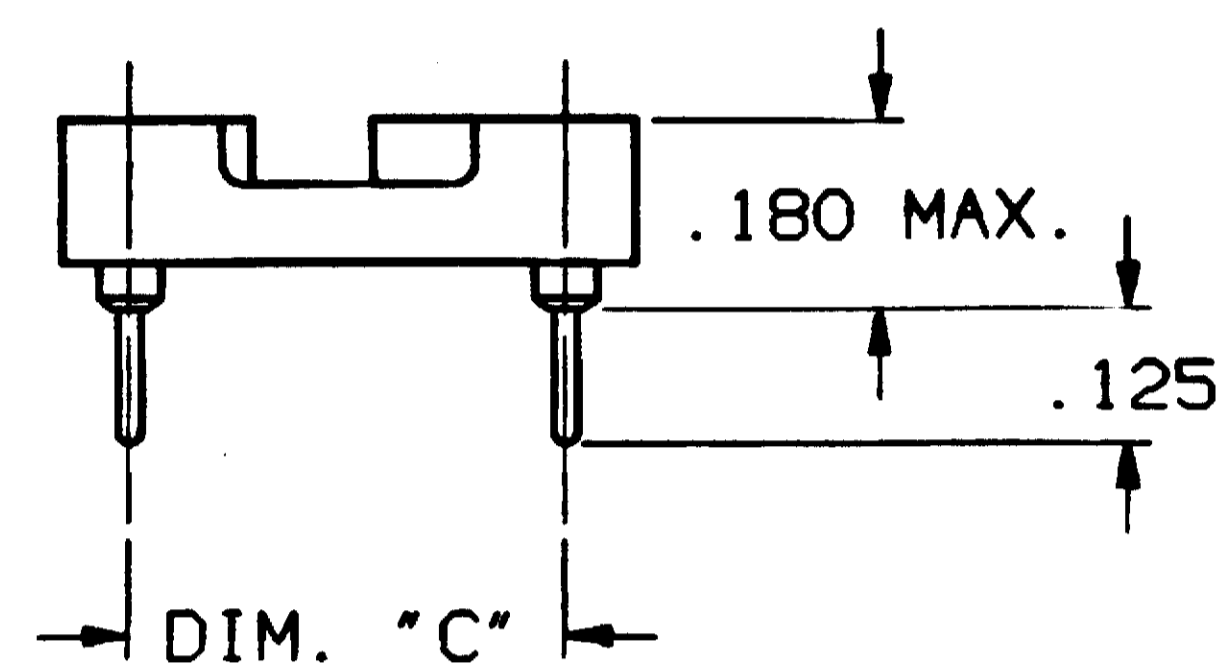
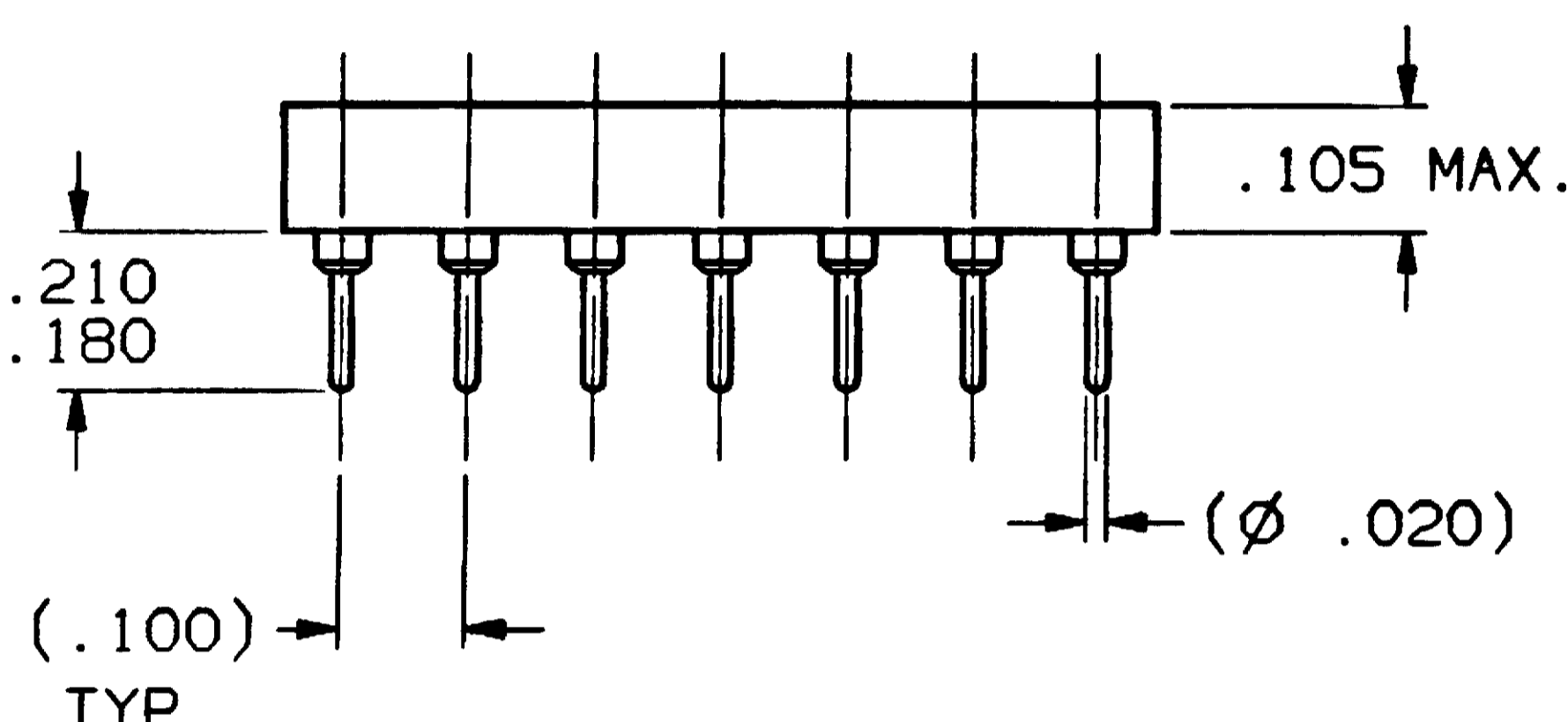
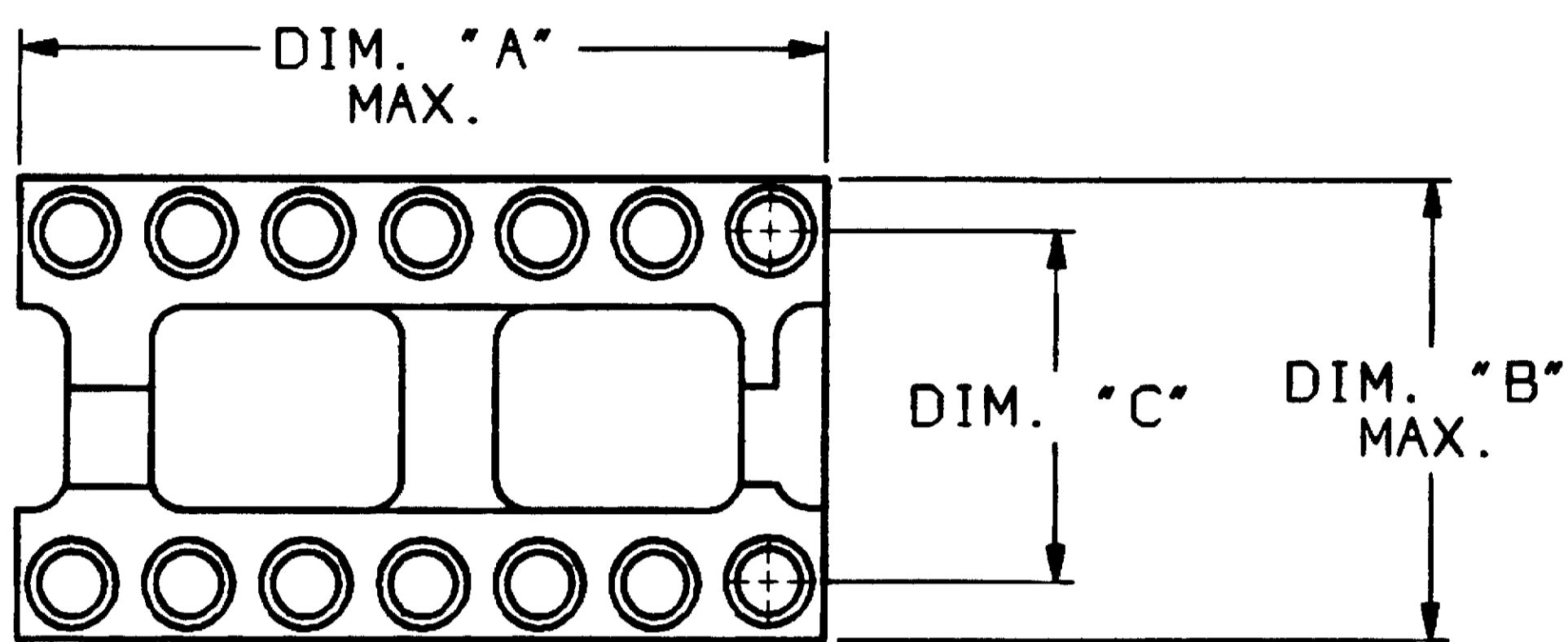

FIG. 2



P.C.B. HOLE LAYOUT
TOLERANCE ±.002

SPECIFICATIONS:

- MATERIALS:**
 - INSULATOR: POLYESTER, UL RATED 94V-0.
 - CONTACT: COPPER ALLOY
 - SLEEVE: COPPER ALLOY.
 - PLATING: 11D-ES, 31D-ES - CONTACT - GOLD OVER NICKEL. SLEEVE - TIN/LEAD.
 - 11D-ESL, 31D-ESL - CONTACT - LOW GOLD OVER NICKEL. SLEEVE - TIN/LEAD.
 - 12D-ES, 32D-ES - CONTACT - TIN/LEAD. SLEEVE - TIN/LEAD.
- ELECTRICAL:**
 - CONTACT RESISTANCE: 10 MILLIOHMS MAX.
 - CONTACT RATING: 3 AMPS.
 - CAPACITANCE: 1.0pF PER MIL-STD-202, METHOD 305.
 - INSULATION RESISTANCE: 5000 MΩ MIN. @ 500 VDC PER MIL-STD-1344, METHOD 3003.1.
 - DIELECTRIC WITHSTANDING VOLTAGE: 1000 VOLTS (RMS) PER MIL-STD-1344, METHOD 3001.1.
- MECHANICAL:**
 - INSERTION FORCE: 179 GRAMS AVERAGE WHEN MEASURED WITH Ø .018 POLISHED STEEL PIN.
 - WITHDRAWAL FORCE: 63 GRAMS AVERAGE WHEN MEASURED WITH Ø .018 POLISHED STEEL PIN.
- ENVIRONMENTAL:**
 - OPERATING TEMPERATURE: -67°F TO +221°F (-55°C TO +105°C).

NOTES:

1. INTERPRET DRAWING PER ASME Y14.5M-1994.

PART NUMBER	FIG.	DIM. "A"	DIM. "B"	DIM. "C"
814-AG11D-ES 814-AG11D-ESL 814-AG12D-ES	1	.700	.400	.295 .305
816-AG11D-ES 816-AG11D-ESL 816-AG12D-ES	1	.800	.400	.295 .305
820-AG11D-ES 820-AG11D-ESL 820-AG12D-ES	1	1.000	.400	.295 .305
824-AG11D-ES 824-AG11D-ESL 824-AG12D-ES	1	1.200	.700	.595 .605
824-AG31D-ES 824-AG31D-ESL 824-AG32D-ES	1	1.200	.400	.295 .305
828-AG11D-ES 828-AG11D-ESL 828-AG12D-ES	1	1.400	.700	.595 .605
832-AG11D-ES 832-AG11D-ESL 832-AG12D-ES	2	1.600	.700	.595 .605
840-AG11D-ES 840-AG11D-ESL 840-AG12D-ES	2	2.000	.700	.595 .605
864-AG11D-ES 864-AG11D-ESL 864-AG12D-ES	2	3.200	1.000	.895 .905

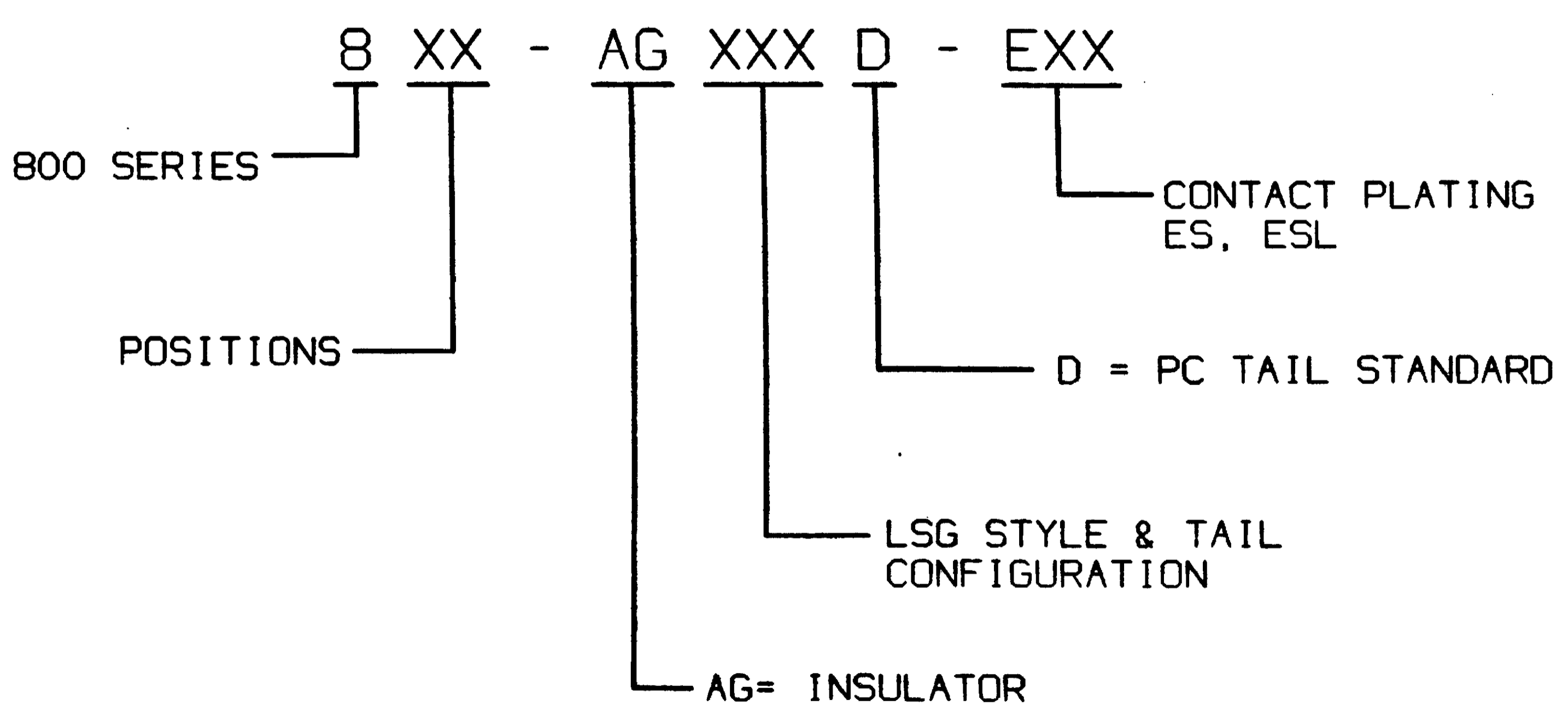

OUTLINE DRAWING
SPECIFICATIONS ARE SUBJECT TO CHANGES WITHOUT NOTICE

THIS IS A C.A.D. GENERATED DRAWING.
DO NOT MAKE MANUAL REVISIONS TO MASTER.

REV	REVISIONS
0	INITIAL RELEASE ESR/MSZ S.KIRCORIAN 5-30-95 APP'D: D.O'NEILL 6-1-95
1	REVISED ECM/676-95 S.KIRCORIAN 9-25-95 APP'D: D.O'NEILL 9-26
2	REVISED ECM/793-95 SEK 11-27-95 APP'D: D.O'NEILL 12-4-95

THIRD ANGLE PROJECTION

TOLERANCES (EXCEPT AS NOTED)
ANGULAR = ±1°
DECIMAL .XX = ±
DECIMAL .XXX = ±.010
DECIMAL .XXXX = ±

AUGAT CONFIDENTIAL
This document contains information which is the exclusive property of Augat Inc.
Distribution, reproduction or use by others is not permitted without the expressed written consent of Augat Inc.

UNLESS OTHERWISE SPECIFIED DIMENSIONS ARE IN INCHES DO NOT SCALE PRINT		ORIGINAL DATE OF DRAWING: 5-30-95	
FILE NAME: 8XXAOUT1	DIRECTORY: PNCODEAS	DRAWN: S.KIRCORIAN	DATE: 5-30-95
MATERIAL: SEE SPECIFICATIONS		CHECKED:	DATE:
FINISH: SEE SPECIFICATIONS		APPROVED: D.O'NEILL	DATE: 6-1-95
		CODE IDENT. NO. 91506	DWG. SIZE C
		NEXT ASSY:	

AUGAT INC. 452 JOHN DIETSCH BLVD. ATTLEBORO FALLS, MASS. 02763	
TITLE: OUTLINE DRAWING 800 SERIES	
DWG. NO. 8XX-AGXXXD-ES, ESL	REV. 2
PRODUCT CODE: 25	SCALE: SHEET 1 OF 1