

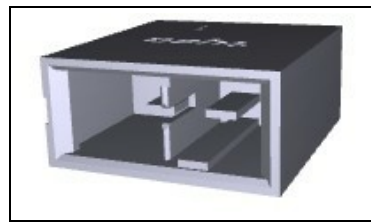

1-1747277-2 Product Details

[Share](#) [Print](#) [Email](#)

1-1747277-2

TE Internal Number: 1-1747277-2

Active
[View 3D PDF](#)

Dynamic Series Connectors

Always EU RoHS/ELV Compliant (Statement of Compliance)

Product Highlights:

- Dynamic Series Product Line
- D-4200S Series
- Series No. = 4000
- Wire-to-Board
- Applies To Printed Circuit Board

[View all Features](#)

Quick Links

- ▶ [Pricing & Availability](#)
- ▶ [Search for Tooling](#)
- ▶ [Product Feature Selector](#)
- ▶ [Contact Us About This Product](#)

[Add to My Part List](#) [Request Sample](#) [Find Similar Products](#) [Buy Product](#)

Documentation & Additional Information	
<p>Product Drawings:</p> <ul style="list-style-type: none"> • DYNAMIC D4200S 6.35mmPITCH HDR ASSY (V-TYPE) 2-4POS (PDF, Japanese) <p>Catalog Pages/Data Sheets:</p> <ul style="list-style-type: none"> • D4000 and D5000 Series Dynamic Connectors (PDF, English) <p>Product Specifications:</p> <ul style="list-style-type: none"> • DYNAMIC CONNECTOR D-4000 SERIES (PDF, Japanese) <p>Application Specifications:</p> <ul style="list-style-type: none"> • DYNAMIC CONNECTOR D4000 SERIES CONTACT (PDF, Japanese) <p>Instruction Sheets:</p> <ul style="list-style-type: none"> • None Available <p>CAD Files: (CAD Format & Compression Information)</p> <ul style="list-style-type: none"> • 2D Drawing (DXF, Version 02) • 3D Model (IGES, Version 02) • 3D Model (STEP, Version 02) 	<p>Related Products:</p> <ul style="list-style-type: none"> • Tooling

[List all Documents](#)

Product Features (Please use the Product Drawing for all design activity)

<p>Product Type Features:</p> <ul style="list-style-type: none"> • Product Line = Dynamic Series • Product Type = Connector • Connector Type = Header • PCB Mounting Orientation = Vertical • PCB Mount Retention = With • Sealed = No • CSA File Number = LR7189 <p>Mechanical Attachment:</p> <ul style="list-style-type: none"> • Mating Retention Type = Latching <p>Electrical Characteristics:</p> <ul style="list-style-type: none"> • Contact - Rated Current (A) = 24 • Operating Voltage Reference = AC/DC • Operating Voltage (VAC) = 600 • Operating Voltage (VDC) = 600 <p>Termination Features:</p> <ul style="list-style-type: none"> • Termination Method to Wire/Cable = Solder • Termination Method to PC Board = Through Hole - Solder <p>Dimensions:</p> <ul style="list-style-type: none"> • Tail Length (mm [in]) = 3.8 [0.148] • PCB Thickness, Recommended (mm [in]) = 1.60 - 2.40 [0.063 - 0.0945] <p>Body Features:</p> <ul style="list-style-type: none"> • Mating Retention = With 	<p>Housing Features:</p> <ul style="list-style-type: none"> • Connector Style = Plug • Centerline (mm [in]) = 6.35 [0.2499] • Housing Material = Polyester - GF • Housing Color = Black • Mating Alignment = With • Mating Alignment Type = Keyed <p>Configuration Features:</p> <ul style="list-style-type: none"> • Number of Positions = 2 • Number of Rows = 1 <p>Industry Standards:</p> <ul style="list-style-type: none"> • RoHS/ELV Compliance = RoHS compliant, ELV compliant • Lead Free Solder Processes = Wave solder capable to 240°C, Wave solder capable to 260°C, Wave solder capable to 265°C • RoHS/ELV Compliance History = Always was RoHS compliant • Agency/Standard = CSA, UL • UL Rating = Recognized • UL File Number = E28476 • CSA Rating = Certified • UL Flammability Rating = UL 94V-0 <p>Identification Marking:</p> <ul style="list-style-type: none"> • Keying = X <p>Environmental:</p> <ul style="list-style-type: none"> • Operating Temperature (°C [°F]) = -55 - +105 [-67 - +221]
---	---

Contact Features:

- Contact Type = Tab
- Contact Layout = Single Row
- Contact Base Material = Copper Alloy
- Contact Plating, Mating Area, Material = Gold
- Contact Plating, Mating Area, Thickness (μm [μin]) = 0.38 [15]
- Multiple Contact Types = Without
- Tail Plating Material = Tin
- Tail Plating Thickness (μm [μin]) = 2 [78.74]
- Underplate Material = Nickel
- Underplate Material Thickness (μm [μin]) = 1.30 [51.180]

Conditions for Usage:

- Applies To = Printed Circuit Board
- For Use With = Receptacle Housing

Operation/Application:

- Application Use = Wire-to-Board
- Contact Transmits (Typical Application) = Power

Packaging Features:

- Packaging Method = Tube
- Packaging Quantity = 20

Other:

- Series = D-4200S
- Series No. = 4000
- Brand = AMP

Corporate Information

- [About TE](#)
- [Investors](#)
- [News Room](#)
- [Supplier Portal](#)
- [Careers](#)
- [Terms & Conditions](#)
- [Privacy Policy](#)
- [AODA Accessibility Policy](#)
- [AODA Multi-Year Accessibility Plan](#)

Quick Links

- [Distributor Inventory](#)
- [Product Cross Reference](#)
- [Documents & Drawings](#)
- [Product Compliance Support Center](#)
- [Site Map](#)

Customer Support

- [Email or Chat With Us](#)
- [Find a Phone Number](#)
- [Knowledge Base](#)
- [Manage Your Account](#)

Keep Me Informed