

P.C.B. HOLE DIM. ACTION PIN

DRILLED HOLE	:1,15 ±0,025	mm
FIN. HOLE	:0,94 to 1,09	mm
AFTER REFLOW	:0,91 to 1,09	mm
Cu-thks	:0,025 to 0,075	mm
SnPb-thks	:0,004 to 0,010	mm

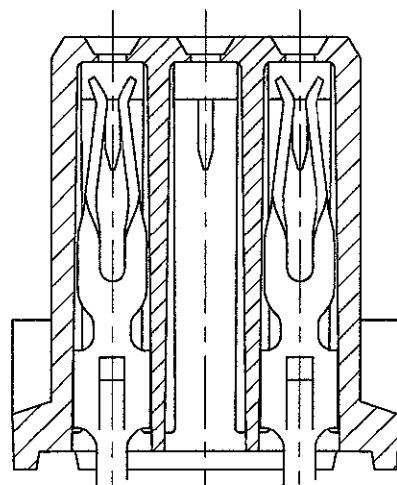

DO NOT SCALE  
DIMENSIONS IN mm

METRIC

THIRD ANGLE  
PROJECTION

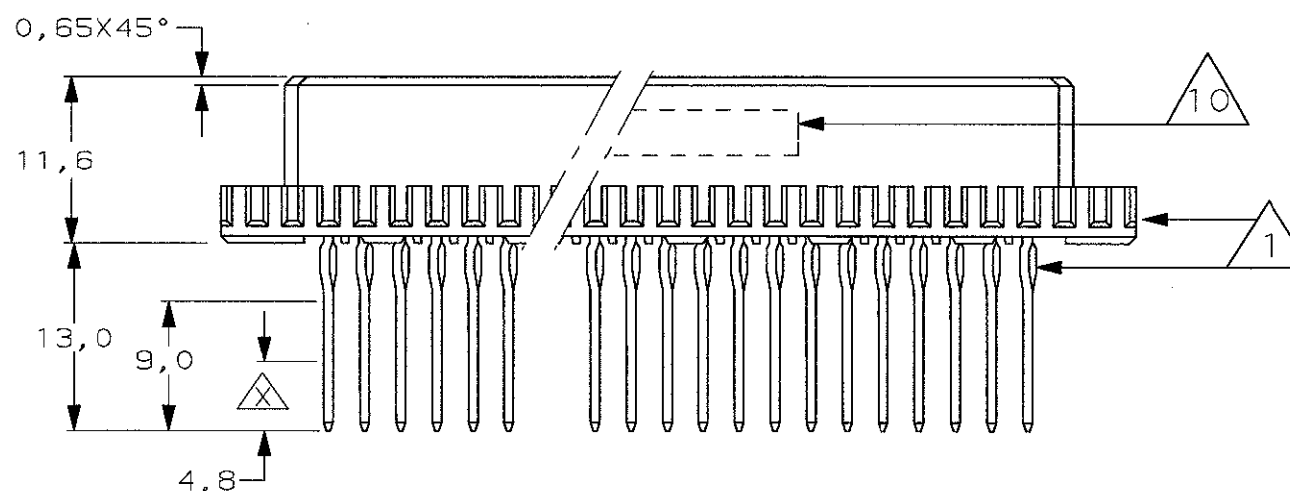
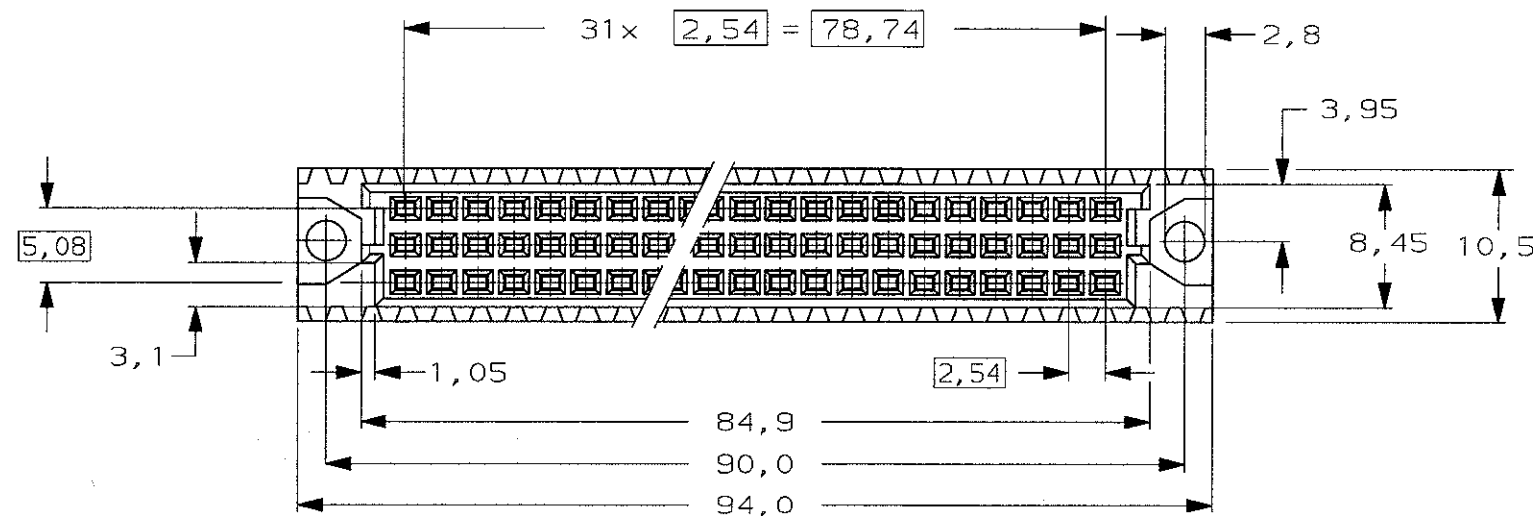
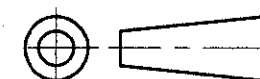

NOTES:

- 1 CONNECTOR MEETS THE REQUIREMENTS ACC. DIN 41612 AND DIN 41611, PART 2 AND 5.
- 2 MATERIAL CONTACT: PHOSPHORBRONZE. MATERIAL HOUSING: GLASSFILLED THERM. POLYESTER.
- 3 AT CONTACTAREA 1,25 μm GOLD OVER 1,25 μm NICKEL. REMAINDER 1,25 μm TIN-LEAD (93/7).
- 4 AT CONTACTAREA 0,8 μm GOLD OVER 1,25 μm NICKEL. REMAINDER 1,25 μm TIN-LEAD (93/7).
- 5 AT CONTACTAREA AND AREA  $\Delta$  1,25 μm GOLD OVER 1,25 μm NICKEL. AT ACTION PIN AREA 1,25 μm TIN LEAD (93/7).
- 6 AT CONTACTAREA AND AREA  $\Delta$  0,8 μm GOLD OVER 1,25 μm NICKEL. AT ACTION PIN AREA 1,25 μm TIN LEAD (93/7).
- 7 AT CONTACTAREA AND AREA  $\Delta$  0,4 μm GOLD OVER 1,25 μm NICKEL. AT ACTION PIN AREA 1,25 μm TIN LEAD (93/7).
- 8 AT CONTACTAREA AND AREA  $\Delta$  0,1 μm GOLD OVER 0,7 μm PALLADIUM (DURAGOLD) OVER 1,25 μm NICKEL. AT ACTION PIN AREA 1,25 μm TIN LEAD (93/7).
- 9 AT CONTACTAREA AND AREA  $\Delta$  0,1 μm GOLD OVER 0,3 μm PALLADIUM (DURAGOLD) OVER 1,25 μm NICKEL. AT ACTION PIN AREA 1,25 μm TIN LEAD (93/7).
- 10 CONNECTOR PRINTED WITH PARTNUMBER AND DATECODE ON OUTSIDE OF MATING AREA OF ROW c.

9	2	7-215913-8
8	2	7-215913-4
7	2	1-215913-8
6	2	1-215913-4
5	2	1-215913-1
4	2	215913-4
3	2	OBS 215913-1
FINISH		PARTNUMBER

ROW	XX
abc	.....
POS	2 3 4 5 6 7 8 9 10 11 12 13 14 15 16 17 18 19 20 21 22 23 24 25 26 27 28 29 30

AN ASTERISK ,,X'' DENOTES A SIGNAL CONTACT.

**CUSTOMER DRAWING** FOR REFERENCE ONLY WILL NOT BE UPDATED

© COPYRIGHT 19- BY AMP HOLLAND B.V.  
ALL INTERNATIONAL RIGHTS RESERVED. AMP PRODUCTS MAY BE COVERED BY U.S. AND FOREIGN AND/OR PATENTS PENDING.  
THIS DRAWING IS UNPUBLISHED  
RELEASED FOR PUBLICATION , 19

**AMP** | AMP HOLLAND B.V.  
s-Hertogenbosch,  
The Netherlands.

E1	EH-1209-00	RvH	R.F.	08-11-00	NAME	64 POS FEMALE CONN. ASS'Y
D	EH-0855-97	J.G.	J.G.	06-08-97		ACC.DIN 41612 WITH ACTION-PIN
LTR.	REVISION RECORD	DR.	CHK.	DATE		FOR 2,4-3,2mm P.C.BOARD THK'S
DR.:	R.v.Lokven	CHK.:	R. FIJTEN	APP.:	R. FIJTEN	DWG.No.
DATE:	26-01-88	DATE:	8-11-00	DATE:	8-11-00	C-215913
						REV.LTR.
						E1
						SHEET
						1 OF 1
						A3