

## 1367643-1 Product Details



**1367643-1**

TE Internal Number: 1367643-1



### Pluggable Connectors, Cages & Accessories

 Always EU RoHS/ELV Compliant (Statement of Compliance)

#### Product Highlights:

- SFP Product Line
- Cage
- SFP Application
- Cage Type = Single
- Single Port Port Configuration

### Documentation & Additional Information

#### Product Drawings:

- [CAGE ASSEMBLY, PRESS FIT, DWDM SFP](#) (PDF, English)

#### Catalog Pages/Data Sheets:

- [1773408-1 Pluggable Input/Output Solutions catalog -...](#) (PDF, English)
- [4-1773455-4 Quick Reference Guide SFP Solutions](#) (PDF, English)

#### Product Specifications:

- None Available

#### Application Specifications:

- [Small Form-Factor Pluggable \(SFP\) DWDM \(Dense Wavele...](#) (PDF, English)

#### Instruction Sheets:

- [Small Form-Factor Pluggable \(SFP\) DWDM \(Dense Wavele...](#) (PDF, English)

#### CAD Files: (CAD Format & Compression Information)

- [2D Drawing](#) (DXF, Version D)
- [3D Model](#) (IGES, Version D)
- [3D Model](#) (STEP, Version D)

#### Related Products:

- [Tooling](#)
- [Connectors \(2\)](#)
- [Heatsinks \(3\)](#)
- [Cable Assemblies \(5\)](#)

### Product Features (Please use the Product Drawing for all design activity)

#### Product Type Features:

- Product Line = SFP
- [Product Type](#) = Cage
- Termination Method to PC Board = Press-Fit

#### Mechanical Attachment:

- PCB Mount = Double Sided (Belly-to-Belly)

#### Electrical Characteristics:

- Data Signal Rate (Gb/s) = Up to 4

#### Termination Features:

- Tail Length (mm [in]) = 3 [0.118]

#### Dimensions:

- PCB Thickness, Recommended (mm [in]) = 2.25 [0.089]

#### Body Features:

- Cage Plating = Tin over Nickel Flash

#### Housing Features:

- Cage Type = Single
- Cage Material = Copper Alloy

#### Configuration Features:

- Port Configuration = Single Port
- Heat Sink Included = No
- Lightpipe = Without

#### Industry Standards:

- [RoHS/ELV Compliance](#) = RoHS compliant, ELV compliant
- [Lead Free Solder Processes](#) = Not relevant for lead free process
- RoHS/ELV Compliance History = Always was RoHS compliant

#### Conditions for Usage:

- Applies To = Printed Circuit Board

#### Operation/Application:

- [Application](#) = SFP
- Heat Sink Application = Yes

#### Packaging Features:

- Packaging Method = Tray

#### Other:

- Brand = AMP

LOC	DIST	REV	DATE	DWN	APVD
GP	00				
REVISIONS					
C		REVISED PER ECO-06-029298	12DEC06	BM	JK
D		REVISED PER ECO-10-021738	04JAN2011	CJV	JTL

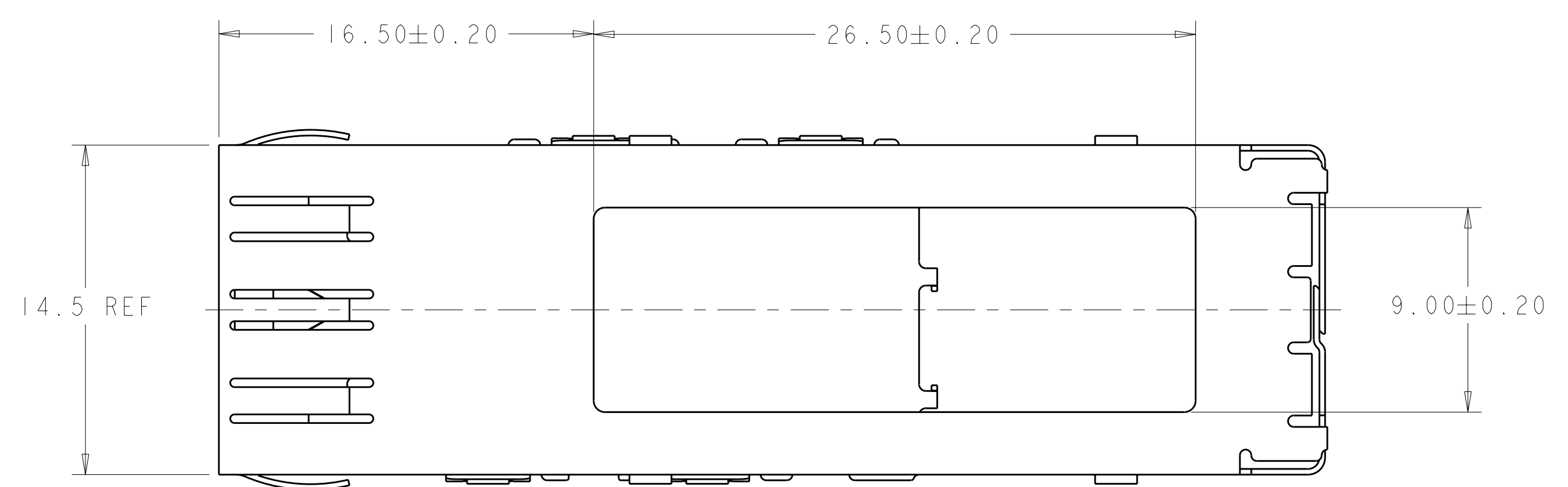

- 1. MATERIAL: 0.25 THICK COPPER ALLOY.
- 2. FINISH: TIN, NONPLATED EDGES PERMISSIBLE.
- 3. MATES WITH SFP MSA COMPLIANT TRANSCEIVERS.
- 4. PADS AND VIAS CHASSIS GROUND.
- 5. DATUM AND BASIC DIMENSIONS ESTABLISHED BY CUSTOMER.
- 6. MINIMUM PC BOARD THICKNESS:  
 SINGLE SIDED= 1.45  
 DOUBLED SIDED= 3.00
- 7. REFERENCE APPLICATION SPEC 114-13178, HOLE A, FOR RECOMMENDED DRILL HOLE DIAMETER AND PLATING THICKNESSES.
- 8. REFERENCE APPLICATION SPEC 114-13178, HOLE C, FOR RECOMMENDED DRILL HOLE DIAMETER AND PLATING THICKNESSES.

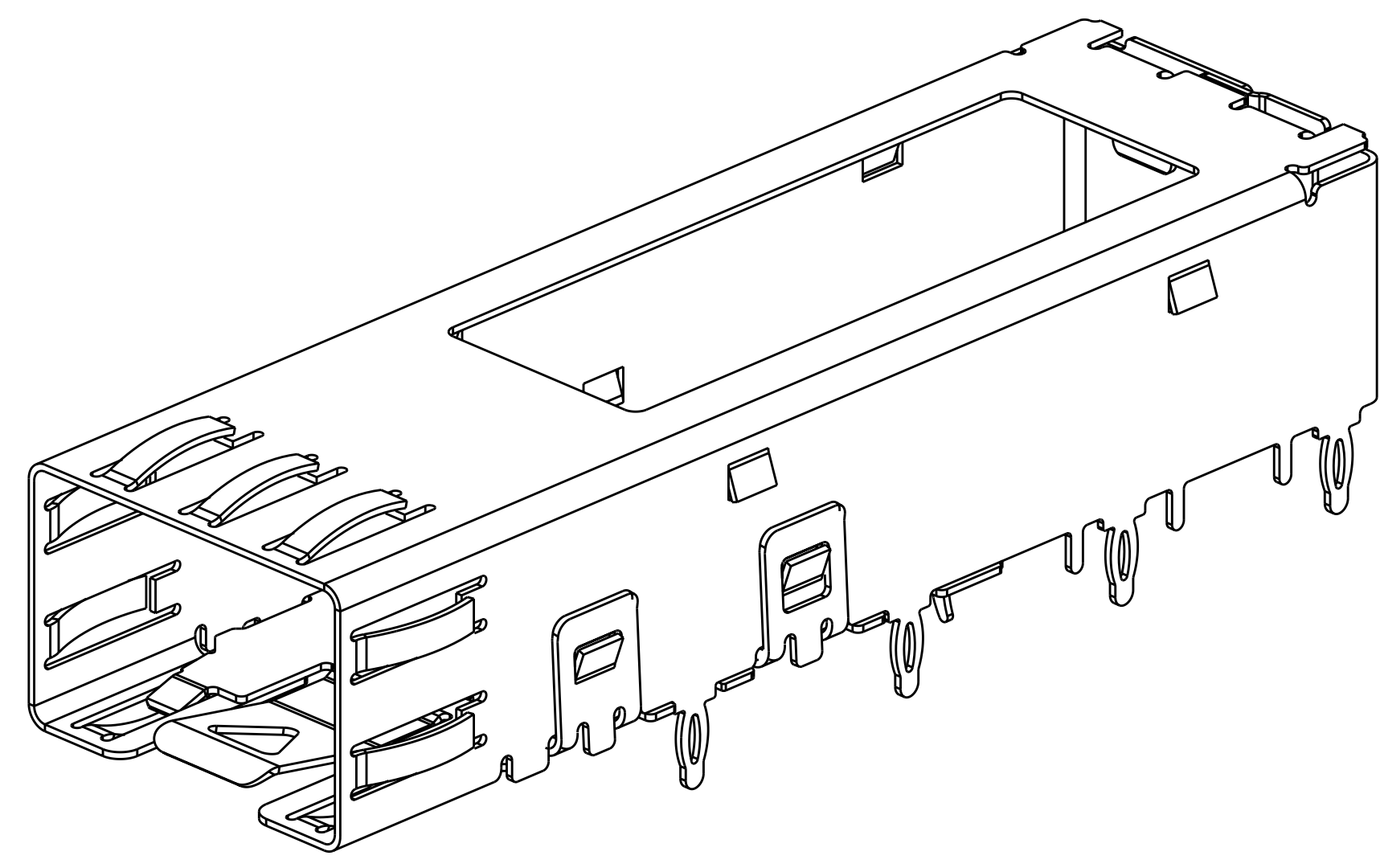
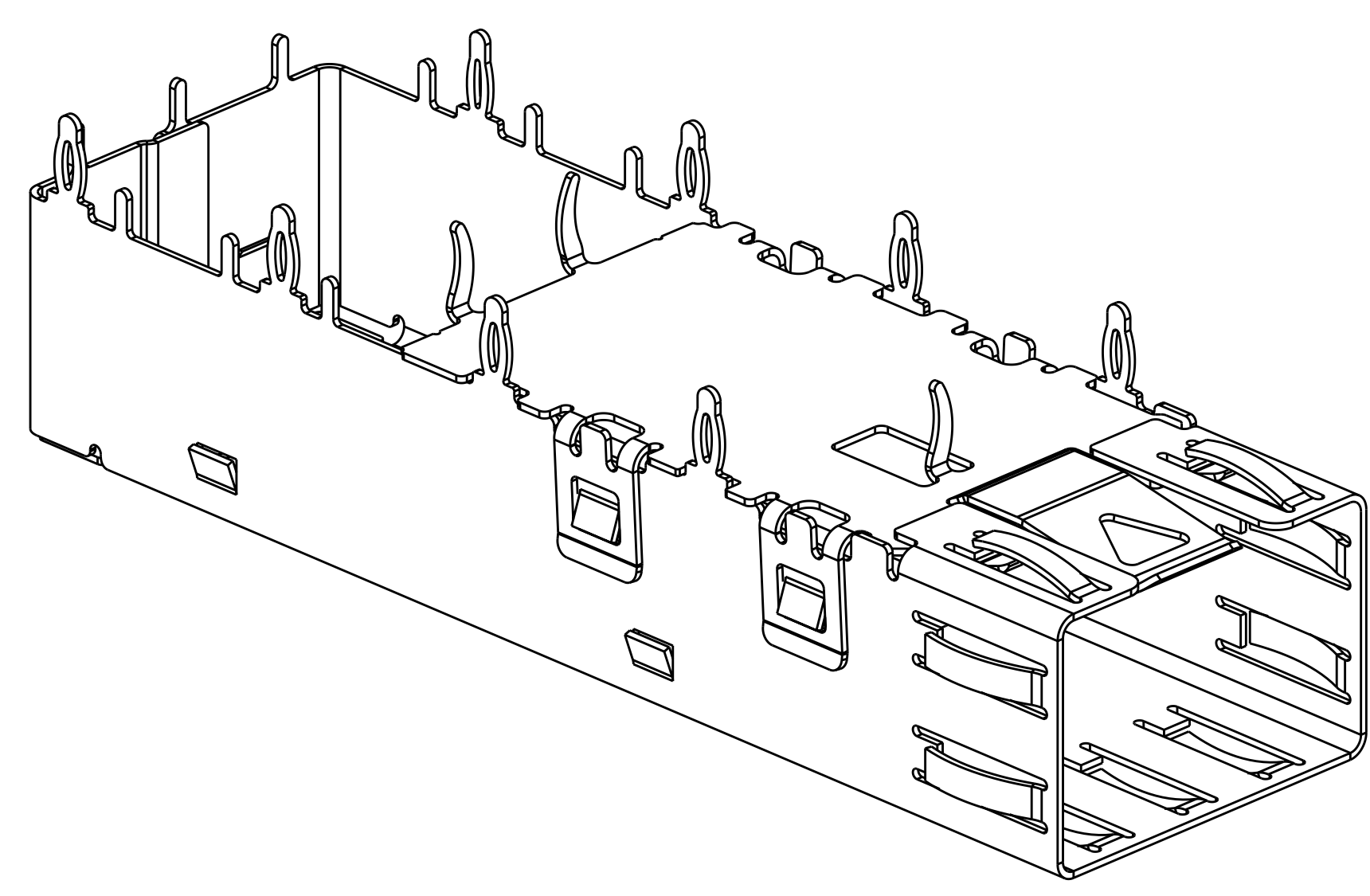
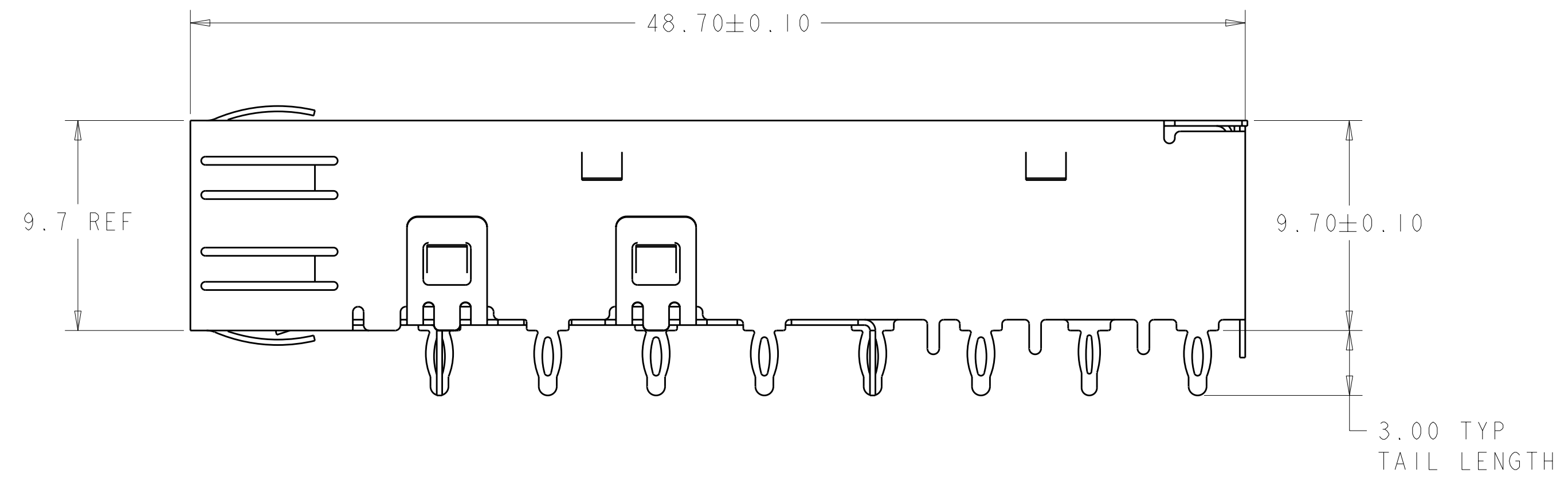
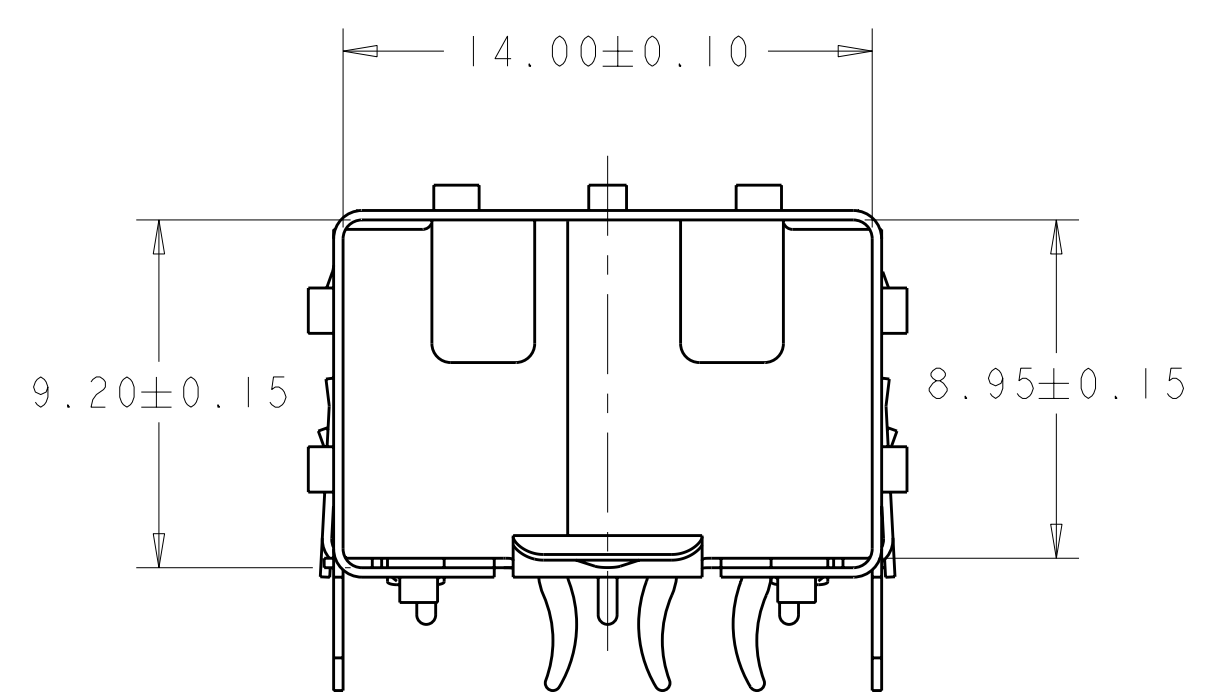

1367643-1  
 PART NUMBER

DIMENSIONS: mm 		TOLERANCES UNLESS OTHERWISE SPECIFIED: 0 PLC ± 1 PLC ±0.10 2 PLC ±0.15 3 PLC ±0.15 4 PLC ± ANGLES ± FINISH ±		DWN P. KERLIN 11MAY06 CHK E. J. BRIGHT 11MAY06 APVD E. J. BRIGHT 11MAY06		Tyco Electronics Harrisburg, PA 17105-3608	
MATERIAL 		FINISH 		PRODUCT SPEC 108-1950		NAME CAGE ASSEMBLY, PRESS FIT, DWDM SFP	
CUSTOMER DRAWING		WEIGHT -		SIZE CAGE CODE DRAWING NO A 100779 C=1367643		RESTRICTED TO -	
SCALE 5:1		SHEET 1 OF 2		REV D		Tyco Electronics logo	

LOC	DIST	REV	DATE	BY	APPD
GP	00				

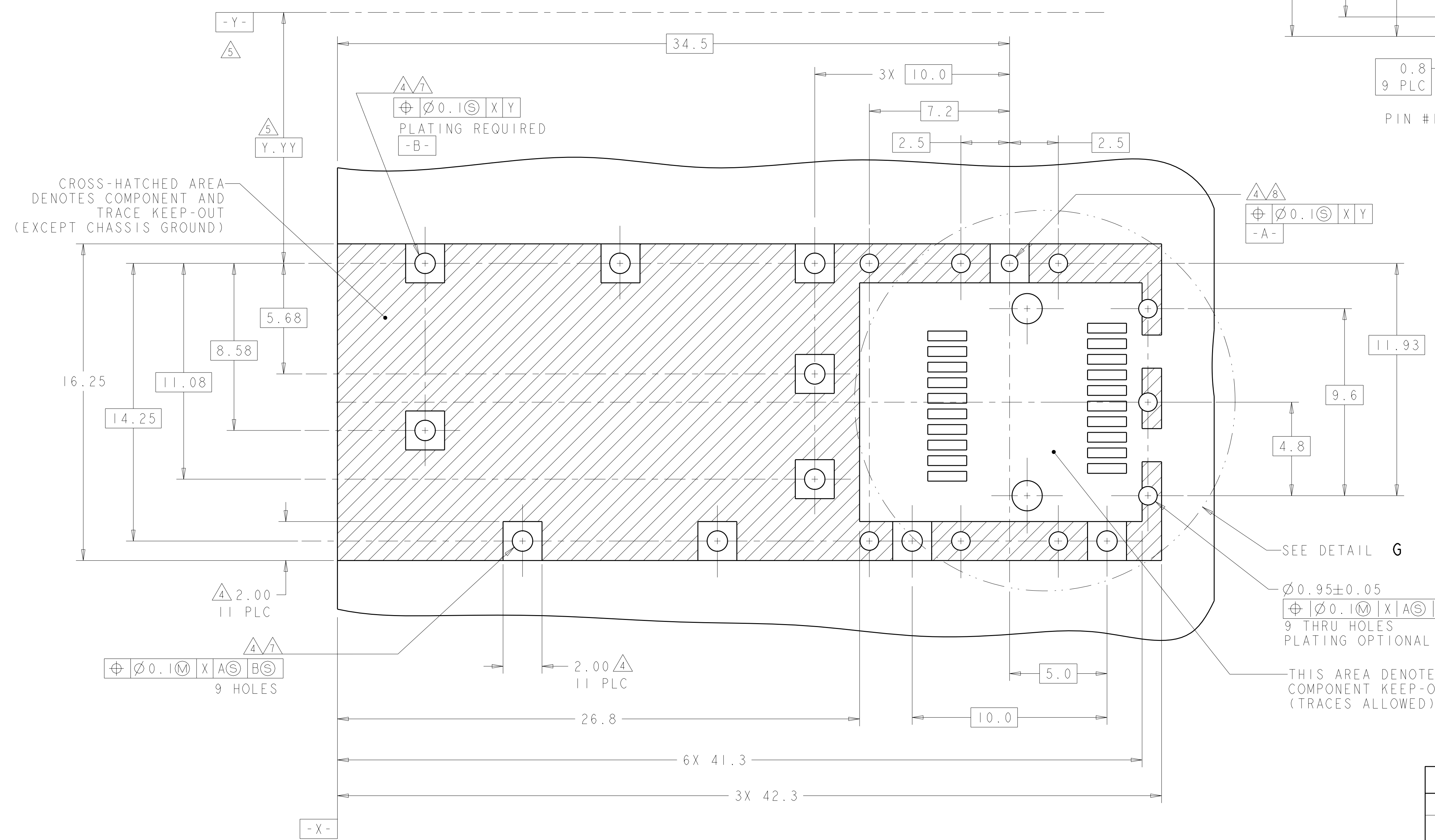
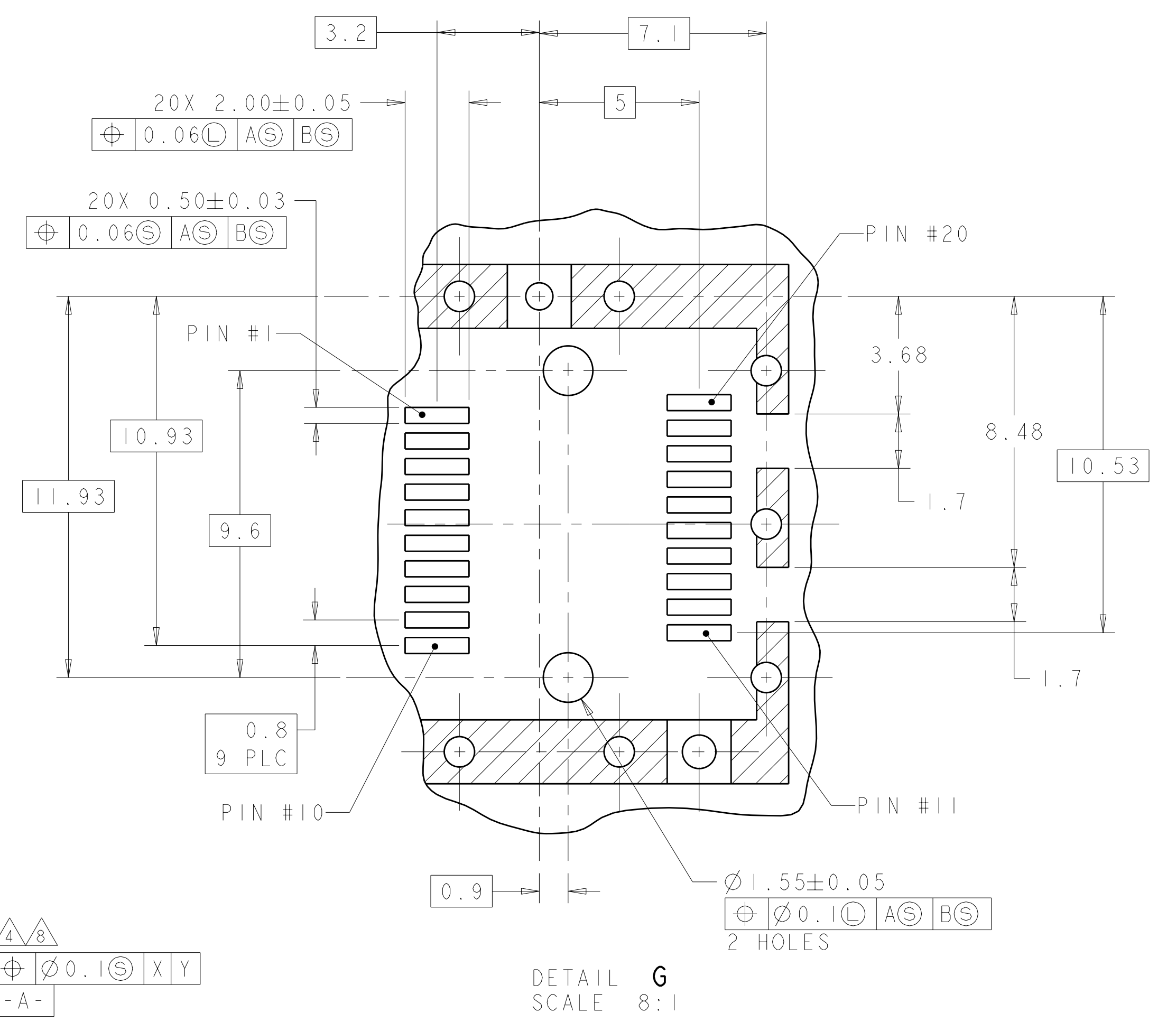
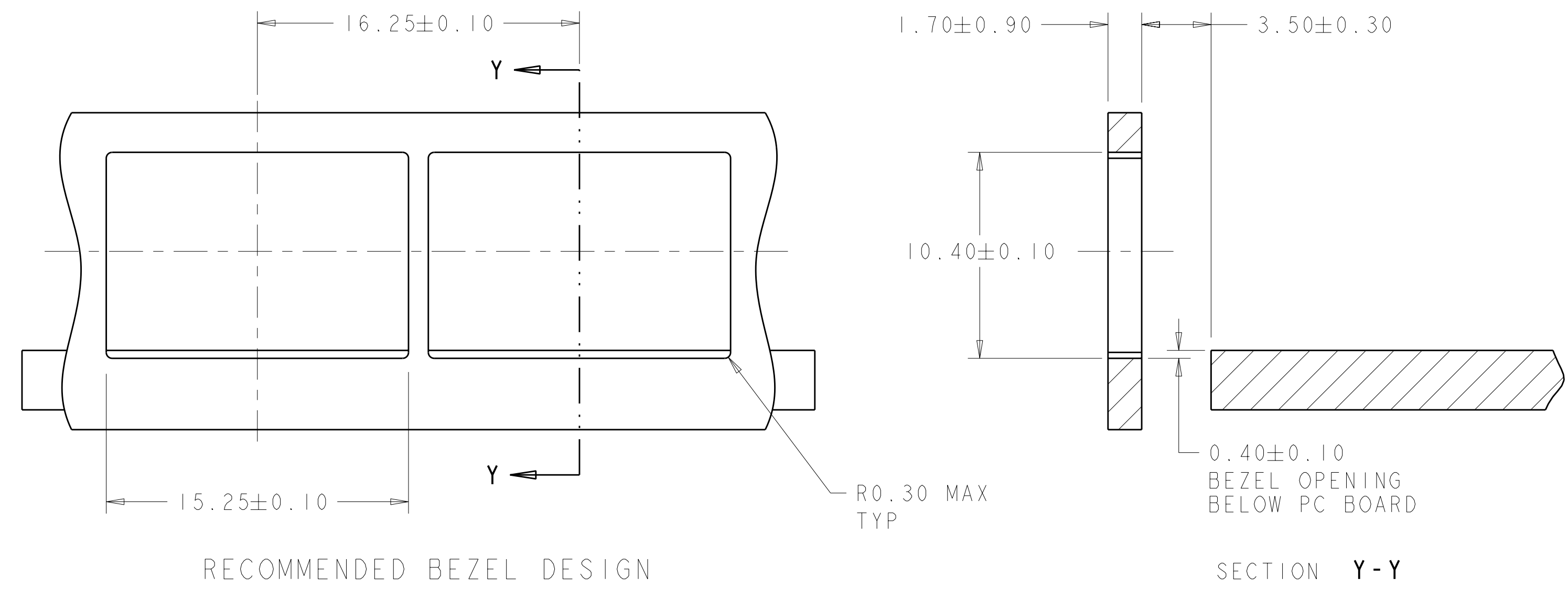

DIMENSIONS: mm 		TOLERANCES UNLESS OTHERWISE SPECIFIED: 9 PLC ± 1 PLC ±0.10 3 PLC ±0.15 4 PLC ± ANGLES ±		DWN P. KERLIN 11MAY06 CHK E. J. BRIGHT 11MAY06 APVD F. J. BRIGHT 11MAY06		Tyco Electronics Harrisburg, PA 17105-3608	
MATERIAL: FINISH:		PRODUCT SPEC: 108-1950 APPLICATION SPEC: 114-13178		NAME: CAGE ASSEMBLY, PRESS FIT, DWDM SFP		SIZE: CAGE CODE: DRAWING NO: A100779C=1367643 RESTRICTED TO:	
CUSTOMER DRAWING		WEIGHT:		SCALE: 5:1		SHEET 2 OF 2 REV D	