

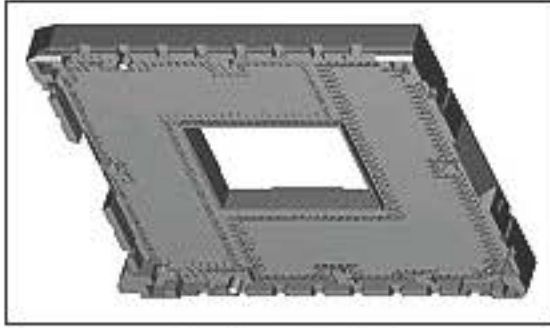

1554116-3 Product Details

[Share](#) | [Print](#) | [Email](#)

1554116-3

TE Internal Number: 1554116-3

Active

[View 3D PDF](#)

LGA Sockets

[Always EU RoHS/ELV Compliant \(Statement of Compliance\)](#)

Product Highlights:

- Socket
- Socket Type = LGA 1356-2
- Black Tray
- Gold (30) Contact Plating, Mating Area, Material
- RoHS compliant, ELV compliant

[View all Features](#)

Quick Links

- ▶ [Check Pricing & Availability](#)
- ▶ [Search for Tooling](#)
- ▶ [Product Feature Selector](#)
- ▶ [Contact Us About This Product](#)

[Add to My Part List](#) [Request Sample](#) [Find Similar Products](#) [Buy Product](#)

Documentation & Additional Information

Product Drawings:

- [SOCKET ASSY LGA1356-2 \(PDF, English\)](#)

Catalog Pages/Data Sheets:

- None Available

Product Specifications:

- None Available

Application Specifications:

- None Available

Instruction Sheets:

- None Available

CAD Files: [\(CAD Format & Compression Information\)](#)

- [2D Drawing \(DXF, Version B\)](#)
- [3D Model \(IGES, Version B\)](#)
- [3D Model \(STEP, Version B\)](#)

Related Products:

- [Tooling](#)

[List all Documents](#)

Product Features (Please use the Product Drawing for all design activity)

Product Type Features:

- Product Type = Socket
- Grid Spacing (mm [in]) = 1.016 x 1.016 [.040 x .040]
- Frame Style = Square

Body Features:

- Socket Type = LGA 1356-2
- Number of Positions = 1356

Contact Features:

- Contact Plating, Mating Area, Material = Gold (30)

Housing Features:

- Housing Material = Thermoplastic
- Housing Color = Black

Industry Standards:

- [RoHS/ELV Compliance](#) = RoHS compliant, ELV compliant
- [Lead Free Solder Processes](#) = Reflow solder capable to 245°C, Reflow solder capable to 260°C
- RoHS/ELV Compliance History = Always was RoHS compliant

Packaging Features:

- Tray Color = Black

Other:

- Brand = Tyco Electronics

Corporate Information

[Who We Are](#)
[Investors](#)
[News Room](#)
[Supplier Portal](#)
[Careers](#)

Quick Links

[Check Distributor Inventory](#)
[Cross Reference](#)
[Find Documents & Drawings](#)
[Product Compliance Support Center](#)
[Site Map](#)

Customer Support

[Email or Chat With Us](#)
[Find a Phone Number](#)
[Search Knowledge Base](#)
[Manage your Account](#)

Keep Me Informed

Receive TE News, Events & Technology Updates

