

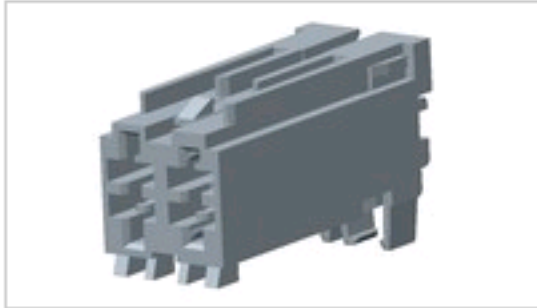

293491-2 Product Details

[Share](#) | [Print](#) | [Email](#)

Active

[View 3D PDF](#)

5mm MONO-SHAPE IDC Connectors

AMP MONO-SHAPE TAB CONN assy 2

293491-2

TE Internal Number: 293491-2

Product Highlights [View All](#)

- Type of Connector = Tab
- Mark I Series
- 2 Positions
- Standard Connector Configuration
- Polarizing Rib Location = 1S, 2D

[Pricing & Availability](#)

[Request Sample](#)

[Add to My Part List](#)

[Buy Product through Distributor](#)

Feedback

[Documents](#)

[Features](#)

[Compliance](#)

Please Note:

Use the Product Drawing for all design activity

Product Type Features	Configuration Features
Type of Connector: Tab	Number of Positions: 2
Color Code: None	Connector Configuration: Standard
Body Features	Industry Standards
Polarizing Rib Location: 1S, 2D	RoHS/ELV Compliance: RoHS compliant, ELV compliant
Locking Latch Between Cavity No.: 1&2	Lead Free Solder Processes: Not reviewed for lead free solder process
RAST Version: None	RoHS/ELV Compliance History: Always was RoHS compliant
Contact Features	Conditions for Usage
Short Circuit Position: None	Mates With: RAST 5 Header
Contact Base Material: Brass	Packaging Features
Contact Finish: Tin	Packaging Method: Tray/Box
Housing Features	Other
Inside Polarization Key Location: None	Series: Mark I
Housing Material: PA 6.6 GF	Brand: TE Connectivity
Housing Color: Natural	

Related Products

Not quite the product you're looking for?

[Find Similar Products](#)

[View Part in Product Feature Selector](#)

[Check for Tooling](#)

Corporate Information

- [About TE](#)
- [Investors](#)
- [News Room](#)
- [Supplier Portal](#)
- [Careers](#)
- [Terms & Conditions](#)
- [Privacy Policy](#)
- [Global Accessibility Statement](#)

Quick Links

- [Distributor Inventory](#)
- [Product Cross Reference](#)
- [Documents & Drawings](#)
- [Product Compliance Support Center](#)
- [Site Map](#)

Customer Support

- [Email or Chat With Us](#)
- [Find a Phone Number](#)
- [Knowledge Base](#)
- [Manage Your Account](#)

Keep Me Informed

